

**26TH STREET EAST SIDEWALK
FROM 9TH AVE DR E TO 16TH AVE E
MANATEE COUNTY, FL**

COVER

ISSUED FOR CONSTRUCTION
JUNE 26, 2017

Sheet List Table	
Sheet Number	Sheet Title
1	COVER
2	GENERAL NOTES
3	GENERAL NOTES
4	TABULATION OF QUANTITIES
5	TYPICAL SECTION & DRAINAGE DETAIL
6	HORIZONTAL & VERTICAL CONTROL
7	SIDEWALK PLAN (1)
8	SIDEWALK PROFILE (1)
9	SIDEWALK PLAN (2)
10	SIDEWALK PROFILE (2)
11	SIDEWALK PLAN (3)
12	SIDEWALK PROFILE (3)
13	SIDEWALK PLAN (4)
14	SIDEWALK PROFILE (4)
15	SIDEWALK PLAN (5)
16	SIDEWALK PROFILE (5)
17	SIGNING & PAVEMENT MARKING PLAN
18	MANATEE COUNTY DETAILS
19	MANATEE COUNTY DETAILS (2)

SHOP DRAWINGS
TO BE SUBMITTED TO :

JOHN SEALS, P.E.
KING ENGINEERING ASSOC, INC.
4921 MEMORIAL CENTER, SUITE 300
TAMPA, FLORIDA 33634
PHONE: 813 880 8881
FAX: 813 880 8882

PLANS PREPARED BY:

King

ENGINEERING ASSOCIATES, INC.

4921 Memorial Highway
One Memorial Center, Suite 300
Tampa, Florida 33634
Phone 813 880-8881
Fax 813 880-8882
www.kingengineering.com
Engineering License #2610



Know what's below
Call before you dig

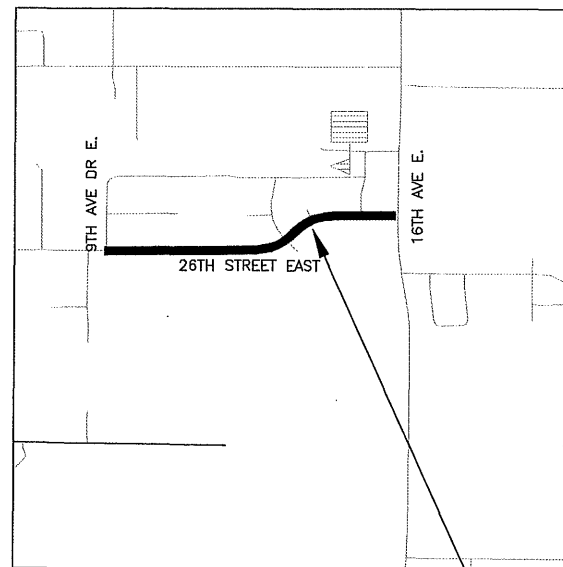

VICINITY MAP
N.T.S.

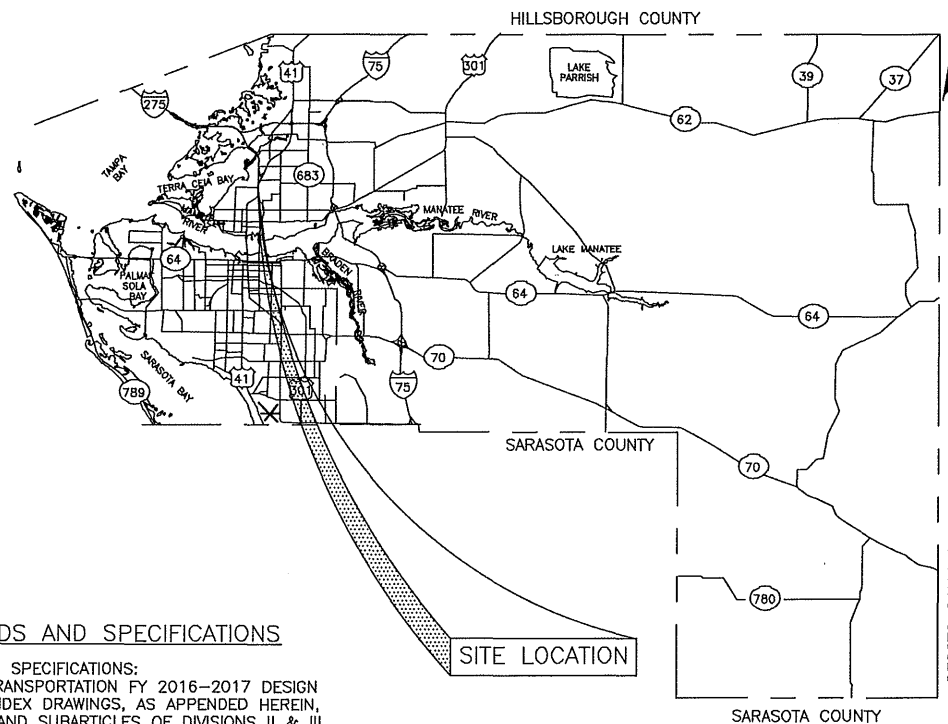

PROJECT SITE

RELATED STANDARDS AND SPECIFICATIONS

GOVERNING STANDARDS AND SPECIFICATIONS:
FLORIDA DEPARTMENT OF TRANSPORTATION FY 2016-2017 DESIGN
STANDARDS AND REVISED INDEX DRAWINGS, AS APPENDED HEREIN,
AND APPLICABLE ARTICLES AND SUBARTICLES OF DIVISIONS II & III
OF THE 2016 STANDARD SPECIFICATIONS FOR ROAD AND BRIDGE
CONSTRUCTION, AS AMENDED BY CONTRACT DOCUMENTS.

FOR DESIGN STANDARDS CLICK ON THE "DESIGN STANDARDS" LINK
AT THE FOLLOWING WEB SITE:
[HTTP://WWW.DOT.STATE.FL.US/RDDesign/](http://www.dot.state.fl.us/RDDesign/)

FOR THE STANDARD SPECIFICATIONS FOR ROAD AND BRIDGE
CONSTRUCTION CLICK ON THE "SPECIFICATIONS" LINK AT THE
FOLLOWING WEB SITE:

FOR MANATEE COUNTY PUBLIC WORKS UTILITY STANDARDS CLICK
'UTILITY DESIGN STANDARDS' LINK AT THE FOLLOWING WEBSITE:
[HTTPS://WWW.MYMANATEE.ORG/HOME/GOVERNMENT/DEPARTMENTS/
PUBLIC-WORKS/ENGINEERING-SERVICES/ENGINEERING-STANDARDS.HTML](https://www.myanatee.org/home/government/departments/public-works/engineering-services/engineering-standards.html)

PROJECT DESCRIPTION

26TH STREET SIDEWALK:

PLANS FOR THE INSTALLATION OF SIDEWALK ALONG 26TH STREET
EAST FROM 9TH AVENUE DRIVE EAST TO 16TH AVENUE EAST

TOTAL LENGTH OF PROJECT (BASELINE):
0.432 MILES

TOTAL LENGTH OF PROPOSED SIDEWALK:
2281 LF

NO.	REVISION DESCRIPTION		BY	DATE
	PROJECT #		9012219	
	SURVEY #		000	
	SEC./TWN./RGE		12/34S/17E	
	SCALE		AS SHOWN	
		BY	DATE	
	SURVEYED	---	---	
	DESIGNED	JRS, MDS	5/19/90	
	DRAWN	MDS	5/19/90	
	CHECKED	JRS	5/19/90	

JOHN SEALS, P.E.
FLORIDA P.E. # 51505

Signature & Date

SHEET 1

O:\PW-Civil\8281\100\001\Production\Drawings\KEYSRD01.dwg,KEYSRD01, 6/26/2017 3:54 PM, Michael D. Schofield, 1:2.5949, ANSI A (8.50 x 11.00 inches)

ALL CONSTRUCTION ACTIVITIES SHALL BE COORDINATED WITH THE PROJECT MANAGEMENT DIVISION. THE PROJECT MANAGER IS: ANTHONY RUSSO, P.E. AND CAN BE REACHED AT (941) 708-7450; EXT. 7349.

2. ALL CONSTRUCTION ON THIS PROJECT SHALL BE IN ACCORDANCE WITH THE LATEST EDITION OF MANATEE COUNTY UTILITY AND TRANSPORTATION STANDARDS AND/OR FDOT DESIGN STANDARDS AND FDOT "STANDARD SPECIFICATIONS FOR ROAD AND BRIDGE CONSTRUCTION" UNLESS OTHERWISE INDICATED ON THE PLANS.

3. ELEVATIONS ARE BASED ON MANATEE COUNTY DISC "BREVARD 2010", WITH A PUBLISHED ELEVATION OF 20.00, NAVD 1988.

4. THE CONTRACTOR SHALL BE RESPONSIBLE FOR MEETING ALL CONDITIONS AND REQUIREMENTS OF ALL PERMITS AND ALL GOVERNING FEDERAL, STATE, AND LOCAL AGENCIES. THE CONTRACTOR SHALL OBTAIN AND PAY FOR ALL REQUIRED PERMITS THAT ARE NOT PROVIDED IN THE BID DOCUMENTS, AT NO ADDITIONAL COST TO THE OWNER.

5. THE INFORMATION PROVIDED IN THESE PLANS IS SOLELY TO ASSIST THE CONTRACTOR IN ASSESSING THE NATURE AND EXTENT OF THE CONDITIONS WHICH MAY BE ENCOUNTERED DURING THE COURSE OF WORK. ALL CONTRACTORS ARE DIRECTED, PRIOR TO BIDDING, TO CONDUCT WHATEVER INVESTIGATION THEY MAY DEEM NECESSARY TO ARRIVE AT THEIR OWN CONCLUSIONS REGARDING THE ACTUAL CONDITIONS THAT WILL BE ENCOUNTERED, AND UPON WHICH THEIR BIDS WILL BE BASED.

6. THE CONTRACTOR SHALL REVIEW AND VERIFY ALL DIMENSIONS ON THE PLANS AND REVIEW ALL FIELD CONDITIONS THAT MAY AFFECT CONSTRUCTION. SHOULD DISCREPANCIES OCCUR, THE CONTRACTOR SHALL NOTIFY THE ENGINEER TO OBTAIN THE ENGINEER'S CLARIFICATION BEFORE COMMENCING WITH CONSTRUCTION.

7. AT LEAST 48 HOURS PRIOR TO ANY EXCAVATION, THE CONTRACTOR SHALL CONTACT SUNSHINE STATE ONE CALL OF FLORIDA AT 1-800-432-4770 OR THE NATIONAL 811 ONE CALL NUMBER WHEN APPLICABLE FOR UTILITY LOCATIONS. THE CONTRACTOR SHALL BE RESPONSIBLE FOR COORDINATING WITH ALL UTILITIES FOR THE POSSIBLE RELOCATION OR THE TEMPORARY MOVEMENT OF ANY EXISTING UTILITIES WITHIN THE RIGHTS-OF-WAY.

8. ALL STATIONS AND OFFSETS REFER TO BASELINE OF CONSTRUCTION, UNLESS OTHERWISE NOTED.

9. THE CONSTRUCTION LENGTHS IN THESE PLANS ARE APPROXIMATE. ACTUAL LIMITS MAY BE SET IN THE FIELD AS DIRECTED BY THE ENGINEER.

10. SEPARATE PAYMENT SHALL BE MADE ONLY FOR THE ITEMS OF WORK LISTED AND IDENTIFIED BY APPROPRIATE PAY ITEM ON THE BID FORM. THE COST OF ANY RELATED WORK NOT SPECIFICALLY IDENTIFIED, BUT WHICH IS REQUIRED FOR SATISFACTORY COMPLETION OF THE WORK, SHALL BE CONSIDERED TO BE INCLUDED IN THE CONTRACT PRICE FOR THE APPROPRIATE BID ITEM.

11. THE CONTRACTOR SHALL HAVE A FOREMAN, OR RESPONSIBLE PARTY, ON SITE AT ALL TIMES WHEN WORK IS BEING PERFORMED. ALL WORKERS ON THE JOB SITE WILL BE COURTEOUS TO THE PUBLIC AT ALL TIMES, AND SHALL REFER ANY QUESTIONS OR CONCERNS TO THE CONTRACTOR'S FOREMAN OR THE COUNTY INSPECTOR. THE FOREMAN SHALL SPEAK AND UNDERSTAND ENGLISH AND SHALL BE AVAILABLE AT ALL TIMES FOR TIMELY RESOLUTION OF PROJECT-RELATED ISSUES.

12. THE CONTRACTOR SHALL BE RESPONSIBLE FOR THE COMPLETE COORDINATION OF CONSTRUCTION SCHEDULING BETWEEN CONTRACTOR AND ALL UTILITY AGENCIES.

NOTE:
THIS INCLUDED MEETING WITH UTILITY AGENCIES PRIOR TO THE PRE-CONSTRUCTION CONFERENCE TO ADJUST THEIR SCHEDULES TO COINCIDE WITH THE CONTRACTORS CONSTRUCTION SCHEDULE. (REFERENCE CONTRACT DOCUMENTS)

13. ANY DAMAGE TO STATE, COUNTY, OR LOCAL ROADS CAUSED BY THE CONTRACTOR'S HAULING OR EXCAVATION EQUIPMENT SHALL BE REPAIRED BY THE CONTRACTOR TO THE SATISFACTORY OF THE COUNTY PROJECT MANAGER. PAYMENT SHALL NOT BE MADE FOR THIS WORK.

14. ALL CONSTRUCTION WITHIN FDOT RIGHT-OF-WAY IS TO BE IN ACCORDANCE WITH CURRENT FDOT STANDARD SPECIFICATIONS FOR ROADWAY CONSTRUCTION AND THE DESIGN STANDARDS.

15. ALL SIGNING, STRIPING AND RPM PLACEMENT WITHIN THE FDOT RIGHT-OF-WAY IS TO BE IN ACCORDANCE WITH FDOT STANDARD INDEX 17346.

SAFETY

16. THE CONTRACTOR SHALL BE RESPONSIBLE FOR COMPLIANCE WITH THE FLORIDA TRENCH SAFETY ACT, 90-96, LAWS OF FLORIDA EFFECTIVE OCTOBER 1, 1990 AND THE OCCUPATIONAL SAFETY AND HEALTH ADMINISTRATION EXCAVATION SAFETY STANDARDS, 29 CFR 1926.650, SUBPART P, AS AMENDED. THE CONTRACTOR SHALL INCLUDE IN THE TOTAL BID PRICE ALL COSTS FOR COMPLIANCE WITH THESE REGULATIONS.

17. THE CONTRACTOR SHALL USE SHEET PILING, SHEETING, BRACING, ETC., AS REQUIRED IN ALL EXCAVATION AREAS AND CONFORM TO ALL OSHA REQUIREMENTS.

18. THE CONTRACTOR SHALL USE ALL NECESSARY SAFETY PRECAUTIONS TO AVOID CONTACT WITH OVERHEAD AND UNDERGROUND UTILITIES, POWER LINES, ETC.

19. THESE DRAWINGS DO NOT INCLUDE NECESSARY COMPONENTS FOR CONSTRUCTION SAFETY. THIS EXCLUSION DOES NOT ALLEVIATE THE CONTRACTOR FOR PROVIDING A CONTINUOUS SAFE WORKSPACE.

ENVIRONMENTAL

20. CONTRACTOR IS RESPONSIBLE FOR INSTALLATION ALL SEDIMENT AND EROSION CONTROL (SEC) DEVICES (E.G., BARRIERS, SEDIMENT TRAPS/BASINS, VEGETATIVE BUFFERS, ETC.) AS SPECIFIED IN THE FINAL APPROVED PLANS FOR THE PROJECT. CONTRACTOR SHALL BE RESPONSIBLE FOR MAINTAINING ALL SEC DEVICES UTILIZED DURING THE PROJECT, AS WELL AS INSTALLATION & MAINTENANCE OF ANY ADDITIONAL MEASURES DEEMED NECESSARY DURING PROJECT IMPLEMENTATION, TO PREVENT EROSION AND OFF-SITE SEDIMENT MIGRATION. CONTRACTOR SHALL ALSO BE RESPONSIBLE FOR REMOVAL AND PROPER DISPOSAL OF ALL SEC DEVICES UPON CONCLUSION OF THE PROJECT, AND UPON ADEQUATE STABILIZATION OF DISTURBED SOILS.

21. WHEN A BENTONITE SPILL OR FRACK-OUT OCCURS OR THERE IS A LOSS OF RETURN INDICATING EXCESSIVE SEEPAGE OR LOSS OF DRILLING FLUID, DRILLING MUST BE STOPPED UNTIL THE LOCATION OF THE SPILL IS IDENTIFIED. UNDER NO CIRCUMSTANCES WILL DRILLING CONTINUE WHEN A SPILL IS APPARENT.

22. ONCE LOCATED, THE BENTONITE SPILL MUST BE ISOLATED AND SEEPAGE INTO ANY NEARBY WATER BODIES WILL BE BLOCKED DEPENDING ON THE DEGREE OF THE SPILL, THE ISOLATED BENTONITE MUST BE REMOVED MANUALLY OR MECHANICALLY AND DISPOSED OF BY APPROPRIATE MEANS OR REUSED.

23. THE CONTRACTOR SHALL PROVIDE AND INSTALL ALL NECESSARY STORM WATER, EROSION, AND SEDIMENTATION CONTROL MEASURES IN ACCORDANCE WITH THE FDEP "FLORIDA STORM WATER, EROSION AND SEDIMENTATION CONTROL INSPECTOR'S MANUAL". IT IS THE RESPONSIBILITY OF THE CONTRACTOR TO CONTROL AND PREVENT EROSION AND TRANSPORT OF SEDIMENT TO SURFACE DRAINS AND TO DITCHES DURING CONSTRUCTION.

24. STOCKPILES SHALL BE PROTECTED AT ALL TIMES BY ON-SITE DRAINAGE CONTROLS WHICH PREVENT EROSION OF THE STOCKPILED MATERIAL. CONTROL OF DUST FROM SUCH STOCKPILES IS REQUIRED, DEPENDING UPON THEIR LOCATION AND THE EXPECTED LENGTH OF TIME THE STOCKPILES WILL BE PRESENT. IN NO CASE SHALL ANY STOCKPILED MATERIAL REMAIN AFTER THIRTY (30) CALENDAR DAYS.

25. STORM WATER INLETS IN THE VICINITY OF THE PROJECT SHALL BE PROTECTED BY SEDIMENT TRAPS SUCH AS SECURED HAY BALES, SOD, STONE, ETC., WHICH SHALL BE MAINTAINED AND MODIFIED AS REQUIRED BY CONSTRUCTION PROGRESS, AND WHICH MUST BE APPROVED BY THE ENGINEER BEFORE INSTALLATION. THIS WILL BE MAINTAINED TO PREVENT DEGRADATION OF THE WATERS OF THE COUNTY AND STATE.

26. SEDIMENT BASINS AND TRAPS, PERIMETER BERMS, SEDIMENT BARRIERS, VEGETATIVE BUFFERS, AND OTHER MEASURES INTENDED TO TRAP SEDIMENT AND/OR PREVENT THE TRANSPORT OF SEDIMENT ONTO ADJACENT PROPERTIES, OR INTO EXISTING BODIES OF WATER, MUST BE INSTALLED, CONSTRUCTED, OR IN THE CASE OF VEGETATIVE BUFFERS, PROTECTED FROM DISTURBANCE, AS A FIRST STEP IN THE LAND ALTERATION PROCESS. SUCH SYSTEMS SHALL BE FULLY OPERATIVE BEFORE ANY OTHER DISTURBANCE OF THE SITE BEGINS. EARTHEN STRUCTURES INCLUDING BUT NOT LIMITED TO BERMS, EARTH FILTERS, DAMS OR DIKES SHALL BE STABILIZED AND PROTECTED FROM DRAINAGE DAMAGE OR EROSION WITHIN ONE (1) WEEK OF INSTALLATION.

27. ALL SWALES, DITCHES, AND CHANNELS LEADING FROM THE SITE SHALL BE PROTECTED FROM SILTATION AND EROSION DURING CONSTRUCTION AND BE SODDED WITHIN THREE (3) DAYS OF EXCAVATION.

42. EXCEPT WHERE THE PLANS AND SPECIFICATIONS PROVIDE THAT SUCH WORK SHALL BE PERFORMED UNDER THE CONTRACT FOR THIS PROJECT, ALL UTILITIES INTERFERING WITH CONSTRUCTION SHALL BE REMOVED, RELOCATED OR ADJUSTED BY THEIR OWNERS, AT THEIR EXPENSE. THE CONTRACTOR SHALL ARRANGE HIS SCHEDULE TO ALLOW UTILITY OWNERS TIME FOR THE NECESSARY RELOCATION AND ADJUSTMENT OF UTILITIES AND RELATED STRUCTURES.
43. ~~A-FLORIDA POWER AND LIGHT SPECIAL PROVISION THAT THE TYPE OF EQUIPMENT USED IN THE INSTALLATION OF MAST ARMS/FOUNDATIONS, OVERHEAD/CANTRILEVER SIGNS/FOUNDATIONS, AND THE MOVEMENT/INSTALLATION OF STRAIN POLES SHALL MEET THE FOLLOWING REQUIREMENTS: 1) OVERHEAD LINES SHALL STAY IN PLACE BOTH VERTICALLY AND HORIZONTALLY 2) CONTRACTOR SHALL MEET ALL APPLICABLE OSHA REQUIREMENTS (SEPARATION SHALL FOLLOW FPL GUIDELINES). ANY COST ASSOCIATED WITH THIS TYPE OF EQUIPMENT REQUIRED FOR THIS INSTALLATION IS INCLUDED IN THE RELATED PAY ITEMS. PLEASE REFER TO THE SPECIAL CONDITIONS IN THE UTILITY WORK SCHEDULE AND UTILITY COORDINATION.~~
44. CONTRACTOR SHALL BE RESPONSIBLE FOR COORDINATING WITH ALL UTILITY COMPANIES FOR THE RELOCATION AND ADJUSTMENT OF ALL UTILITIES, INCLUDING, ANY EXISTING POWER POLES AND/OR UTILITY CONDUITS WITHIN RIGHT-OF-WAY.
45. PRIOR TO CONSTRUCTION, THE CONTRACTOR SHALL BE RESPONSIBLE TO COORDINATE WITH THE APPROPRIATE PARTIES TO DETERMINE THE COUNTY'S FIBER COMMUNICATION NETWORK, KNOWN AS ATMS (COUNTY ISD, SCHOOL BOARD, AND TRAFFIC MANAGEMENT CENTER) IN THE AREA TO ACCOMMODATE ANY POTENTIAL CONFLICTS. AS-BUILT INFORMATION FOR EXISTING COMMUNICATION CONDUIT AND FIBER IS AVAILABLE FROM OLGA ROSIER, WITH UTILITY RECORDS (941-792-8811 EXT. 5059). CONSTRUCTION PLAN INFORMATION FOR PROJECTS UNDER CONSTRUCTION WITH THE COUNTY'S TRAFFIC MANAGEMENT CENTER ARE AVAILABLE AT WWW.MANATEEATMS.COM AND WWW.MANATEETMS2.COM.

46. ALL CONSTRUCTION IS TO BE STAKED IN THE FIELD BY OR UNDER THE SUPERVISION OF A FLORIDA REGISTERED LAND SURVEYOR.

47. THE CONTRACTOR IS TO PROVIDE THE ENGINEER OF RECORD WITH REPRODUCIBLE RECORD DRAWINGS SHOWING ALL IMPROVEMENT LOCATIONS AND ELEVATIONS IN ACCORDANCE WITH LATEST MANATEE COUNTY TRANSPORTATION DEPARTMENT STANDARDS AND SOUTHWEST FLORIDA WATER MANAGEMENT DISTRICT (SWFWMD) STANDARDS. THE CONTRACTOR SHALL ALSO PROVIDE FIVE SETS OF PRINTS, SIGNED AND SEALED BY A PROFESSIONAL LAND SURVEYOR, OF THE RECORD DRAWINGS TO THE ENGINEER OF RECORD. THESE RECORD DRAWINGS SHALL BE CERTIFIED TO THE OWNER AND APPROPRIATE GOVERNMENTAL AGENCIES. RECORD DRAWINGS SHALL SPECIFICALLY INDICATE WATER TREATMENT FACILITY LOCATIONS, INCLUDING TOP OF BANK, UNDERDRAIN AND CONTROL STRUCTURES. SHALL BE PERFORMED BY A REGISTERED LAND SURVEYOR AND REVIEWED BY THE ENGINEER OF RECORD PRIOR TO ACCEPTANCE AND PAYMENT. BENCH MARKS WITH THE ELEVATION CLEARLY AND PERMANENTLY MARKED ARE TO BE

67. RESTORATION OF CURBS, DRIVEWAYS, SIDEWALKS, AND PLACEMENT OF SOD SHALL BE COMPLETED WITHIN FORTY-FIVE CALENDAR DAYS OF INITIAL DISTURBANCE, OR TWENTY-ONE CALENDAR DAYS OF SUBSTANTIAL COMPLETION, WHICHEVER OCCURS FIRST.

[illegible]

Q:\PW-Civil\828\1\00\001\Production\Drawings\CONTR001.dwg, SCL 2, Trans, 6/26/2017 3:45 PM Michael D. Schofield, 1:1, ANSI D (22.00 x 34.00 inches)

CONSTRUCTION

68. THE EXHAUST SYSTEM OF ALL GASOLINE AND DIESEL ENGINES SHALL BE EQUIPPED WITH MUFFLERS THAT MEET THE EQUIPMENT MANUFACTURER'S REQUIREMENTS FOR NOISE SUPPRESSION. THE CONTRACTOR SHALL INSTALL NOISE ABATEMENT BAFFELS POSITIONED TO BREAK LINE-OF-SITE FROM THE NOISE SOURCE TO AFFECTED RESIDENCES, AS APPROVED BY THE ENGINEER.
69. NO MATERIAL SHALL BE STOCKPILED IN ROADWAYS. ALL DIRT AND DEBRIS SHALL BE REMOVED FROM THE JOB SITE DAILY. ROADS SHALL BE SWEEP DAILY AS PART OF DAILY CLEAN UP.
70. THE CONTRACTOR IS TO CONTROL ALL FUGITIVE DUST ORIGINATING ON THIS PROJECT BY WATERING OR OTHER METHODS AS REQUIRED.
71. INGRESS AND EGRESS TO ALL THE PROPERTIES IN THE CONSTRUCTION AREA SHALL BE MAINTAINED AT ALL TIMES.
72. PRIOR APPROVAL WILL BE REQUIRED FOR REMOVAL OF ANY TREE WITHIN THE CONSTRUCTION AREA, UNLESS OTHERWISE NOTED ON THE PLANS.
73. THE CONTRACTOR SHALL PROVIDE ALL DEWATERING EQUIPMENT NECESSARY TO KEEP ALL EXCAVATIONS DRY. DEWATERING IS REQUIRED TO 18" BELOW TRENCH BOTTOM. THE CONTRACTOR SHALL SUBMIT DEWATERING PLAN TO DISTICT FOR APPROVAL PRIOR TO CONSTRUCTION.
74. ALL PIPING AND FITTINGS USED ON THIS PROJECT SHALL BE AS NOTED ON THE PLANS AND IN THE CONTRACT DOCUMENT AND SHALL BE INSTALLED TO THE LINES AND GRADES SHOWN ON THE PLANS AND PROFILES.
75. ALL PIPE LENGTHS ARE PLUS OR MINUS AND MAY BE ADJUSTED IN THE FIELD AS REQUIRED. PIPE MEASUREMENTS AND STATION OFFSETS ARE TO CENTER OF STRUCTURES OR FITTINGS. REFER TO DETAIL SHEET FOR ALL REFERENCE POINTS.
76. ALL ROCKS OR STONES LARGER THAN SIX INCH DIAMETER SHALL BE REMOVED FROM THE BACKFILL MATERIAL. BACKFILL MATERIAL PLACED WITHIN ONE FOOT OF PIPING AND APPURTENANCES SHALL NOT CONTAIN ANY STONES LARGER THAN TWO INCH DIAMETER.
77. ALL PENETRATION OF EXISTING STRUCTURES SHALL BE BY THE MECHANICAL ROTARY CORE BORING METHOD.
78. ALL CONCRETE AND REBAR PENETRATED OR DISTURBED SHALL BE COATED WITH TWO COATS OF EPOXY.
79. CONTRACTOR IS RESPONSIBLE FOR ALL UNSUITABLE MATERIAL REMOVAL WITHIN PROJECT LIMITS. EXCAVATION, EMBANKMENT, INCLUDING UTILIZATION, AND UNSUITABLE MATERIAL REMOVAL SHALL BE IN ACCORDANCE WITH FDOT DESIGN STANDARDS, LATEST VERSION.
80. WHERE EXCAVATION IS REQUIRED FOR CONSTRUCTION OF SIDEWALK, ALL STUMPS, ROOTS, ETC. SHALL BE REMOVED COMPLETELY FROM THE SIDEWALK AREA. ALL STUMPS WITHIN THE PROJECT LIMITS SHALL BE REMOVED COMPLETELY AND REPLACED WITH COMPACTED FILL BEFORE THE AREA IS FILLED. TREE ROOTS IN AREA OF PROPOSED SIDEWALK, RAMP, OR DRIVEWAY REPLACEMENT SHALL BE GROUND OUT TO A DEPTH OF 6" BELOW BOTTOM OF NEW SIDEWALK OR DRIVEWAY. ALL PRUNED ROOT DEBRIS SHALL BE REMOVED FROM THE SUB-BASE MATERIAL PRIOR TO POURING CONCRETE, ASPHALT, OR APPLICATION OF OTHER SPECIFIED MATERIALS. THIS WORK SHALL BE INCLUDED IN AND PAID FOR UNDER THE PAY ITEM FOR CLEARING AND GRUBBING.
81. ALL STUMPS, ROOTS, AND OTHER DEBRIS PROJECTING THROUGH OR APPEARING ON THE SURFACE OF THE GROUND SHALL BE REMOVED TO A DEPTH OF 1-FOOT BELOW THE COMPLETED SURFACE. THIS WORK SHALL BE INCLUDED IN AND PAID FOR UNDER THE PAY ITEM FOR CLEARING AND GRUBBING.
82. ALL MATERIALS NOT CLAIMED BY THE COUNTY SHALL BECOME PROPERTY OF THE CONTRACTOR, AND SHALL BE DISPOSED OF BY THE CONTRACTOR IN AREAS PROVIDED BY THE CONTRACTOR. THIS WORK SHALL BE INCLUDED IN AND PAID UNDER THE PAY ITEM CLEARING AND GRUBBING.
83. THE CONTRACTOR SHALL PROVIDE ALL SHEETING, SHORING, AND BRACING REQUIRED TO PROTECT ADJACENT STRUCTURES OR TO MINIMIZE TRENCH WIDTH. WHERE A SEPARATE PAY ITEM IS NOT PROVIDED, THE COST OF ALL SHEETING, SHORING, AND BRACING REQUIRED SHALL BE INCLUDED IN THE CONTRACT PRICE FOR THE ITEM OF WORK FOR WHICH SHEETING, SHORING, AND BRACING IS REQUIRED.
84. THE CONTRACTOR SHALL DISTURB NO MORE GROUND THAN WHAT IS NECESSARY FOR CONSTRUCTION. NO OPEN EXCAVATED TRENCH, OR OTHER UNSAFE CONDITION WILL BE LEFT OVERNIGHT. ALL WORK SITES WILL BE COMPLETELY RESTORED WITHIN SEVEN (7) CALENDAR DAYS OF THE CONCRETE POUR FOR SIDEWALK.THE INTENT OF THIS PROVISION IS TO "SAFE-UP" THE PROJECT SITE AS WORK PROGRESSES, AND SHALL INCLUDE REMOVING FORMS, FILLING HOLES, GRADING, AND REMOVAL OF DEBRIS.
85. ALL EXISTING SIGNS WITHIN THE PROJECT LIMITS SHALL REMAIN UNLESS OTHERWISE NOTED IN THE PLANS, OR AS DIRECTED BY THE ENGINEER.
86. ANY EXISTING SIGN TO REMAIN THAT IS DISTURBED OR RELOCATED DURING CONSTRUCTION SHALL BE RESET TO CURRENT STANDARDS FOR HEIGHT, OFFSET, AND METHOD OF INSTALLATION AT NO ADDITIONAL COST TO THE COUNTY.
87. ALL EXISTING SWALES NOT DESIGNATED FOR RECONSTRUCTION SHALL BE REGRADED TO PROMOTE POSITIVE DRAINAGE AND MATCH PROPOSED CENTERLINE SWALE ELEVATION AND ALIGNMENT.
88. ALL STORM DRAINS AND STRUCTURES TO REMAIN SHALL BE CLEANED OF DEBRIS, DIRT, VEGETATION AND OTHER MATERIAL. STORM SEWER INLETS SHALL BE MODIFIED (RAISED/LOWERED) TO MATCH PROPOSED FINISHED GRADE.
89. ALL EXISTING FENCES DISTURBED DURING CONSTRUCTION SHALL BE REPAIRED OR REPLACED AND REINSTALLED BY THE CONTRACTOR AT NO ADDITIONAL COST. (EXISTING FENCES WITHIN R/W TAKING LIMITS SHALL BE RECONSTRUCTED TO THE NEW R/W LINE AND ARE TO BE REIMBURSED UNDER THE MISCELLANEOUS BID ITEM).
90. ALL EXISTING TREES LOCATED WITHIN R/W LIMITS SHALL REMAIN UNLESS OTHERWISE NOTED.
91. ALL EXISTING STORM DRAINAGE STRUCTURES SHALL REMAIN UNLESS OTHERWISE NOTED.
92. ALL EXISTING BUILDINGS SHALL REMAIN UNLESS OTHERWISE NOTED.
93. REMOVE AND REPLACE BASE AND SUB-BASE ACCORDING TO FDOT STANDARDS
94. ALL DISTURBED SOIL/GRASSED AREAS TO BE SODDED.

ADDITIONAL NOTES:

TREE REMOVAL

1. TREE REMOVAL AND ROOT PRUNING TO BE PAID UNDER LUMP SUM FEE FOR CLEARING AND GRUBBING.

WORK ZONE TRAFFIC CONTROL GENERAL NOTES:

1. ALL WORK ZONE TRAFFIC CONTROL (WZTC) DEVICES SHALL BE INSTALLED PRIOR TO COMMENCEMENT OF CONSTRUCTION AND SHALL BE PROPERLY MAINTAINED AND OPERATED THROUGHOUT THE PERIOD OF EACH PHASE/STAGE OF CONSTRUCTION. ALL TEMPORARY SIGNS, PAVEMENT MARKINGS, AND WARNING DEVICES NECESSARY FOR THE WZTC SHALL CONFORM TO THE MANUAL OF UNIFORM TRAFFIC CONTROL DEVICES (LATEST EDITION) AND THE FDOT DESIGN STANDARDS (FY 2016-2017).
2. MAINTAIN EXISTING POSTED SPEED LIMIT ALONG 26TH STREET EAST DURING ALL WORK ACTIVITIES.
3. FOR WORK ZONE ACTIVITIES ALONG THE ROADWAY SHOULDER GREATER THAN 2' FROM THE TRAVEL, REFER TO FDOT INDEX 601 AND 602 FOR PLACEMENT OF WORK ZONE SIGNS AND WARNING DEVICES. FOR WORK ZONE ACTIVITIES THAT ENCR OACH INTO OR WITHIN 2' OF THE TRAVEL LANE, REFER TO FDOT INDEX 603 FOR PLACEMENT OF WORK ZONE SIGNS AND WARNING DEVICES.

MANATEE COUNTY
PUBLIC WORKS DEPT.
INFRASTRUCTURE ENGINEERING
SCOTT MAY, P.E.
1022 26TH AVENUE EAST
BRADENTON, FL. 34208
(941) 708-7450 EXT. 7650
FAX: (941) 708-7431

TECO/PEOPLES GAS CO.
DAN SHANAHAN
8261 VICO COURT
SARASOTA, FL. 34240
(941) 342-4030
FAX: (941) 342-4011
EMERGENCY: 1-877-832-6911
djshanahan@tecoenergy.com

SUNSHINE STATE ONE CALL OF
FLORIDA
1-(800) 432-4770

VERIZON FLORIDA INC.
DAVID WYNN
7701 E. TELECOM PKWY
TEMPLE TERRACE, FL 33637
(813) 978-2164
denise.hutton@verizon.com

FLORIDA POWER & LIGHT
DISTRIBUTION
TRACY STERN
2900 CATHERINE ST
PALATKA, FL 32177
1-800-868-9554
(941) 723-4430
FAX: (941) 723-4444
EMERGENCY: 1-800-4-OUTAGE
tracy.stern@flp.com

CONTACTS

FLORIDA POWER & LIGHT
TRANSMISSION
PETER H. WASHIO
700 UNIVERSE BLVD. TS4/JW
JUNO BEACH, FL. 33408
Peter.H.Washio@ fpl.com

MANATEE COUNTY HEALTH DEPT.
HANS C. ROESE
410 6th AVENUE EAST
BRADENTON, FL. 34208
(941) 748-0747 EXT. 1342
FAX: (941) 750-9364
hans_roese@doh.state.fl.us

SOUTHWEST FLORIDA WATER
MANAGEMENT DISTRICT
SARASOTA SERVICE OFFICE
6750 FRUITVILLE ROAD
SARASOTA, FL. 34240
(941) 377-3722
FAX: (941) 373-7660

FLORIDA GAS TRANSMISSION
SAFETY HARBOR TEAM
7804 ANDERSON RD.
TAMPA, FL. 33634
CHRIS LEE
(813) 466-3327
CELL : (727) 639-7512
christopher.lee@sug.com

BRIGHT HOUSE NETWORKS
TOM WRIGHT
9413 E. STATE ROAD 64
BRADENTON, FL. 34208-5535
(941) 748-3816 EXT. 21348
tom.wright@mybrighthouse.com

DEPARTMENT OF ENVIRONMENTAL
PROTECTION
STEPHANIE BARIOS
13051 N. TELECOM PKWY
TEMPLE TERRACE, FL. 33637
PHONE: (813) 632-7600, EXT.
408
FAX: (813) 632-7662

PEACE RIVER ELECTRIC
COOPERATIVE, INC.
P.O. BOX 1310
WACHULA, FL. 33873
KENDELL COKER
(863) 767-4660
kendell.coker@preco.coop
CLAY STANPHILL
(863) 781-0863

PEACE RIVER ELECTRIC
COOPERATIVE, INC.
14505 ARBOR GREEN TRAIL
LAKEWOOD RANCH, FL 34202
DAVID MCCLINTOCK
ENGINEERING SERVICES
SUPERVISOR
863-767-4621

MANATEE COUNTY
PUBLIC WORK DEPT.
TRAFFIC DESIGN DIVISION
PAUL J. VILLALUZ, P.E., PTOE
(941) 749-3500 EXT. 7859
FAX: (941) 749-3571

CITY OF PALMETTO
PUBLIC WORKS
600 17TH ST W
PALMETTO, FL 34221
JAVIER VARGAS
(941) 723-4580 EXT. 2102
jvargas@palmettofl.org

MANATEE COUNTY, FLORIDA
PUBLIC WORKS DEPARTMENT
ENGINEERING SERVICES



1022 26th Avenue East
Bradenton, FL 34208

26TH STREET EAST SIDEWALK
FROM 9TH AVE DR E TO 16TH AVE E
MANATEE COUNTY, FL
GENERAL NOTES

NO.	REVISION DESCRIPTION	BY	DATE
PROJECT #		9012219	
SURVEY #		000	
SEC./TWN./RGE		12/34S/17E	
SCALE		AS SHOWN	
		BY	DATE
SURVEYED	----	----	----
DESIGNED	JRS, MDS	5/19/17	
DRAWN	MDS	5/19/17	
CHECKED	JRS	5/19/17	
JOHN SEALS, P.E.			
FLORIDA P.E. # 51505			
Signature & Date			
SHEET 3			

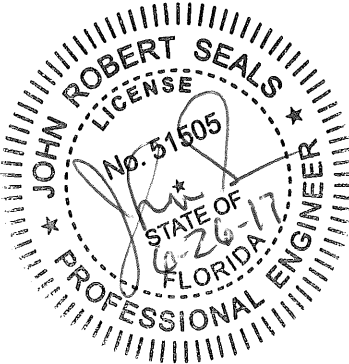

**26TH STREET EAST SIDEWALK
FROM 9TH AVE DR E TO 16TH AVE E
MANATEE COUNTY, FL
TABULATION OF QUANTITIES**

NO.	REVISION DESCRIPTION	BY	DATE
PROJECT #	9012219		
SURVEY #	000		
SEC./TWN./RGE	12/34S/17E		
SCALE	AS SHOWN		
	BY	DATE	
SURVEYED			
DESIGNED	JRS, MDS	5/19/17	
DRAWN	MDS	5/19/17	
CHECKED	JRS	5/19/17	
JOHN SEALS, P.E.			
FLORIDA P.E. # 51505			
Signature & Date			
SHEET 4			

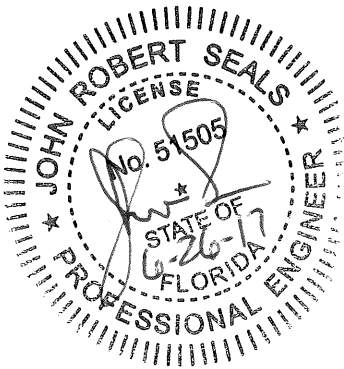

D:\VW-Civil\2017\100\001\Production\Drawings\TYPICAL\SECTION_6\28\2017_3-45 PM Michael D. Schofield, P.E., ANSI D (22.00 x 34.00 inches)

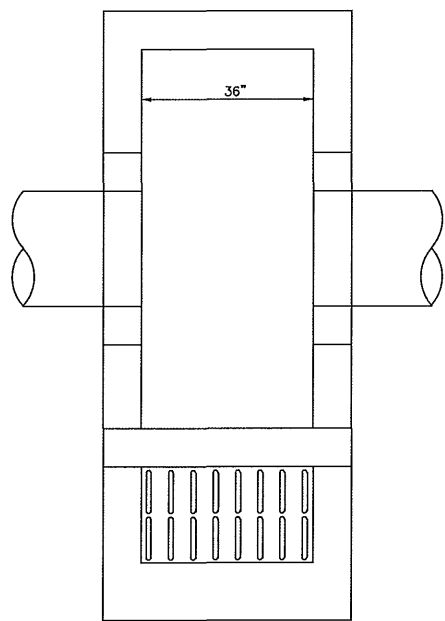
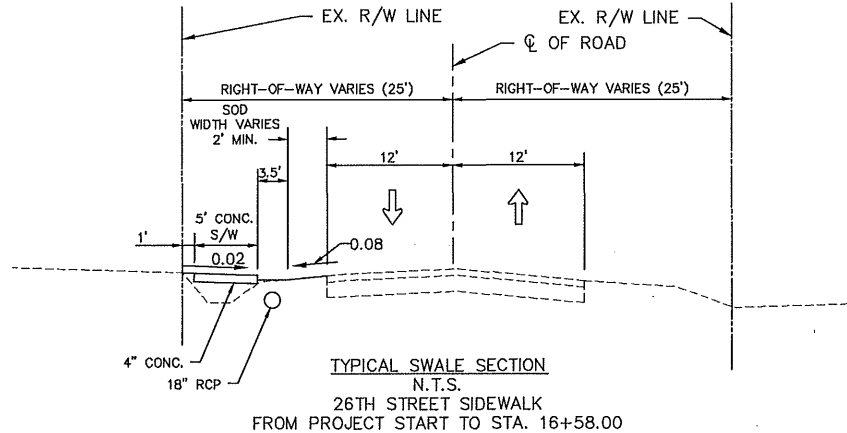
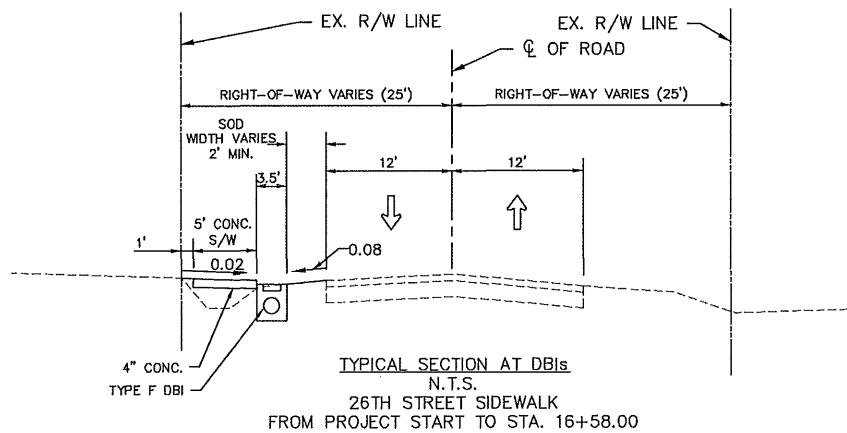

MODIFIED DITCH BOTTOM INLET DETAIL
PLAN VIEW

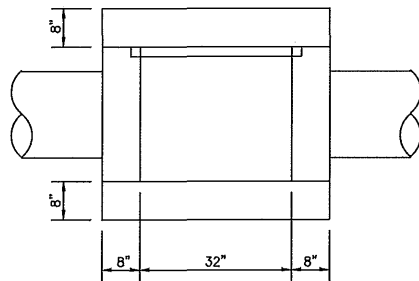

MODIFIED DITCH BOTTOM INLET DETAIL
ELEVATION VIEW

POSTED SPEEDS:

26TH ST. E.	30 MPH
16TH AVE E	35 MPH
SIDE STREETS	25 MPH

NOTES:

SIDEWALKS SHALL BE CONSTRUCTED IN ACCORDANCE TO THE FOLLOWING MANATEE COUNTY HIGHWAY TRAFFIC AND STORMWATER STANDARDS SECTION 300:
<http://www.mymonatee.org/home/government/departments/public-works/engineering-services/engineering-standards.html>

- SIDEWALK SHALL BE CONSTRUCTED A MINIMUM OF 4" THICK, USING 3000 PSI CONCRETE. WHERE SIDEWALK BISECTS A DRIVEWAY, THE MINIMUM SHALL BE 6" OF CLASS I CONCRETE. *SEE SHEETS #101.2 AND 101.3
 - ALL SIDEWALKS SHALL BE CONSTRUCTED TO THE SPECIFICATIONS OF THE MANATEE COUNTY LAND DEVELOPMENT CODE, SECTION 722. A MINIMUM (5) FOOT WIDE SIDEWALK SHALL BE INSTALLED ALONG THE NORTH AND WEST SIDES OF ALL NEW LOCAL STREETS WHICH ARE CONSTRUCTED IN CONJUNCTION WITH A NEW RESIDENTIAL DEVELOPMENT. A SIDEWALK A MINIMUM OF (5) FEET IN WIDTH SHALL BE INSTALLED ON BOTH SIDES OF ALL THOROUGHFARES. REFER TO FDOT ROADWAY AND TRAFFIC STANDARDS, LATEST REVISION FOR CURB CUT RAMP SPECIFICATIONS.
 - THE CONCRETE SHALL BE GIVEN A BROOM FINISH. THE SURFACE VARIATIONS SHALL NOT BE MORE THAN 1/4" UNDER A TEN FOOT STRAIGHTEDGE, NOR MORE THAN 1/8" ON A FIVE-FOOT TRAVERSE SECTION. THE EDGE OF THE SIDEWALK SHALL BE CAREFULLY FINISHED WITH AN EDGING TOOL HAVING A RADIUS OF 1/2".
 - EXPANSION JOINT: EXPANSION JOINTS BETWEEN THE SIDEWALKS AND THE CURB OR DRIVEWAY OR AT FIXED OBJECTS AND SIDEWALK INTERSECTIONS SHALL BE 1/2" MATERIAL SHALL MEET THE REQUIREMENTS OF AASHTO M153 OR AASHTO M213. FOR LONG POORS, AN EXPANSION JOINT SHALL BE PLACED AT INTERVALS NOT TO EXCEED 120'.
 - CONTRACTION JOINTS:
OPEN TYPE JOINTS:
OPEN TYPE CONSTRUCTION JOINTS SHALL BE FORMED BY STAKING A METAL BULKHEAD IN PLACE AND DEPOSITING THE CONCRETE ON BOTH SIDES. AFTER THE CONCRETE HAS SET SUFFICIENTLY TO PRESERVE THE WIDTH AND THE SHAPE OF THE JOINT, THE BULKHEAD SHALL BE REMOVED. AFTER THE SIDEWALK HAS BEEN FINISHED OVER THE JOINT, THE SLOT SHALL BE FINISHED WITH A TOOL HAVING A 1/2" RADIUS.
SAWED JOINTS:
A SLOT APPROXIMATELY 3/16" WIDE AND NOT LESS THAN 1" DEEP AT 10' CENTERS SHALL BE CUT WITH A CONCRETE SAW AFTER THE CONCRETE HAS SET.
 - SIDEWALKS ALONG OTHER STREETS SHALL BE CONSTRUCTED AND DEDICATED AS REQUIRED BY THE APPROVING AUTHORITY WHEN NECESSARY TO CONTINUE AN EXISTING OR PROPOSED SIDEWALK.
 - HANDICAP RAMPS SHALL MEET FLORIDA ACCESSIBILITIES STANDARDS, AND SECTIONS 301.0, 301.1 AND 301.2.
 - ALL SIDEWALKS ON R/W WITH 10' OF AN EXISTING OR PROPOSED TREE THAT WILL EXCEED 6" IN DIAMETER AT MATURITY SHALL BE 5" THICK AND CONTAIN 2-#3 REBAR CENTERED VERTICALLY AND SPACED 3' ON CENTER. PALMS ARE NOT CONSIDERED TREES.
- *NOTE: FOR COMPLETE SIDEWALK DETAILS, SEE FDOT DESIGN STANDARDS, 2013 EDITION, INDEX 304, SHEETS 1 THROUGH 6 AND INDEX 310, SHEETS 1 & 2.
- CONCRETE DRIVEWAY REPLACEMENT SHALL BE 6" CLASS I CONCRETE, 3000 PSI MIN. W/ FIBER.

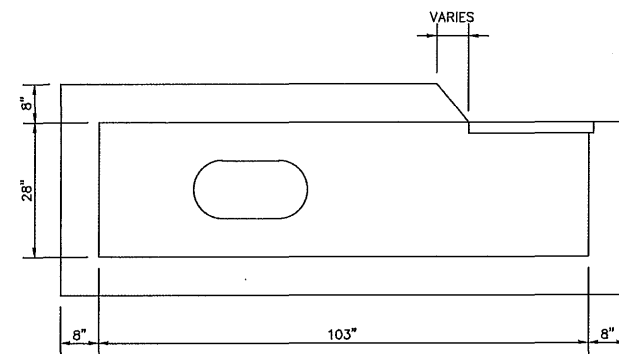

MODIFIED DITCH BOTTOM INLET DETAIL
SECTION VIEW

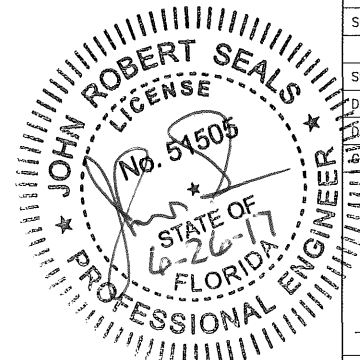

MANATEE COUNTY, FLORIDA
PUBLIC WORKS DEPARTMENT
ENGINEERING SERVICES



1022 26th Avenue East
Bradenton, FL 34208

26TH STREET EAST SIDEWALK FROM 9TH AVE DRE TO 16TH AVE E MANATEE COUNTY, FL TYPICAL SECTION & DRAINAGE DETAIL

NO.	REVISION DESCRIPTION	BY	DATE
PROJECT #	9012219		
SURVEY #	000		
SEC./TWN./RGE	12/34S/17E		
SCALE	AS SHOWN		
	BY	DATE	
SURVEYED	-----	-----	
DESIGNED	JRS, MDS	5/19/17	
DRAWN	MDS	5/19/17	
CHECKED	JRS	5/19/17	
	JOHN SEALS, P.E.		
	FLORIDA P.E. # 51505		
	Signature & Date		
	SHEET 5		

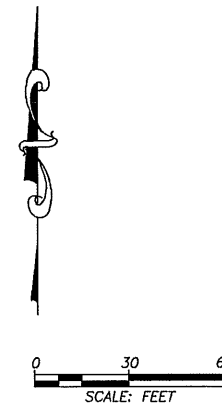
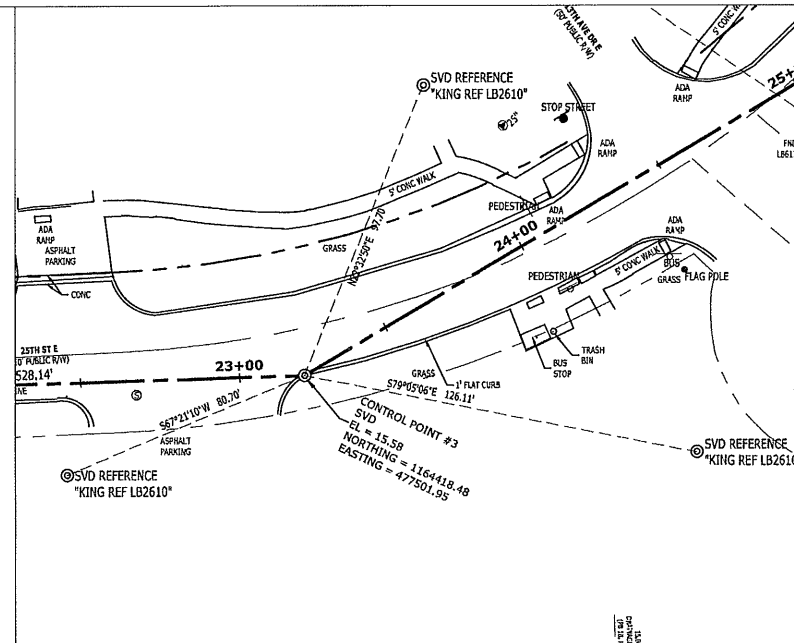

**26TH STREET EAST SIDEWALK
FROM 9TH AVE DR E TO 16TH AVE E
MANATEE COUNTY, FL
HORIZONTAL & VERTICAL CONTROL**

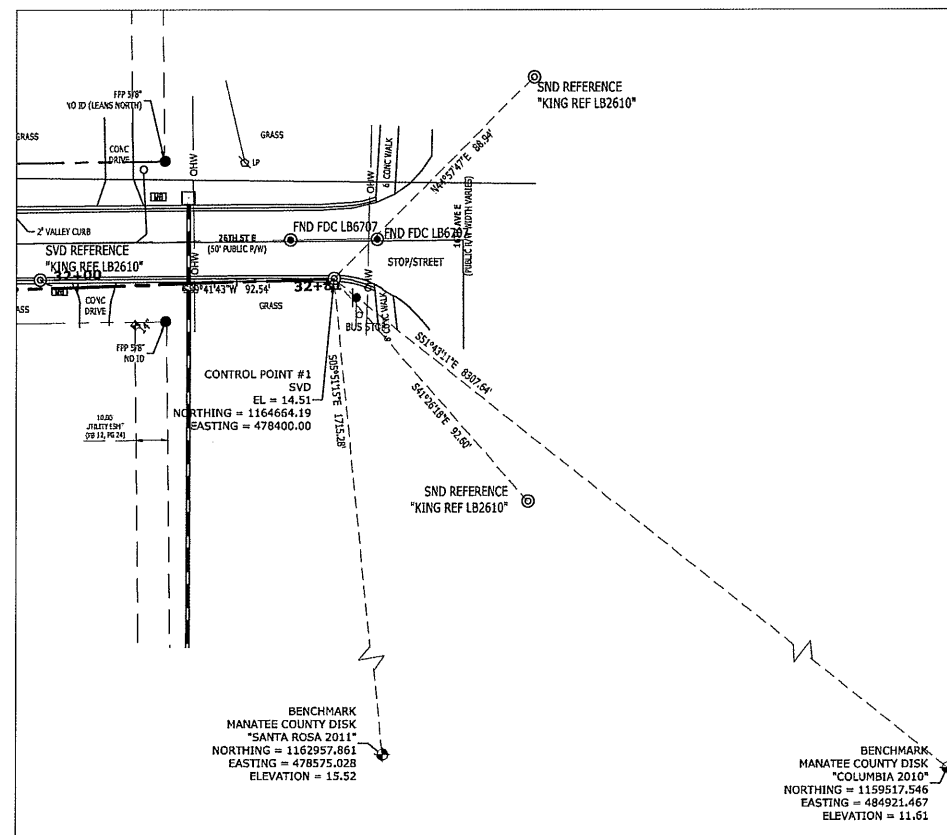

- NOTES:
1. TYPE OF SURVEY: TOPOGRAPHIC SURVEY. ANY USE OF THIS SURVEY FOR PURPOSES OTHER THAN WHICH IT WAS INTENDED, WITHOUT WRITTEN VERIFICATION, WILL BE AT THE USER'S SOLE RISK AND WITHOUT LIABILITY TO THE SURVEYOR. NOTHING HEREIN SHALL BE CONSTRUED TO GIVE ANY RIGHTS OR BENEFITS TO ANYONE OTHER THAN THOSE CERTIFIED TO.
 2. THIS SURVEY WAS PREPARED WITHOUT THE BENEFIT OF A COMMITMENT FOR TITLE INSURANCE.
 3. NO INSTRUMENTS OF RECORD REFLECTING EASEMENTS, RIGHTS-OF-WAY, AND/OR OWNERSHIP WERE FURNISHED TO OR PURSUED BY THE UNDERSIGNED OTHER THAN THOSE SHOWN HEREON. EASEMENTS OR RESTRICTIONS OF RECORD OTHER THAN THOSE SHOWN HEREON MAY EXIST.
 4. NO EXCAVATION WAS PERFORMED TO VERIFY THE LOCATION OR EXISTENCE OF ANY UNDERGROUND IMPROVEMENTS, STRUCTURES, OR FOUNDATIONS. UNDERGROUND UTILITIES SHOWN HEREON ARE SHOWN PER ABOVE GROUND EVIDENCE AND/OR RECORD DRAWINGS OR MUNICIPAL ATLAS INFORMATION AND THE LOCATION OF ALL UNDERGROUND UTILITY LINES ARE APPROXIMATE ONLY. THIS DOCUMENT SHOULD NOT BE RELIED UPON FOR EXCAVATION OR CRITICAL DESIGN FUNCTIONS WITHOUT FIELD VERIFICATION OF UNDERGROUND UTILITY LOCATIONS. UTILITIES OTHER THAN THOSE SHOWN HEREON MAY EXIST.
 5. THIS SURVEY IS NOT INTENDED TO SHOW THE LOCATION OR EXISTENCE OF ANY JURISDICTIONAL, HAZARDOUS OR ENVIRONMENTALLY SENSITIVE AREAS.
 6. ADDITIONS OR DELETIONS TO SURVEY MAPS OR REPORTS BY OTHER THAN THE SIGNING PARTY OR PARTIES IS PROHIBITED WITHOUT WRITTEN CONSENT OF THE SIGNING PARTY OR PARTIES.
 7. STATE PLANE COORDINATES SHOWN HEREON (FL83-WF) WERE DERIVED BY GLOBAL POSITIONING SYSTEM (GPS) OBSERVATIONS UTILIZING A VIRTUAL REFERENCE STATION REAL TIME NETWORK (RTN) SOLUTION, AND THE PRODUCT OF REDUNDANT OBSERVATION SESSIONS CONSISTING OF AT LEAST 60 EPOCHS EACH, AND INCLUDED MANATEE COUNTY SURVEY CONTROL STATION "SANTA ROSA" NORTH AMERICAN DATUM OF 1983 NORTH AMERICAN DATUM 83 (2011).
 8. SEE DRAWING FOR ON SITE TEMPORARY BENCHMARKS (T.B.M.).
 9. ELEVATIONS SHOWN HEREON ARE IN FEET AND ARE BASED ON THE NORTH AMERICAN VERTICAL DATUM OF 1988 (NAVD 88). CONTROL MONUMENTS UTILIZED ARE DESIGNATED AS "SANTA ROSA" (PID = D04869), HAVING A PUBLISHED ELEVATION OF 15.52 FEET ADJUSTED, AS PUBLISHED BY THE MANATEE COUNTY SURVEY DEPARTMENT.
 10. BEARINGS AND STATE PLANE COORDINATES SHOWN HEREON (FLORIDA WEST ZONE) WERE DERIVED BY GLOBAL POSITIONING SYSTEM (GPS) OBSERVATIONS UTILIZING A VIRTUAL REFERENCE STATION REAL TIME NETWORK (RTN) SOLUTION, AND THE PRODUCT OF MULTIPLE OBSERVATION SESSIONS CONSISTING OF AT LEAST 60 EPOCHS EACH, AND INCLUDED NATIONAL GEODETIC SURVEY (NGS) CONTROL STATION "SANTA ROSA" NORTH AMERICAN DATUM 83 (2011).
 11. RIGHT-OF-WAY, PROPERTY AND EASEMENT INFORMATION SHOWN HEREON IS ACCORDING TO THE APPROPRIATE SUBDIVISION PLATS OF THE PUBLIC RECORDS OF MANATEE COUNTY, FLORIDA.
 12. 12. COORDINATES AND DISTANCES SHOWN HEREON ARE IN U.S. SURVEY FEET.

NO.	REVISION DESCRIPTION	BY	DATE
	PROJECT #		9012219
	SURVEY #		000
	SEC./TWN./RGE		12/34S/17E
	SCALE		AS SHOWN
	SUBMITTED		DATE
	DESIGNED	JRS MDS	5/19/17
	DRAWN	JRS	5/19/17
	CHECKED	JRS	5/19/17
	JOHN SEARS, P.E. FLORIDA STATE BOARD OF PROFESSIONAL ENGINEERS No. 6-51505 Signature and Date		
	SHEET 6		

SEC. TOWN/RGE	22 34S 71E
SCALE	AS SHOWN
PROFESSIONAL ENGINEER STATE OF FLORIDA NO. 51503 JOHN SEASS, P.E.	
SURVEYED	
DESIGNED	JRS. MDS 5/19/78
DRAWN	JRS 7/19/77
CHECKED	JRS 5/19/77
JOHN SEASS, P.E. STATE OF FLORIDA NO. 51503 FLORIDA	
Signature & Date	

C:\PW-Civil\B261\100\001\Production Drawings\PLP\B261.dwg; PUN-1, 5/25/2017 3:45 PM Michael D. Schofield, 12:59:49, ANSI A (8.50 x 11.00 inches)

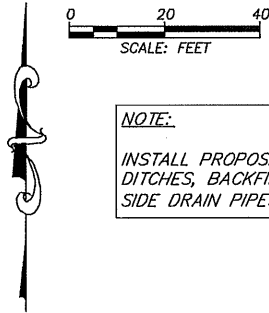

NOTE:
INSTALL PROPOSED 18" RCP IN ALL EXISTING ROADSIDE DITCHES, BACKFILL DITCHES, AND REMOVE ALL EXISTING SIDE DRAIN PIPES (FROM BEGIN PROJECT TO STA 16+60)

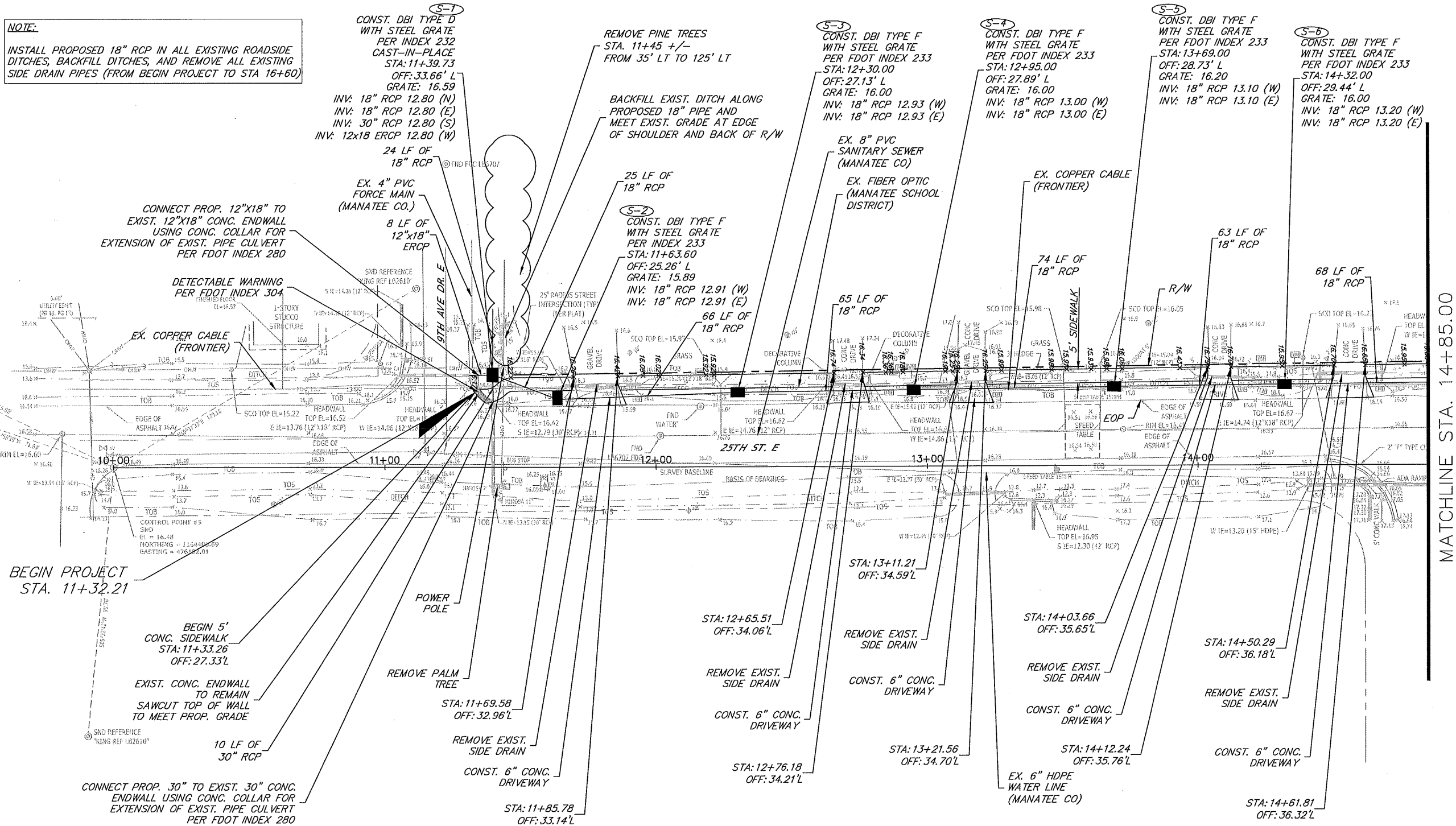

MATCHLINE STA. 14+85.00



**26TH STREET EAST SIDEWALK
FROM 9TH AVE DR E TO 16TH AVE E
MANATEE COUNTY, FL
SIDEWALK PLAN (1)**

NO.	REVISION DESCRIPTION	BY	DATE

PROJECT #	9012219
SURVEY #	000
SEC./TWN./RGE	12/34S/17E
SCALE	AS SHOWN
SURVEYED	BY DATE
DESIGNED	JRS, MDS 5/19/17
DRAWN	MDS 5/19/17
CHECKED	JRS 5/19/17
JOHN SEALS, P.E.	FLORIDA P.E. # 51505

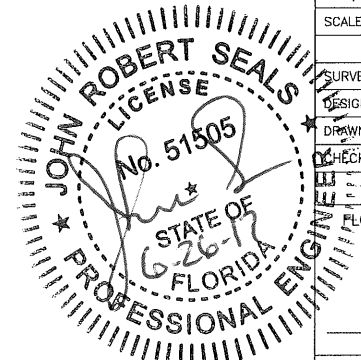

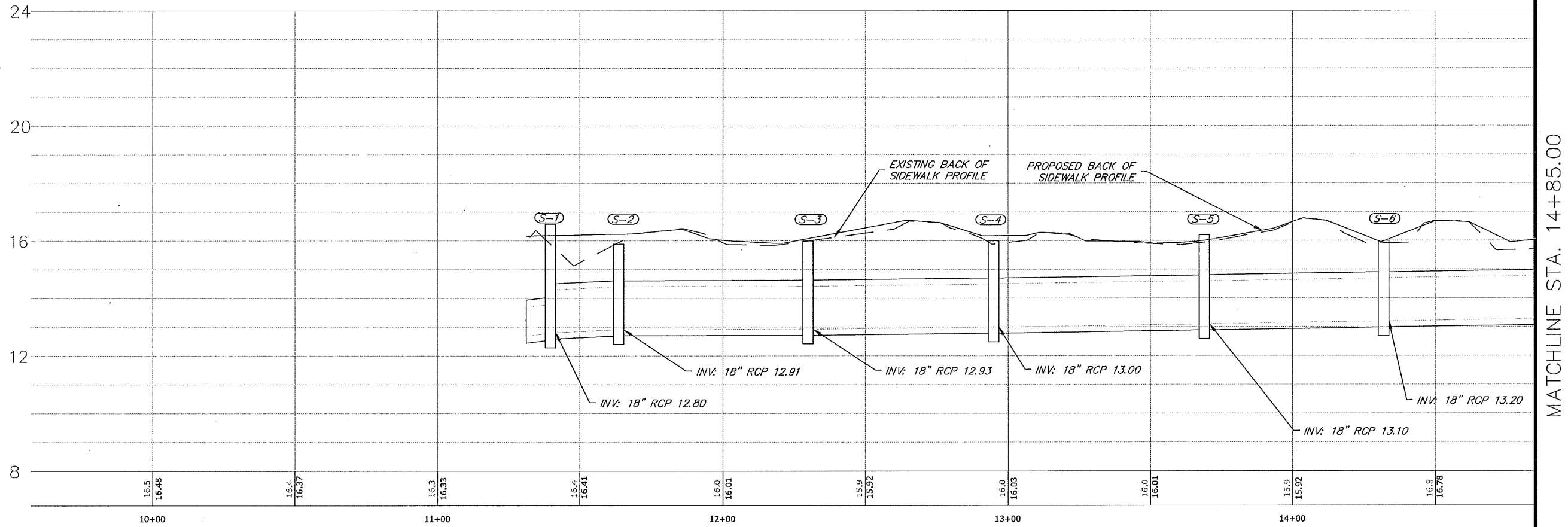

MATCHLINE STA. 14+85.00



1022 26th Avenue East
Brdenton, FL 34208

**26TH STREET EAST SIDEWALK
FROM 9TH AVE DR E TO 16TH AVE E
MANATEE COUNTY, FL
SIDEWALK PROFILE (1)**

DATE									
BY									
REVISION									
DESCRIPTION									
NO.									
PROJECT #		9012219							
SURVEY #		000							
SEC./TWN./RGE		12/34S/17E							
SCALE		AS SHOWN							
		BY			DATE				
SURVEYED		---			---				
DESIGNED		JRS, MDS			5/19/17				
DRAWN		MDS			5/19/17				
CHECKED		JRS			5/19/17				
JOHN SEALS, P.E.									
FLORIDA P.E. # 51505									
Signature & Date									
SHEET 8									

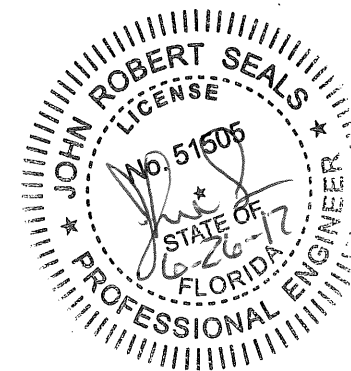



1022 26th Avenue East
Bradenton, FL 34208

**26TH STREET EAST SIDEWALK
FROM 9TH AVE DR E TO 16TH AVE E
MANATEE COUNTY, FL
SIDEWALK PLAN (2)**

[illegible]

PROJECT #	9012219	
SURVEY #	000	
SEC./TWN./RGE	12/34S/17E	
SCALE	AS SHOWN	
	BY	DATE
SURVEYED	-----	-----
DESIGNED	JRS, MDS	5/19/17
DRAWN	MDS	5/19/17
CHECKED	JRS	5/19/17

JOHN SEALS, P.E.
FLORIDA P.E. # 51505

Signature & Date

SHEET 9

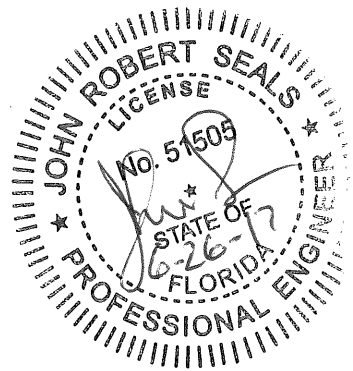
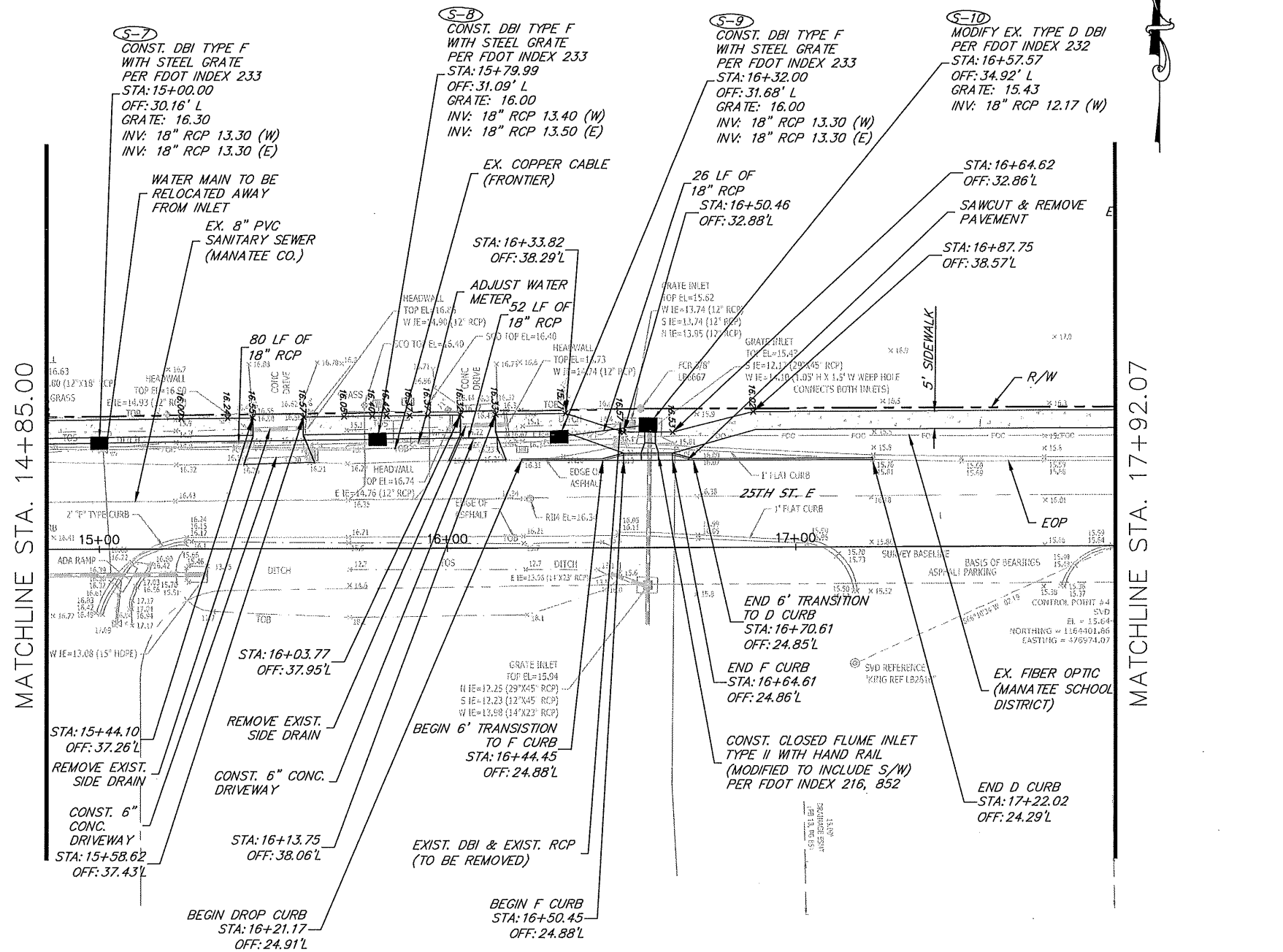

JOHN SEALS, P.E.
FLORIDA P.E. # 51505

Signature & Date

SHEET 10

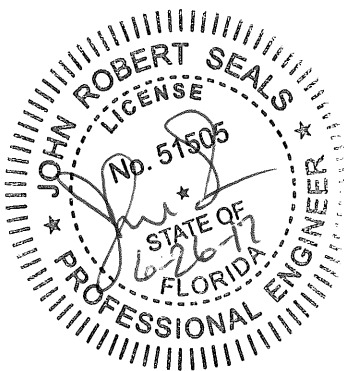

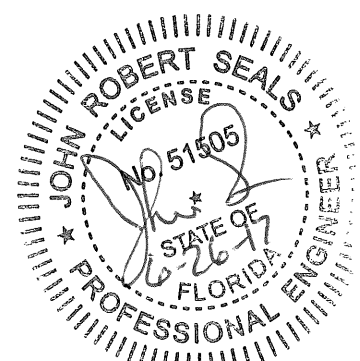
[illegible]

C:\PIU-Civil\2017\100\001\Production Drawings\PIU\PIU000.dwg PROFILE-3, 5/26/2017 3:49 PM Michael D. Seinfeld, 125949, AIA 850 x 1100 Inches

MATCHLINE STA. 17+92.07

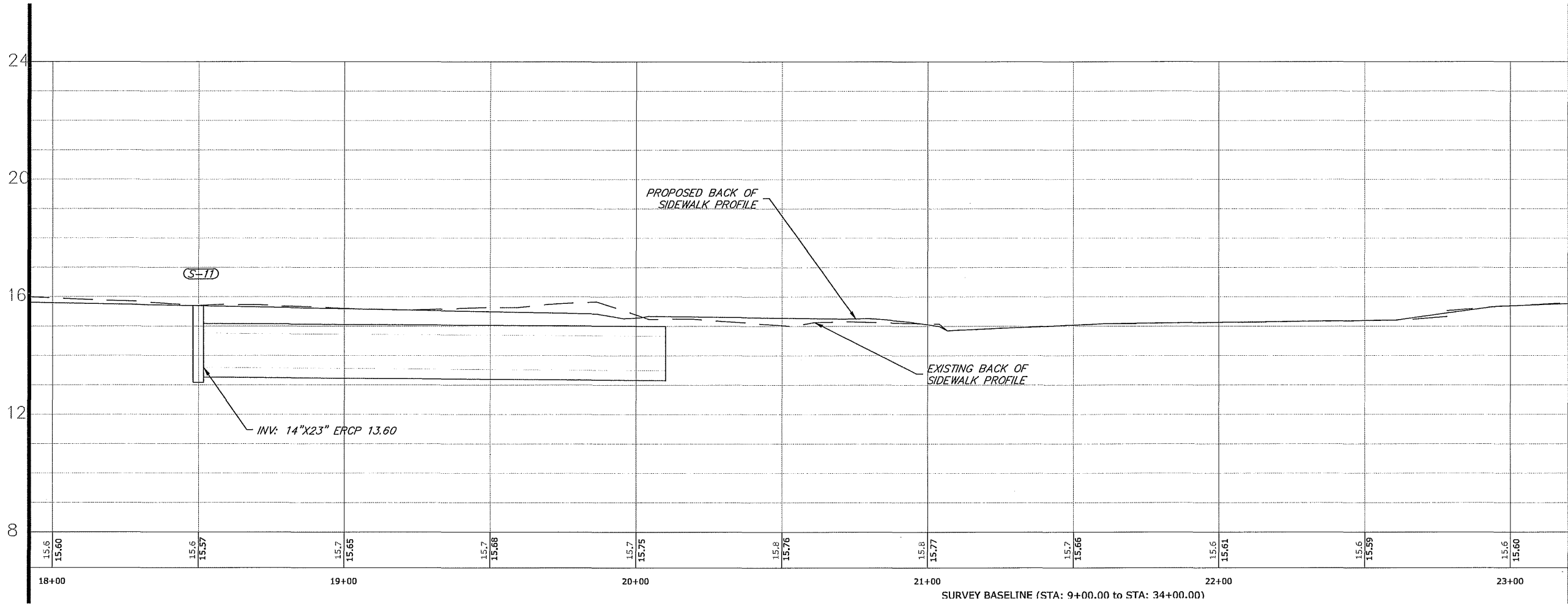

MATCHLINE STA. 23+20.20

**26TH STREET EAST SIDEWALK
FROM 9TH AVE DRE TO 16TH AVE E
MANATEE COUNTY, FL
SIDEWALK PROFILE (3)**

MANATEE COUNTY, FLORIDA
PUBLIC WORKS DEPARTMENT
ENGINEERING SERVICES



1022 26th Avenue East
Bradenton, FL 34208

NO.	REVISION DESCRIPTION	BY	DATE

PROJECT #	9012219		
SURVEY #	000		
SEC./TWN./RGE	12/34S/17E		
SCALE	AS SHOWN		
	BY	DATE	
SURVEYED	-----	-----	
DESIGNED	JRS, MDS	5/19/17	
DRAWN	MDS	5/19/17	
CHECKED	JRS	5/19/17	

JOHN SEALS, P.E.
FLORIDA P.E. # 51505

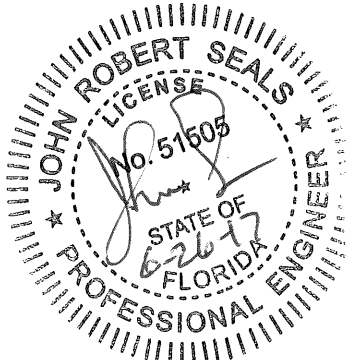

Signature & Date

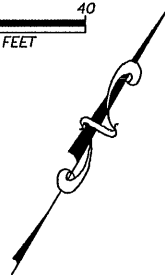

Manatee
County
FLORIDA

**26TH STREET EAST SIDEWALK
FROM 9TH AVE DRE TO 16TH AVE E
MANATEE COUNTY, FL
SIDEWALK PLAN (4)**

SIDEWALK PLAN (4)

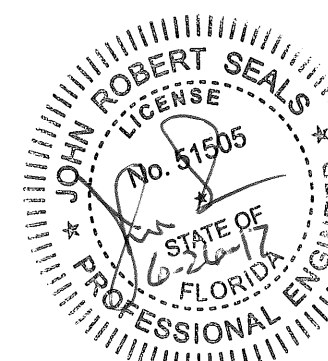
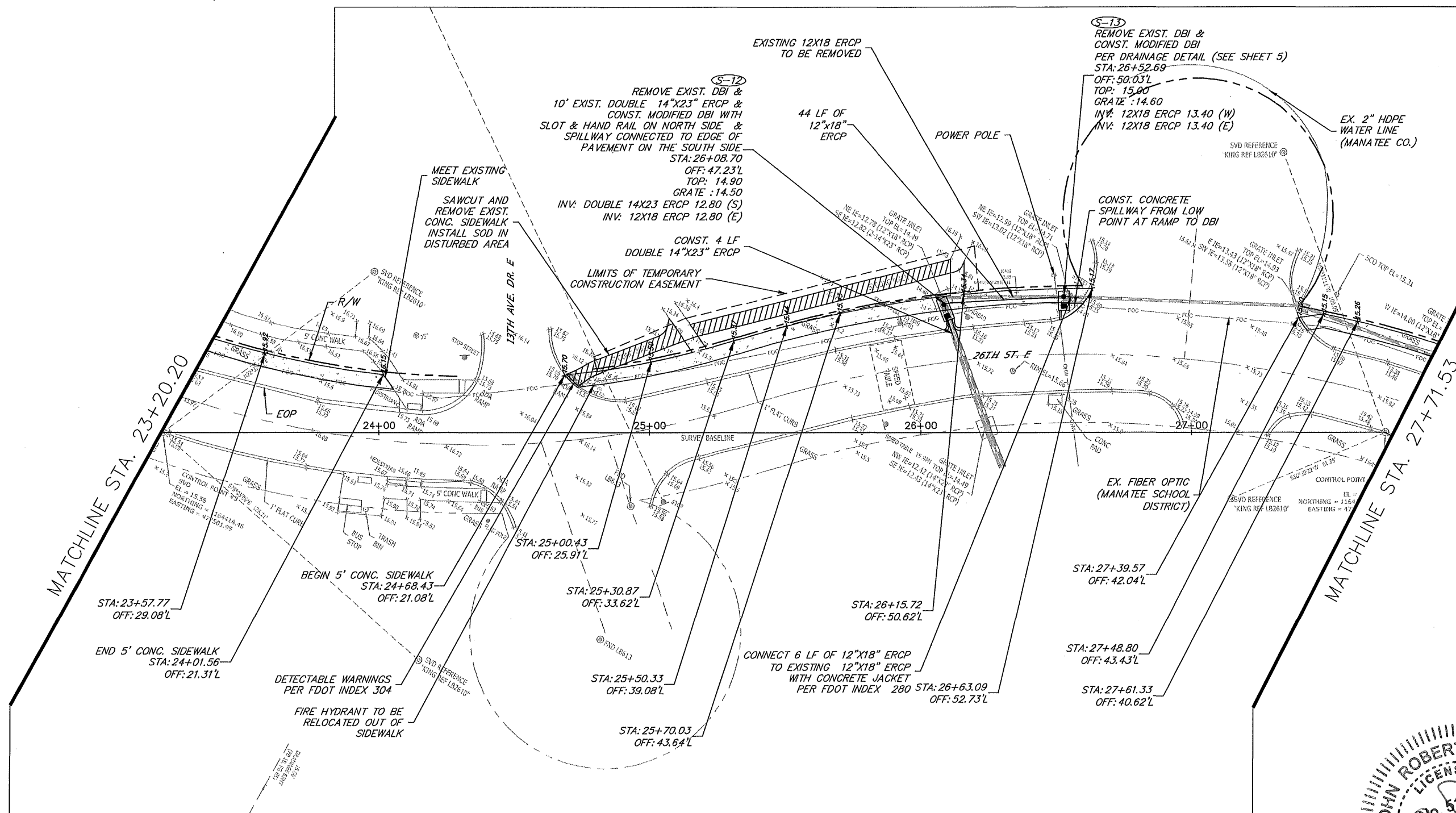
[illegible]

PROJECT #	9012219	
SURVEY #	000	
SEC./TWN./RGE	12/34S/17E	
SCALE	AS SHOWN	
	BY	DATE
SURVEYED	-----	-----
DESIGNED	JRS, MDS	5/19/90
DRAWN	MDS	5/19/90
CHECKED	JRS	5/19/90

JOHN SEALS, P.E.
FLORIDA P.E. # 51505

Signature & Date

SHEET 13

3- PW-Civil 828 100 001 Production Drawings PI 8890 run PLAN 4 6/26/2017 3:40 PM Michael O. Schofield 1-2 5840 ANSIA (B 50 11 00 1000000)

C:\PIU-Civil\5281\1\00\001\Production\Drawings\PIU\PIU02.dwg PROFILE-4, 6/26/2017 3:49 PM Michael D. Schofield, 1:2.5449, ANSI A (8.50 x 11.00 inches)

MATCHLINE STA. 23+20.20

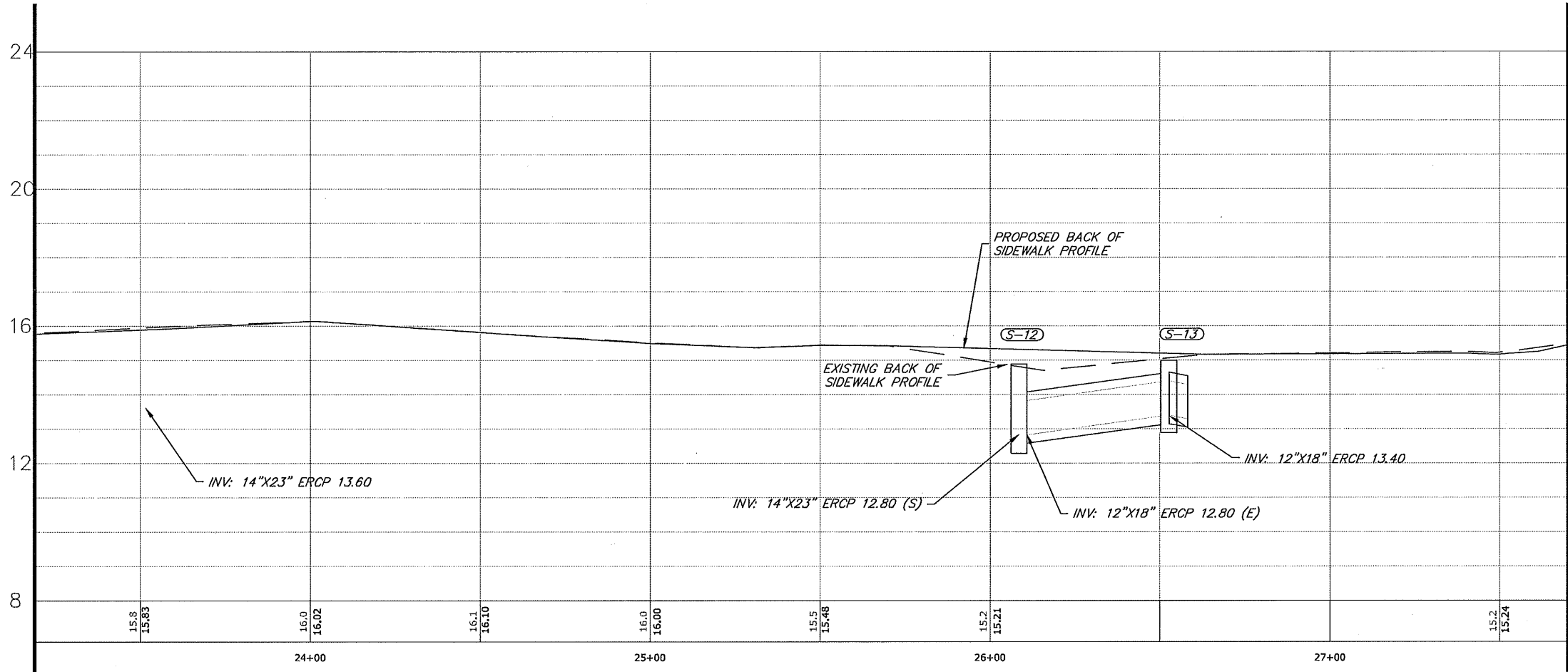

MATCHLINE STA. 27+71.53

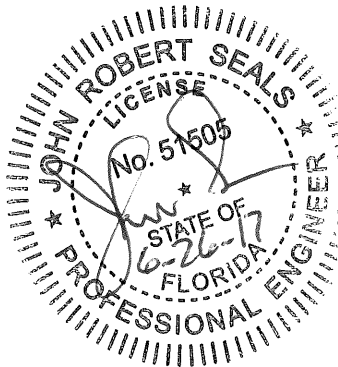

MANATEE COUNTY, FLORIDA
PUBLIC WORKS DEPARTMENT
ENGINEERING SERVICES



1022 26th Avenue East
Bradenton, FL 34208

26TH STREET EAST SIDEWALK
FROM 9TH AVE DR E TO 16TH AVE E
MANATEE COUNTY, FL
SIDEWALK PROFILE (4)

DATE	BY	REVISION DESCRIPTION		NO.
PROJECT #			9012219	
SURVEY #			000	
SEC./TWN./RGE			12/34S/17E	
SCALE			AS SHOWN	
		BY	DATE	
SURVEYED		-----	-----	
DESIGNED		JRS, MDS	5/19/17	
DRAWN		MDS	5/19/17	
CHECKED		JRS	5/19/17	
JOHN SEALS, P.E.				
FLORIDA P.E. # 51505				
Signature & Date				
SHEET 14				

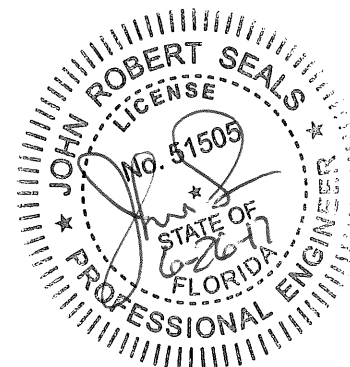

NO.							
REVISION DESCRIPTION							
BY							
DATE							
PROJECT #	9012219						
SURVEY #	000						
SEC./TWN./RGE	12/34S/17E						
SCALE	AS SHOWN						
	BY		DATE				
SURVEYED	-----		-----				
DESIGNED	JRS, MDS	5/19/17					
DRAWN	MDS	5/19/17					
CHECKED	JRS	5/19/17					
JOHN SEALS, P.E.							
FLORIDA P.E. # 51505							
Signature & Date							
SHEET 15							

C:\PIV-Gal\5281\100\00\Production\Drawings\PIPR00.dwg PROFILE-5, 6/25/2017 3:49 PM Michael D. Schofield, 125849, ANSI A (6.50 x 11.00 inches)

MATCHLINE STA. 27+71.53

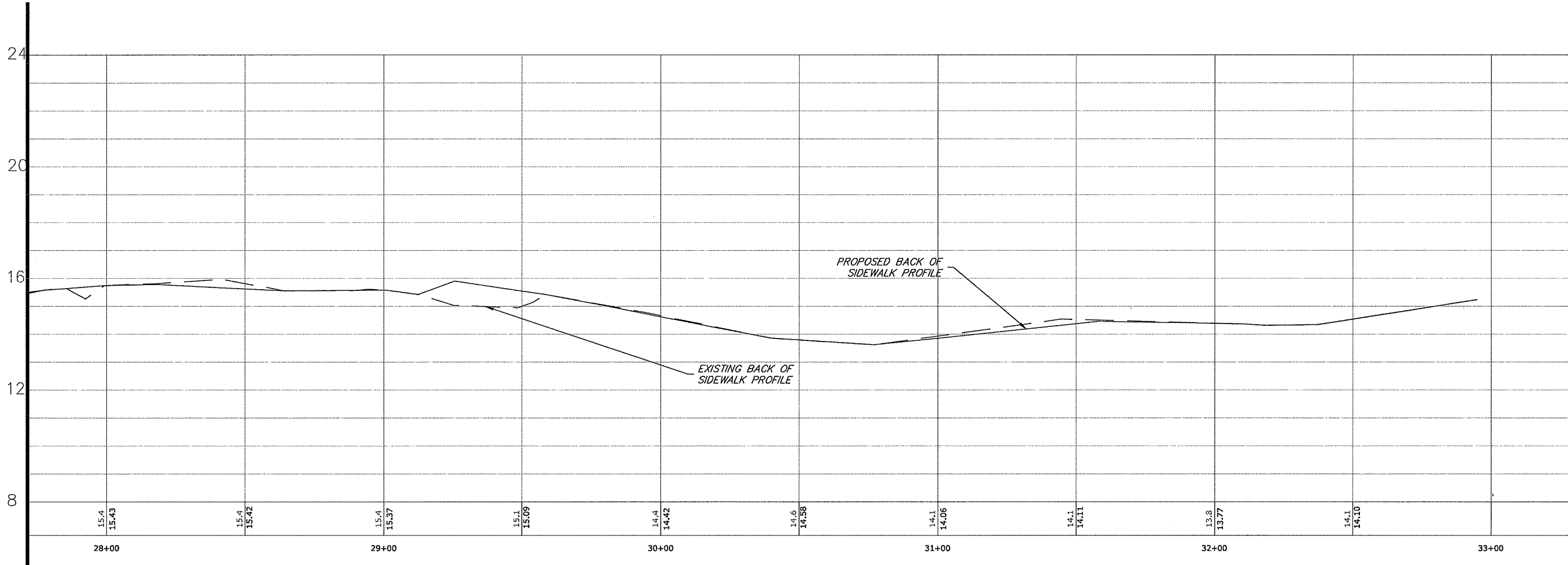

**26TH STREET EAST SIDEWALK
FROM 9TH AVE DR E TO 16TH AVE E
MANATEE COUNTY, FL
SIDEWALK PROFILE (5)**

NO.	REVISION DESCRIPTION	BY	DATE
PROJECT #	9012219		
SURVEY #	000		
SEC./TWN./RGE	12/34S/17E		
SCALE	AS SHOWN		
SURVEYED	-----	BY	DATE
DESIGNED	JRS, MDS	5/19/17	
DRAWN	MDS	5/19/17	
CHECKED	JRS	5/19/17	
JOHN SEALS, P.E.			
FLORIDA P.E. # 51505			
Signature & Date			
SHEET 16			

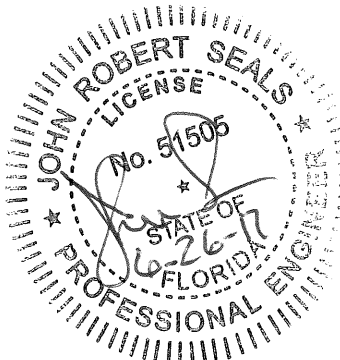

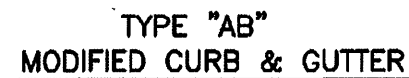

- | | | | |
|--|--|-------------------------------------|-------|
| MANATEE COUNTY
TRANSPORTATION DEPARTMENT | | TYPE "AB" MODIFIED
CURB & GUTTER | 201.3 |
| REV.BY

 | DATE

6/12/07
DATE OF B.O.C.C. APPROVAL | | |

Page T-112

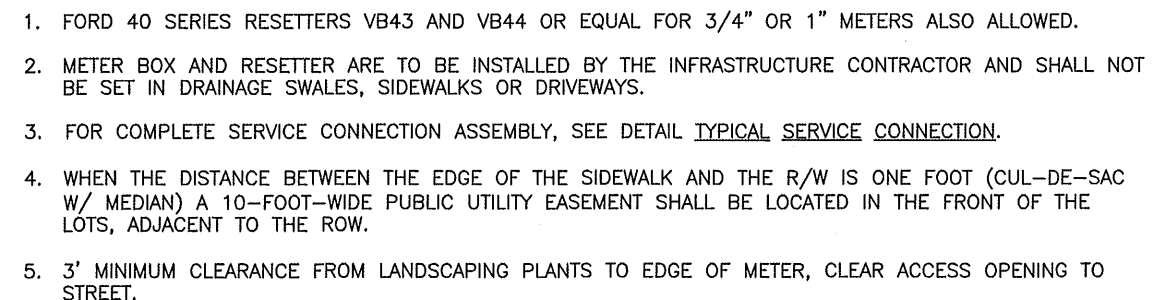

MANATEE COUNTY PUBLIC WORKS DEPARTMENT		METER BOX ASSEMBLY FOR 5/8" X 3/4", 3/4" & 1" METERS	UW-17 PAGE 135
REV. BY	DATE		
CLB/BR	11/10		
	MAY 10, 2011 <hr/> DATE OF APPROVAL		