

COPYRIGHT 2010 MANATEE COUNTY GOVERNMENT | S:\P\WD_Engineering_Share\Util_Eng_Design\PROJ\~SAR SWR Proj\San Swr - LS Upgrades\MLS 1D Rehab\DWG\~MLS 1D.dwg, Cover, 5/27/2016 10:26 AM Shea Shoun, 1:1, ANSI full bleed D (34.00 x 22.00 inches)

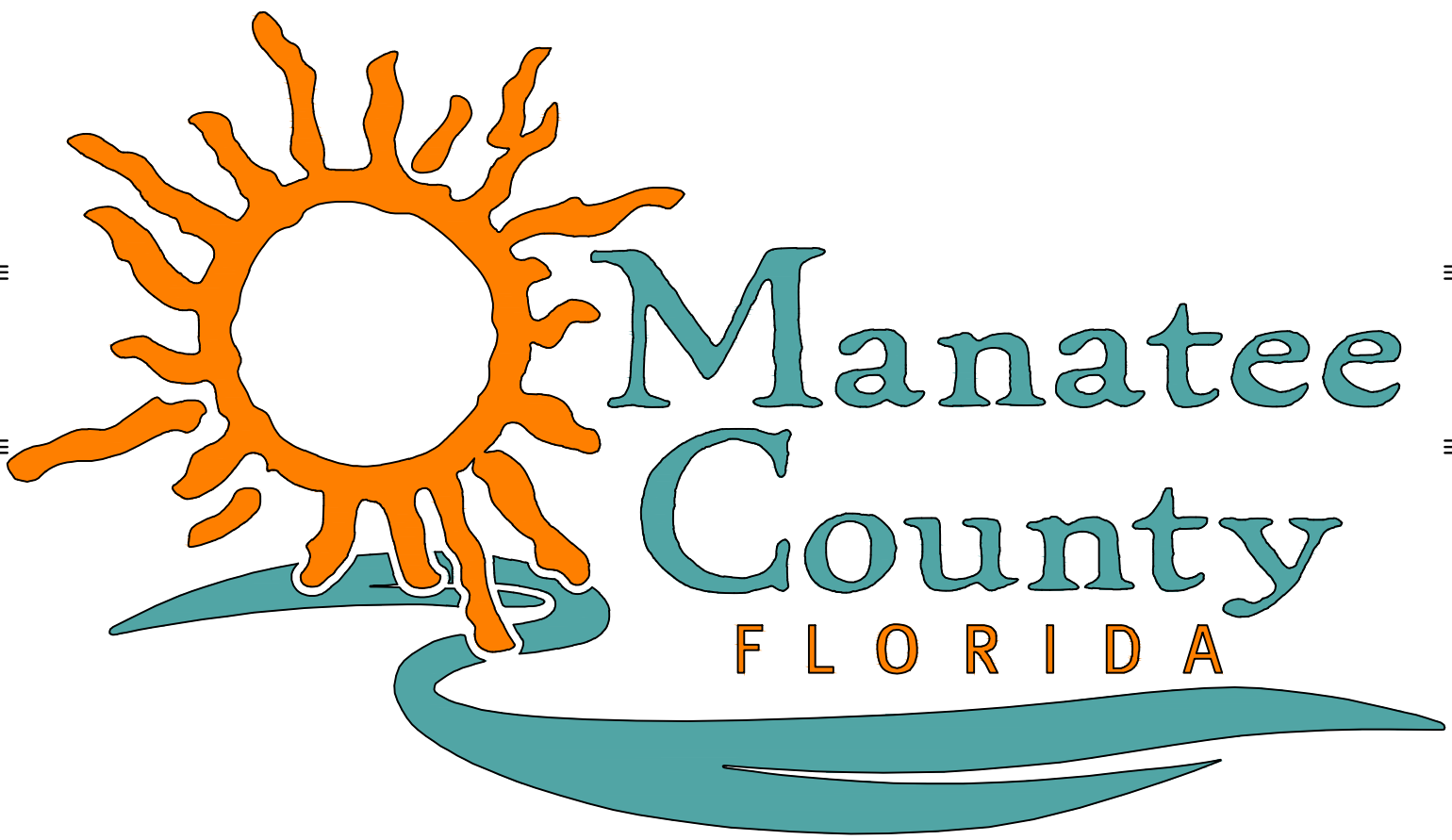

CONFINED
SPACE ENTRY
PERMIT
REQUIRED

LIFT STATION UPGRADE MASTER LIFT STATION 1D REHAB 404.6060789

PROJECT DESCRIPTION

REMOVE AND REPLACE EXISTING WET WELL FIBERGLASS DECKING AND ISOLATION GATES.

REMOVE AND REPLACE EXISTING WET WELL ALUMINUM SAFETY RAIL SYSTEM WITH A BASIC IN-LINE TWO-RAIL FIBERGLASS GUARDRAIL SYSTEM THAT MEETS OR EXCEEDS CURRENT OSHA REQUIREMENTS.

REMOVE EXISTING FIBERGLASS PROTECTIVE LINER.

REPAIR, REHAB EXISTING WET WELL CONCRETE STRUCTURE AND APPLY NEW PROTECTIVE SPRAY LINER.

REMOVE AND REPLACE EXISTING WET WELL LIGHTS WITH LED EXPLOSION-PROOF (CLASS I, DIVISION I).

REMOVE AND REPLACE EXISTING DIMMINUTOR, CONTROL PANEL, ACCESS HATCHES, AND BAR SCREEN.

REMOVE AND INSTALL NEW EXTERIOR LIGHTING, CONDUIT, ETC ALONG THE NORTH SIDE OF THE MLS BUILDING.

REMOVE AND REPLACE EXISTING MAIN ACCESS DOUBLE DOORS AND WET WELL ACCESS DOOR WITH NEW ALUMINUM DOORS AND FRAMES.

REMOVE AND REPLACE ODOR CONTROL CONCRETE CONTAINMENT PAD/FOUNDATION.

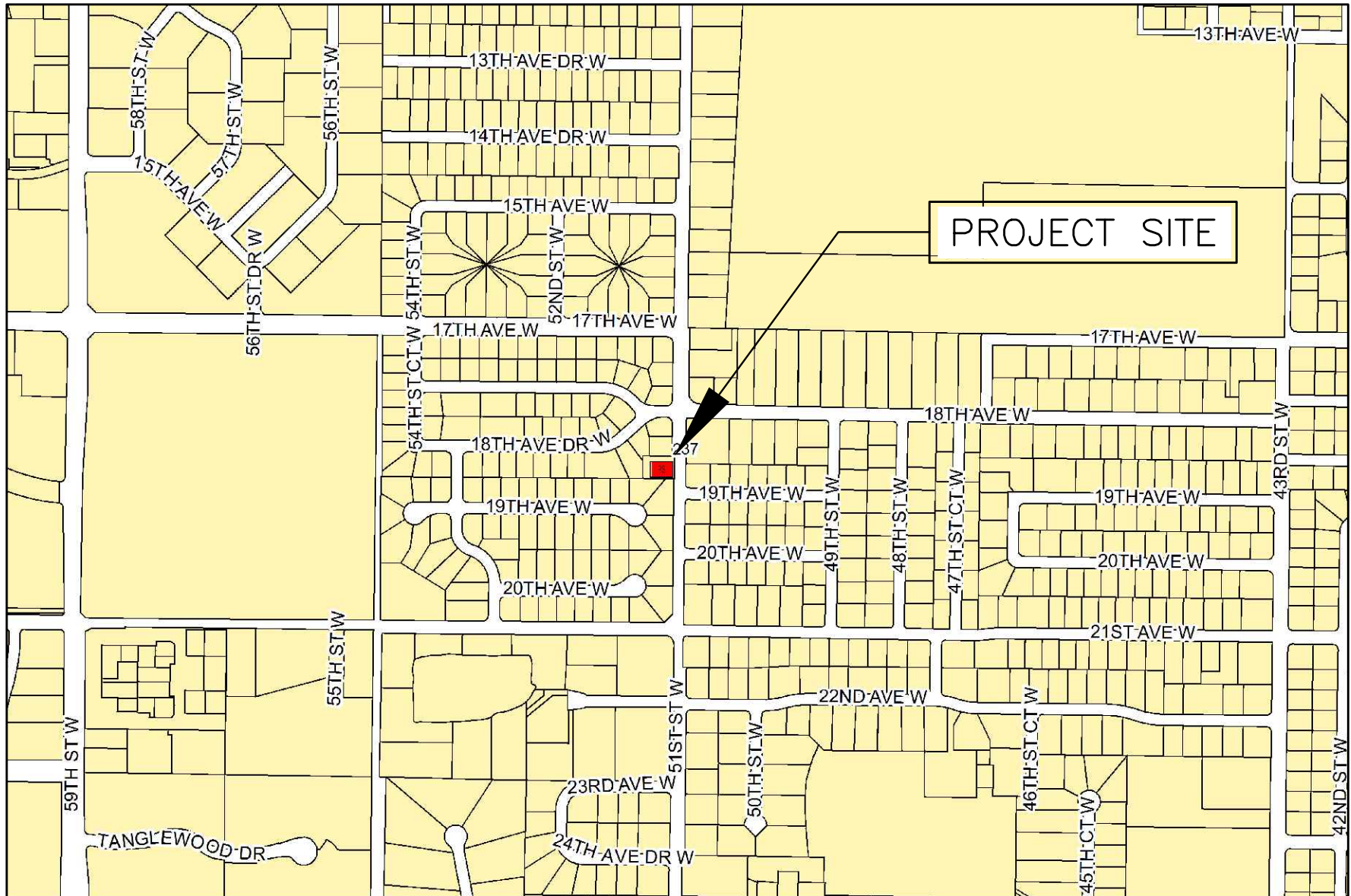

VICINITY MAP
N.T.S.

MAY 2016

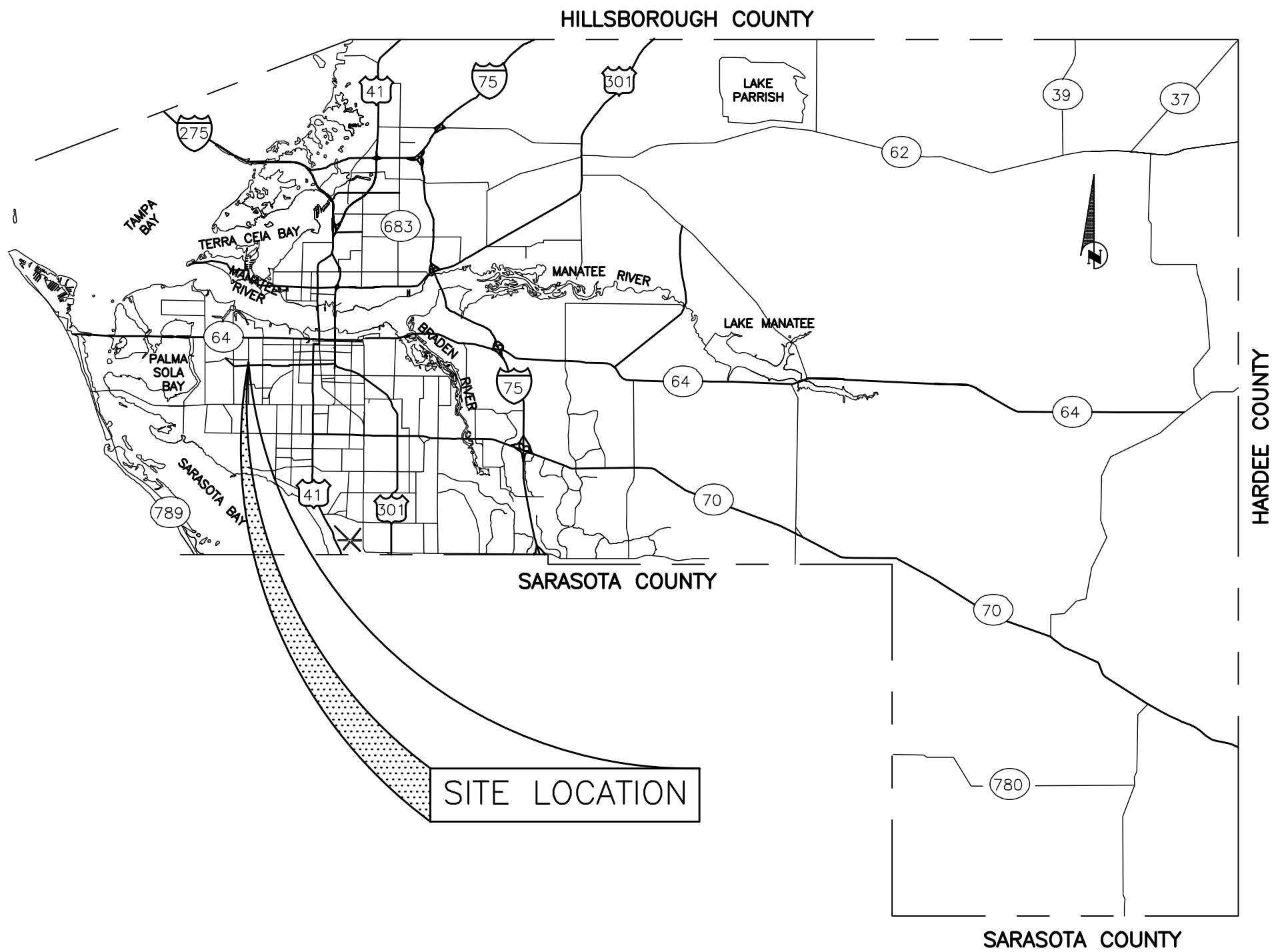

100% PLANS

NO.	INDEX OF SHEETS
1.	COVER SHEET
2.	PLAN VIEWS
3.	SECTION VIEWS
4.	WET WELL DETAILS
5.	ODOR CONTROL CONTAINMENT (EVOQUA) DETAILS

MASTER LIFT STATION 1D	
ITEM	VALUE
RTU	RTU 237
STREET ADDRESS	1806 51ST STREET WEST
CITY	BRADENTON
SEC./TWN./RGE	32/34/17
DESIGN FLOW	2,609 GPM @ 126' TDH
EXISTING ACCESS HATCH CLEAR OPENING DIMENSIONS *	31" X 29.5" & 31" X 28.5"
INFLUENT CHANNEL DIMENSIONS *	4' DEEP X 2'-3.5" WIDE

* CONTRACTOR SHALL FIELD VERIFY ALL DIMENSIONS

NO.	REVISION DESCRIPTION	BY	DATE
PROJECT #	404.6060789		
SURVEY #	-		
SEC./TWN./RGE	32/34/17		
SCALE	N.T.S.		
	BY	DATE	
SURVEYED	-	-	
DESIGNED	JSS	2/16	
DRAWN	JSS	2/16	
CHECKED	-	2/16	
J. SHEA SHOUN, P.E. Professional Engineer No. 60923 STATE OF FLORIDA 5/21/16			
SHEET 1 OF 5			

PLAN-GROUND FLOOR

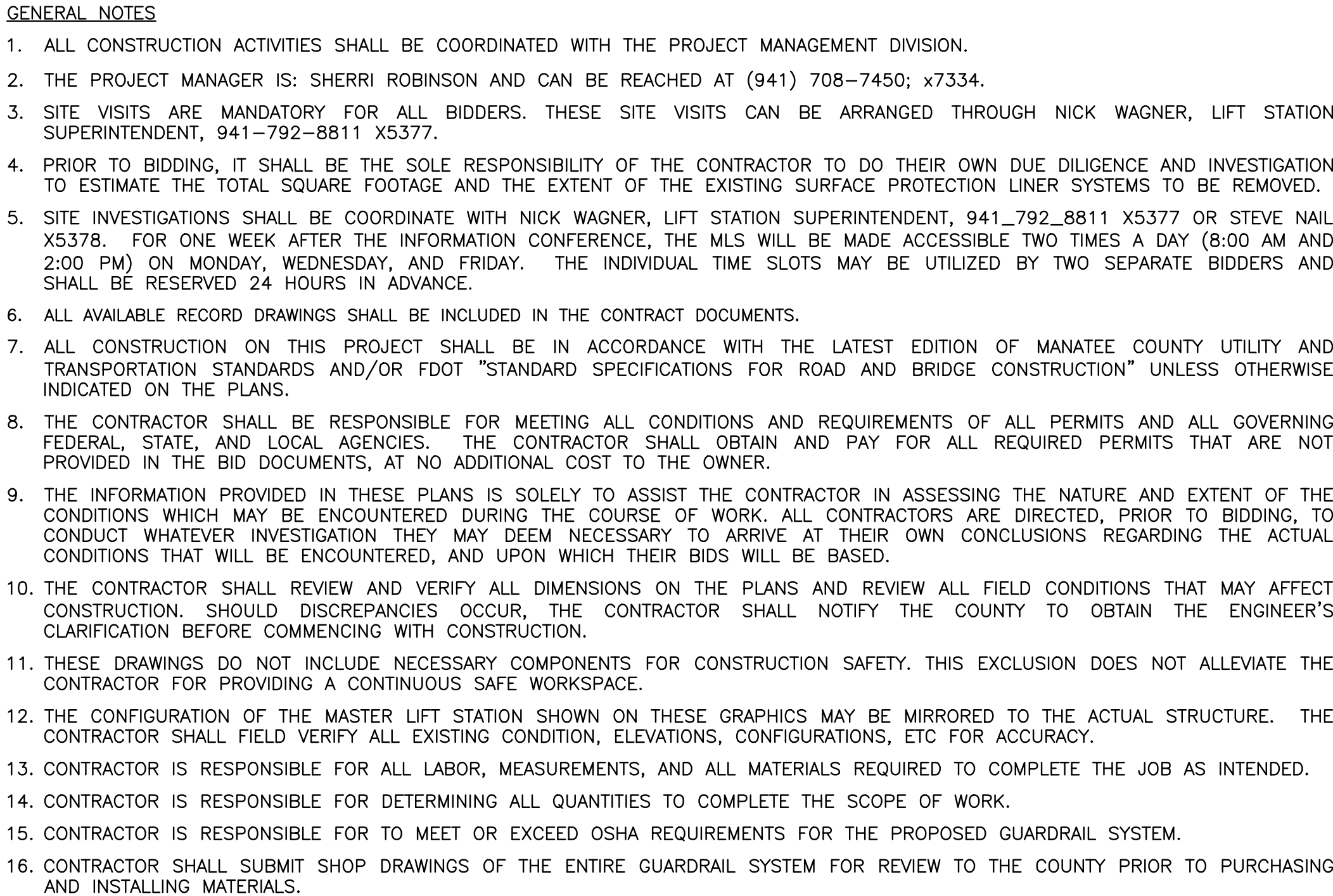

DATE	BY	REVISION DESCRIPTION	NO.	PROJECT #	404.6060789
				SURVEY #	—
				SEC./TWN./RGE	32/34/17
				VERT. SCALE	NTS
				HORIZ. SCALE	1"=4'
				BY	DATE
				SURVEYED	—
				DRAWN	JSS 2/16
				CHECKED	JSS 2/16
					— 2/16

J. SH... SH... P.E.
 JOHN S. SH...
 FLORIDA LICENSE 60923
 No. 60923
 STATE OF
 5/27/16
 FLORIDA
 PROFESSIONAL ENGINEER
 Signature of

[illegible]

J. SHEA
FLORIDA PROFESSIONAL ENGINEER
No. 60923
STATE OF
5/27/16
FLORIDA
Professional Engineer
Signature

1. ELECTRICAL LINE NEEDS TO BE ROUTED FROM THE NEW CONTROL BOX TO THE NEW DIMMINUTOR. CURRENT LINES ARE ROUTED THRU THE EX. HATCH, THIS WILL NO LONGER BE ACCEPTABLE. SEE NOTE ABOVE.
2. THE CONTRACTOR IS TO PROVIDE A COMPLETE AND OPERATIONAL UNIT, INCLUDING ALL LABOR, ASSOCIATED PARTS, FITTINGS, AND 3 O&M MANUALS.
3. SEE SPECIFICATION SECTION 16108 FOR MORE DETAILS.

**LIFT STATION UPGRADE
MASTER LIFT STATION 1D REHAB
ODOR CONTROL CONTAINMENT PAD
(EVOQUA) DETAILS**

PROJECT #	404.6060789
SURVEY #	-
SEC./TWN./RGE	32/34/17
VERT. SCALE	NTS
HORZ. SCALE	1" = 2'

J. SHAW
 JOHN S. SHAW
 FLORIDA
 No. 60923
 STATE OF
 5/27/16
 FLORIDA
 PROFESSIONAL ENGINEER
 Signature: _____ Date: _____

SHEET 5 OF 5

1. CONTRACTOR TO SUBMIT A STRUCTURAL SHOP DRAWING SIGNED AND SEALED BY A PROFESSIONAL ENGINEER LICENSED IN THE STATE OF FLORIDA PROVIDING THE REQUIRED MINIMUM THICKNESS AND REQUIRED MINIMUM REINFORCEMENT.
2. THE DESIGN DIMENSIONS AND LIVE LOAD INFORMATION HAS BEEN PROVIDED BY EVOQUA, OWNER OF ODOR CONTROL EQUIPMENT.
3. CONTRACTOR SHALL REMOVE & PROPERLY DISPOSE OF THE EXISTING CONCRETE PAD, PIPING, ETC.
4. CONTRACTOR SHALL REMOVE EXISTING EARTH AND ASPHALT FROM WITHIN 3- FEET OF THE EXISTING CONCRETE PAD, EXCEPT UNDER MLS STRUCTURE, AND SHALL PLACE SUITABLE BACKFILL MATERIAL INTO THE EXCAVATED AREA WITH A COMPACTION OF 98% OF MINIMUM MAXIMUM DENSITY AS DETERMINED BY AASHTO T-180. COUNTY SHALL SUPPLY COMPACTION TESTING.
5. CONTRACTOR SHALL PROVIDE AND INSTALL A NEW 2" THICK ASPHALT PAVEMENT IN THE REMAINING DISTURBED AREAS.
6. EXPANSION JOINTS BETWEEN CONCRETE PAD AND EXISTING STRUCTURES SHALL BE 1/2" MATERIAL AND SHALL MEET THE REQUIREMENTS OF AASHTO M153 OR AASHTO M213.
7. CONTRACTOR SHALL BE RESPONSIBLE FOR FURNISHING AND INSTALL THE CONCRETE PAD AND ANY PIPING SPECIFICALLY CALLED OUT IN THE DETAILS.
8. EVOQUA SHALL BE RESPONSIBLE FOR THE REMOVAL OF THE EXISTING EQUIPMENT PRIOR TO DEMOLITION OF THE EXISTING CONCRETE PAD AND SHALL BE RESPONSIBLE FOR ALL INSTALLATION OF NEW EQUIPMENT, PIPING (NOT SPECIFICALLY CALLED OUT IN THE DETAILS), ELECTRICAL WIRING AND CONDUIT.
9. SLAB THICKNESS SHALL BE A MINIMUM OF 12-INCHES. SLAB MAY BE GREATER BASED ON THE STRUCTURAL DESIGN.
10. SLAB MAY BE RECESSED INTO THE GROUND (DEPTH TO BE DETERMINED IN THE FIELD), SO TOP OF SLAB ELEVATION MATCHES THAT OF THE EXISTING ADJACENT WALKWAY.

