



Financial Management Department
Purchasing Division
1112 Manatee Avenue West, Ste 803
Bradenton, FL 34205
Phone: (941) 749-3044
george.earnest@mymanatee.org
www.mymanatee.org

November 20, 2015

**RFQ 16-0164GE: Mill Creek Tree Trimming and
RFQ 16-0165GE Greenfield Plantation Tree Trimming
ADDENDUM 1**

The following addendum is issued to add to, modify, and/or clarify the above named solicitation documents. The items contained within this Addendum shall have the same force and effect as if contained within the first issued solicitation document and any cost involved shall be factored into the response. Quoters shall acknowledge receipt of this and any other addenda issued pursuant to this Request for Quotes (RFQ) in their quote submittal.

Maps for Mill Creek and Greenfield Plantation are included with this addendum.

Please note that 18th Place East (in the south east corner of Mill Creek) is included in this specification. And Portal Crossing (south of SR 64, south east of Greenfield Plantation) is also included in this specification.

Sincerely,

George Earnest CPPB
Buyer, Purchasing

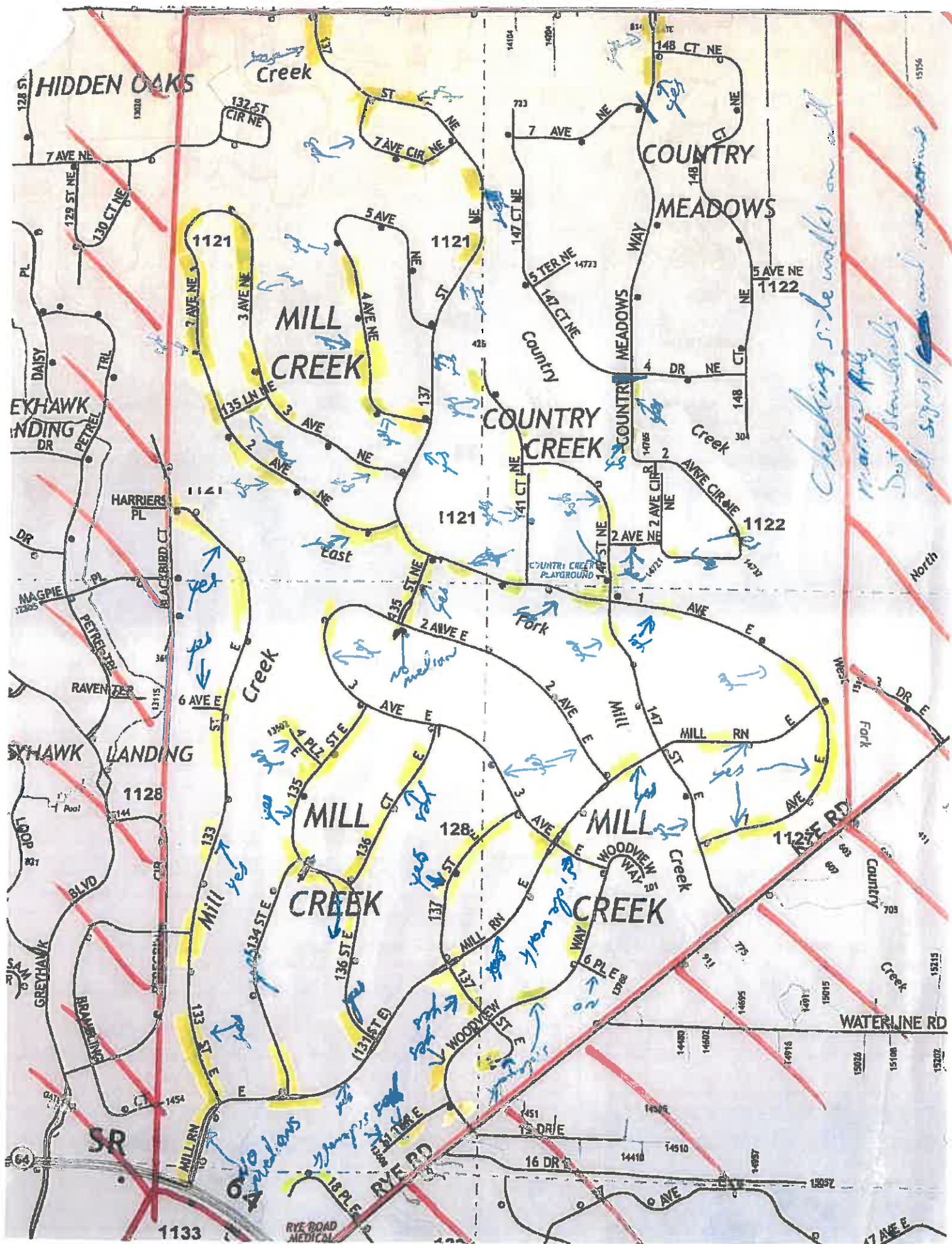

UNCLASSIFIED//FOR OFFICIAL USE ONLY



Google

Imagery Date: 4-1-2014

© 2015 Google
22.84854831, -88.2401123, 12m

Foot 106713

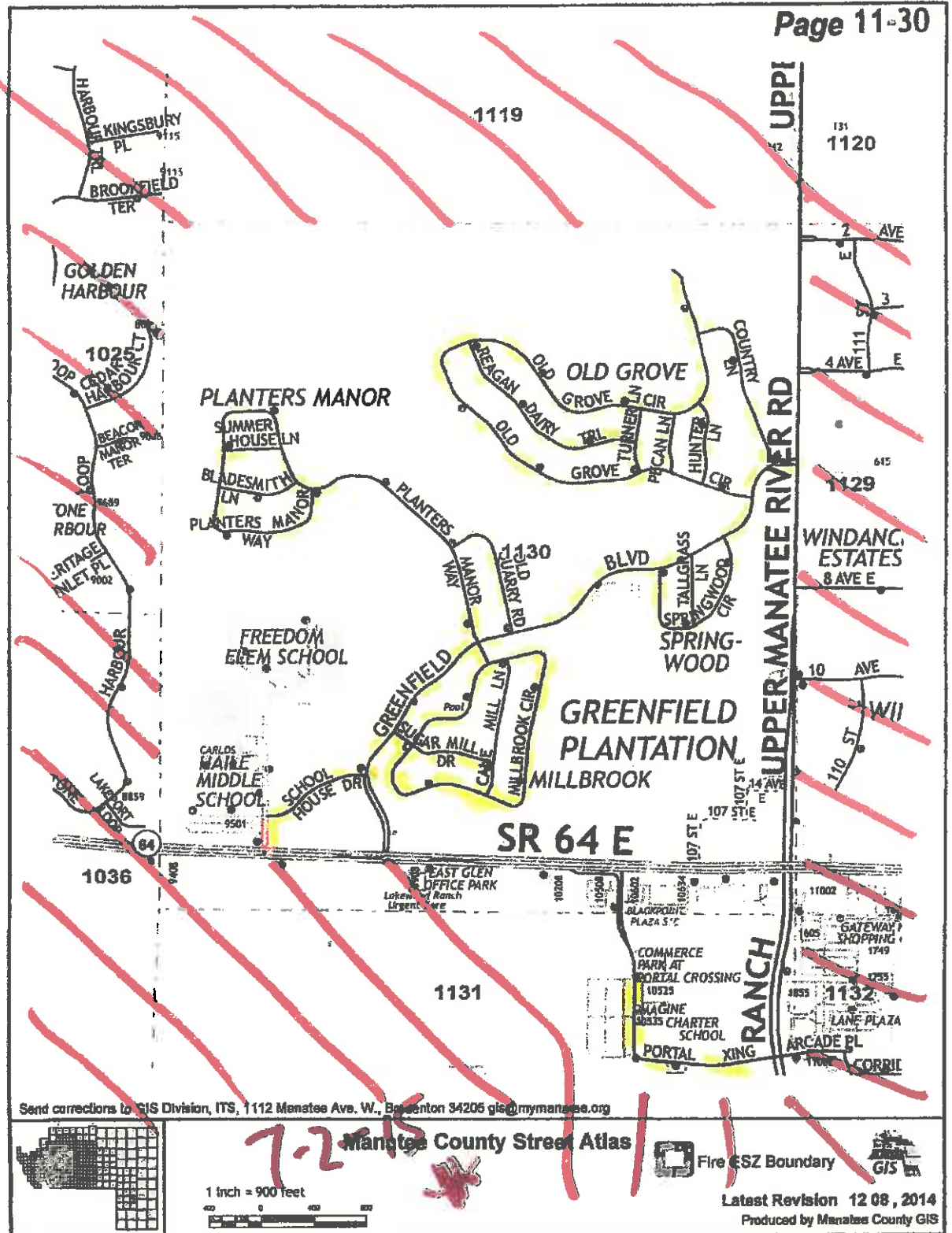

Send corrections to GIS Division, ITS, 1112 Manatee Ave. W., Baynton 34205 gis@mymanatee.org

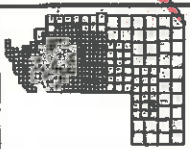

1 inch = 900 feet

Manatee County Street Atlas



Fire ESZ Boundary



Latest Revision 12-08-2014
Produced by Manatee County GIS

