

16+79 32'R
CT 8" PVC WM
IN PLACE DURING
SIGN REPLACEMENT

STA. 47+84, 29'R
CONFLICT. EX. 8" PVC WM TO BE
RELOCATED PRIOR TO SIGN INSTALLATION.
INST. 23LF 8" PVC C900 & 4-45' DIA
BENDS. RESTORE SURFACES TO EXISTING
OR BETTER COND. COORD. SHUTTERS &
WORK WITH COUNTY AND FDOT. INST.
THRUST BLOCKS & RJ AS NECESSARY.

STA. 49+18 - 49
PROTECT 8" PVC WM
IN PLACE DURING SIGN
REPLACEMENT

STA. 53+24, 32'R &
STA. 53+32, 32'R
PROTECT 8" PVC WM
IN PLACE DURING
SIGN REPLACEMENT

STA. 53+69 11' R
ADJUST VALVE BOX/
COVER TO FINISHED
GRADE, IF NECESSARY

STA. 54+23 42' L
REPLACE MH RING
COVER, ADJUST T
FINISHED GRADE

STA. 53+96 27' L
REPLACE MH RING
COVER, ADJUST T
FINISHED GRADE

MANATEE COUNTY EXHIBIT A
UTILITY ADJUSTMENTS

NOTICE: THE OFFICIAL RECORD OF THIS SHEET IS THE ELECTRONIC FILE IN THE PROJECT RECORD SYSTEM. SEE THE PROJECT RECORD SYSTEM FOR THE OFFICIAL RECORD OF THIS SHEET. FILE 51 SEALER: RULE 61615-23.003, T.A.C.

REVISIONS		REVISIONS		ENGINEER OF RECORD: RYAN KEITH SLATER, P.E. P.E. LICENSE NUMBER 63861 FLORIDA DEPARTMENT OF TRANSPORTATION 801 N. BROADWAY AVENUE BARTOW, FL 33830-3809	STATE OF FLORIDA DEPARTMENT OF TRANSPORTATION			SHEET NO. S-9
DATE	DESCRIPTION	DATE	DESCRIPTION		ROAD NO.	COUNTY	FINANCIAL PROJECT ID	
					70	MANATEE	431207-1-52-01	

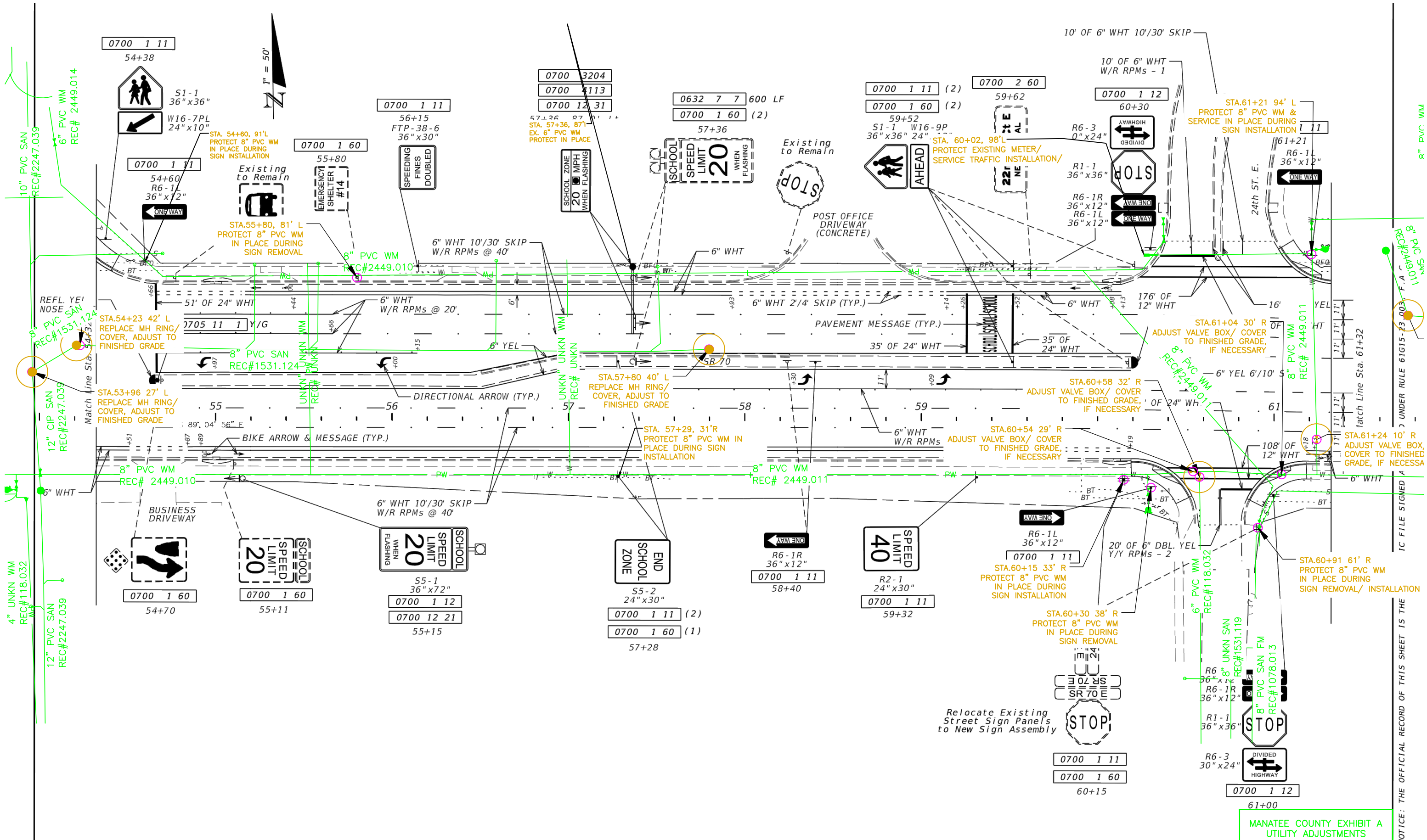

IC FILE SIGNED A UNDER RULE 61G15-23.003 F.A. REC#2449.011 8\"/>

MANATEE COUNTY EXHIBIT A
UTILITY ADJUSTMENTS

REVISIONS	
DATE	DESCRIPTION

ENGINEER OF RECORD:
RYAN KEITH SLATER, P.E.
P.E. LICENSE NUMBER 63861
FLORIDA DEPARTMENT OF TRANSPORTATION
801 N. BROADWAY AVENUE
BARTOW, FL 33830-3809

STATE OF FLORIDA DEPARTMENT OF TRANSPORTATION		
ROAD NO.	COUNTY	FINANCIAL PROJECT ID
70	MANATEE	431207-1-52-01

PLAN SHEET

SHEET NO.
S-10

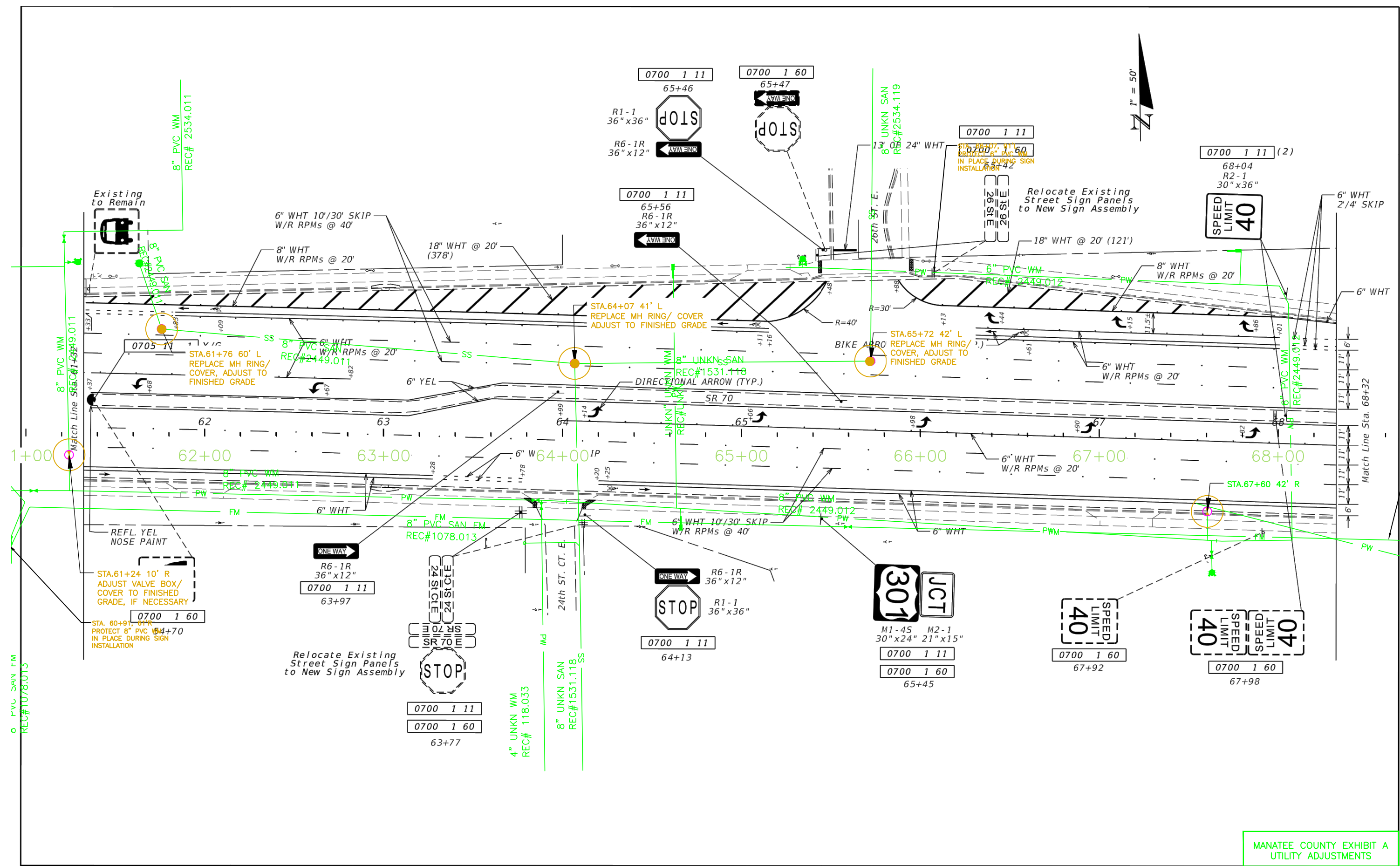
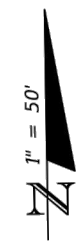

MANATEE COUNTY EXHIBIT A
UTILITY ADJUSTMENTS

REVISIONS			
DATE	DESCRIPTION	DATE	DESCRIPTION

ENGINEER OF RECORD:
RYAN KEITH SLATER, P.E.
P.E. LICENSE NUMBER 63861
FLORIDA DEPARTMENT OF TRANSPORTATION
801 N. BROADWAY AVENUE
BARTOW, FL 33830-3809

STATE OF FLORIDA DEPARTMENT OF TRANSPORTATION		
ROAD NO.	COUNTY	FINANCIAL PROJECT ID
70	MANATEE	431207-1-52-01

PLAN SHEET

SHEET NO.
S-11

NOTICE: THE OFFICIAL RECORD OF THIS SHEET IS THE ELECTRONIC FILE SIGNED AND SEALED UNDER RULE 61G15-23.003, F.A.C.

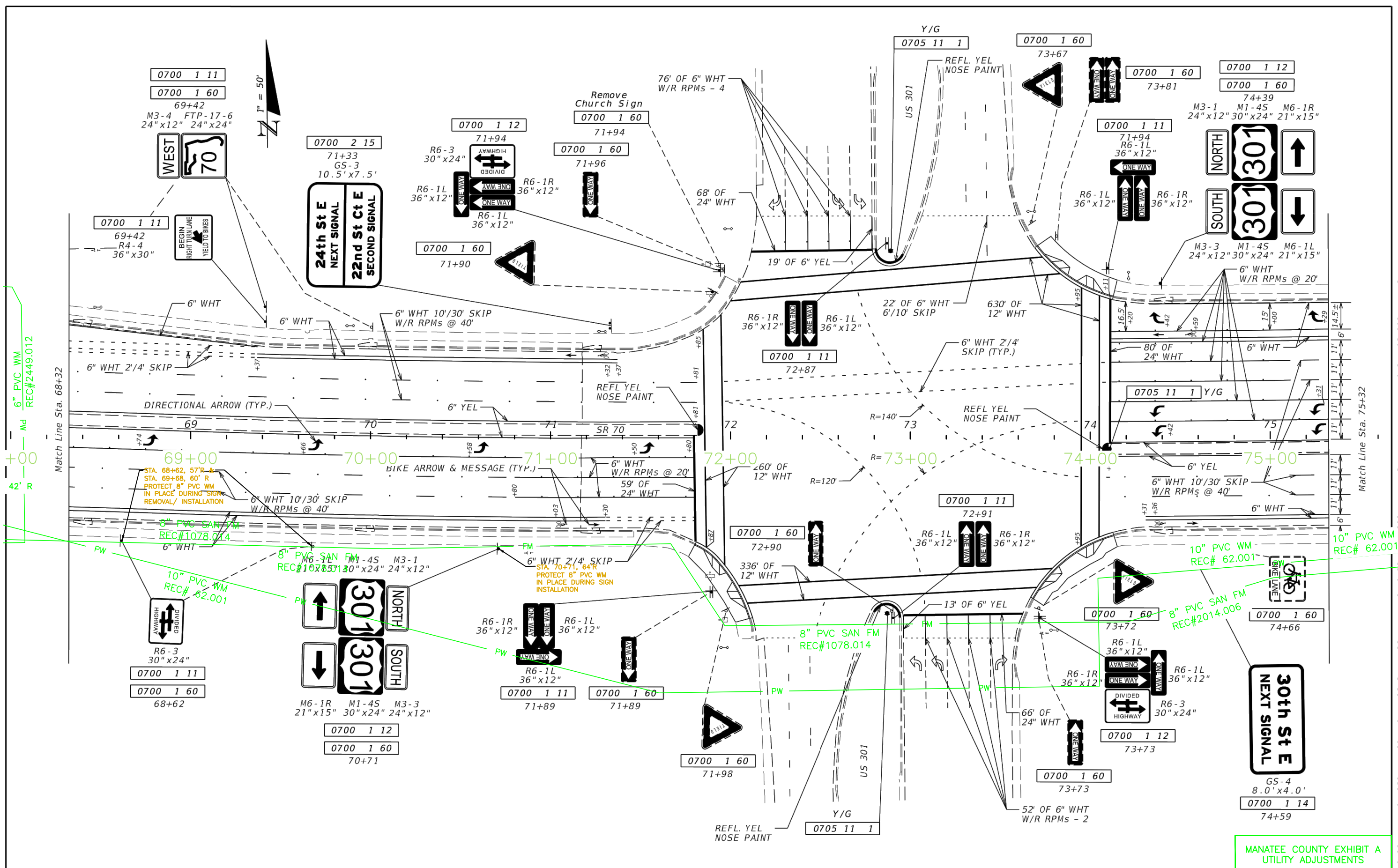

MANATEE COUNTY EXHIBIT A
UTILITY ADJUSTMENTS

REVISIONS		REVISIONS		ENGINEER OF RECORD: RYAN KEITH SLATER, P.E. P.E. LICENSE NUMBER 63861 FLORIDA DEPARTMENT OF TRANSPORTATION 801 N. BROADWAY AVENUE BARTOW, FL 33830-3809	STATE OF FLORIDA DEPARTMENT OF TRANSPORTATION			SHEET NO.
DATE	DESCRIPTION	DATE	DESCRIPTION		ROAD NO.	COUNTY	FINANCIAL PROJECT ID	
					70	MANATEE	431207-1-52-01	S-12

NOTICE: THE OFFICIAL RECORD OF THIS SHEET IS THE ELECTRONIC FILE SIGNED AND SEALED UNDER RULE 61G15-23.003, F.A.C.

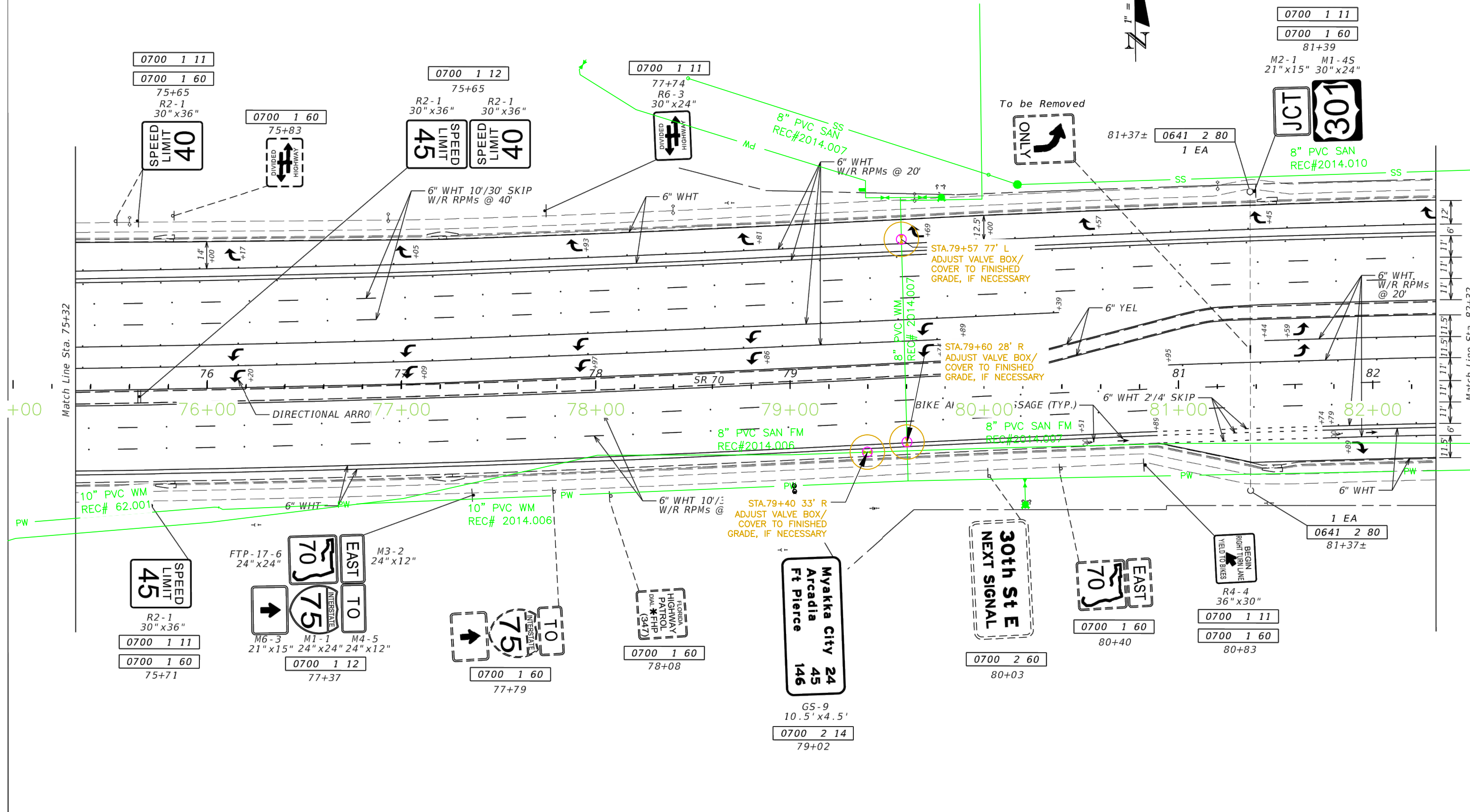

MANATEE COUNTY EXHIBIT A
UTILITY ADJUSTMENTS

REVISIONS		REVISIONS		ENGINEER OF RECORD: RYAN KEITH SLATER, P.E. P.E. LICENSE NUMBER 63861 FLORIDA DEPARTMENT OF TRANSPORTATION 801 N. BROADWAY AVENUE BARTOW, FL 33830-3809	STATE OF FLORIDA DEPARTMENT OF TRANSPORTATION			SHEET NO. S-13
DATE	DESCRIPTION	DATE	DESCRIPTION		ROAD NO.	COUNTY	FINANCIAL PROJECT ID	
					70	MANATEE	431207-1-52-01	

NOTICE: THE OFFICIAL RECORD OF THIS SHEET IS THE ELECTRONIC FILE SIGNED AND SEALED UNDER RULE 61G15-23.003, F.A.C.

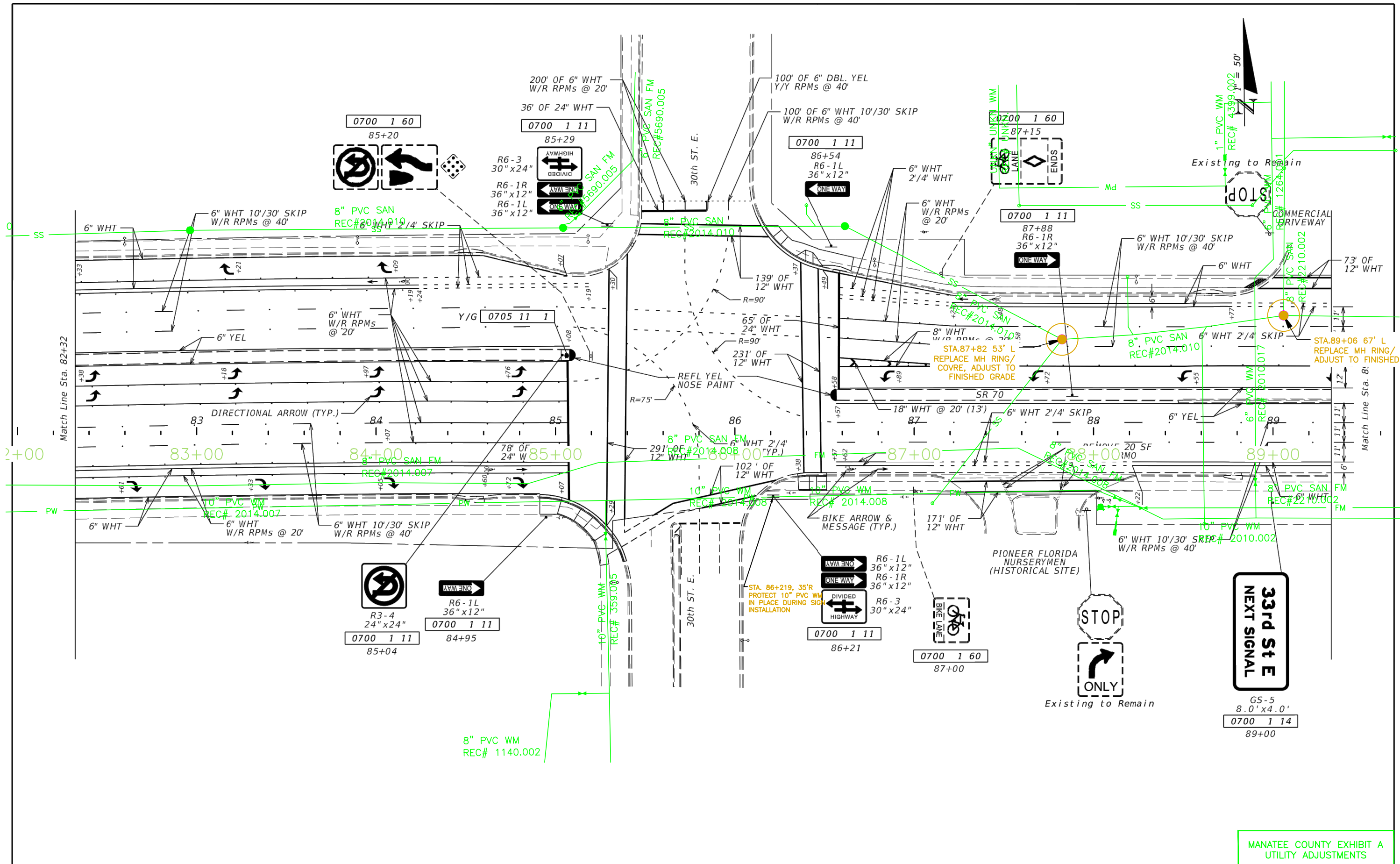

NOTICE: THE OFFICIAL RECORD OF THIS SHEET IS THE ELECTRONIC FILE SIGNED AND SEALED UNDER RULE 61.003, F.A.C.

REVISIONS			
DATE	DESCRIPTION	DATE	DESCRIPTION

ENGINEER OF RECORD:
 RYAN KEITH SLATER, P.E.
 P.E. LICENSE NUMBER 63861
 FLORIDA DEPARTMENT OF TRANSPORTATION
 801 N. BROADWAY AVENUE
 BARTOW, FL 33830-3809

STATE OF FLORIDA DEPARTMENT OF TRANSPORTATION		
ROAD NO.	COUNTY	FINANCIAL PROJECT ID
70	MANATEE	431207-1-52-01

PLAN SHEET

SHEET NO.
S-14

MANATEE COUNTY EXHIBIT A
UTILITY ADJUSTMENTS

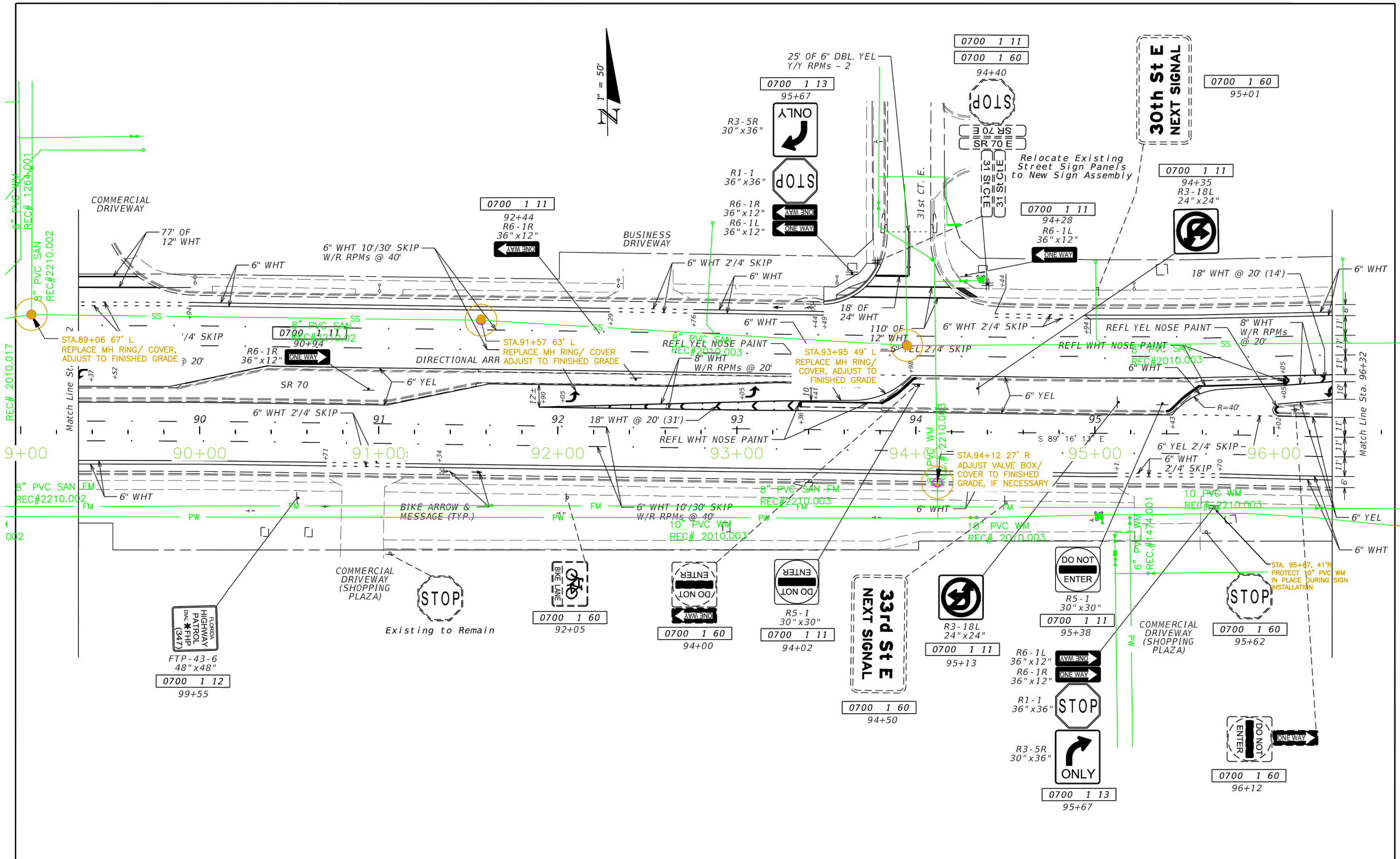

REVISIONS			
DATE	DESCRIPTION	DATE	DESCRIPTION

ENGINEER OF RECORD:
 RYAN KEITH SLATER, P.E.
 P.E. LICENSE NUMBER 63861
 FLORIDA DEPARTMENT OF TRANSPORTATION
 801 N. BROADWAY AVENUE
 BARTOW, FL 33830-3809

STATE OF FLORIDA DEPARTMENT OF TRANSPORTATION		
ROAD NO.	COUNTY	FINANCIAL PROJECT ID
70	MANATEE	431207-1-52-01

PLAN SHEET

SHEET NO.
S-15

NOTICE: THE OFFICIAL RECORD OF THIS SHEET IS THE ELECTRONIC FILE SIGNED AND SEALED UNDER RULE 61G15-23.003, F.A.C.

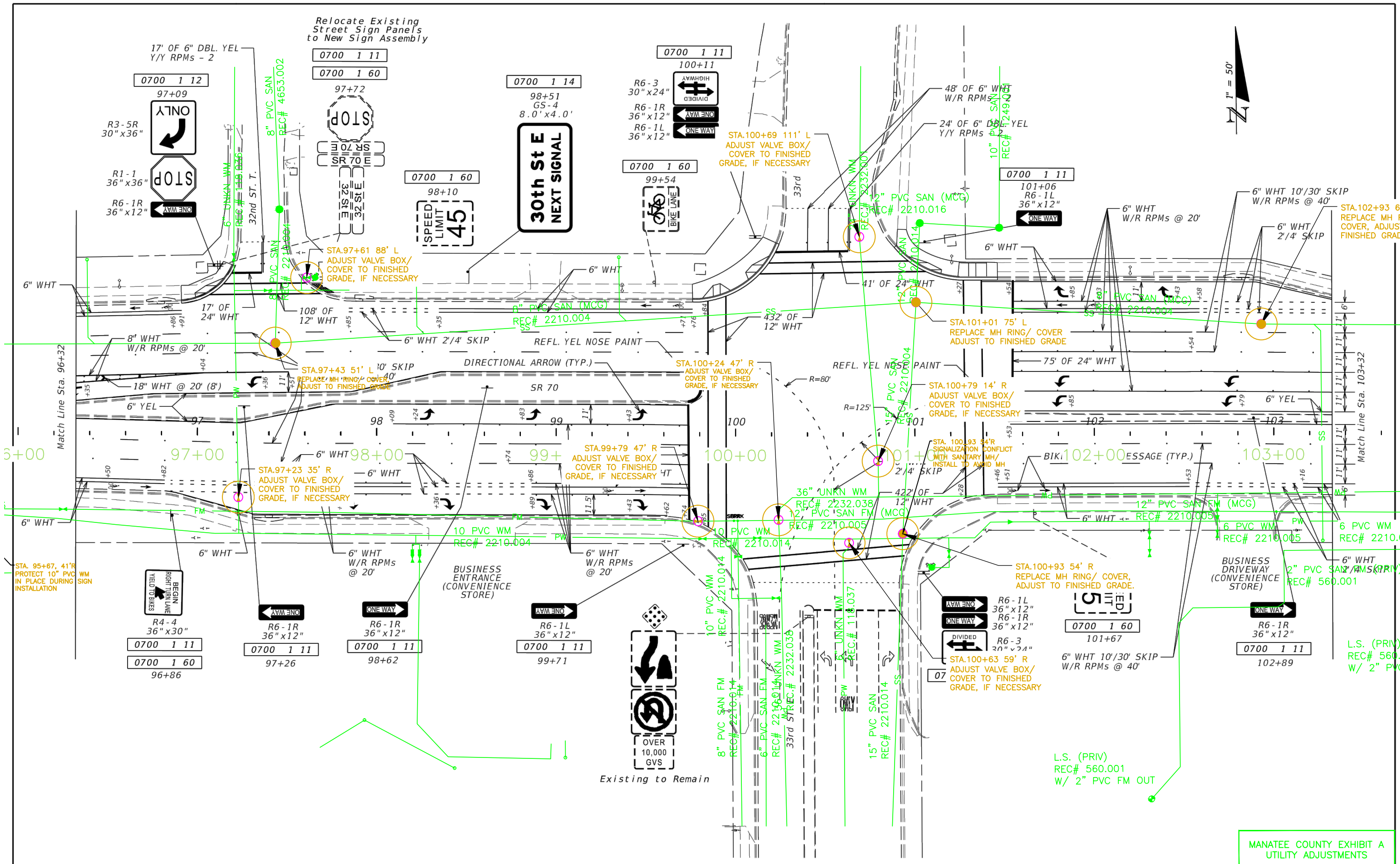

MANATEE COUNTY EXHIBIT A
UTILITY ADJUSTMENTS

REVISIONS			
DATE	DESCRIPTION	DATE	DESCRIPTION

ENGINEER OF RECORD:
 RYAN KEITH SLATER, P.E.
 P.E. LICENSE NUMBER 63861
 FLORIDA DEPARTMENT OF TRANSPORTATION
 801 N. BROADWAY AVENUE
 BARTOW, FL 33830-3809

STATE OF FLORIDA DEPARTMENT OF TRANSPORTATION		
ROAD NO.	COUNTY	FINANCIAL PROJECT ID
70	MANATEE	431207-1-52-01

PLAN SHEET

SHEET NO.
S-16

NOTICE: THE OFFICIAL RECORD OF THIS SHEET IS THE ELECTRONIC FILE. PRINTED AND SEALED UNDER RULE 61G15-23.003, F.A.C.

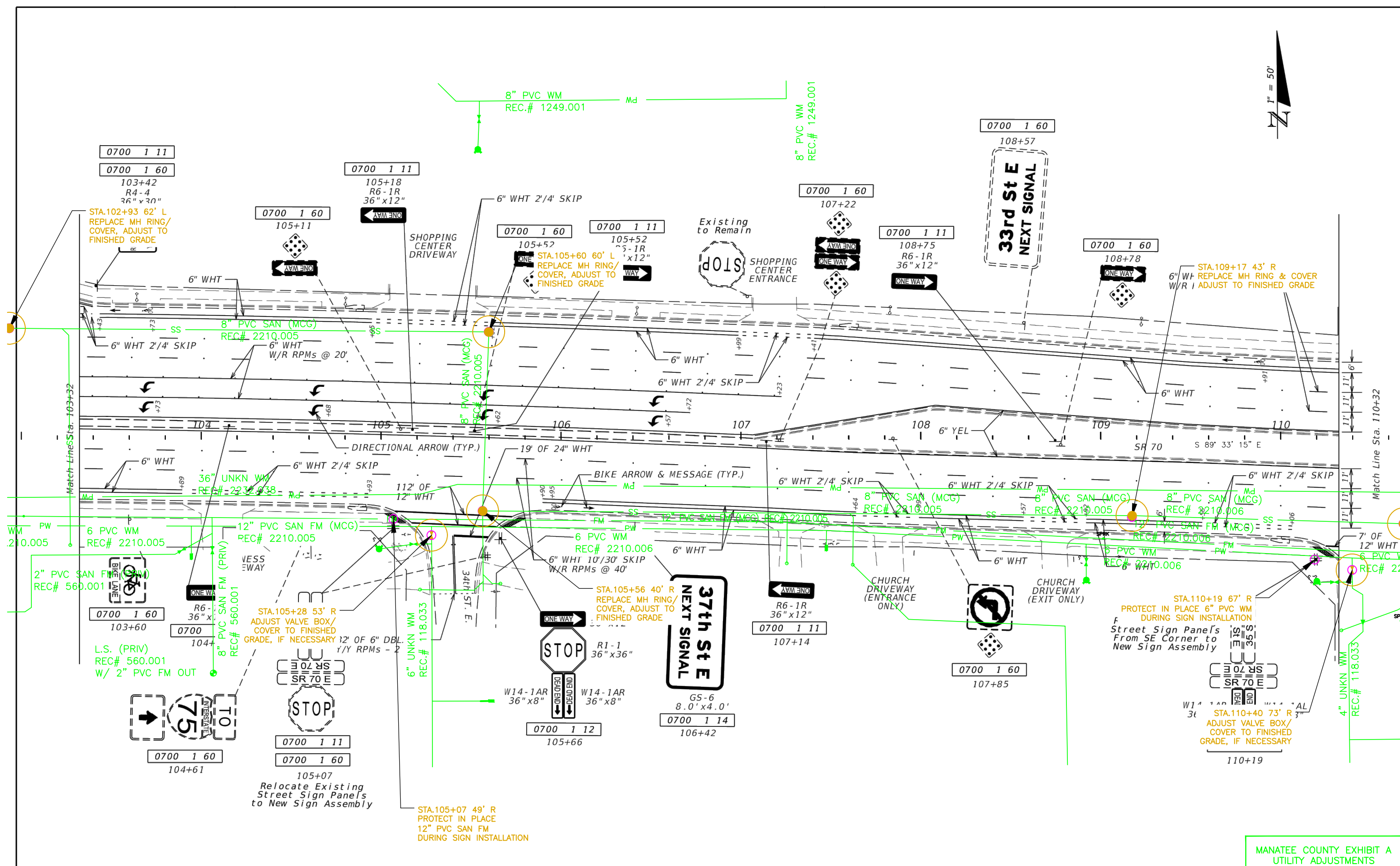

MANATEE COUNTY EXHIBIT A
UTILITY ADJUSTMENTS

REVISIONS			
DATE	DESCRIPTION	DATE	DESCRIPTION

ENGINEER OF RECORD:
 RYAN KEITH SLATER, P.E.
 P.E. LICENSE NUMBER 63861
 FLORIDA DEPARTMENT OF TRANSPORTATION
 801 N. BROADWAY AVENUE
 BARTOW, FL 33830-3809

STATE OF FLORIDA DEPARTMENT OF TRANSPORTATION		
ROAD NO.	COUNTY	FINANCIAL PROJECT ID
70	MANATEE	431207-1-52-01

PLAN SHEET

SHEET NO.
S-17

NOTICE: THE OFFICIAL RECORD OF THIS SHEET IS THE ELECTRONIC FILE SIGNED AND SEALED UNDER RULE 61G15-23-.003, F.A.C.

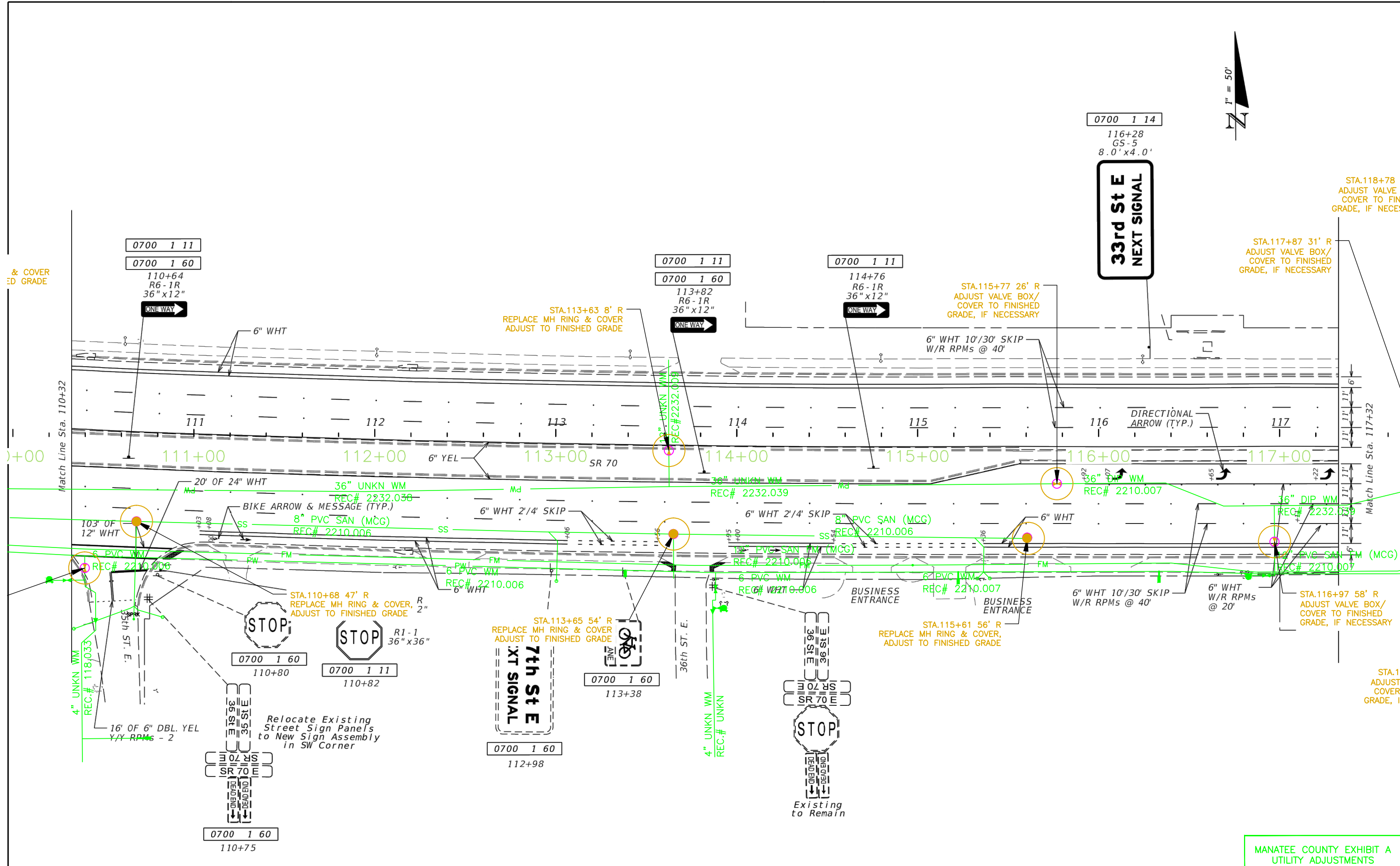

STA.118+78 32' R
ADJUST VALVE BOX/
COVER TO FINISH
GRADE, IF NECESSARY

STA.117+87 31' R
ADJUST VALVE BOX/
COVER TO FINISHED
GRADE, IF NECESSARY

STA.115+77 26' R
ADJUST VALVE BOX/
COVER TO FINISHED
GRADE, IF NECESSARY

STA.113+63 8' R
REPLACE MH RING & COVER
ADJUST TO FINISHED GRADE

STA.110+68 47' R
REPLACE MH RING & COVER,
ADJUST TO FINISHED GRADE

STA.113+65 54' R
REPLACE MH RING & COVER
ADJUST TO FINISHED GRADE

STA.115+61 56' R
REPLACE MH RING & COVER,
ADJUST TO FINISHED GRADE

STA.116+97 58' R
ADJUST VALVE BOX/
COVER TO FINISHED
GRADE, IF NECESSARY

STA.118+
ADJUST VAL
COVER TO
GRADE, IF NI

MANATEE COUNTY EXHIBIT A
UTILITY ADJUSTMENTS

REVISIONS			
DATE	DESCRIPTION	DATE	DESCRIPTION

ENGINEER OF RECORD:
RYAN KEITH SLATER, P.E.
P.E. LICENSE NUMBER 63861
FLORIDA DEPARTMENT OF TRANSPORTATION
801 N. BROADWAY AVENUE
BARTOW, FL 33830-3809

STATE OF FLORIDA DEPARTMENT OF TRANSPORTATION		
ROAD NO.	COUNTY	FINANCIAL PROJECT ID
70	MANATEE	431207-1-52-01

PLAN SHEET

SHEET NO.
S-18

NOTICE: THE OFFICIAL RECORD OF THIS PROJECT IS THE ELECTRONIC FILE SIGNED AND SEALED UNDER RULE 61G15-23.003, F.A.C.

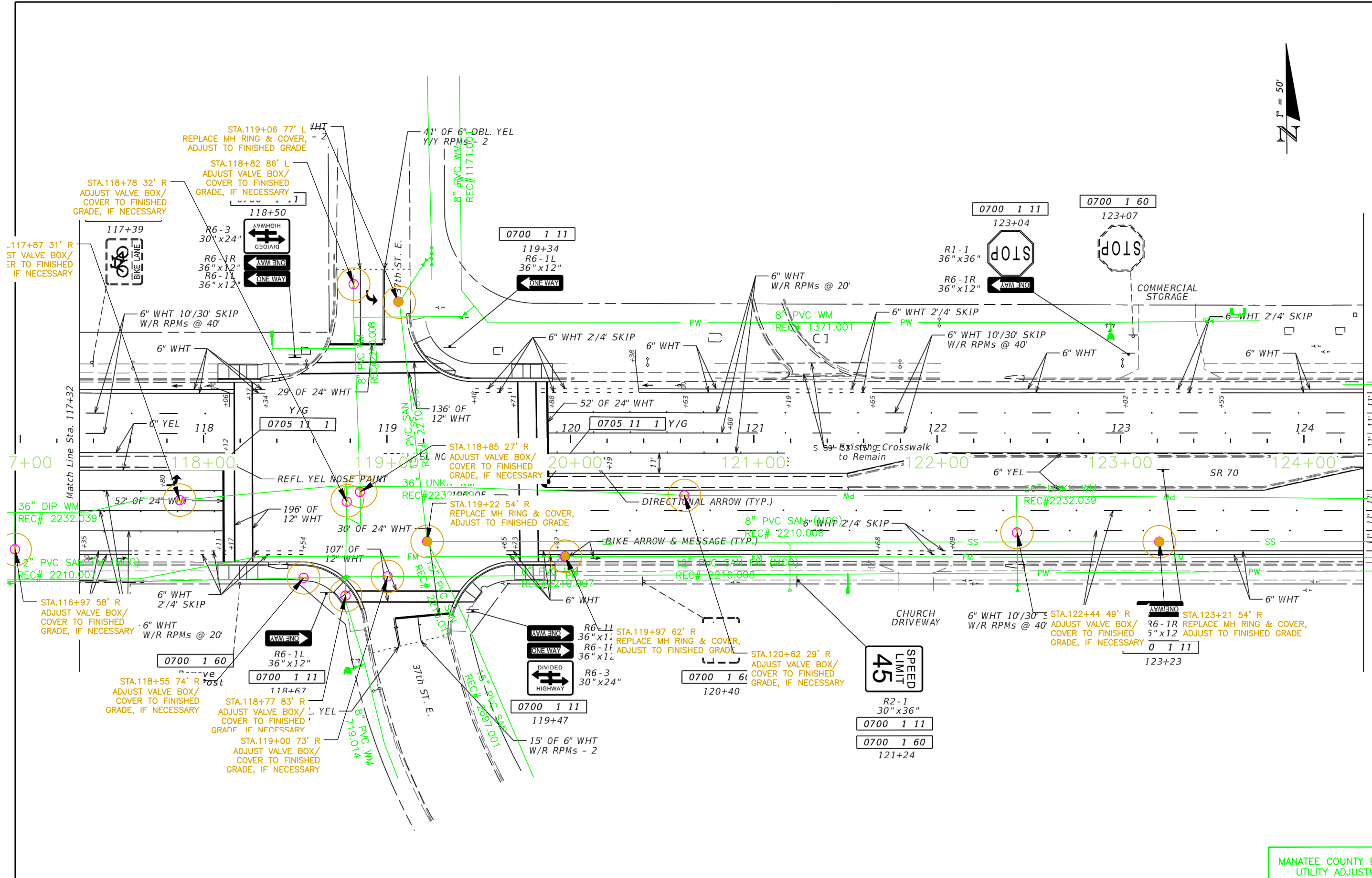
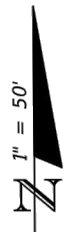

MANATEE COUNTY EXHIBIT A
UTILITY ADJUSTMENTS

REVISIONS			
DATE	DESCRIPTION	DATE	DESCRIPTION

ENGINEER OF RECORD:
RYAN KEITH SLATER, P.E.
P.E. LICENSE NUMBER 63861
FLORIDA DEPARTMENT OF TRANSPORTATION
801 N. BROADWAY AVENUE
BARTOW, FL 33830-3809

STATE OF FLORIDA DEPARTMENT OF TRANSPORTATION		
ROAD NO.	COUNTY	FINANCIAL PROJECT ID
70	MANATEE	431207-1-52-01

PLAN SHEET

SHEET NO.
S-19

NOTICE: THE OFFICIAL RECORD OF THIS SHEET IS THE ELECTRONIC FILE SIGNED AND SEALED UNDER RULE 61G15-23.003, F.A.C.

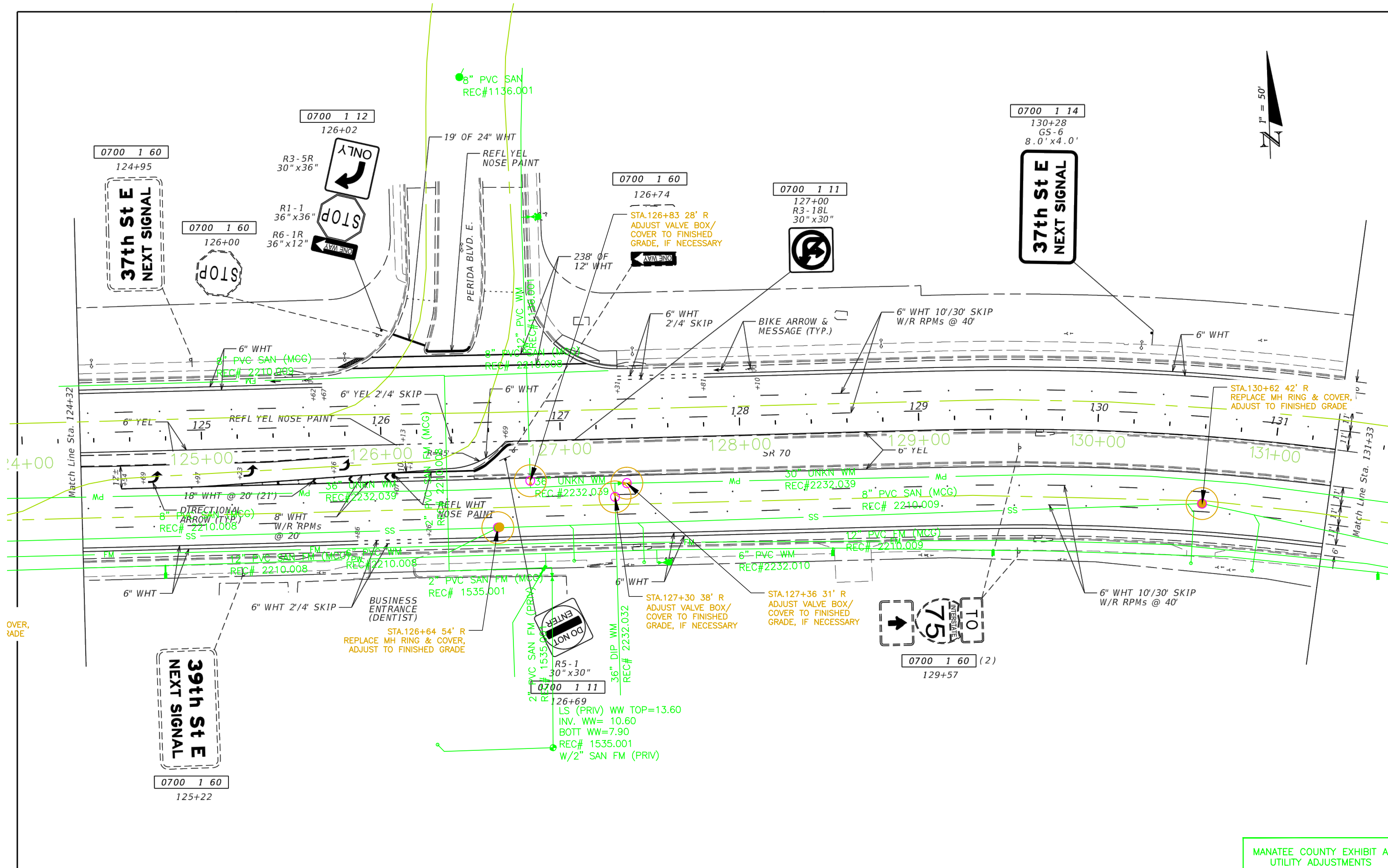
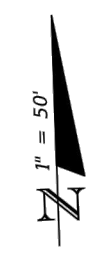

OVER,
GRADE

MANATEE COUNTY EXHIBIT A
UTILITY ADJUSTMENTS

REVISIONS		REVISIONS		ENGINEER OF RECORD: RYAN KEITH SLATER, P.E. P.E. LICENSE NUMBER 63861 FLORIDA DEPARTMENT OF TRANSPORTATION 801 N. BROADWAY AVENUE BARTOW, FL 33830-3809	STATE OF FLORIDA DEPARTMENT OF TRANSPORTATION			SHEET NO. S-20
DATE	DESCRIPTION	DATE	DESCRIPTION		ROAD NO.	COUNTY	FINANCIAL PROJECT ID	
					70	MANATEE	431207-1-52-01	

PLAN SHEET

NOTICE: THE OFFICIAL RECORD OF THIS SHEET IS THE ELECTRONIC FILE SIGNED AND SEALED UNDER RULE 61G15-23.003, F.A.C.

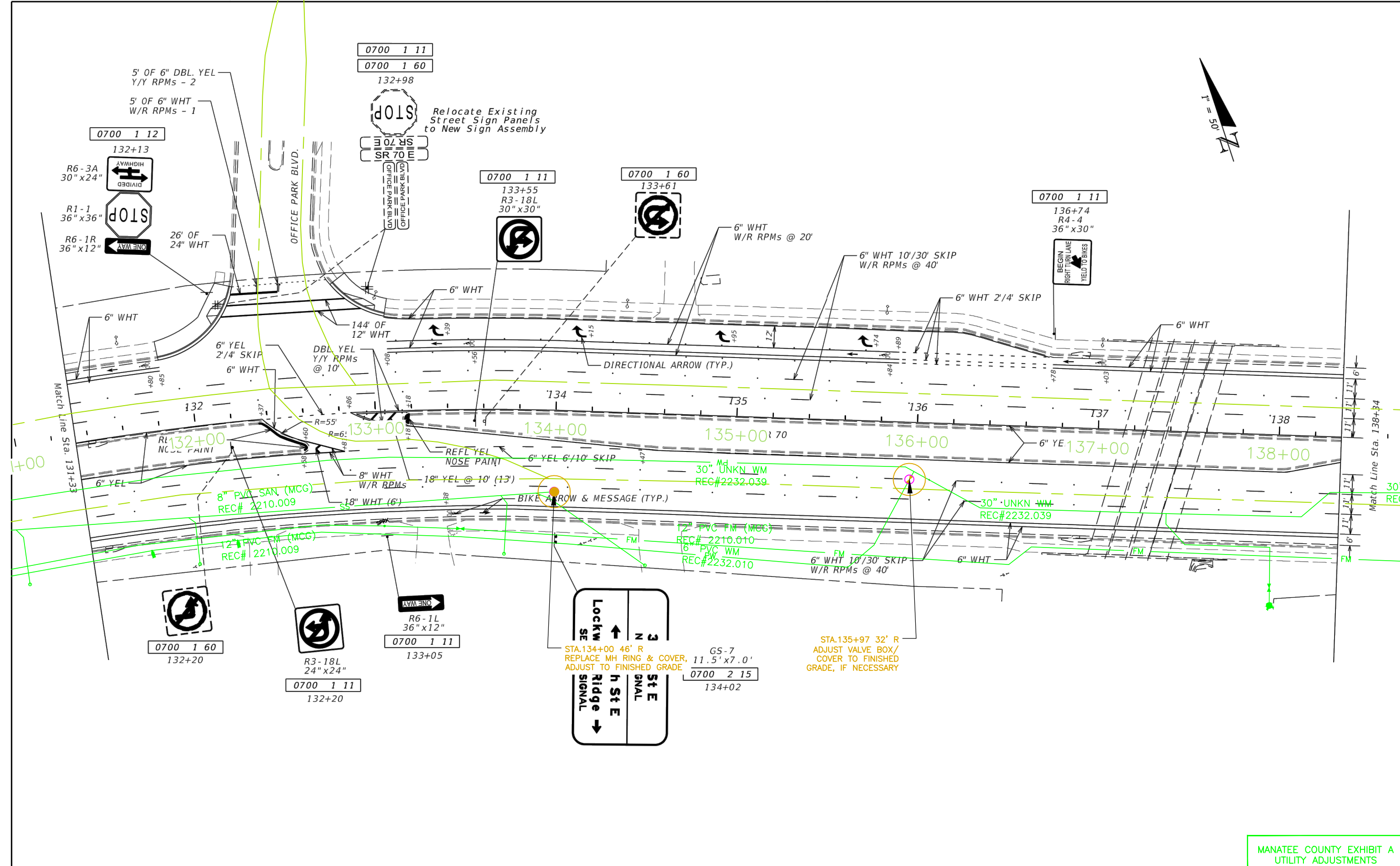
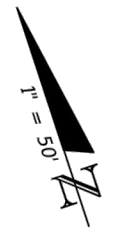

NOTICE: THE OFFICIAL RECORD OF THIS SHEET IS THE ELECTRONIC FILE SIGNED AND SEALED UNDER RULE 61G15-23.003, F.A.C.

MANATEE COUNTY EXHIBIT A
UTILITY ADJUSTMENTS

REVISIONS				ENGINEER OF RECORD: RYAN KEITH SLATER, P.E. P.E. LICENSE NUMBER 63861 FLORIDA DEPARTMENT OF TRANSPORTATION 801 N. BROADWAY AVENUE BARTOW, FL 33830-3809	STATE OF FLORIDA DEPARTMENT OF TRANSPORTATION			PLAN SHEET	SHEET NO.
DATE	DESCRIPTION	DATE	DESCRIPTION		ROAD NO.	COUNTY	FINANCIAL PROJECT ID		S-21
					70	MANATEE	431207-1-52-01		

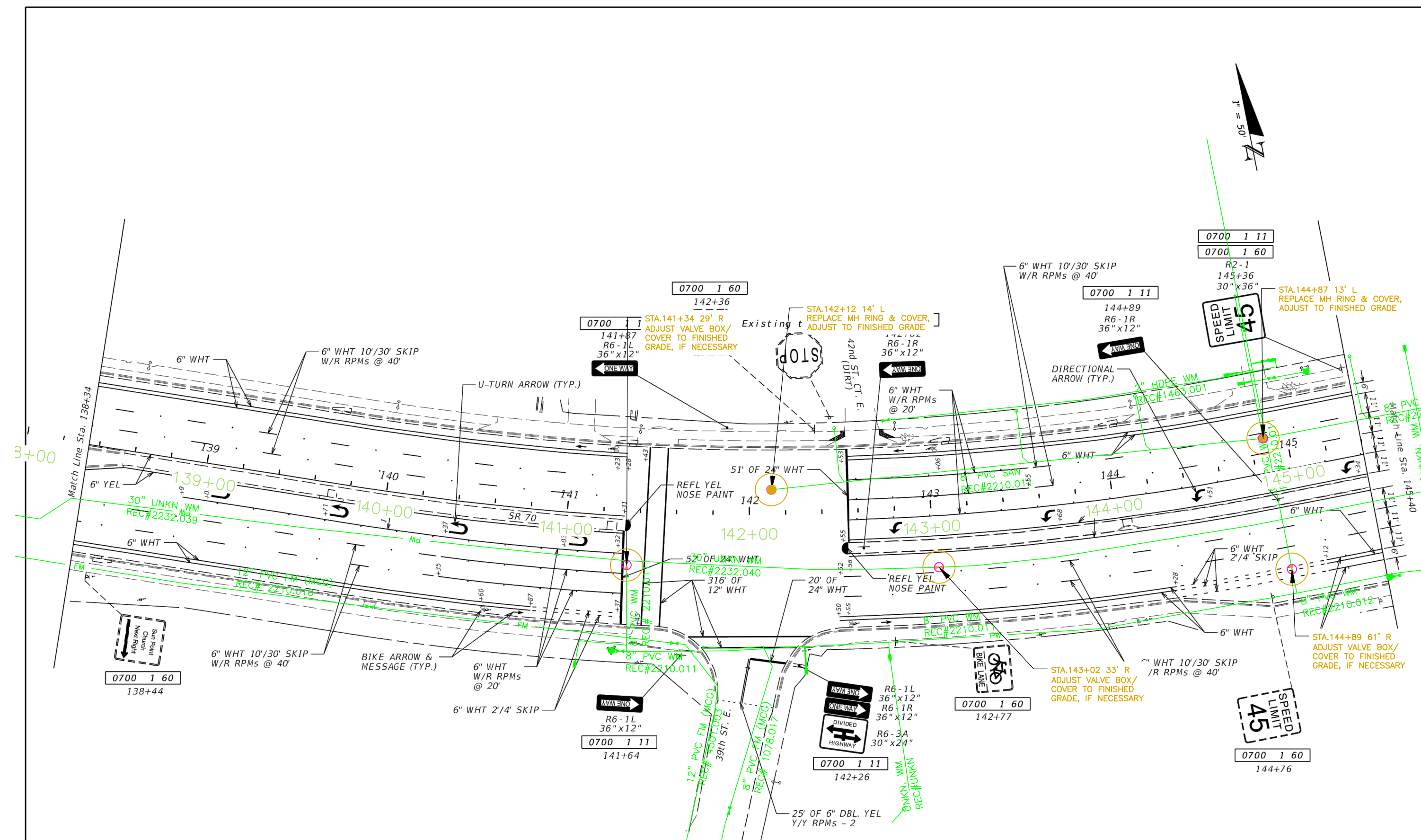
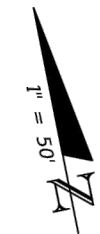

MANATEE COUNTY EXHIBIT A
UTILITY ADJUSTMENTS

REVISIONS			
DATE	DESCRIPTION	DATE	DESCRIPTION

ENGINEER OF RECORD:
RYAN KEITH SLATER, P.E.
P.E. LICENSE NUMBER 63861
FLORIDA DEPARTMENT OF TRANSPORTATION
801 N. BROADWAY AVENUE
BARTOW, FL 33830-3809

STATE OF FLORIDA DEPARTMENT OF TRANSPORTATION		
ROAD NO.	COUNTY	FINANCIAL PROJECT ID
70	MANATEE	431207-1-52-01

PLAN SHEET

SHEET NO.
S-22

NOTICE: THE OFFICIAL RECORD OF THIS SHEET IS THE ELECTRONIC FILE SIGNED AND SEALED UNDER CHAPTER 61G15-23.003, F.A.C.

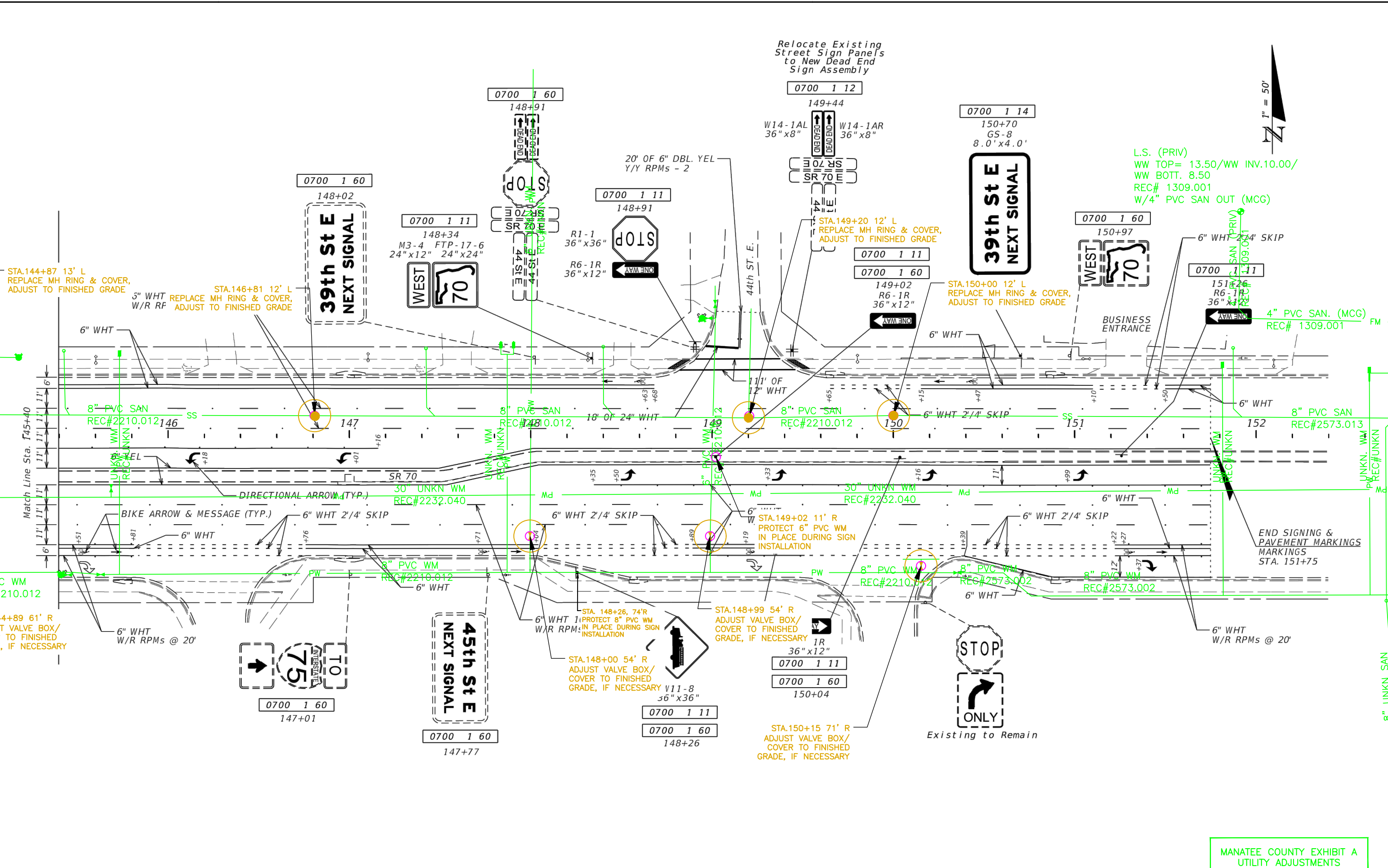

MANATEE COUNTY EXHIBIT A
UTILITY ADJUSTMENTS

REVISIONS			
DATE	DESCRIPTION	DATE	DESCRIPTION

ENGINEER OF RECORD:
RYAN KEITH SLATER, P.E.
P.E. LICENSE NUMBER 63861
FLORIDA DEPARTMENT OF TRANSPORTATION
801 N. BROADWAY AVENUE
BARTOW, FL 33830-3809

STATE OF FLORIDA DEPARTMENT OF TRANSPORTATION		
ROAD NO.	COUNTY	FINANCIAL PROJECT ID
70	MANATEE	431207-1-52-01

PLAN SHEET

SHEET NO.
S-23

NOTICE: THE OFFICIAL RECORD OR AS SHOWN IS THE ELECTRONIC FILE SIGNED UNDER RULE 61G15-23.003, F.A.C.