



# UPPER MANATEE RIVER ROAD ROADWAY FUNCTIONAL IMPROVEMENTS

## 307-6082660

September 2014

### SIGNING AND PAVEMENT MARKING BID SET

UPPER MANATEE RIVER ROAD  
 ROADWAY FUNCTIONAL  
 IMPROVEMENTS  
 SIGNING AND PAVEMENT MARKING PLANS  
 COVER SHEET



VICINITY MAP  
 N.T.S.

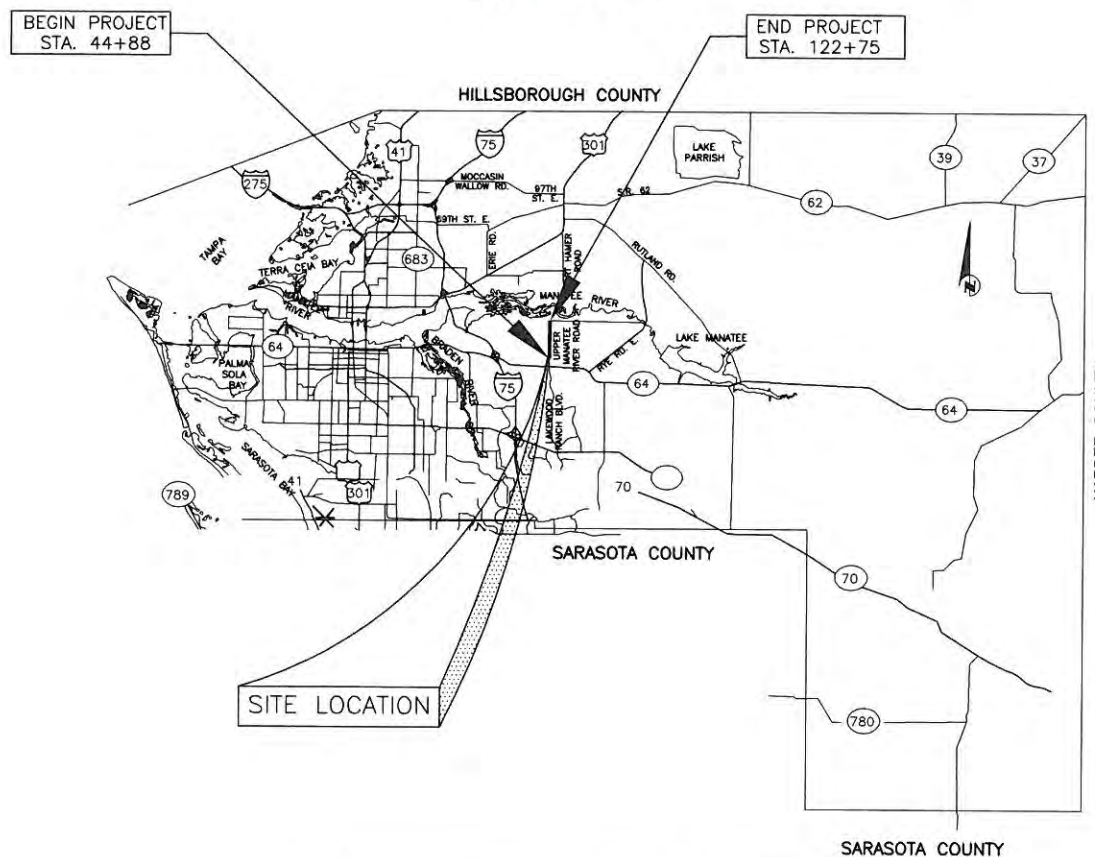

SITE LOCATION

NO.	INDEX OF SHEETS
1	COVER SHEET
2	GENERAL NOTES
3-17	SIGNING AND PAVEMENT MARKING

**PROJECT DESCRIPTION**

THIS PROJECT CONSISTS OF WIDENING THE EXISTING SHOULDER TO 8', RELOCATING EXISTING ROADSIDE DITCHES; ADDING AND REPAIRING SIDEWALK ON THE WEST SIDE OF THE ROAD; ADDING RIGHT AND LEFT TURN LANES AT EACH INTERSECTION.

LENGTH OF PROJECT		
	LINEAR FEET	MILES
ROADWAY	7,439	1.40
SIDEWALK	3,604	.68
NET LENGTH OF PROJECT	7,787	1.47
EXCEPTIONS	N/A	N/A
GROSS LENGTH OF PROJECT	7,787	1.47

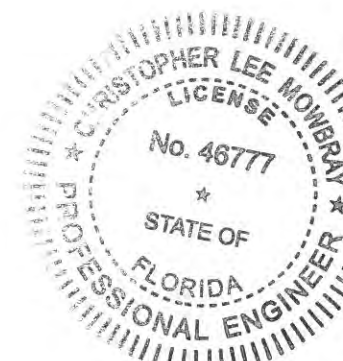

NO.	REVISION DESCRIPTION	BY	DATE

PROJECT #	307-6082660
SURVEY #	FILE 00-42783
SEC./TWN./RGE	19-20, 29-30,34S/19E
SCALE	NTS
BY	DATE
SURVEYED	ZNS 04/27/12
DESIGNED	PV/PBF 03/18/14
DRAWN	KR/CB 03/18/14
CHECKED	PV/PBF 03/18/14
CHRISTOPHER L. MOWBRAY, P.E. FLORIDA P.E. # 46777	

Signature & Date  
 11/5/14

COPYRIGHT 2010 MANATEE COUNTY GOVERNMENT I:\S\PROJ\Engineering\Shore\Highway\Engineering\ROADS\Upper Manatee River Road\WVA\WVA\PLANS\ Pavement Marking and Signing Plan\Upper Manatee Spn and Pavement\COVSET\_11/3/2014 10:43 AM\408 Page\_12\_11817

GENERAL NOTES

1. THESE PLANS HAVE BEEN PREPARED IN ACCORDANCE WITH AND ARE GOVERNED BY THE STATE OF FLORIDA DEPARTMENT OF TRANSPORTATION (FDOT), STANDARD SPECIFICATIONS FOR ROAD AND BRIDGE CONSTRUCTION (DATED 2014), AND FLORIDA DEPARTMENT OF TRANSPORTATION DESIGN STANDARDS (DATED 2014), AND THE FHWA MANUAL OF UNIFORM TRAFFIC CONTROL DEVICES (MUTCD) 2009 EDITION.
2. PAVEMENT MARKING SHALL BE PLACED AS SHOWN IN THE PLANS AND THE APPROPRIATE FDOT DESIGN STANDARDS INDEX.
3. PAVEMENT MARKING DIRECTIONAL ARROWS SHALL BE SPACED AS PER FDOT DESIGN STANDARD INDEX NO. 17346.
4. IT SHALL BE THE RESPONSIBILITY OF THE CONTRACTOR TO VERIFY THE LENGTH OF COLUMN SUPPORTS IN THE FIELD PRIOR TO FABRICATION.
5. REFER TO FDOT DESIGN STANDARD INDEX NO. 17352 FOR RETRO-REFLECTIVE PAVEMENT MARKER PLACEMENT DETAILS.
6. ALL PERMANENT PAVEMENT MARKINGS PLACED WITHIN THE MANATEE COUNTY RIGHT OF WAY SHALL BE THERMOPLASTIC EXCEPT WHEN OTHERWISE NOTED IN PLANS WHERE PAINT IS SPECIFIED.
7. ALL THERMOPLASTIC PAVEMENT MARKINGS SHALL BE CERTIFIED LEAD FREE.
8. TEMPORARY PAINTED PAVEMENT MARKINGS SHALL BE INSTALLED PRIOR TO OPENING LANES TO TRAFFIC. PAVEMENT MARKINGS SHALL BE PLACED AS SHOWN IN THE PLANS AND THE APPROPRIATE FDOT DESIGN STANDARDS INDEX.
9. EXISTING PAVEMENT MARKINGS WHICH CONFLICT WITH THE PROPOSED PAVEMENT MARKINGS SHALL BE REMOVED USING AN EDCO TLR-7 GRINDER OR EQUAL. NO SCAR RESULTING FROM THE MARKING REMOVAL SHALL BE DEEPER THAN 1/4" AS MEASURED FROM THE SURROUNDING SURFACE TO THE LOWEST POINT IN THE REMOVED AREA. HYDROBLASTING IS NOT ALLOWED.
10. ALL PAVEMENT MARKINGS SHALL MEET THE CRITERIA SPECIFIED IN THE FDOT STANDARD SPECIFICATIONS FOR ROAD AND BRIDGE CONSTRUCTION, 2014 EDITION.
11. ALL SIGNS SHALL BE INSTALLED ACCORDING TO THE LATEST FDOT DESIGN STANDARDS INDEX AND FDOT STANDARD SPECIFICATIONS FOR ROAD AND BRIDGE CONSTRUCTION, 2014 EDITION.
12. SIGN LOCATIONS SHOWN ARE APPROXIMATE AND MAY REQUIRE FIELD ADJUSTMENT AS DIRECTED BY THE ENGINEER.
13. ANY EXISTING SIGN TO REMAIN THAT IS DISTURBED DURING CONSTRUCTION SHALL BE RESET TO CURRENT STANDARDS FOR HEIGHT, OFFSET AND METHOD OF INSTALLATION.
14. CAUTION SHALL BE EXERCISED WHILE RELOCATING EXISTING SIGNS SO AS TO PREVENT DAMAGE TO THE SIGNS. IF THE SIGNS ARE DAMAGED BEYOND USE, AS DETERMINED BY THE ENGINEER, THEY SHALL BE REPLACED BY THE CONTRACTOR AT THE CONTRACTOR'S EXPENSE.
15. CONTRACTOR SHALL USE W-SHAPED STEEL POSTS FOR MULTI-POST SIGNS. ALL COLUMNS (POSTS) FOR SINGLE COLUMN GROUND SIGNS SHALL BE ALUMINUM ROUND TUBE.
16. ALL SINGLE POST AND MULTI-POST SIGNS WITHIN THE LIMITS OF THE PROJECT SHALL BE REMOVED UNLESS OTHERWISE SHOWN IN THE PLANS. REMOVAL INCLUDES REMOVING FOUNDATIONS AND BACKFILLING THE HOLES LEFT AFTER REMOVAL.
17. ANY SIGN MOUNTED OVER A SIDEWALK SHALL HAVE A STANDARD VERTICAL CLEARANCE OF 8 FEET.
18. STREET NAME SIGNS THAT ARE NOT SHOWN IN THE GUIDE SIGN WORK SHEET SECTION OF THE PLANS SHALL BE AS PER MANATEE COUNTY DESIGN REQUIREMENTS.

19. SIGNS THAT ARE EMBEDDED IN ASPHALT/CONCRETE SHALL BE INSTALLED IN PIPE SLEEVES.
20. THE CONTRACTOR SHALL BE RESPONSIBLE FOR THE DISPOSAL OF ALL SIGNS THAT ARE TO BE PERMANENTLY REMOVED IN THIS PROJECT.
21. THE CONTRACTOR SHALL APPLY THERMOPLASTIC AS THE FINAL TRAFFIC STRIPES AND MARKINGS A MINIMUM OF 14 DAYS AFTER THE FIRST APPLICATION OF PAINT, BUT PRIOR TO FINAL ACCEPTANCE OF THE PROJECT.



**UPPER MANATEE RIVER ROAD  
ROADWAY FUNCTIONAL  
IMPROVEMENTS  
SIGNING AND PAVEMENT MARKING PLANS  
GENERAL NOTES**

NO.	REVISION DESCRIPTION	BY	DATE

PROJECT #	307-6082660
SURVEY #	FILE 00-42783
SEC./TWN./RGE	19-20, 29-30.34S/19E
SCALE	NTS

	BY	DATE
SURVEYED	ZNS	04/27/12
DESIGNED	PV/PBF	03/18/14
DRAWN	KR/CB	03/18/14
CHECKED	PV/PBF	03/18/14

CHRISTOPHER L. MOWBRAY, P.E.  
FLORIDA P.E. # 46777

*[Signature]*  
11/5/14

Signature & Date

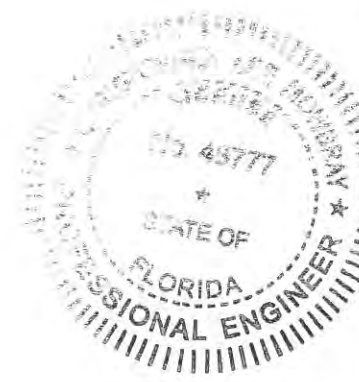

COPYRIGHT 2010 MANATEE COUNTY GOVERNMENT | E:\P\W\Engineering\Shore\Highway\_Engineering\NO\NO5\Upper\_Manatee\_River\_Road\ROADWAY\_FUNCTIONAL\_PLANS\Permanent\_Marking\_and\_Signing\_Plan\Upper\_Manatee\_Sign\_and\_Pave.dwg, December 17, 2014 10:15 AM, AutoCAD, 13, 11117

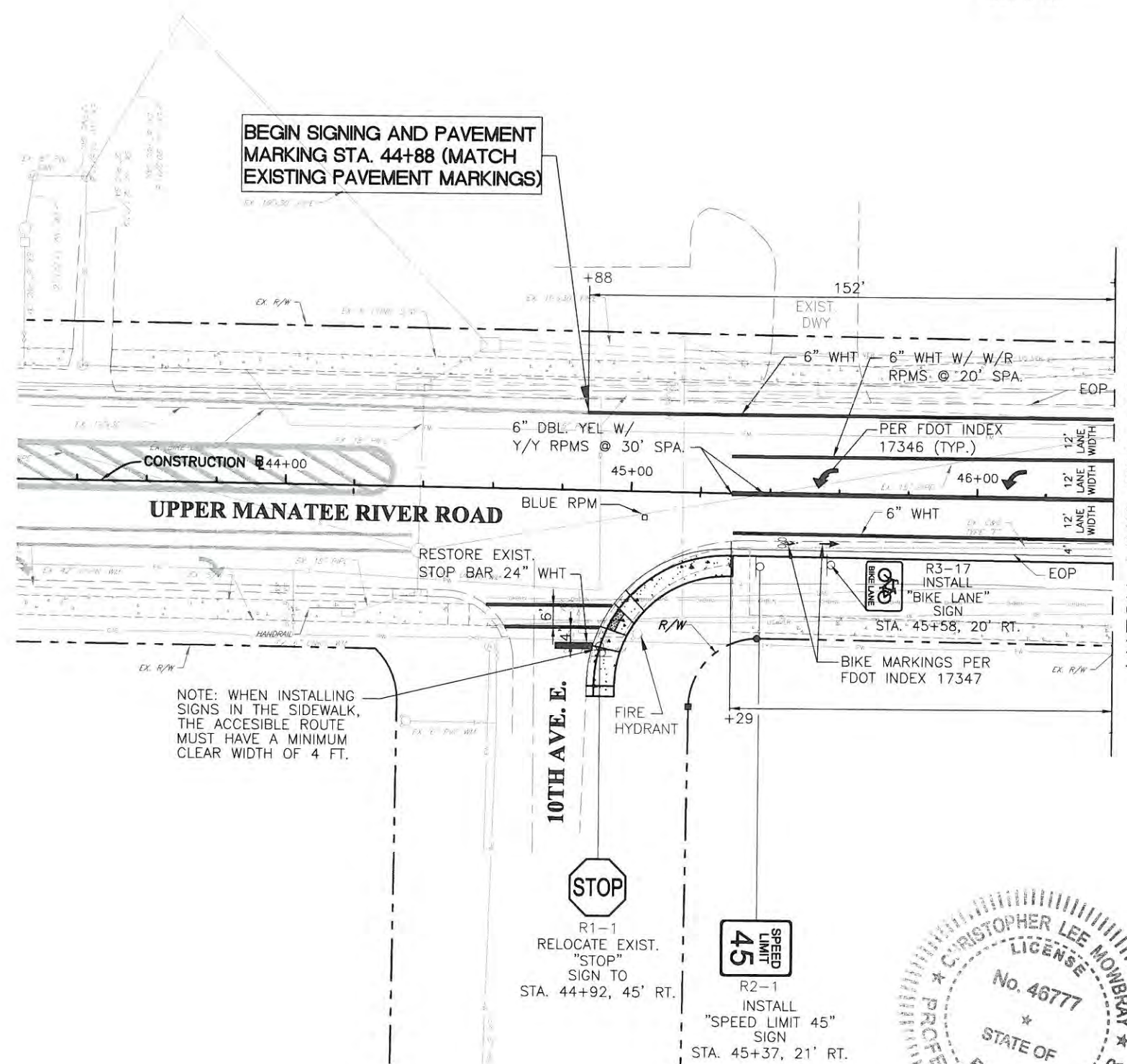
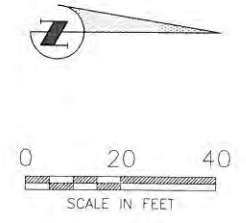

**UPPER MANATEE RIVER ROAD  
ROADWAY FUNCTIONAL  
IMPROVEMENTS  
SIGNING AND PAVEMENT MARKING PLANS  
STA. 45+00 TO 46+40**

NO.	REVISION DESCRIPTION	BY	DATE

PROJECT #	307-6082660
SURVEY #	FILE 00-42783
SEC./TWN./RGE	19-20, 29-30.34S/19E
SCALE	1"=40'

	BY	DATE
SURVEYED	ZNS	04/27/12
DESIGNED	PV/PBF	03/18/14
DRAWN	KR/CB	03/18/14
CHECKED	PV/PBF	03/18/14

CHRISTOPHER L. MOWBRAY, P.E.  
FLORIDA P.E. # 46777

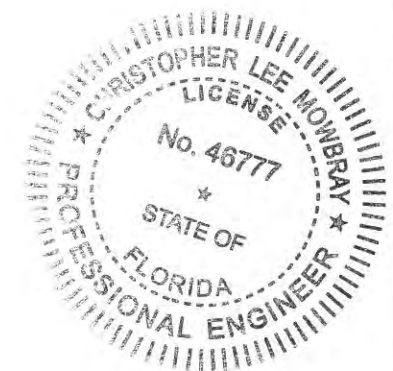

*Christopher Lee Mowbray*  
1/5/14

Signature & Date

COPYRIGHT 2010 MANATEE COUNTY GOVERNMENT | S:\P\0 - Engineering - Shared\Highway Engineering\ROADS\Upper Manatee River Road\TRAFFIC PLANS Pavement Marking and Signing Plan\Upper Manatee Sign and Pavement.dwg, 11/3/2014 10:43 AM, John Regis, 12, 11/17

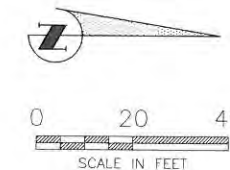

**UPPER MANATEE RIVER ROAD  
ROADWAY FUNCTIONAL  
IMPROVEMENTS  
SIGNING AND PAVEMENT MARKING PLANS  
STA. 46+40 TO 51+40**

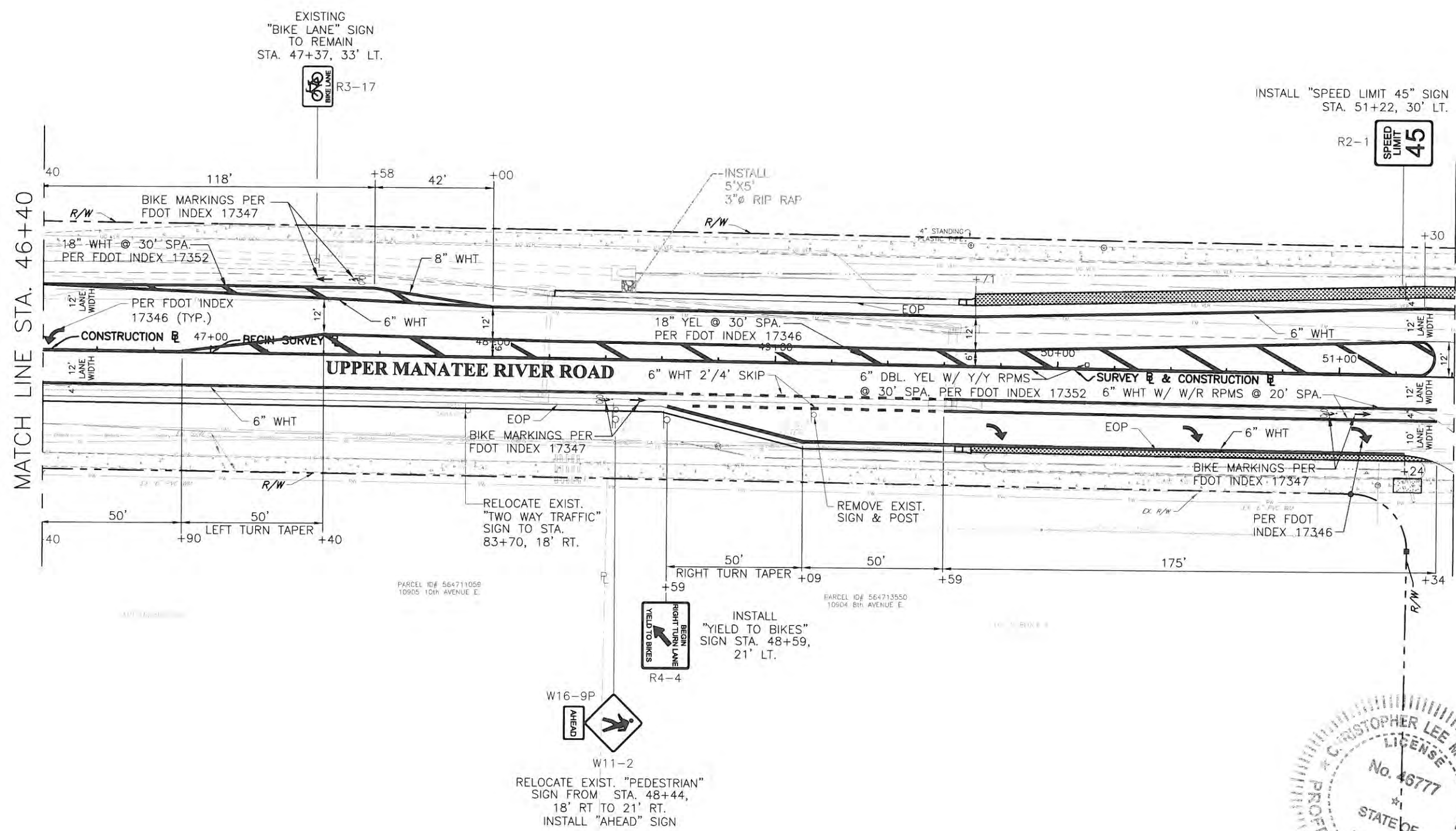

MATCH LINE STA. 46+40

MATCH LINE STA. 51+40

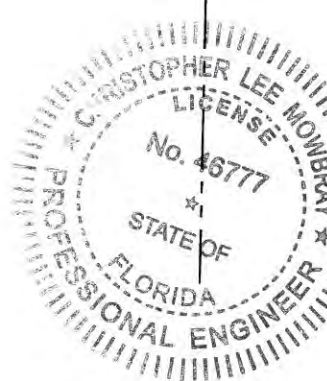

NO.	REVISION DESCRIPTION	BY	DATE

PROJECT #	307-6082660
SURVEY #	FILE 00-42783
SEC./TWN./RGE	19-20, 29-30.34S/19E
SCALE	1"=40'

	BY	DATE
SURVEYED	ZNS	04/27/12
DESIGNED	PV/PBF	03/18/14
DRAWN	KR/CB	03/18/14
CHECKED	PV/PBF	03/18/14

CHRISTOPHER L. MOWBRAY, P.E.  
FLORIDA P.E. # 46777

*Chris Lee Mowbray*  
11/15/14

Signature & Date

COPYRIGHT 2010 MANATEE COUNTY GOVERNMENT | S:\P\W\Engineering\Shared\Highway\_Engineering\ROADS\Upper Manatee River Road\TRAFFIC PLANS\Pavement Marking and Signing Plan\Upper Manatee Sign and Pavement.dwg, 11/15/2014 10:43 AM Carla Boley, 1:2, 11x17

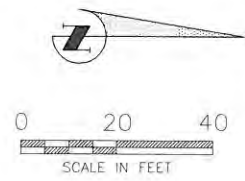

**UPPER MANATEE RIVER ROAD**  
**ROADWAY FUNCTIONAL**  
**IMPROVEMENTS**  
**SIGNING AND PAVEMENT MARKING PLANS**  
**STA. 51+40 TO 56+70**

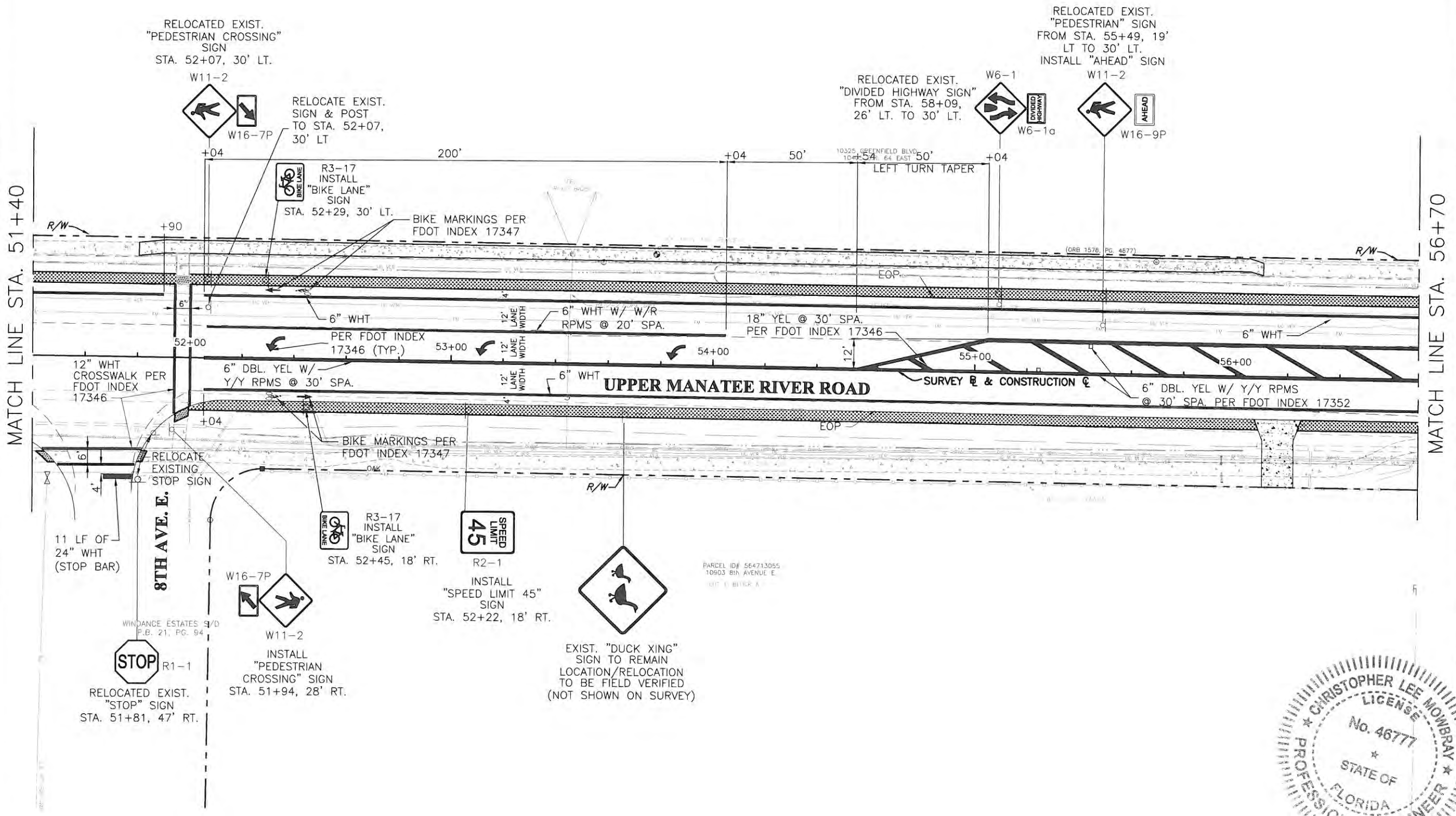

NO.	REVISION DESCRIPTION	BY	DATE

PROJECT #	307-6082660
SURVEY #	FILE 00-42783
SEC./TWN./RGE	19-20, 29-30,34S/19E
SCALE	1"=40'
BY	DATE
SURVEYED	ZNS 04/27/12
DESIGNED	PV/PBF 03/18/14
DRAWN	KR/CB 03/18/14
CHECKED	PV/PBF 03/18/14
CHRISTOPHER L. MOWBRAY, P.E. FLORIDA P.E. # 46777	

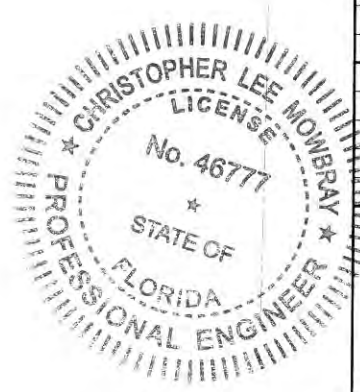

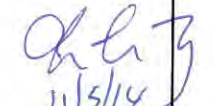
  
 Signature & Date  
 11/5/14

COPYRIGHT 2010 MANATEE COUNTY GOVERNMENT | S:\P\W\Engineering\Shared\Highway Engineering\Roads\Upper Manatee River Road\DWG\Traffic Plans\Pavement Marking and Signing Plan\Upper Manatee Sign and Pavement Marking.dwg, 11/3/2014 10:44 AM Scott Ripley, 1,2, 11417

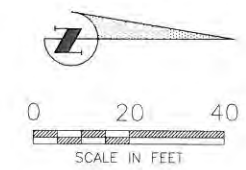

**UPPER MANATEE RIVER ROAD  
ROADWAY FUNCTIONAL  
IMPROVEMENTS  
SIGNING AND PAVEMENT MARKING PLANS  
STA. 56+70 TO 62+00**

MATCH LINE STA. 56+70

MATCH LINE STA. 62+00

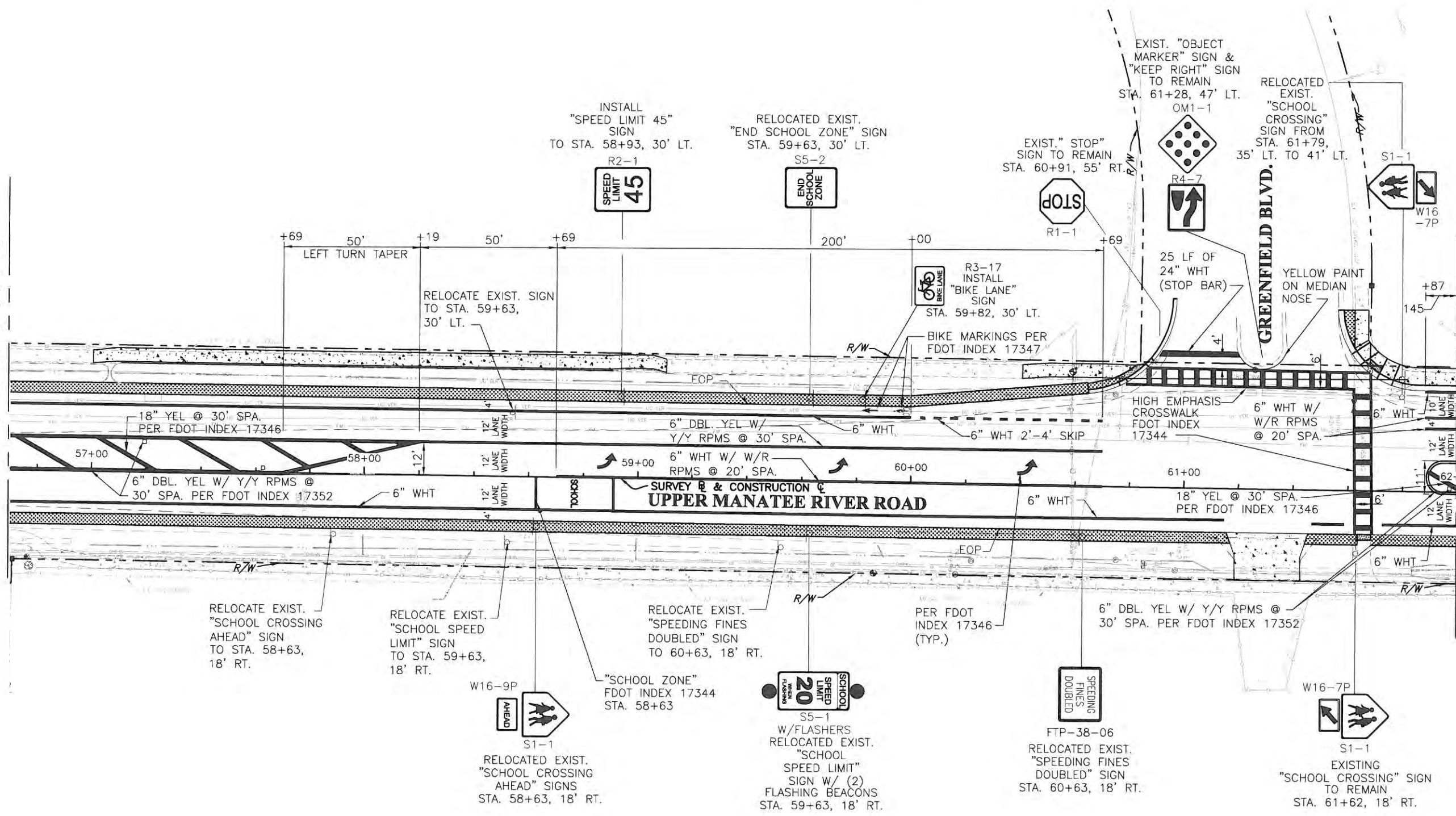

RELOCATE EXIST. "SCHOOL CROSSING AHEAD" SIGN TO STA. 58+63, 18' RT.

RELOCATE EXIST. "SCHOOL SPEED LIMIT" SIGN TO STA. 59+63, 18' RT.

RELOCATE EXIST. "SPEEDING FINES DOUBLED" SIGN TO 60+63, 18' RT.

"SCHOOL ZONE" FDOT INDEX 17344 STA. 58+63

W16-9P  
S1-1  
RELOCATED EXIST. "SCHOOL CROSSING AHEAD" SIGNS STA. 58+63, 18' RT.

S5-1  
W/FLASHERS  
RELOCATED EXIST. "SCHOOL SPEED LIMIT" SIGN W/ (2) FLASHING BEACONS STA. 59+63, 18' RT.

FTP-38-06  
RELOCATED EXIST. "SPEEDING FINES DOUBLED" SIGN STA. 60+63, 18' RT.

W16-7P  
S1-1  
EXISTING "SCHOOL CROSSING" SIGN TO REMAIN STA. 61+62, 18' RT.

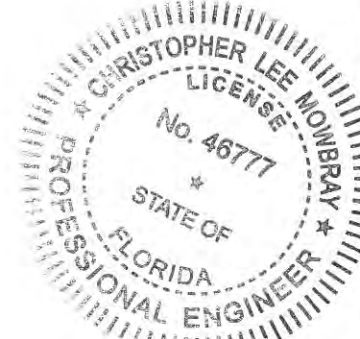

NO.	REVISION DESCRIPTION	BY	DATE

PROJECT #	307-6082660
SURVEY #	FILE 00-42783
SEC./TWN./RGE	19-20, 29-30,34S/19E
SCALE	1"=40'

	BY	DATE
SURVEYED	ZNS	04/27/12
DESIGNED	PV/PBF	03/18/14
DRAWN	KR/CB	03/18/14
CHECKED	PV/PBF	03/25/14

CHRISTOPHER L. MOWBRAY, P.E.  
FLORIDA P.E. # 46777  
*Chris Mowbray*  
11/9/14  
Signature & Date

COPYRIGHT 2010, MANATEE COUNTY GOVERNMENT. S:\P\00\_Engineering\_Signing\Highway\_Engineering\ROADS\Upper Manatee River Road\TRAFFIC PLANS\ Pavement Marking and Signing Plan\Upper Manatee Sign and Pavement Marking\_11/3/2014\_10:44 AM Scott Egley\_1,2, 11/17

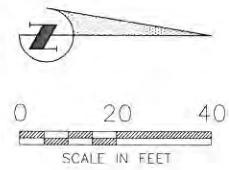

**UPPER MANATEE RIVER ROAD  
ROADWAY FUNCTIONAL  
IMPROVEMENTS  
SIGNING AND PAVEMENT MARKING PLAN  
STA. 62+00 TO 67+30**

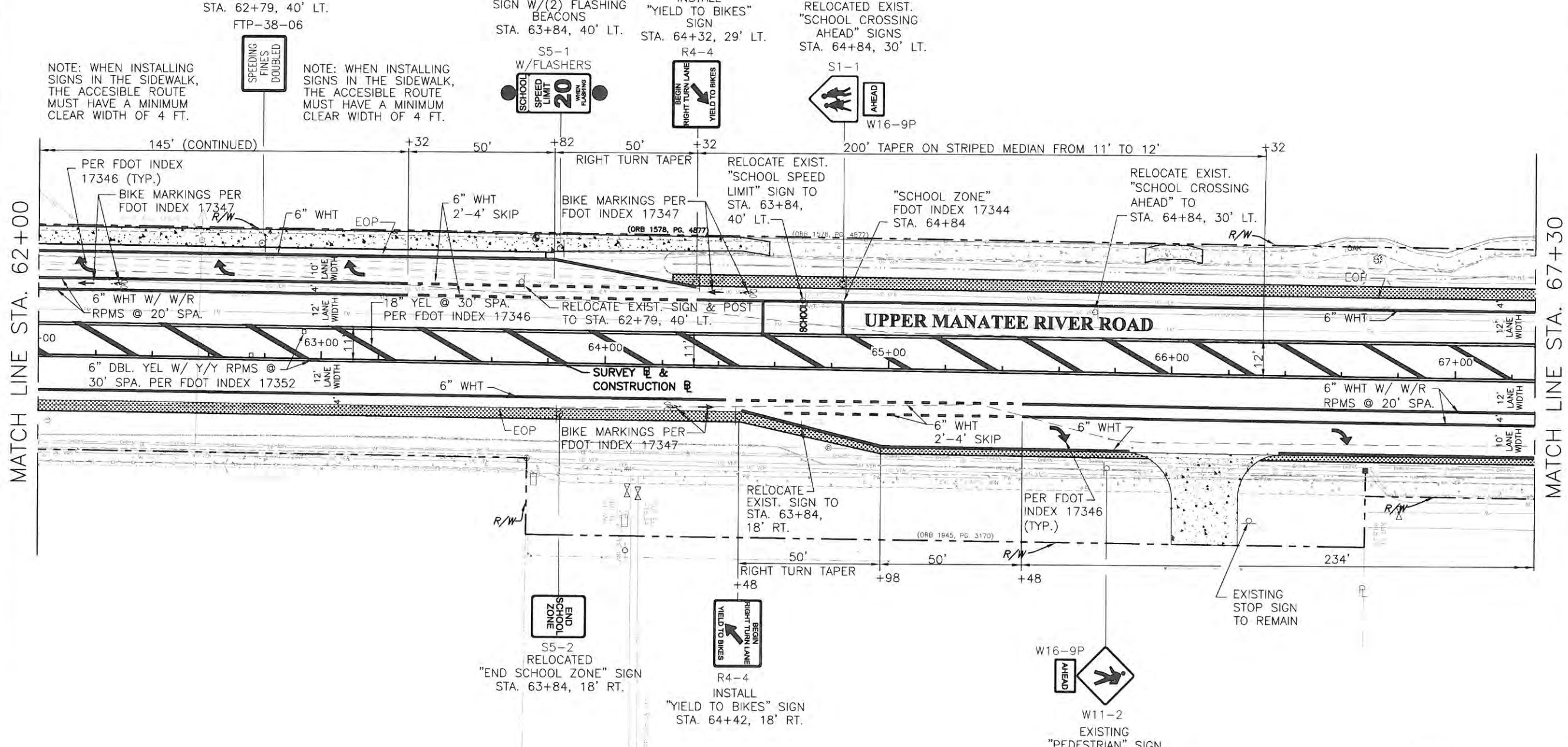

NOTE: WHEN INSTALLING SIGNS IN THE SIDEWALK, THE ACCESSIBLE ROUTE MUST HAVE A MINIMUM CLEAR WIDTH OF 4 FT.

RELOCATED EXIST. "SPEEDING FINE DOUBLED" SIGN STA. 62+79, 40' LT. FTP-38-06

RELOCATED EXIST. "SCHOOL SPEED LIMIT" SIGN W/(2) FLASHING BEACONS STA. 63+84, 40' LT.

INSTALL "YIELD TO BIKES" SIGN STA. 64+32, 29' LT.

RELOCATED EXIST. "SCHOOL CROSSING AHEAD" SIGNS STA. 64+84, 30' LT.

RELOCATED "END SCHOOL ZONE" SIGN STA. 63+84, 18' RT.

INSTALL "YIELD TO BIKES" SIGN STA. 64+42, 18' RT.

EXISTING "PEDESTRIAN" SIGN TO REMAIN INSTALL "AHEAD" SIGN STA. 65+78, 33.5' RT.

MATCH LINE STA. 62+00

MATCH LINE STA. 67+30

NO.	REVISION DESCRIPTION	BY	DATE

PROJECT #	307-6082660
SURVEY #	FILE 00-42783
SEC./TWN./RGE	19-20, 29-30, 34S/19E
SCALE	1"=40'

	BY	DATE
SURVEYED	ZNS	04/27/12
DESIGNED	PV/PBF	03/18/14
DRAWN	KR/CB	03/18/14
CHECKED	PV/PBF	03/18/14

CHRISTOPHER L. MOWBRAY, P.E.  
FLORIDA P.E. # 46777

*Christopher L. Mowbray*  
10/15/14  
Signature & Date

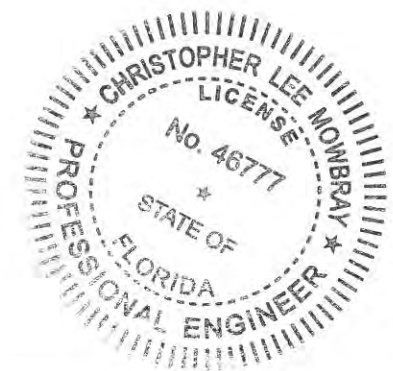

COPYRIGHT 2010 MANATEE COUNTY GOVERNMENT | S:\P\W\Engineering\Sharon\Highway Engineering\ROADS\Upper Manatee River Road\TRAFFIC PLANS\Government Marking and Signing Plan\Upper Manatee River Road.dwg, 11/23/2014, 10:44 AM Kevin Reilly, L2, 11x17

COPYRIGHT 2010, MANATEE COUNTY GOVERNMENT 15:PW00\_Engineering/Share/Highway\_Engineering/ROADS/Upper Manatee River Road/DWG/TRAFFIC PLANS/Government Marking and Signing Plan/Upper Manatee Sign and Pavement/12-11x17

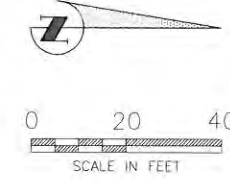

**UPPER MANATEE RIVER ROAD  
ROADWAY FUNCTIONAL  
IMPROVEMENTS  
SIGNING AND PAVEMENT MARKING PLANS  
STA. 67+30 TO 72+60**

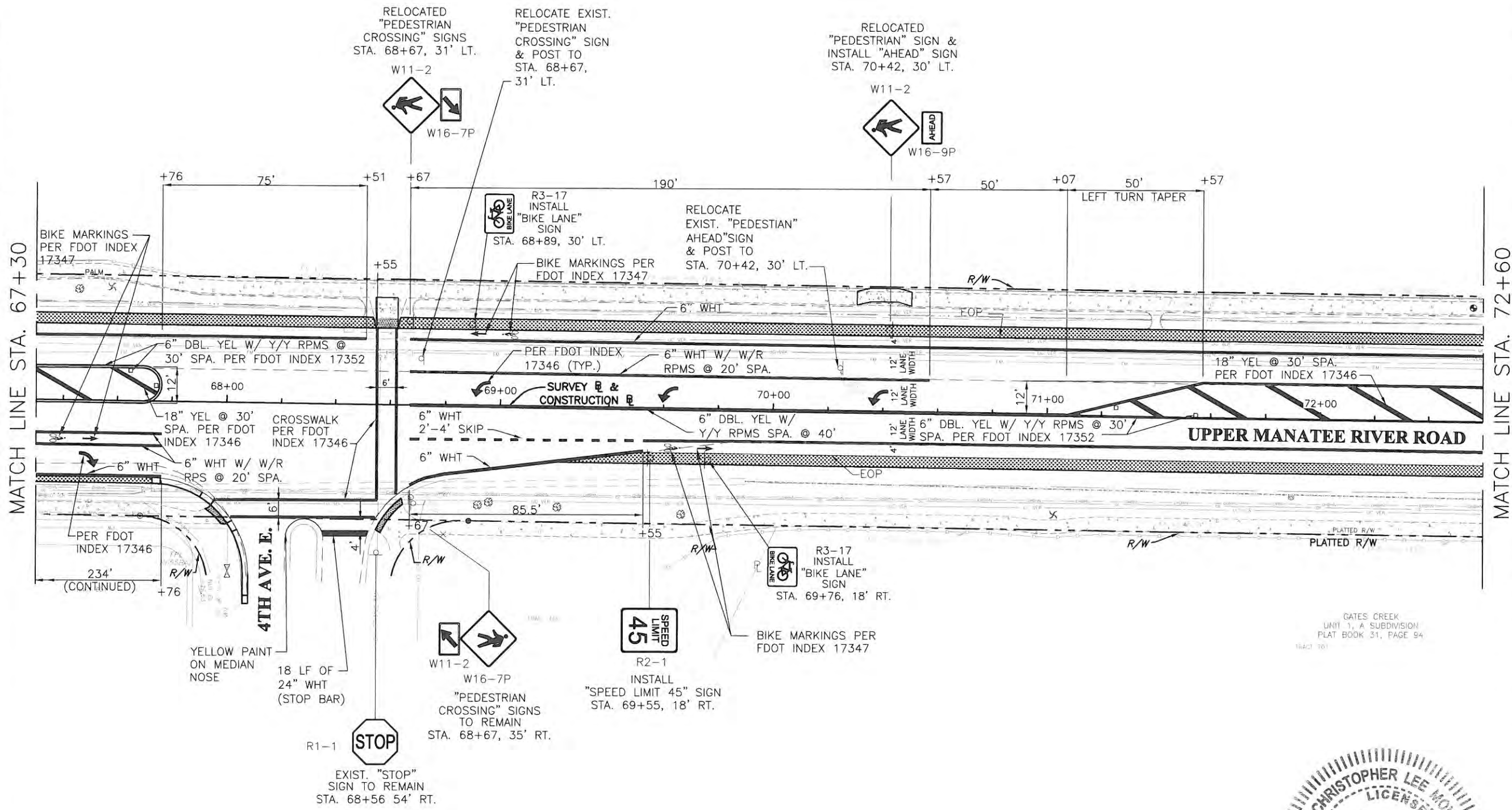

MATCH LINE STA. 72+60

MATCH LINE STA. 67+30

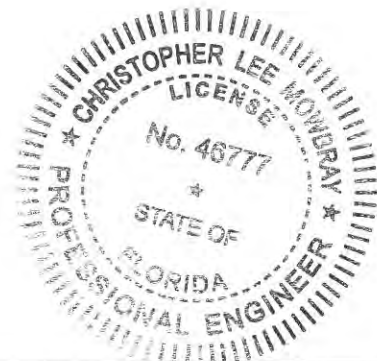

NO.	REVISION DESCRIPTION	BY	DATE

PROJECT #	307-6082660
SURVEY #	FILE 00-42783
SEC./TWN./RGE	19-20, 29-30, 34S/19E
SCALE	1"=40'

	BY	DATE
SURVEYED	ZNS	04/27/12
DESIGNED	PV/PBF	03/18/14
DRAWN	KR/CB	03/18/14
CHECKED	PV/PBF	03/18/14

CHRISTOPHER L. MOWBRAY, P.E.  
FLORIDA P.E. # 46777

*Christopher Lee Mowbray*  
11/5/14  
Signature & Date

SHEET 8



COPYRIGHT 2010, MANATEE COUNTY GOVERNMENT, S:\P\W\Engineering\Share\Highway\Engineering\ROADS\Upper Manatee River Road\DWG\TRAFFIC PLANS\ Pavement Marking and Signing\Plan\Upper Manatee Sign and Pavement\DRMkg\_11/13/2014\_10:45 AM.kwb Rfpry\_1,2\_11x17

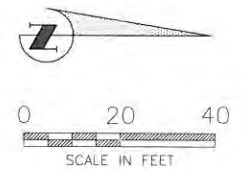

**UPPER MANATEE RIVER ROAD  
ROADWAY FUNCTIONAL  
IMPROVEMENTS  
SIGNING AND PAVEMENT MARKING PLANS  
STA. 72+60 TO 77+90**

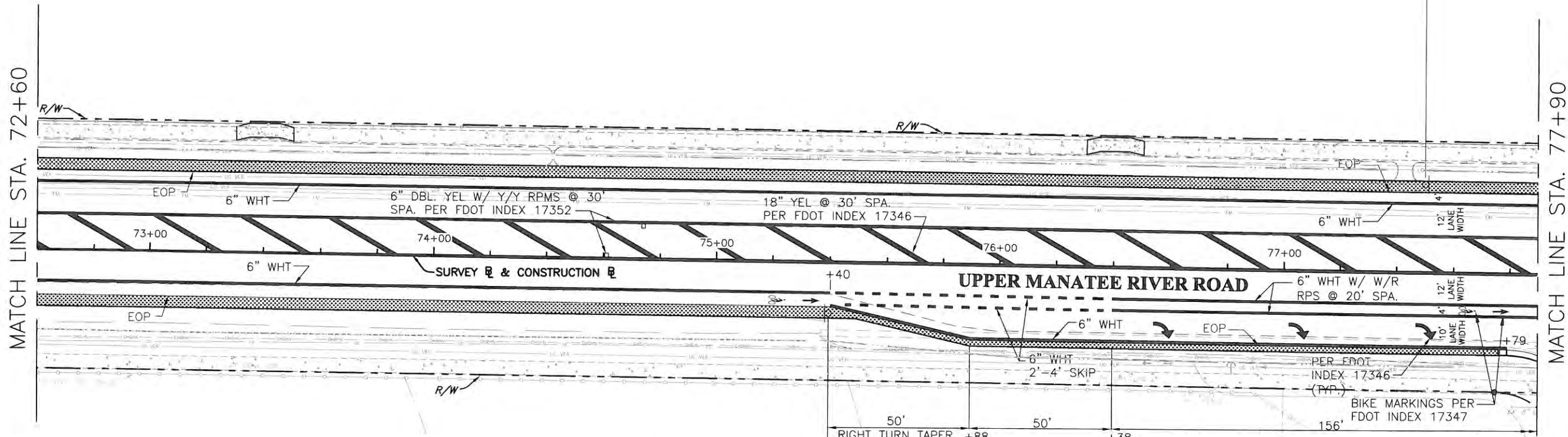

INSTALL  
"SPEED LIMIT 45"  
SIGN  
TO STA. 77+50, 31' LT.  
R2-1



PARCEL ID# 566801155  
NO ASSIGNED ADDRESS

R4-4  
INSTALL  
"YIELD TO BIKES" SIGN  
STA. 75+38, 18' RT.



TRACT 503  
PARCEL ID# 564604858  
NO ASSIGNED ADDRESS

TRACT 503  
PARCEL ID# 564608006  
NO ASSIGNED ADDRESS

PARCEL ID# 564606156  
NO ASSIGNED ADDRESS

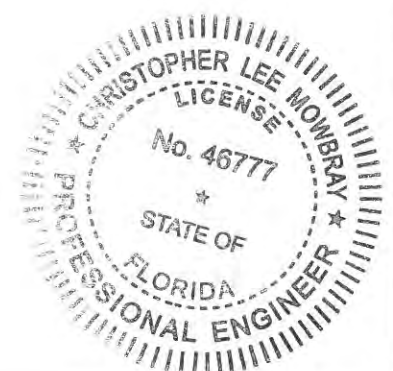

NO.	REVISION DESCRIPTION	BY	DATE

PROJECT #	307-6082660
SURVEY #	FILE 00-42783
SEC./TWN./RGE	19-20, 29-30, 34S/19E
SCALE	1"=40'

	BY	DATE
SURVEYED	ZNS	04/27/12
DESIGNED	PV/PBF	03/18/14
DRAWN	KR/CB	03/18/14
CHECKED	PV/PBF	03/18/14

CHRISTOPHER L. MOWBRAY, P.E.  
FLORIDA P.E. # 46777

*Christopher Lee Mowbray*  
11/18/14  
Signature & Date



PUBLIC WORKS DEPARTMENT  
ENGINEERING SERVICES  
1022 26th Avenue East, Bradenton, FL 34208

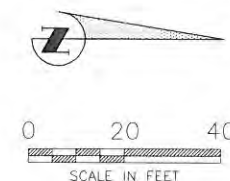

PARCEL ID# 564900002  
10B UPPER MANATEE RIVER RD.

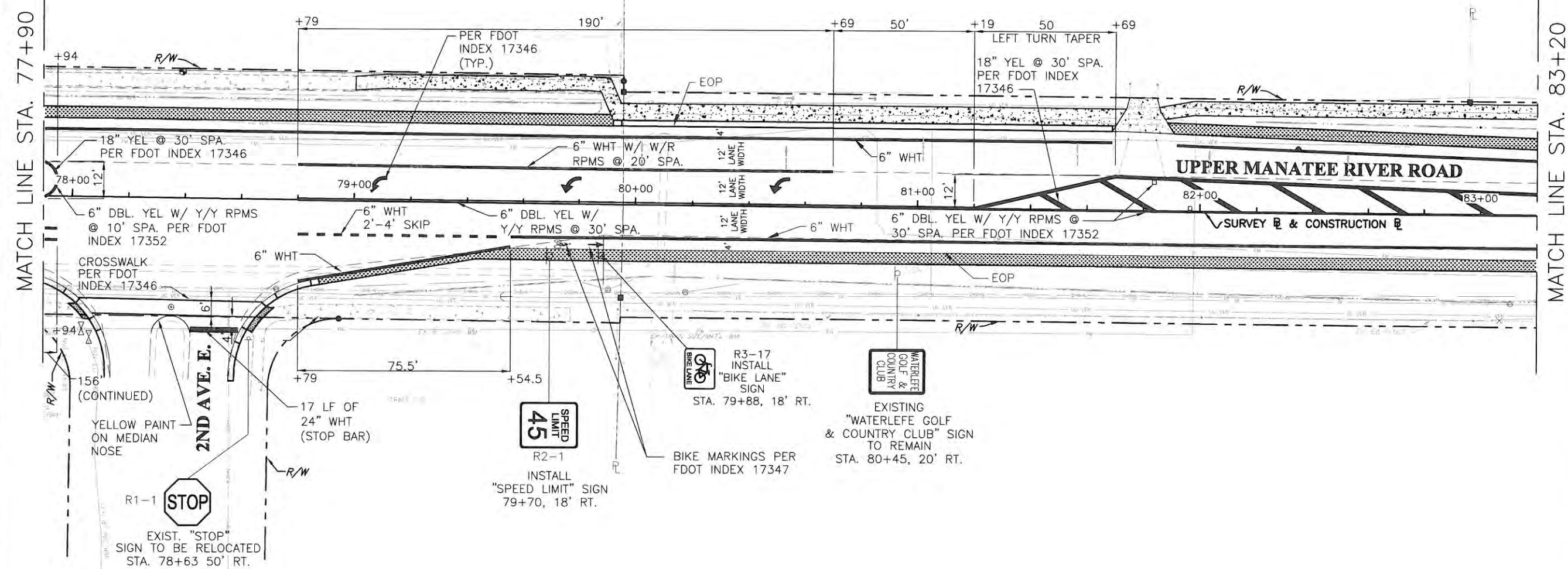

**UPPER MANATEE RIVER ROAD  
ROADWAY FUNCTIONAL  
IMPROVEMENTS  
SIGNING AND PAVEMENT MARKING PLANS  
STA. 77+90 TO 83+20**

NO.	REVISION DESCRIPTION	BY	DATE

PROJECT #	307-6082660
SURVEY #	FILE 00-42783
SEC./TWN./RGE	19-20
SCALE	28-30.345/19E 1"=40' HORIZ. 1"=4' VERT.

	BY	DATE
SURVEYED	ZNS	04/27/12
DESIGNED	PV/PBF	03/18/14
DRAWN	KR/CB	03/18/14
CHECKED	PV/PBF	03/18/14

CHRISTOPHER L. MOWBRAY, P.E.  
FLORIDA P.E. # 46777

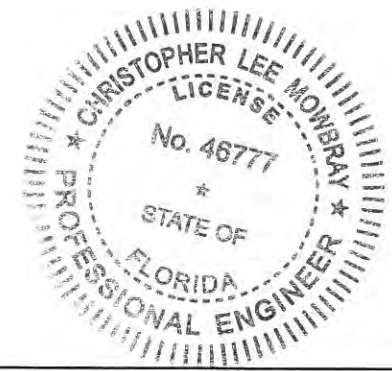

*Chris Mowbray*  
11/5/14  
Signature & Date

COPYRIGHT 2010 MANATEE COUNTY GOVERNMENT. S:\PWD\_Engineering\Shore\Highway\_Engineering\RD005\Upper Manatee River Road\DWG\TRAFFIC PLANS\ Pavement Marking and Signing Plan\Upper Manatee Sign and Pavement\DMG.dwg, 11/3/2014 10:46 AM Mario Ripley, 12, 11x17

COPYRIGHT 2010 - MANATEE COUNTY GOVERNMENT | S:\P\01\_Engineering\_Shera\Highway\_Engineering\ROADS\Upper Manatee River Road\DWG\TRAFFIC\_PLANS\ Pavement\_Marking\_and\_Signing\_Plan\Upper Manatee Sign and Pave.dwg(01)Mag. 11/3/2014 10:46 AM Karla Reley. 12, 11x17

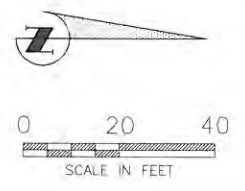

MATCH LINE STA. 83+20

MATCH LINE STA. 88+50

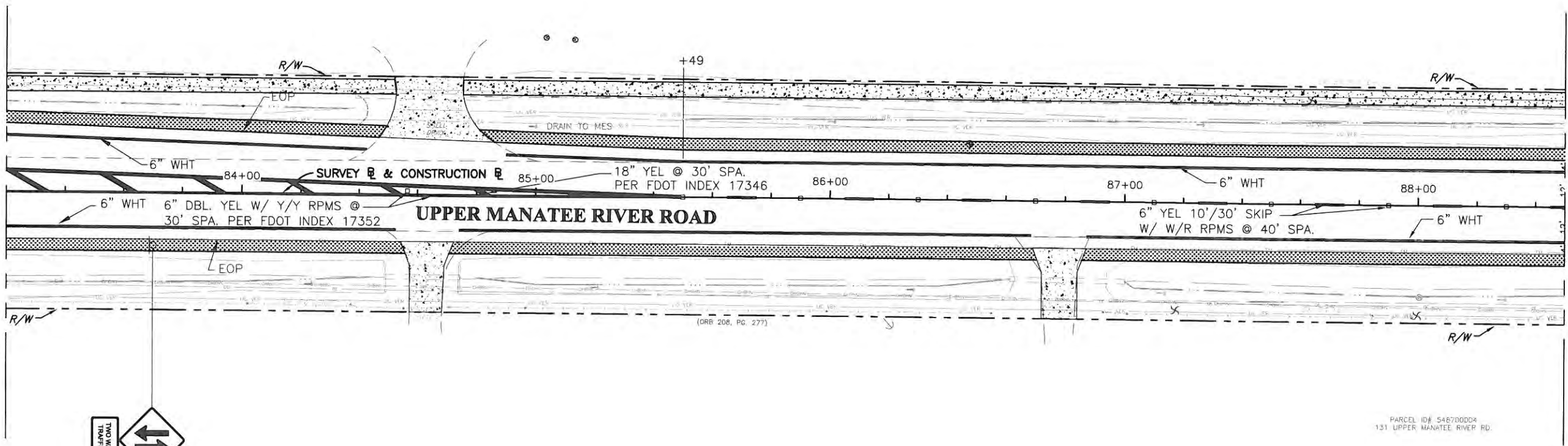

  
 W6-3  
 RELOCATED  
 "TWO WAY TRAFFIC"  
 SIGNS  
 STA. 83+70, 18' RT.

**UPPER MANATEE RIVER ROAD**  
**ROADWAY FUNCTIONAL**  
**IMPROVEMENTS**  
**SIGNING AND PAVEMENT MARKING PLANS**  
**STA. 83+20 TO 88+50**

NO.	REVISION DESCRIPTION	BY	DATE

PROJECT #	307-6082660
SURVEY #	FILE 00-42783
SEC./TWN./RGE	19-20, 29-30.34S/19E
SCALE	1"=40'

	BY	DATE
SURVEYED	ZNS	04/27/12
DESIGNED	PV/PBF	03/18/14
DRAWN	KR/CB	03/18/14
CHECKED	PV/PBF	03/18/14

CHRISTOPHER L. MOWBRAY, P.E.  
 FLORIDA P.E. # 46777

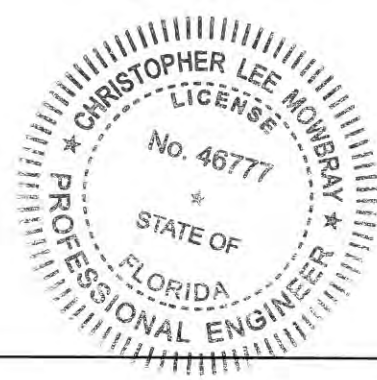

  
 11/5/14  
 Signature & Date

COPYRIGHT 2010 - MANATEE COUNTY GOVERNMENT | S:\PWD\_Engineering\Shore\Highway\_Engineering\ROADS\Upper Manatee River Road\DWG\TRAFFIC PLANS\ Pavement Marking and Signing Plan\Upper Manatee Sup and Pave.dwg, 01/24/14, 11/5/2014, 10:46 AM, Gloria Raley, 1:2, 11x17

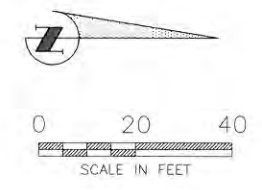

MATCH LINE STA. 88+50

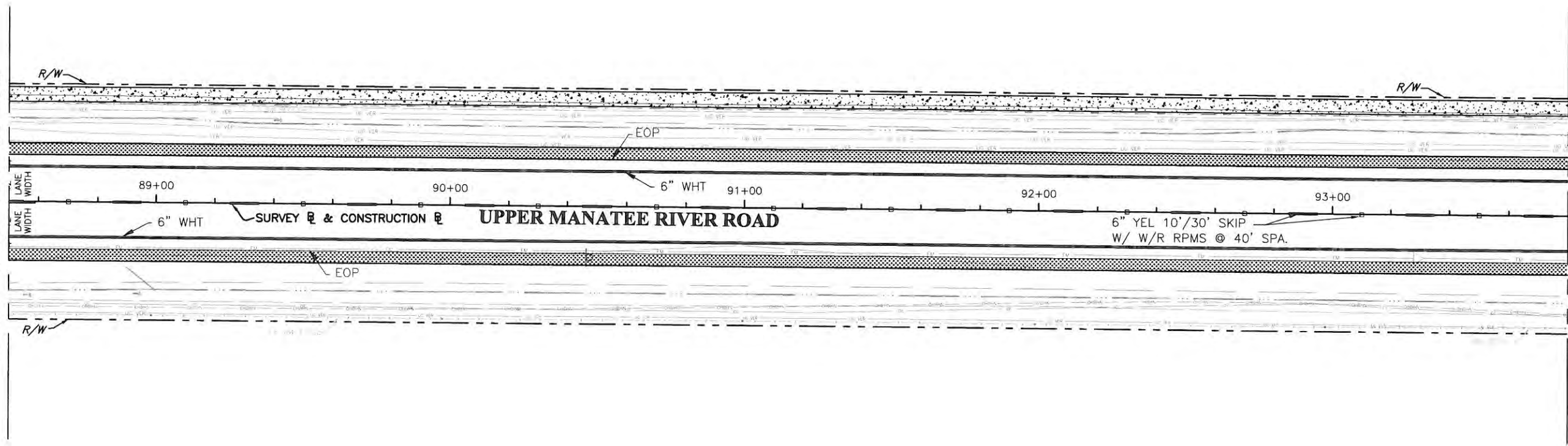

MATCH LINE STA. 93+80

**UPPER MANATEE RIVER ROAD  
ROADWAY FUNCTIONAL  
IMPROVEMENTS  
SIGNING AND PAVEMENT MARKING PLANS  
STA. 88+50 TO 93+80**

NO.	REVISION DESCRIPTION	BY	DATE

PROJECT #	307-6082660
SURVEY #	FILE 00-42783
SEC./TWN./RGE	19-20, 29-30,34S/19E
SCALE	1"=40'

	BY	DATE
SURVEYED	ZNS	04/27/12
DESIGNED	PV/PBF	03/18/14
DRAWN	KR/CB	03/18/14
CHECKED	PV/PBF	03/18/14

CHRISTOPHER L. MOWBRAY, P.E.  
FLORIDA P.E. # 46777

*Chiz*  
11/5/14

Signature & Date

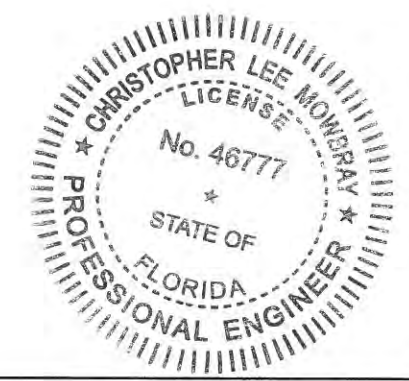

COPYRIGHT 2010, MANATEE COUNTY GOVERNMENT | S:\PWD\_Engineering\Share\Highway\_Engineering\ROADS\Upper Manatee River Road\DWG\TRAFFIC PLANS\Government Marking and Signing Plan\Upper Manatee Sign and Phase.dwg(13Mag, 3/17/2010 10:47 AM Scott Raley, 12, 11417

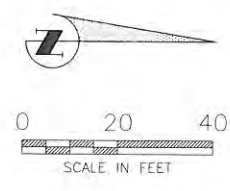

**UPPER MANATEE RIVER ROAD**  
**ROADWAY FUNCTIONAL**  
**IMPROVEMENTS**  
**SIGNING AND PAVEMENT MARKING PLANS**  
**STA. 93+80 TO 99+10**

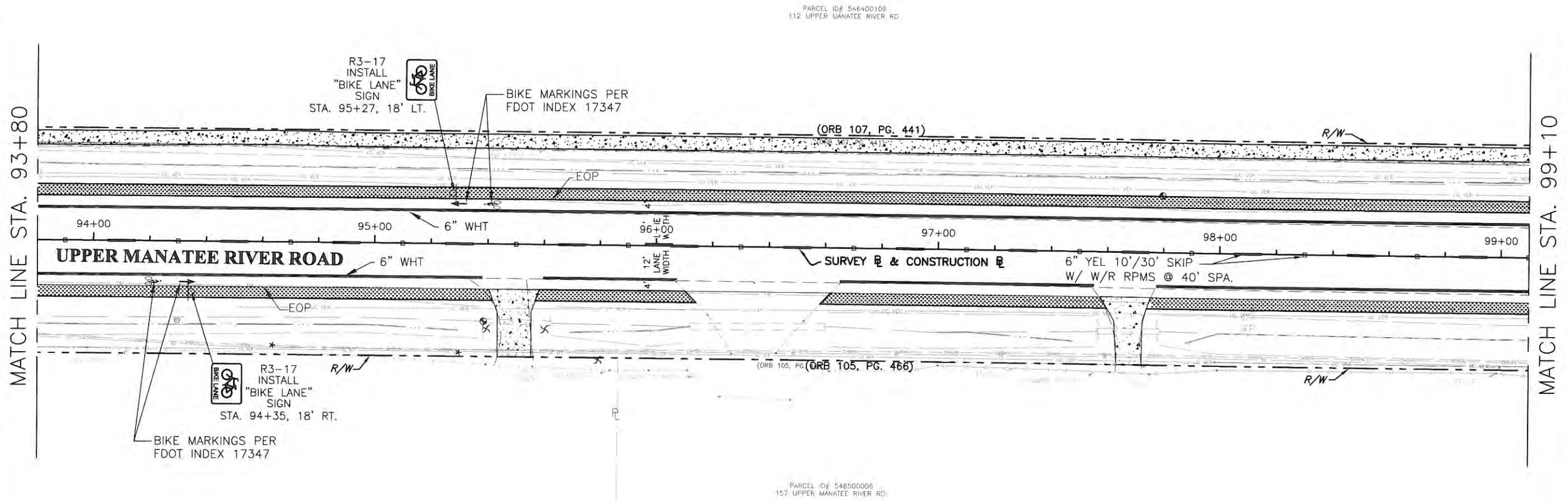

PARCEL ID# 546400109  
112 UPPER MANATEE RIVER RD.

PARCEL ID# 548500008  
157 UPPER MANATEE RIVER RD.

MATCH LINE STA. 99+10

MATCH LINE STA. 93+80

NO.	REVISION DESCRIPTION	BY	DATE

PROJECT #	307-6082660
SURVEY #	FILE 00-42783
SEC./TWN./RGE	19-20, 29-30,34S/19E
SCALE	1"=40'

	BY	DATE
SURVEYED	ZNS	04/27/12
DESIGNED	PV/PBF	03/18/14
DRAWN	KR/CB	03/18/14
CHECKED	PV/PBF	03/18/14

CHRISTOPHER L. MOWBRAY, P.E.  
FLORIDA P.E. # 46777

  
 Signature & Date  
 11/5/14

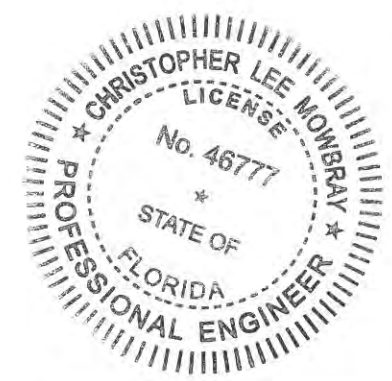

COPYRIGHT 2010 MANATEE COUNTY GOVERNMENT S:\PWD\_Engineering\_Sign\Highway\_Engineering\ROADS\Upper Manatee River Road\DWG\TRAFFIC PLANS\Pavement Marking and Signing Plan\Upper Manatee Sign and Pavement.dwg, 11/13/2014 10:47 AM Kara Bigley, 1,2, 11/17

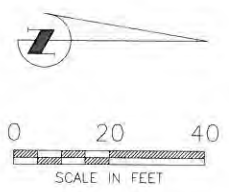

**UPPER MANATEE RIVER ROAD  
ROADWAY FUNCTIONAL  
IMPROVEMENTS  
SIGNING AND PAVEMENT MARKING PLANS  
STA. 99+10 TO STA. 104+40**

MATCH LINE STA. 99+10

MATCH LINE STA. 104+40

INSTALL  
"SPEED LIMIT 45"  
SIGN  
TO STA. 103+55, 22' LT.  
R2-1

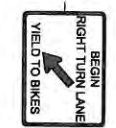
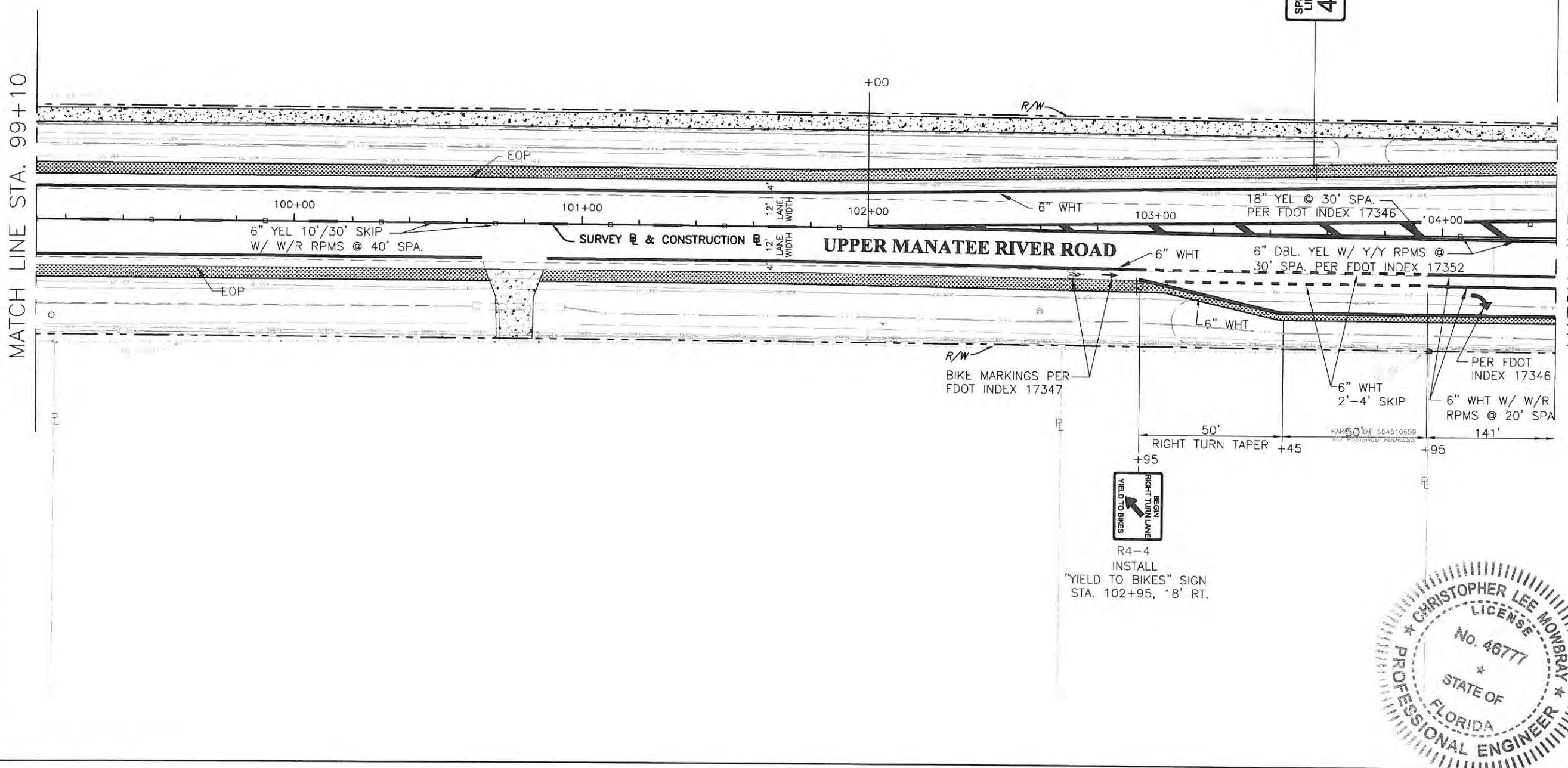

R4-4  
INSTALL  
"YIELD TO BIKES" SIGN  
STA. 102+95, 18' RT.

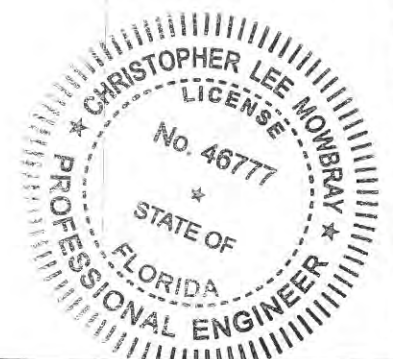

NO.	REVISION DESCRIPTION	BY	DATE

PROJECT #	307-6082660
SURVEY #	FILE 00-42783
SEC./TWN./RGE	19-20, 29-30,34S/19E
SCALE	1"=40'

  

	BY	DATE
SURVEYED	ZNS	04/27/12
DESIGNED	PV/PBF	03/18/14
DRAWN	KR/CB	03/18/14
CHECKED	PV/PBF	03/18/14

CHRISTOPHER L. MOWBRAY, P.E.  
FLORIDA P.E. # 46777

*Chris*  
11/15/14

Signature & Date

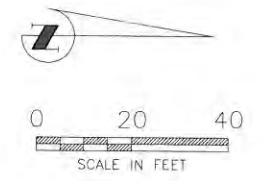

**UPPER MANATEE RIVER ROAD  
ROADWAY FUNCTIONAL  
IMPROVEMENTS  
SIGNING AND PAVEMENT MARKING PLANS  
STA. 104+40 TO STA. 109+70**

MATCH LINE STA. 104+40

MATCH LINE STA. 109+70

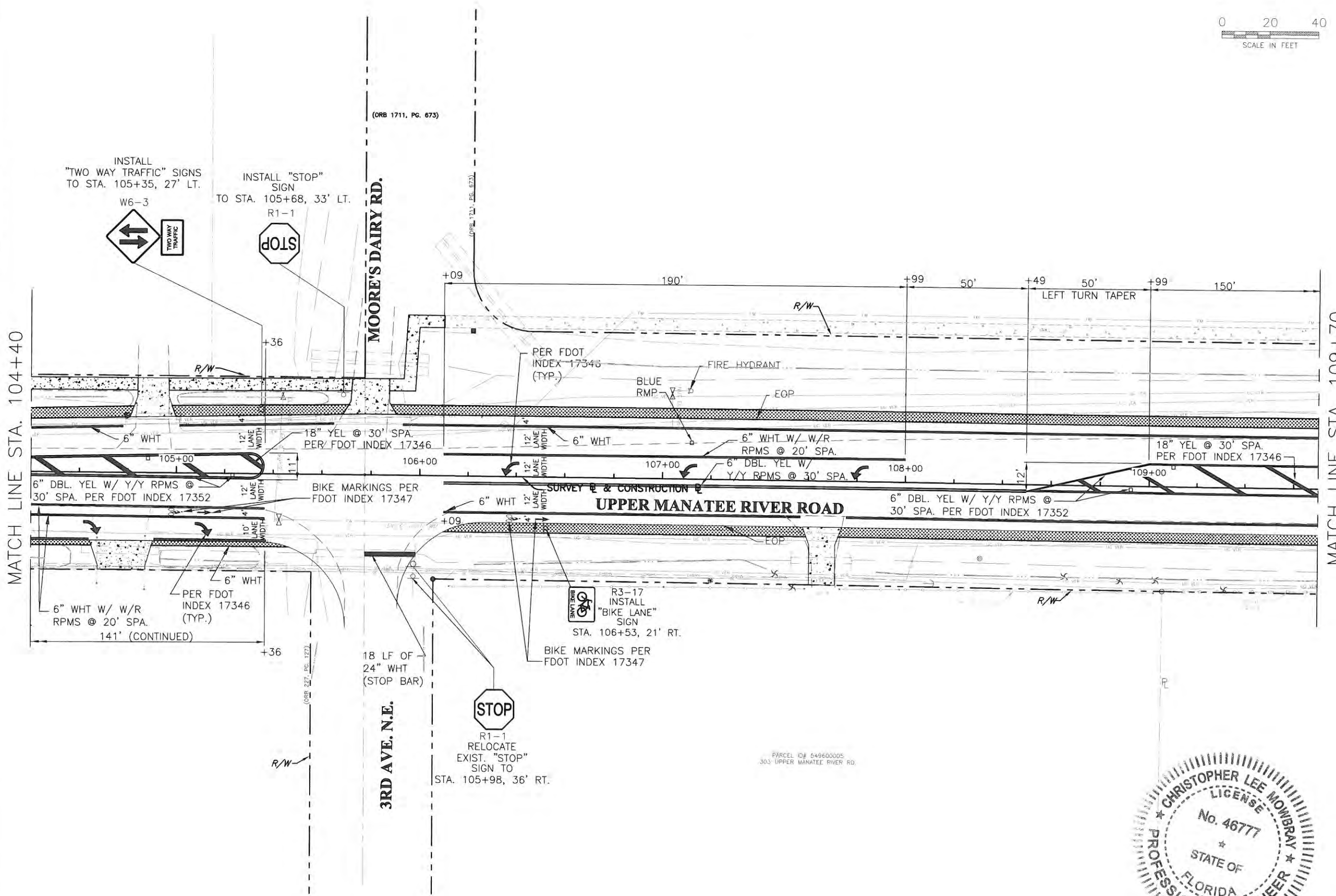

COPYRIGHT 2010, MANATEE COUNTY GOVERNMENT | S:\PW\Engineering\Shared\Highway\Engineering\Roads\Upper Manatee River Road\TRAFFIC PLANS\ Pavement Marking and Signing Plan\Upper Manatee Sign and Pavement\01504g\_11/13/2014 10:47 AM Koria Raley\_12\_11x17

NO.	REVISION DESCRIPTION	BY	DATE

PROJECT #	307-6082660
SURVEY #	FILE 00-42783
SEC./TWN./RGE	19-20, 29-30,34S/19E
SCALE	1"=40'

	BY	DATE
SURVEYED	ZNS	04/27/12
DESIGNED	PV/PBF	03/18/14
DRAWN	KR/CB	03/18/14
CHECKED	PV/PBF	03/18/14

CHRISTOPHER L. MOWBRAY, P.E.  
FLORIDA P.E. # 46777

*Christopher L. Mowbray*  
11/15/14  
Signature & Date

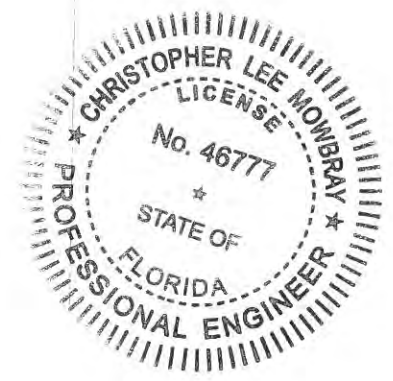

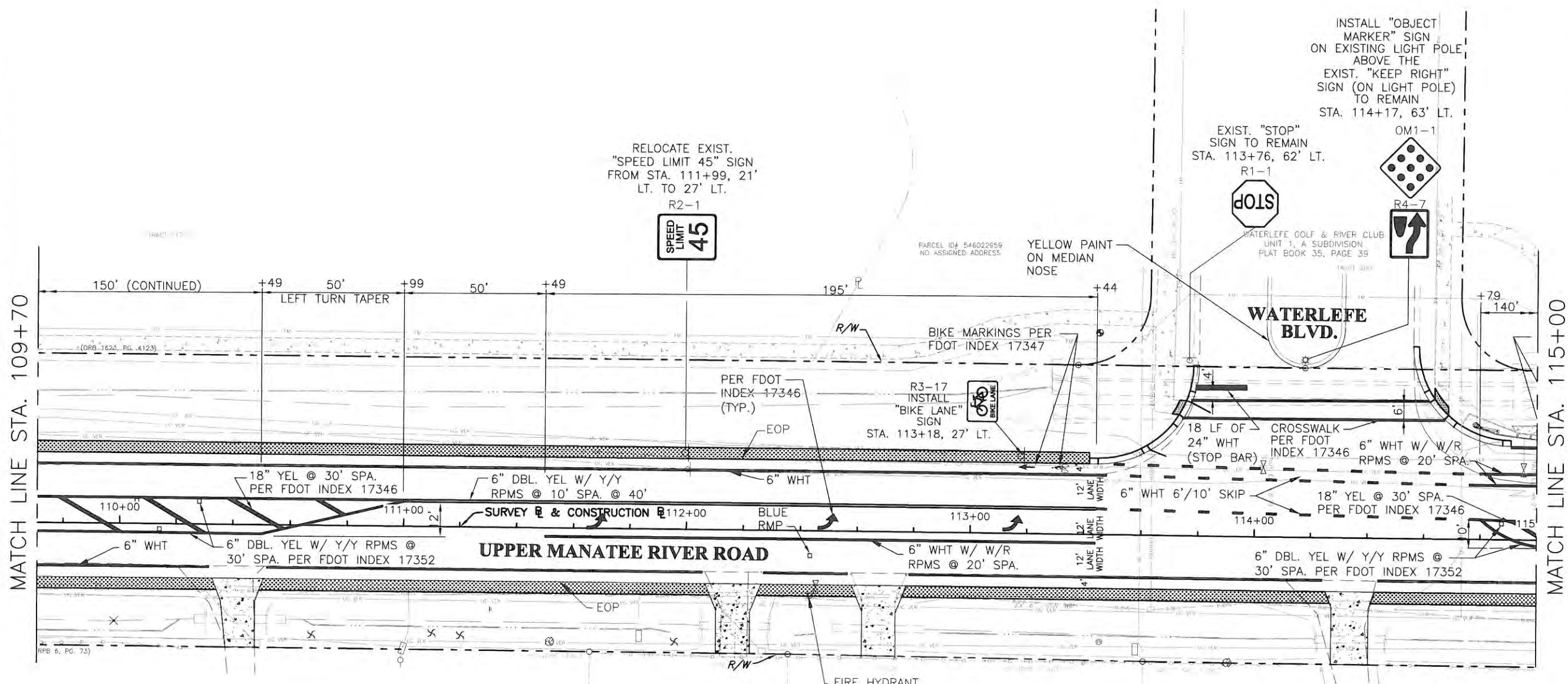
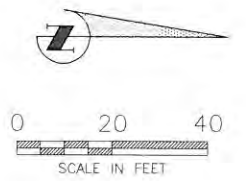

**UPPER MANATEE RIVER ROAD  
 ROADWAY FUNCTIONAL  
 IMPROVEMENTS  
 SIGNING AND PAVEMENT MARKING PLAN S  
 STA. 109+70 TO STA. 115+00**

MATCH LINE STA. 109+70

MATCH LINE STA. 115+00

NO.	REVISION DESCRIPTION	BY	DATE

PROJECT # 307-6082660  
 SURVEY # FILE 00-42783  
 SEC./TWN./RGE 29-30.34S/19E  
 SCALE 1"=40'

	BY	DATE
SURVEYED	ZNS	04/27/12
DESIGNED	PV/PBF	02/18/14
DRAWN	KR/CB	02/18/14
CHECKED	PV/PBF	02/18/14

CHRISTOPHER L. MOWBRAY, P.E.  
 FLORIDA P.E. # 46777

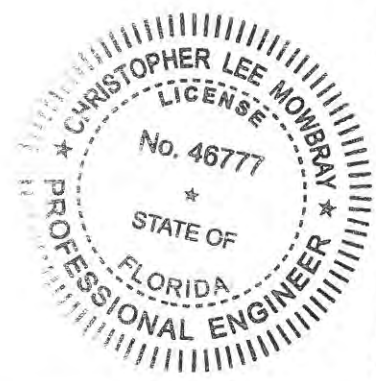

*Ch Lee Mowbray*  
 11/5/14  
 Signature & Date



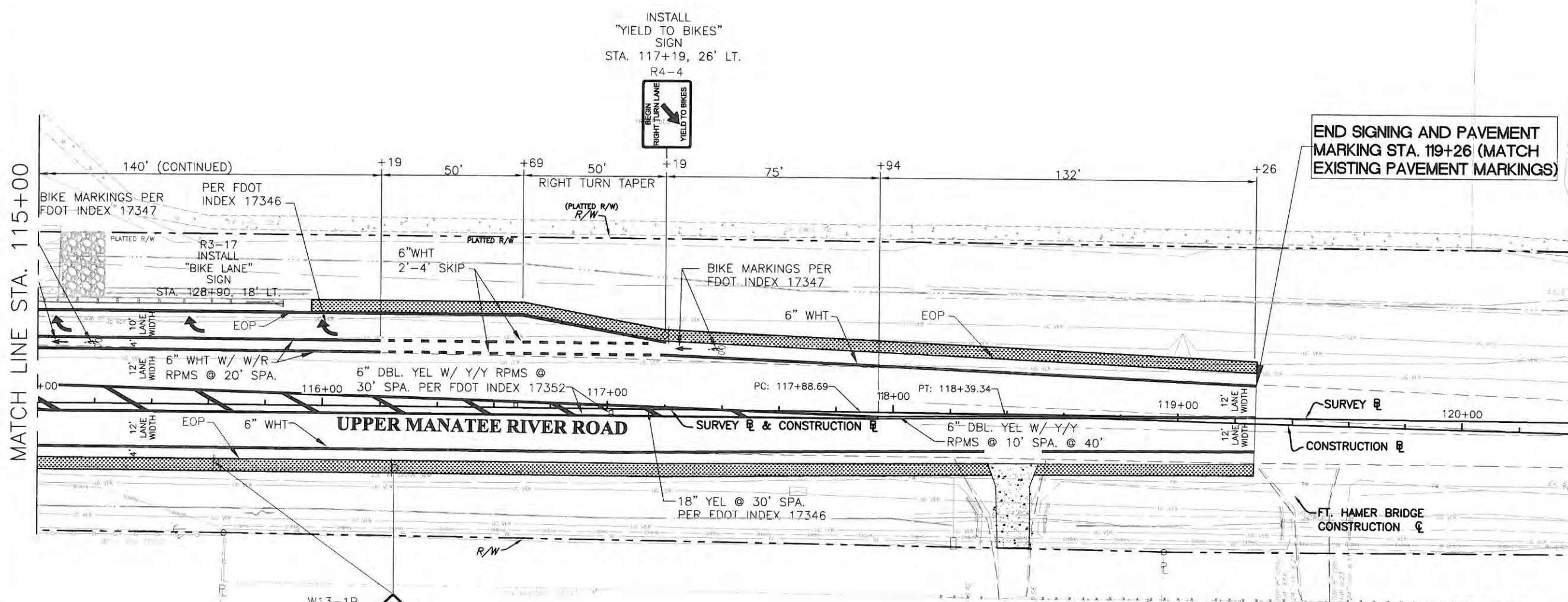
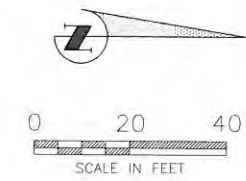

INSTALL  
"YIELD TO BIKES"  
SIGN  
STA. 117+19, 26' LT.  
R4-4



END SIGNING AND PAVEMENT  
MARKING STA. 119+26 (MATCH  
EXISTING PAVEMENT MARKINGS)

MATCH LINE STA. 115+00

W13-1P  
**40**  
MPH  
W1-2R  
RELOCATE  
"CURVE AHEAD" SIGN &  
"SPEED LIMIT 40" ADVISORY  
SPEED SIGN  
STA. 116+25, 22' RT.



**UPPER MANATEE RIVER ROAD  
ROADWAY FUNCTIONAL  
IMPROVEMENTS  
SIGNING AND PAVEMENT MARKING PLAN S  
STA. 109+70 TO STA. 115+00**

NO.	REVISION DESCRIPTION	BY	DATE

PROJECT #	307-6082660
SURVEY #	FILE 00-42783
SEC./TWN./RGE	19-20, 29-30,34S/19E
SCALE	1"=40'

	BY	DATE
SURVEYED	ZNS	04/27/12
DESIGNED	PV/PBF	02/18/14
DRAWN	KR/CB	02/18/14
CHECKED	PV/PBF	02/18/14

CHRISTOPHER L. MOWBRAY, P.E.  
FLORIDA P.E. # 46777

*Christopher Lee Mowbray*  
11/5/14  
Signature & Date

COPYRIGHT 2010 MANATEE COUNTY GOVERNMENT | S:\PWD\_Engineering\_Shera\Highway\_Engineering\ROADS\Upper Manatee Rr or Road\TRAFFIC PLANS\Pavement Marking and Signing Plans\Upper Manatee Sign and Pavement\07\Man. 11/13/2014 10:48 AM Keith Ripley, 12, 11x17