

# MANATEE COUNTY PUBLIC WORKS DEPARTMENT

MANATEE COUNTY PROJECT No: 6108260

75TH STREET WEST  
FROM 20TH AVENUE W. TO  
MANATEE AVENUE W. (SR 64)  
BRADENTON, FLORIDA

## LIGHTING PLANS

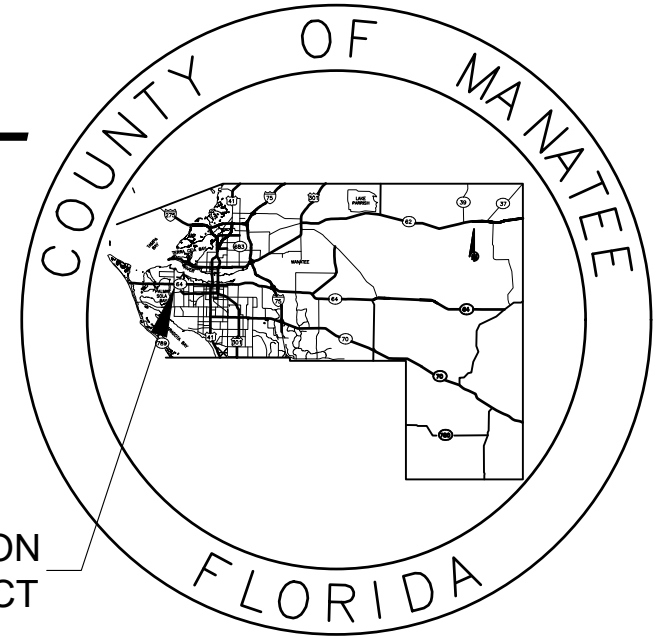

LOCATION  
OF PROJECT

### INDEX OF LIGHTING PLANS

SHEET NO.	SHEET DESCRIPTION
L-1	KEY SHEET
L-2	SIGNATURE SHEET
L-3	TABULATION OF QUANTITIES
L-4	GENERAL NOTES
L-5	FP&L LIGHT POLE DATA TABLE AND LEGEND
L-6 TO L-15	LIGHTING PLAN

**90% SUBMITTAL**  
**JULY 2023**  
(NOT FOR CONSTRUCTION)

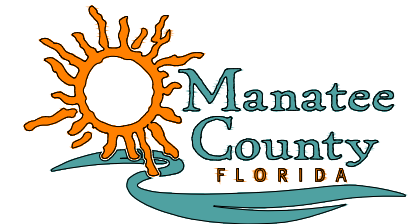

ATTENTION IS DIRECTED TO THE FACT THAT THESE PLANS MAY HAVE BEEN ENLARGED IN SIZE BY REPRODUCTION. THIS MUST BE CONSIDERED WHEN OBTAINING SCALED DATA.

**LIGHTING PLANS  
ENGINEER OF RECORD:**

DAVID J. ALLEN, P.E. NO. 58540  
STANTEC CONSULTANT SERVICES, INC.  
380 PARK PLACE BOULEVARD  
SUITE 300  
CLEARWATER, FLORIDA, 33759  
727-531-3505



Know what's below  
Call before you dig

COUNTY PROJECT MANAGER:  
ANTHONY RUSSO, P.E.

FISCAL YEAR	SHEET NO.
23	L-1

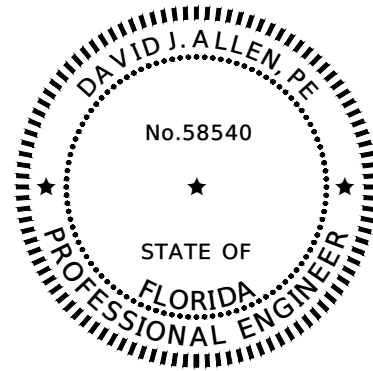

THIS ITEM HAS BEEN DIGITALLY  
SIGNED AND SEALED BY:

ON THE DATE ADJACENT TO THE SEAL



PRINTED COPIES OF THIS DOCUMENT ARE  
NOT CONSIDERED SIGNED AND SEALED AND  
THE SIGNATURE MUST BE VERIFIED ON ANY  
ELECTRONIC COPIES.

DAVID J. ALLEN, PE  
STANTEC CONSULTING SERVICES, INC.  
380 PARK PLACE BOULEVARD  
SUITE 300  
CLEARWATER, FLORIDA, 33759  
(727) 531-3505

THE ABOVE NAMED PROFESSIONAL ENGINEER SHALL BE RESPONSIBLE FOR THE FOLLOWING  
SHEETS IN ACCORDANCE WITH RULE 61G15-23.004, F.A.C.

**LIGHTING PLANS**

SHEET NO.	SHEET DESCRIPTION
L-1	KEY SHEET
L-2	SIGNATURE SHEET
L-3	TABULATION OF QUANTITIES
L-4	GENERAL NOTES AND LEGEND
L-5	FP&L LIGHT POLE DATA TABLE AND LEGEND
L-6 TO L-15	LIGHTING PLAN

REVISIONS				 STANTEC CONSULTING SERVICES, INC.	DAVID J. ALLEN, P.E. P.E. LICENSE NUMBER 58540 380 PARK PLACE BOULEVARD SUITE 300 CLEARWATER, FLORIDA, 33759 (727) 531-3505	 MANATEE COUNTY PUBLIC WORKS COUNTY PROJECT NO: 6108260	75TH STREET WEST FROM 20TH AVENUE W. TO MANATEE AVENUE W. (SR 64)	SHEET NO.
NO.	DESCRIPTION	DATE	BY				SIGNATURE SHEET	L-2
---	---							

TABULATION OF QUANTITIES

PAY ITEM NO.	DESCRIPTION	UNIT	SHEET NUMBERS														TOTAL THIS SHEET		GRAND TOTAL	
			L-6		L-7		L-8		L-9		L-10		L-11		L-12		PLAN	FINAL	PLAN	FINAL
			PLAN	FINAL	PLAN	FINAL	PLAN	FINAL	PLAN	FINAL	PLAN	FINAL	PLAN	FINAL	PLAN	FINAL				
630-2-91	CONDUIT, INSTALL, OPEN TRENCH	LF	10		170		20		20		20		30		25		295			
630-2-92	CONDUIT, INSTALL, DIRECTIONAL BORE	LF	130		530		565		560		555		640		700		3680			
635-2-30	PULL & SPLICE BOX, INSTALL	EA	2		6		4		4		4		7		6		33			

PAY ITEM NO.	DESCRIPTION	UNIT	SHEET NUMBERS														TOTAL THIS SHEET		GRAND TOTAL	
			L-13		L-14		L-15										PLAN	FINAL	PLAN	FINAL
			PLAN	FINAL	PLAN	FINAL	PLAN	FINAL	PLAN	FINAL	PLAN	FINAL	PLAN	FINAL	PLAN	FINAL				
630-2-91	CONDUIT, INSTALL, OPEN TRENCH	LF	20		15		15										50		345	
630-2-92	CONDUIT, INSTALL, DIRECTIONAL BORE	LF	555		535		210										1300		4980	
635-2-30	PULL & SPLICE BOX, INSTALL	EA	4		3		3										10		43	

THE OFFICIAL RECORD OF THIS SHEET IS THE ELECTRONIC FILE DIGITALLY SIGNED AND SEALED UNDER RULE 61G15-23.004, F.A.C.

REVISIONS			
NO.	DESCRIPTION	DATE	BY
---	---	---	---



DAVID J. ALLEN, P.E.  
P.E. LICENSE NUMBER 58540  
380 PARK PLACE BOULEVARD  
SUITE 300  
CLEARWATER, FLORIDA, 33759  
(727)531-3505



**MANATEE COUNTY**  
**PUBLIC WORKS**  
COUNTY PROJECT NO:  
6108260

75TH STREET WEST FROM  
20TH AVENUE W. TO MANATEE AVENUE W. (SR 64)

**TABULATION OF QUANTITIES**

SHEET NO.  
L-3

LIGHTING GENERAL NOTES

1. FLORIDA POWER & LIGHT (FP&L) WILL FURNISH ALL MATERIALS FOR THIS PROJECT. THE CONTRACTOR SHALL INSTALL ALL PULL BOXES, CONDUIT AND PULL WIRE AS FURNISHED BY FP&L. THE CONTRACTOR SHALL COORDINATE PICK UP OF THE MATERIALS WITH FP&L.
2. THE CONTRACTOR SHALL REQUEST ALL NECESSARY SPECIFICATIONS AND STANDARDS FROM ERIC CULLING (FP&L) FOR THE INSTALLATION OF THE LIGHTING CONDUIT AND PLACEMENT OF THE LIGHTING PULL BOXES PRIOR TO THE START OF INSTALLATION.  
  
ERIC CULLING  
PHONE: 239-410-4763  
EMAIL: ERIC.CULLING@FPL.COM.
3. ALL LUMINAIRES ON THE WEST SIDE OF 75TH STREET SHALL BE MOUNTED ON THE PROPOSED POWER POLES BY FP&L AND DO NOT REQUIRE PULL BOXES OR CONDUITS.
4. THE LOCATIONS OF EXISTING UTILITIES, AS SHOWN ON THESE PLANS, ARE APPROXIMATE AND BASED ON THE INFORMATION FURNISHED TO THE ENGINEER BY THE UTILITY OWNER(S) AND ARE SHOWN AS NOTICE TO THE CONTRACTOR THAT UNDERGROUND UTILITIES EXIST.
5. BEFORE EXCAVATING, IT IS REQUIRED THAT NOTICE BE GIVEN TO SUNSHINE STATE ONE CALL OF FLORIDA, INC. (SSOCOF) AT 1-800-432-4770 A MINIMUM OF TWO (2) FULL BUSINESS DAYS BEFORE WORK BEGINS. NOT ALL UTILITY COMPANIES ARE MEMBERS OF SSOCOF.
6. THE LOCATION OF THE CONDUITS ARE DIAGRAMMATIC ONLY AND MAY BE ADJUSTED WITHIN THE RIGHT-OF-WAY BY THE CONTRACTOR WITH APPROVAL FROM THE ENGINEER TO ACCOMMODATE LOCAL CONDITIONS AND EXISTING UTILITY LOCATIONS.
7. THE CONTRACTOR SHALL STAKE ALL POLE LOCATIONS TO ASSIST FP&L IN THE LIGHT POLE INSTALLATION LOCATIONS.
8. THE CONTRACTOR SHALL PLACE THE PULL BOX FOR EACH LIGHT POLE LOCATED ON THE EAST SIDE OF 75TH STREET PER FP&L STANDARDS AND SPECIFICATIONS. THE PULL BOX SHALL BE THREE FEET FROM THE STAKED PROPOSED LIGHT POLE ON THE SIDE DEPICTED IN THE PLANS. THE CONTRACTOR SHALL ALSO INSTALL CONDUIT TO CONNECT THE PULL BOX AND THE PROPOSED LIGHT POLE INSTALLED BY FPL.
9. DIRECTIONAL BORE OPERATIONS SHALL MEET THE REQUIREMENTS OF FDOT'S UTILITY ACCOMMODATION MANUAL (LATEST EDITION).
10. AT LOCATIONS WHERE UNDERGROUND UTILITIES ARE WITHIN TWO FEET OF THE CONDUIT RUN, THE CONTRACTOR SHALL HAND DIG THE FIRST FOUR (4) FEET FOR THE CONDUIT RUN.
11. THE CONTRACTOR SHALL BE AWARE THAT NO TEST BORINGS WERE MADE WHERE CONDUIT OR PULL BOXES ARE TO BE INSTALLED. THE CONTRACTOR SHALL BE RESPONSIBLE FOR EXAMINING THE JOB SITE CONDITIONS BEFORE SUBMITTING BID PROPOSALS.
12. ALL CONDUIT TRENCHES SHALL BE BACKFILLED COMPLETELY TO PROVIDE SAFE CROSSING BY THE END OF EACH WORKING DAY OR WHENEVER THE WORK ZONE BECOMES INACTIVE. THE CONTRACTOR SHALL NOT OPEN ANY AREA THAT CAN NOT BE BACKFILLED IN THE SAME WORK PERIOD.
13. MAINTAIN ACCESS TO ALL SIDE STREETS, PRIVATE AND COMMERCIAL DRIVEWAYS AT ALL TIMES DURING THE CONSTRUCTION OPERATION.
14. THE CONTRACTOR SHALL NOTIFY MANATEE COUNTY BEFORE ANY TRENCHING OR DIGGING AT SIGNALIZED INTERSECTIONS SO THAT ALL UNDERGROUND LOOP LEAD-INS AND ELECTRICAL CABLES CAN BE IDENTIFIED AND MARKED APPROPRIATELY.
15. THE LIGHTING SYSTEM WILL BE MAINTAINED BY FLORIDA POWER AND LIGHT UPON FINAL ACCEPTANCE.
16. WHEN CONSTRUCTION IS COMPLETE, A HARD COPY SET OF "AS-BUILT" PLANS IN ADDITION TO AN ELECTRONIC COPY (PDF) IS TO BE SUBMITTED TO:  
  
FLORIDA POWER AND LIGHT  
ATTN: ERIC CULLING  
SENIOR REPRESENTATIVE - LED LIGHTING SOLUTIONS  
EMAIL: ERIC.CULLING@FPL.COM
17. ALL EXISTING UTILITIES ARE TO REMAIN IN PLACE UNLESS OTHERWISE NOTED.
18. PULL BOXES SHALL NOT BE LOCATED IN DRAINAGE SWALES, DITCHES, WETLANDS, DRIVEWAYS, SURFACE WATER, PAVED SHOULDERS OR PEDESTRIAN RAMPS. THE CONTRACTOR SHALL COORDINATE WITH THE ENGINEER FOR AN APPROVED OFFSET ADJUSTMENT IF NECESSARY.

REVISIONS			
NO.	DESCRIPTION	DATE	BY
----	----		



DAVID J. ALLEN, P.E.  
P.E. LICENSE NUMBER 58540  
380 PARK PLACE BOULEVARD  
SUITE 300  
CLEARWATER, FLORIDA, 33759  
(727)531-3505



**MANATEE COUNTY  
PUBLIC WORKS**  
COUNTY PROJECT NO:  
6108260

75TH STREET WEST FROM  
20TH AVENUE W. TO MANATEE AVENUE W. (SR 64)

**GENERAL NOTES**

SHEET  
NO.

L-4



FP&L LIGHT POLE DATA TABLE

MANATEE COUNTY  
CONVENTIONAL ROADWAY  
LIGHTING DESIGN CRITERIA

FDOT INTERSECTION  
LIGHTING DESIGN CRITERIA







AVERAGE INITIAL INTENSITY 1.0 FOOT CANDLE  
UNIFORMITY RATIO AVG./MIN. 4:1 OR LESS  
MAX./MIN. 10:1 OR LESS  
VEILING LUMINANCE RATIO 0.4:1 OR LESS  
WIND SPEED 140 MPH

AVERAGE HORIZONTAL INTENSITY 1.5 FOOT CANDLES  
(1.0 FOOT CANDLE MINIMUM)  
UNIFORMITY RATIO AVG./MIN. 4:1 OR LESS  
MAX./MIN. 10:1 OR LESS  
AVERAGE VERTICAL INTENSITY 1.5 FOOT CANDLES  
(1.2 FOOT CANDLES MINIMUM)  
WIND SPEED 140 MPH

LEGEND

SYMBOLS

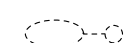
DESCRIPTION

-  FPL TO FURNISH AND INSTALL A FP&L TYPE 7 LIGHT POLE WITH 30-FOOT LUMINAIRE MOUNTING HEIGHT AND 12-FOOT BRACKET ARM WITH A 42 INCH RISE. THE LUMINAIRE FOR EACH POLE IS SPECIFIED ON THE PLAN SHEETS.
-  FPL TO FURNISH AND INSTALL A LUMINAIRE AND A 12-FOOT BRACKET ARM WITH A 42 INCH RISE ON THE EXISTING POWER POLE. THE LUMINAIRE IS SPECIFIED ON THE PLAN SHEETS. THE MOUNTING HEIGHT IS 30 FEET.
-  FPL TO REPLACE THE LUMINAIRE ON THE EXISTING POWER POLE WITH A LUMINAIRE THAT IS SPECIFIED ON THE PLAN SHEETS.
-  FPL TO FURNISH AND INSTALL A LUMINAIRE ON A 12-BRACKET ARM ON THE PROPOSED POWER POLE ON THE WEST SIDE OF 75TH STREET. THE PROPOSED POLES ARE LOCATED WEST OF THE POWER POLES BEING REMOVED DUE TO THE ROADWAY WIDENING. THE LUMINAIRE IS SPECIFIED ON THE PLAN SHEETS AND THE BRACKET ARM IS 13-FOOT LONG WITH A RISE OF 42 INCHES. THE MOUNTING HEIGHT IS 30 FEET.
-  EXISTING LIGHT POLE TO REMAIN.
-  PROPOSED POWER POLE, NO LUMINAIRE IS NEEDED.
-  PROPOSED PULL BOX. FURNISHED BY FP&L AND INSTALLED BY THE CONTRACTOR.

LUMINAIRE PLAN SHEET LEGEND

- (A) FPL ROADWAY 7,500L - 60 WATT ARCHEON LED LUMINAIRE WITH DISTRIBUTION TYPE III AND 3000K COLOR TEMPERATURE. HOUSE SIDE SHIELDS AND ADJUSTABLE DIMMING MODULES OPTIONS/ACCESSORIES SHALL BE INCLUDED DUE TO THE PROXIMITY OF RESIDENTIAL UNITS. PHOTOMETRICS FILE USED FOR ANALYSIS IS ARCH-S-PA1-60-730-U-T3-HSS-59W.IES.
- (B) FPL ROADWAY 12,000L - 90 WATT ARCHEON LED LUMINAIRE WITH DISTRIBUTION TYPE III AND 3000K COLOR TEMPERATURE. HOUSE SIDE SHIELDS AND ADJUSTABLE DIMMING MODULES OPTIONS/ACCESSORIES SHALL BE INCLUDED DUE TO THE PROXIMITY OF RESIDENTIAL UNITS. PHOTOMETRICS FILE USED FOR ANALYSIS IS ARCH-M-PA2-90-730-U-T3-HSS-93W.

POLE NO.	STATION & OFFSET	ARM LENGTH	ARM RISE	FP&L POLE TYPE	LUMINAIRE WATTAGE	BRACKET ANGLE *	MOUNTING HEIGHT
1	102+66, 48.8' RT	12'	42"	7	60	0	30'
2	103+96, 44.7' RT	12'	42"	7	60	0	30'
3	105+61, 49.3' RT	12'	42"	7	90	0	30'
4	106+26, 63.0' RT	12'	42"	7	60	0	30'
5	107+23, 59.6' RT	12'	42"	7	90	0	22.5'
6	107+75, 44.3' RT	12'	42"	7	60	0	30'
7	107+69, 49.3' LT	12'	42"	7	60	0	30'
8	109+19, 44.4' RT	12'	42"	7	60	0	30'
9	110+63, 43.9' RT	12'	42"	7	60	0	30'
10	112+03, 44.1' RT	12'	42"	7	60	0	30'
11	113+36, 44.2' RT	12'	42"	7	60	0	30'
12	114+53, 44.4' RT	12'	42"	7	60	0	30'
13	115+88, 44.4' RT	12'	42"	7	60	0	30'
14	117+29, 44.4' RT	12'	42"	7	60	0	30'
15	118+57, 44.3' RT	12'	42"	7	60	0	30'
16	120+04, 44.3' RT	12'	42"	7	60	0	30'
17	121+42, 44.6' RT	12'	42"	7	60	0	30'
18	122+71, 44.3' RT	12'	42"	7	60	0	30'
19	124+10, 44.4' RT	12'	42"	7	60	0	30'
20	125+54, 44.2' RT	12'	42"	7	60	0	30'
21	126+86, 44.5' RT	12'	42"	7	60	0	30'
22	128+01, 44.3' RT	12'	42"	7	60	0	30'
23	129+30, 44.5' RT	12'	42"	7	60	0	30'
24	130+04, 48.7' LT	12'	42"	7	60	0	30'
25	130+60, 44.0' RT	12'	42"	7	60	0	30'
26	131+80, 39.3' RT	12'	42"	7	60	0	30'
27	132+99, 39.5' RT	12'	42"	7	60	0	30'
28	134+21, 39.4' RT	12'	42"	7	60	0	30'
29	134+93, 48.9' LT	12'	42"	7	60	0	30'
30	135+65, 39.4' RT	12'	42"	7	60	0	30'
31	137+06, 39.5' RT	12'	42"	7	60	0	30'
32	138+91, 43.0' RT	12'	42"	7	60	0	30'
33	140+61, 43.8' RT	12'	42"	7	60	0	30'
34	141+84, 43.1' RT	12'	42"	7	60	0	30'
35	143+03, 43.2' RT	12'	42"	7	60	0	30'
36	144+48, 43.0' RT	12'	42"	7	60	0	30'
37	146+37, 42.2' RT	12'	42"	7	60	0	30'
38	147+68, 42.2' RT	12'	42"	7	60	0	30'
39	148+96, 42.3' RT	12'	42"	7	60	0	30'
40	150+33, 42.2' RT	12'	42"	7	60	0	30'
41	151+13, 42.8' RT	12'	42"	7	90	20	30'

\* BRACKET ARM ORIENTATION BASED ON THE ROTATION IN DEGREES FROM PERPENDICULAR TO THE ROAD. FP&L TO INSTALL THE POLE TO ACCOMMODATE THE ORIENTATION WHERE NECESSARY.

\*\* THIS TABLE DOES NOT INCLUDE THE PROPOSED LUMINAIRE AND BRACKET ARMS TO BE INSTALLED ON THE POWER POLES AS SHOWN IN THE PLANS. THE LABELS PROVIDE THE NECESSARY INFORMATION.

REVISIONS			
NO.	DESCRIPTION	DATE	BY
---	---	---	---



DAVID J. ALLEN, P.E.  
P.E. LICENSE NUMBER 58540  
380 PARK PLACE BOULEVARD  
SUITE 300  
CLEARWATER, FLORIDA, 33759  
(727)531-3505



MANATEE COUNTY  
PUBLIC WORKS  
COUNTY PROJECT NO:  
6108260

75TH STREET WEST FROM  
20TH AVENUE W. TO MANATEE AVENUE W. (SR 64)  
FP&L LIGHT POLE DATA TABLE  
AND LEGEND

SHEET NO.  
L-5

THE OFFICIAL RECORD OF THIS SHEET IS THE ELECTRONIC FILE DIGITALLY SIGNED AND SEALED UNDER RULE 61G15-23.004, F.A.C.

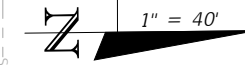

FP&L TO INSTALL A 12-FOOT LONG/3.5-FOOT RISE BRACKET ARM WITH LUMINAIRE (A) ON THE PROPOSED POWER POLE THAT IS REPLACING THE CONFLICTING POWER POLE TO BE REMOVED. THE MOUNTING HEIGHT IS 30 FEET.

FP&L TO INSTALL A 12-FOOT LONG/3.5-FOOT RISE BRACKET ARM WITH LUMINAIRE (A) ON THE PROPOSED POWER POLE THAT IS REPLACING THE CONFLICTING POWER POLE TO BE REMOVED. THE MOUNTING HEIGHT IS 30 FEET.

FP&L TO INSTALL A 12-FOOT LONG/3.5-FOOT RISE BRACKET ARM WITH LUMINAIRE (A) ON THE EXISTING CONCRETE POWER POLE TO REMAIN. MOUNTING HEIGHT IS 30 FEET.

5' SIDEWALK

EXIST. R/W

19TH AVE. W

100

101

102

103

104

5 LF (17" X 30") 1 EA 630-2-91 635-2-30

75TH STREET W

5 LF (17" X 30") 1 EA 630-2-91 635-2-30

EXISTING LIGHT POLE TO REMAIN

EXIST. R/W

11' TRAIL

130 LF 630-2-92

FP&L TO INSTALL LIGHT POLE #1 AT STA. 102+66, 48.8' RT WITH LUMINAIRE (A)

FP&L TO INSTALL LIGHT POLE #2 AT STA. 103+96, 44.7' RT WITH LUMINAIRE (A)

MATCHLINE STA. - 104+00.00

REVISIONS			
NO.	DESCRIPTION	DATE	BY



DAVID J. ALLEN, P.E.  
P.E. LICENSE NUMBER 58540  
380 PARK PLACE BOULEVARD  
SUITE 300  
CLEARWATER, FLORIDA, 33759  
(727) 531-3505



MANATEE COUNTY  
PUBLIC WORKS  
COUNTY PROJECT NO:  
6108260

75TH STREET WEST FROM  
20TH AVENUE W. TO MANATEE AVENUE W. (SR 64)

LIGHTING PLAN (1)

SHEET NO.

L-6

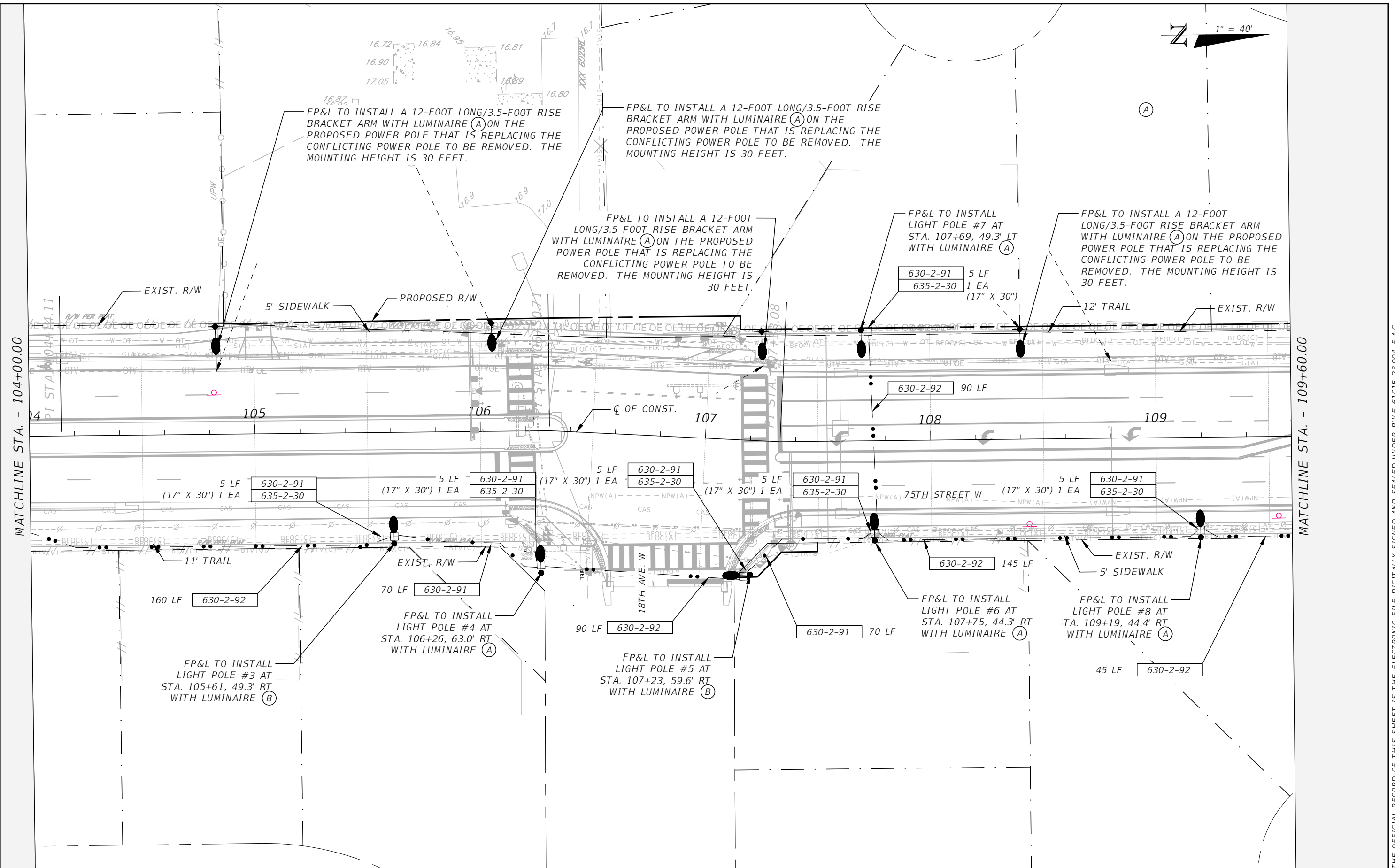
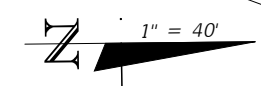

REVISIONS			
NO.	DESCRIPTION	DATE	BY



DAVID J. ALLEN, P.E.  
 P.E. LICENSE NUMBER 58540  
 380 PARK PLACE BOULEVARD  
 SUITE 300  
 CLEARWATER, FLORIDA, 33759  
 (727)531-3505



75TH STREET WEST FROM  
 20TH AVENUE W. TO MANATEE AVENUE W. (SR 64)  
**LIGHTING PLAN (2)**

SHEET NO.  
 L-7

THE OFFICIAL RECORD OF THIS SHEET IS THE ELECTRONIC FILE DIGITALLY SIGNED AND SEALED UNDER RULE 61G15-23.004, F.A.C.

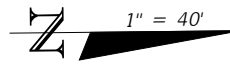

FP&L TO INSTALL A 12-FOOT LONG/3.5-FOOT RISE BRACKET ARM WITH LUMINAIRE (A) ON THE PROPOSED POWER POLE THAT IS REPLACING THE CONFLICTING POWER POLE TO BE REMOVED. THE MOUNTING HEIGHT IS 30 FEET.

FP&L TO INSTALL A 12-FOOT LONG/3.5-FOOT RISE BRACKET ARM WITH LUMINAIRE (A) ON THE PROPOSED POWER POLE THAT IS REPLACING THE CONFLICTING POWER POLE TO BE REMOVED. THE MOUNTING HEIGHT IS 30 FEET.

FP&L TO INSTALL A 12-FOOT LONG/3.5-FOOT RISE BRACKET ARM WITH LUMINAIRE (A) ON THE PROPOSED POWER POLE THAT IS REPLACING THE CONFLICTING POWER POLE TO BE REMOVED. THE MOUNTING HEIGHT IS 30 FEET.

FP&L TO INSTALL A 12-FOOT LONG/3.5-FOOT RISE BRACKET ARM WITH LUMINAIRE (A) ON THE PROPOSED POWER POLE THAT IS REPLACING THE CONFLICTING POWER POLE TO BE REMOVED. THE MOUNTING HEIGHT IS 30 FEET.

FP&L TO INSTALL A 12-FOOT LONG/3.5-FOOT RISE BRACKET ARM WITH LUMINAIRE (A) ON THE PROPOSED POWER POLE THAT IS REPLACING THE CONFLICTING POWER POLE TO BE REMOVED. THE MOUNTING HEIGHT IS 30 FEET.

MATCHLINE STA. - 109+60.00

MATCHLINE STA. - 115+20.00

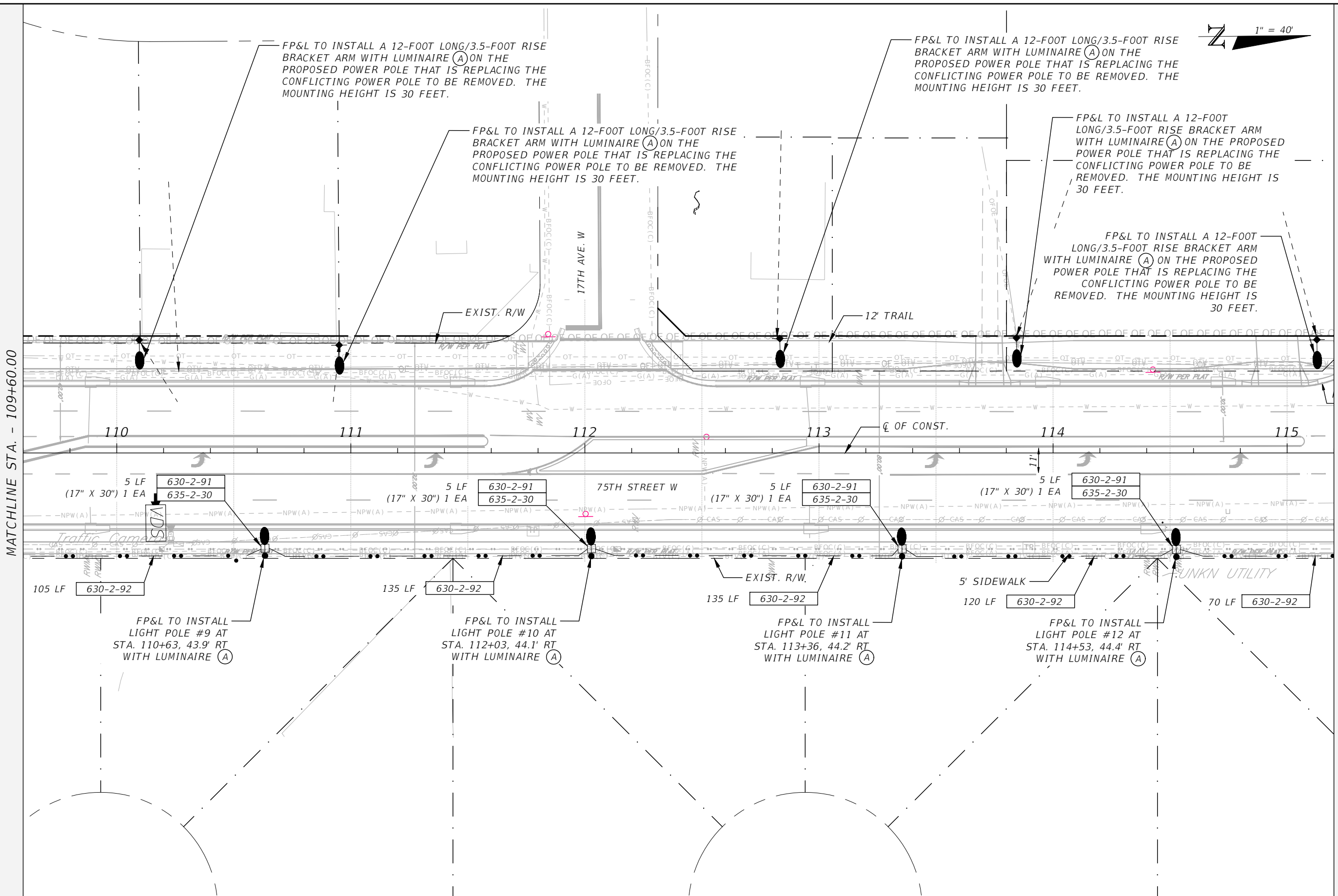

FP&L TO INSTALL LIGHT POLE #9 AT STA. 110+63, 43.9' RT WITH LUMINAIRE (A)

FP&L TO INSTALL LIGHT POLE #10 AT STA. 112+03, 44.1' RT WITH LUMINAIRE (A)

FP&L TO INSTALL LIGHT POLE #11 AT STA. 113+36, 44.2' RT WITH LUMINAIRE (A)

FP&L TO INSTALL LIGHT POLE #12 AT STA. 114+53, 44.4' RT WITH LUMINAIRE (A)

REVISIONS			
NO.	DESCRIPTION	DATE	BY



DAVID J. ALLEN, P.E.  
P.E. LICENSE NUMBER 58540  
380 PARK PLACE BOULEVARD  
SUITE 300  
CLEARWATER, FLORIDA, 33759  
(727)531-3505



75TH STREET WEST FROM  
20TH AVENUE W. TO MANATEE AVENUE W. (SR 64)  
**LIGHTING PLAN (3)**

SHEET NO.  
L-8

THE OFFICIAL RECORD OF THIS SHEET IS THE ELECTRONIC FILE DIGITALLY SIGNED AND SEALED UNDER RULE 61G15-23.004, F.A.C.



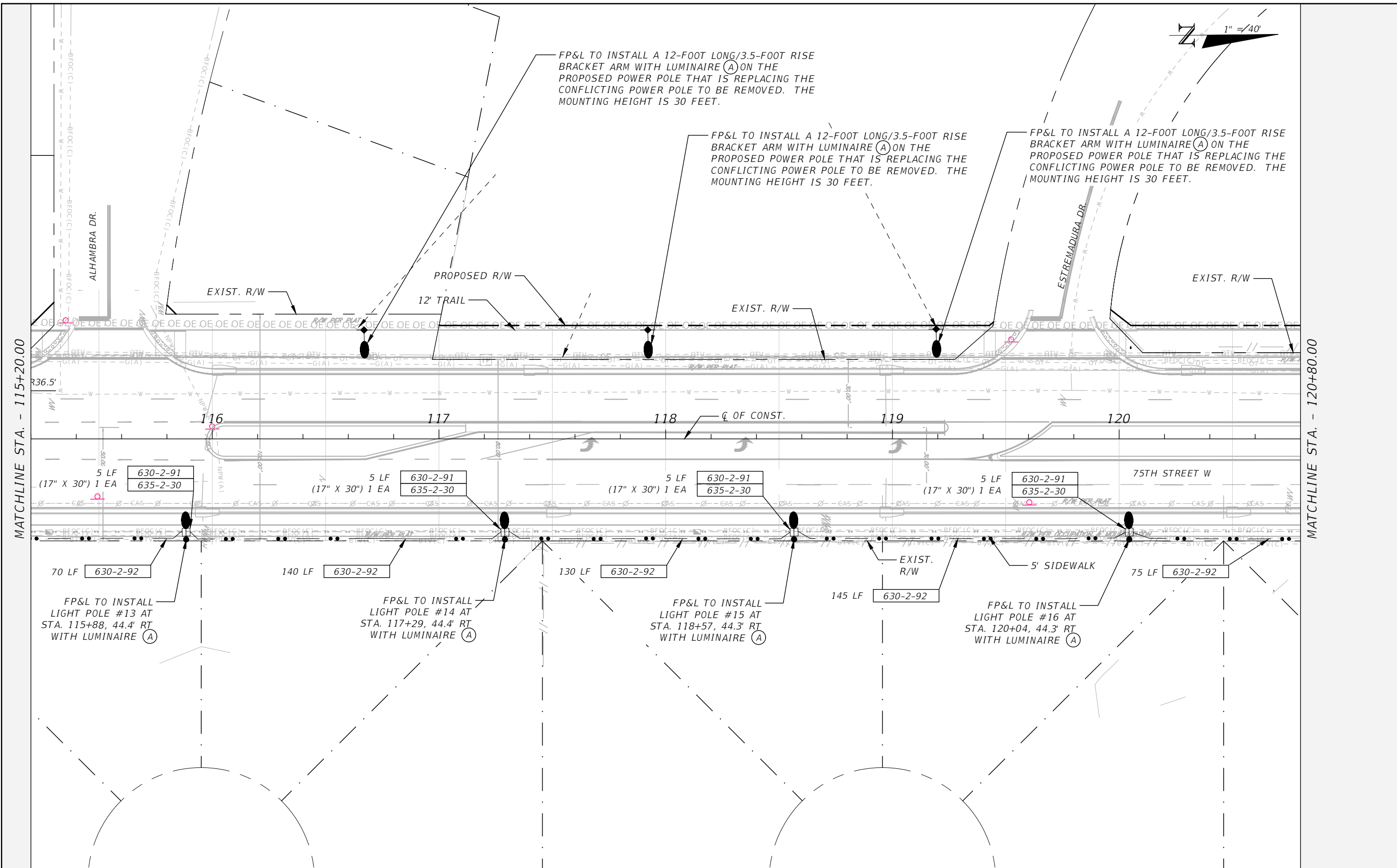

REVISIONS			
NO.	DESCRIPTION	DATE	BY



DAVID J. ALLEN, P.E.  
 P.E. LICENSE NUMBER 58540  
 380 PARK PLACE BOULEVARD  
 SUITE 300  
 CLEARWATER, FLORIDA, 33759  
 (727) 531-3505



75TH STREET WEST FROM  
 20TH AVENUE W. TO MANATEE AVENUE W. (SR 64)  
**LIGHTING PLAN (4)**

SHEET NO.  
 L-9

THE OFFICIAL RECORD OF THIS SHEET IS THE ELECTRONIC FILE DIGITALLY SIGNED AND SEALED UNDER RULE 61G15-23.004, F.A.C.

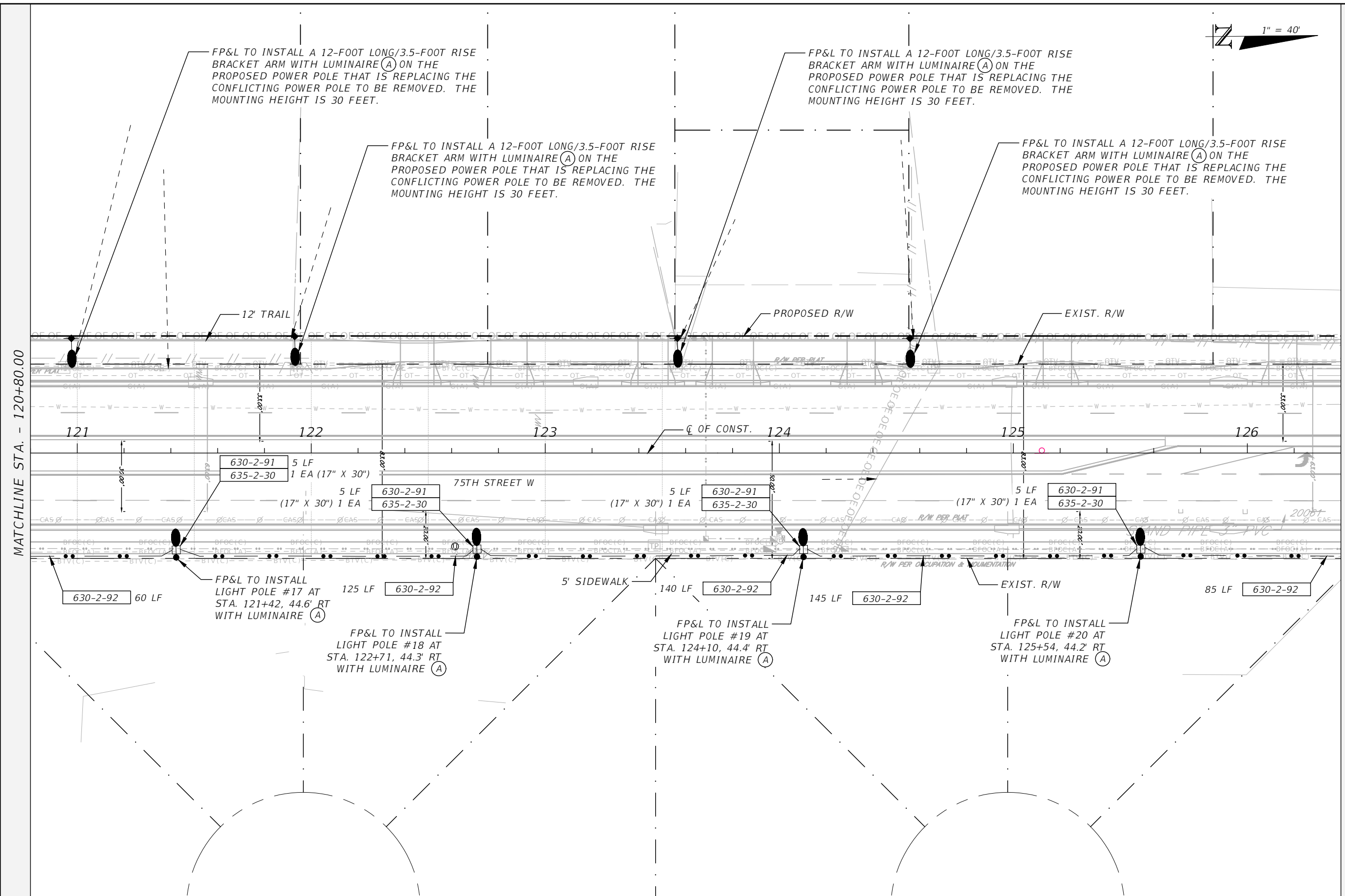
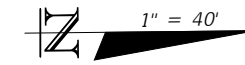

THE OFFICIAL RECORD OF THIS SHEET IS THE ELECTRONIC FILE DIGITALLY SIGNED AND SEALED UNDER RULE 61G15-23.004, F.A.C.

REVISIONS			
NO.	DESCRIPTION	DATE	BY



DAVID J. ALLEN, P.E.  
 P.E. LICENSE NUMBER 58540  
 380 PARK PLACE BOULEVARD  
 SUITE 300  
 CLEARWATER, FLORIDA, 33759  
 (727) 531-3505



75TH STREET WEST FROM  
 20TH AVENUE W. TO MANATEE AVENUE W. (SR 64)  
**LIGHTING PLAN (5)**

SHEET NO.  
 L-10

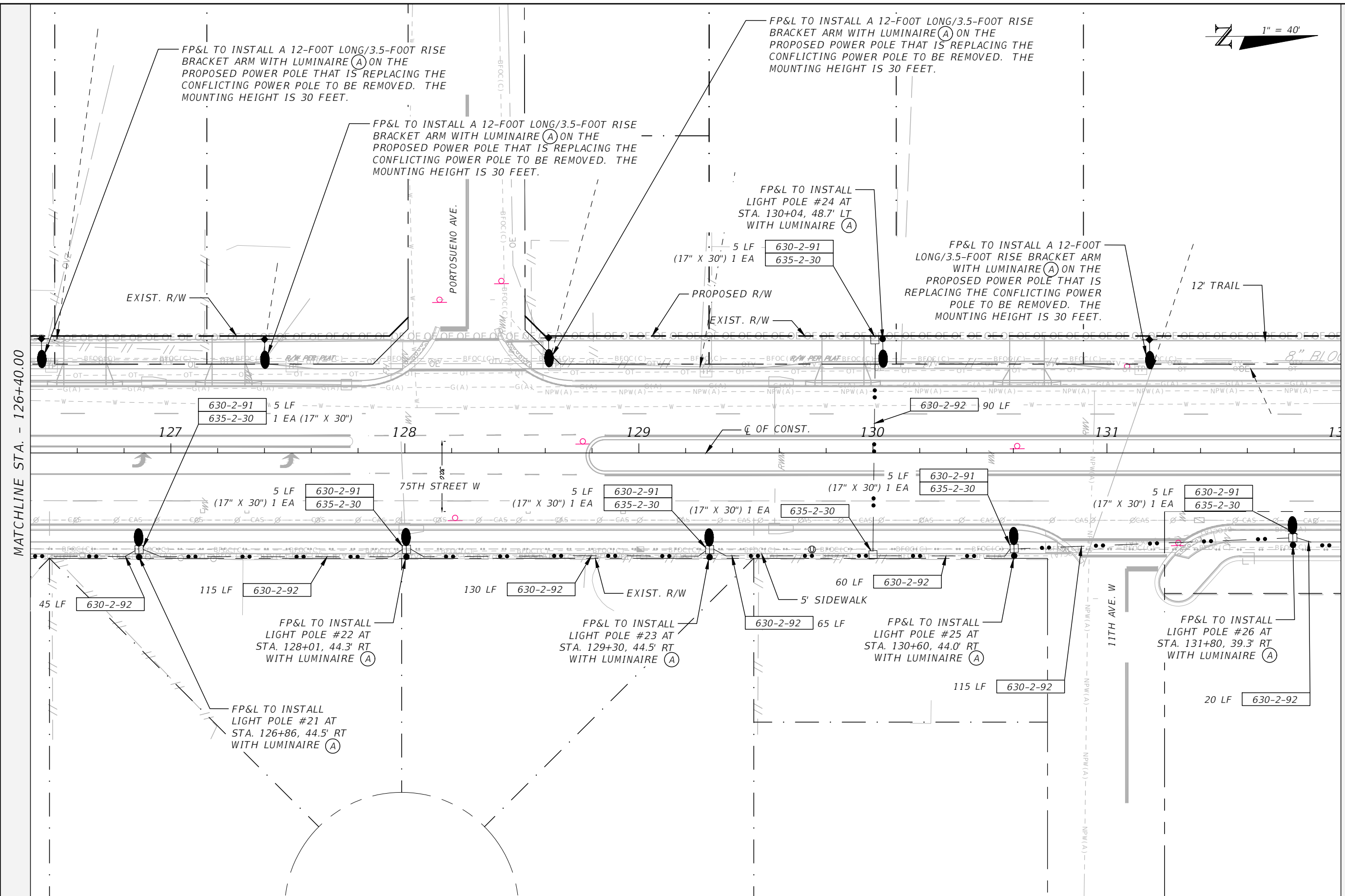
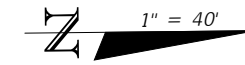

REVISIONS			
NO.	DESCRIPTION	DATE	BY



DAVID J. ALLEN, P.E.  
 P.E. LICENSE NUMBER 58540  
 380 PARK PLACE BOULEVARD  
 SUITE 300  
 CLEARWATER, FLORIDA, 33759  
 (727) 531-3505



75TH STREET WEST FROM  
 20TH AVENUE W. TO MANATEE AVENUE W. (SR 64)  
**LIGHTING PLAN (6)**

SHEET NO.  
 L-11

THE OFFICIAL RECORD OF THIS SHEET IS THE ELECTRONIC FILE DIGITALLY SIGNED AND SEALED UNDER RULE 61G15-23.004, F.A.C.

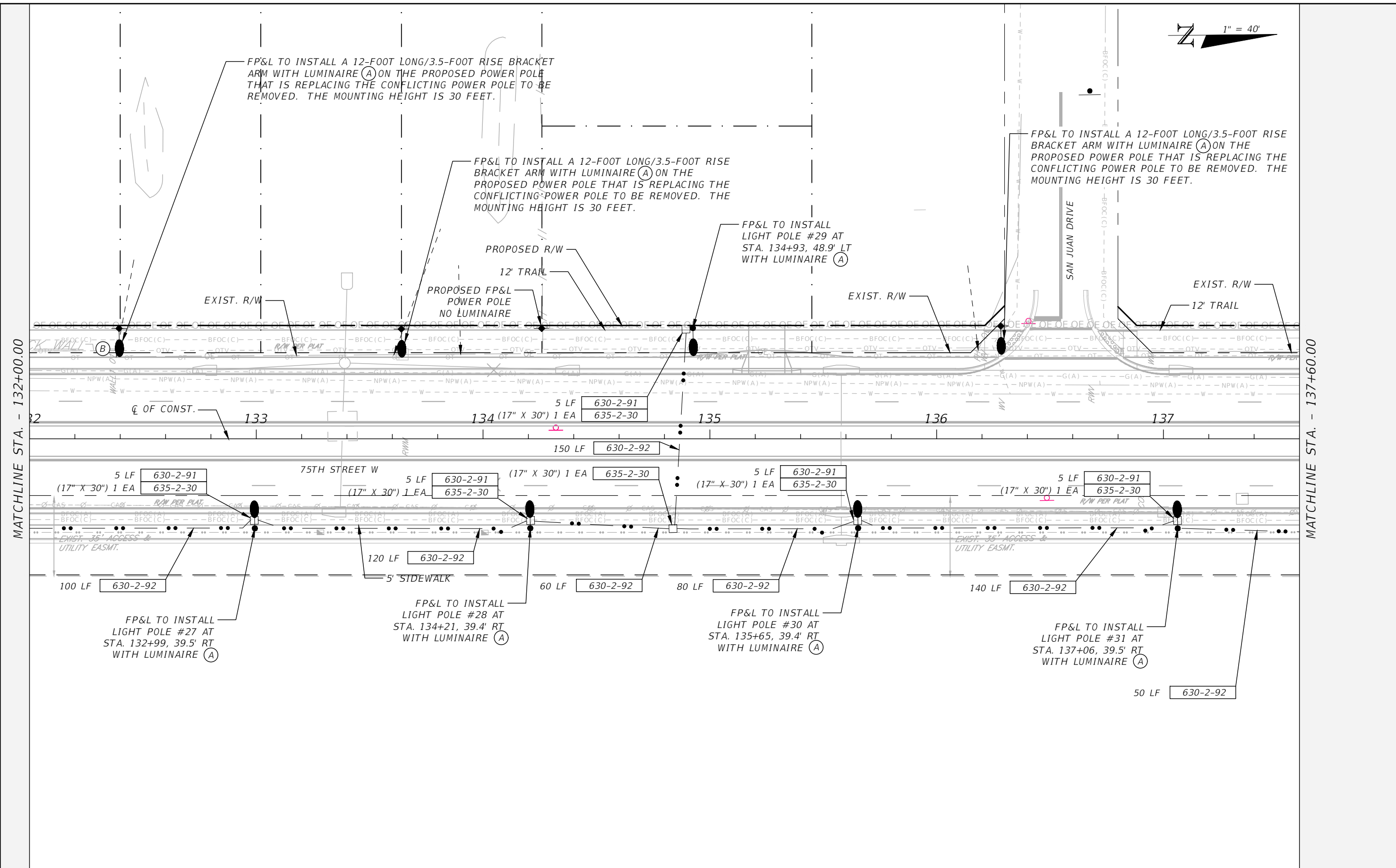
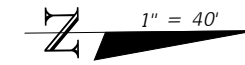

MATCHLINE STA. - 132+00.00

MATCHLINE STA. - 137+60.00

REVISIONS			
NO.	DESCRIPTION	DATE	BY



DAVID J. ALLEN, P.E.  
 P.E. LICENSE NUMBER 58540  
 380 PARK PLACE BOULEVARD  
 SUITE 300  
 CLEARWATER, FLORIDA, 33759  
 (727) 531-3505



75TH STREET WEST FROM  
 20TH AVENUE W. TO MANATEE AVENUE W. (SR 64)  
**LIGHTING PLAN (7)**

SHEET NO.  
 L-12

THE OFFICIAL RECORD OF THIS SHEET IS THE ELECTRONIC FILE DIGITALLY SIGNED AND SEALED UNDER RULE 61G15-23.004, F.A.C.



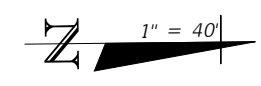

FP&L TO INSTALL A 12-FOOT LONG/3.5-FOOT RISE BRACKET ARM WITH LUMINAIRE (A) ON THE PROPOSED POWER POLE THAT IS REPLACING THE CONFLICTING POWER POLE TO BE REMOVED. THE MOUNTING HEIGHT IS 30 FEET.

FP&L TO INSTALL A 12-FOOT LONG/3.5-FOOT RISE BRACKET ARM WITH LUMINAIRE (A) ON THE PROPOSED POWER POLE THAT IS REPLACING THE CONFLICTING POWER POLE TO BE REMOVED. THE MOUNTING HEIGHT IS 30 FEET.

FP&L TO INSTALL A 12-FOOT LONG/3.5-FOOT RISE BRACKET ARM WITH LUMINAIRE (A) ON THE PROPOSED POWER POLE THAT IS REPLACING THE CONFLICTING POWER POLE TO BE REMOVED. THE MOUNTING HEIGHT IS 30 FEET.

FP&L TO INSTALL A 12-FOOT LONG/3.5-FOOT RISE BRACKET ARM WITH LUMINAIRE (A) ON THE PROPOSED POWER POLE THAT IS REPLACING THE CONFLICTING POWER POLE TO BE REMOVED. THE MOUNTING HEIGHT IS 30 FEET.

MATCHLINE STA. - 137+60.00

MATCHLINE STA. - 143+20.00

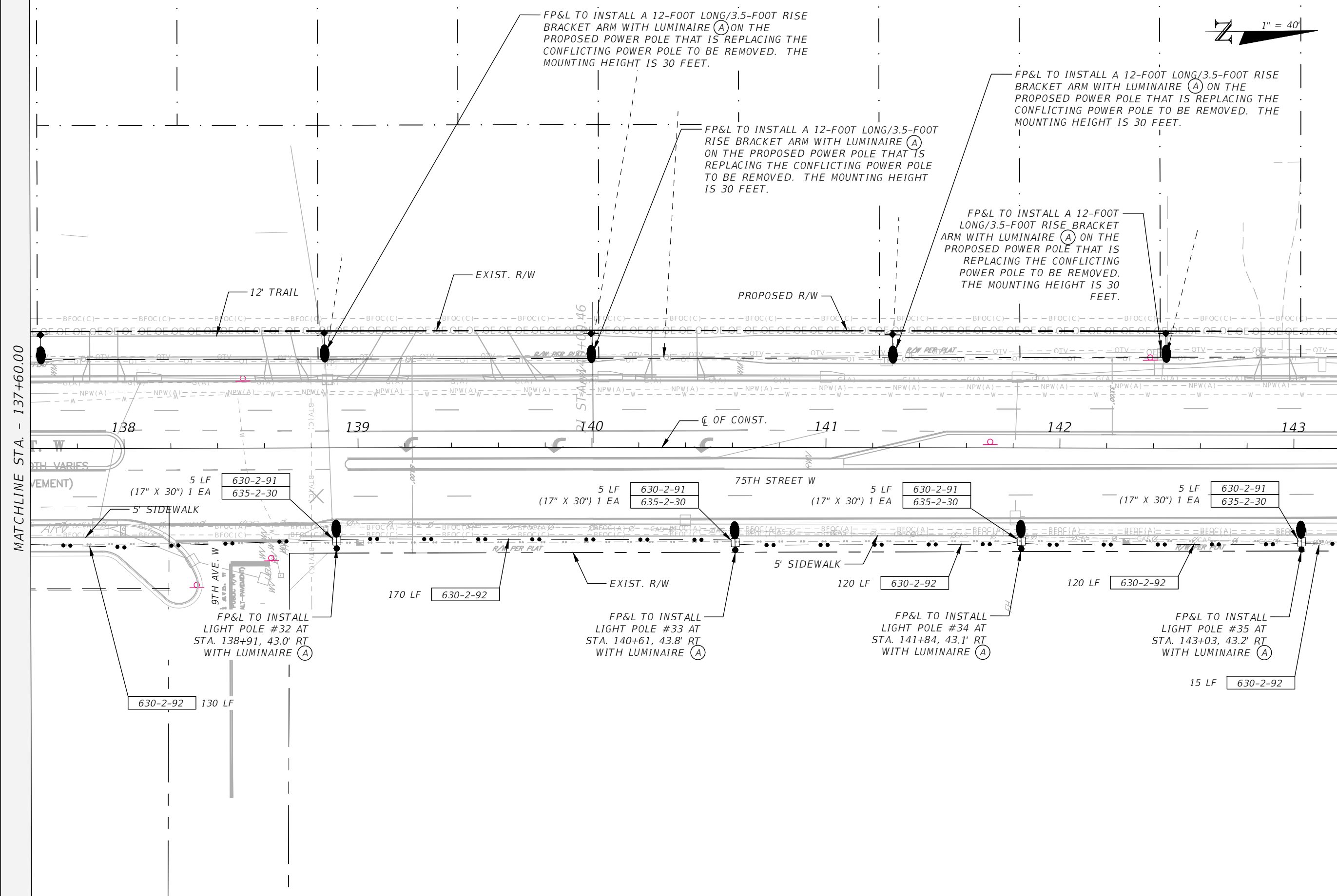

REVISIONS			
NO.	DESCRIPTION	DATE	BY



DAVID J. ALLEN, P.E.  
 P.E. LICENSE NUMBER 58540  
 380 PARK PLACE BOULEVARD  
 SUITE 300  
 CLEARWATER, FLORIDA, 33759  
 (727) 531-3505



75TH STREET WEST FROM  
 20TH AVENUE W. TO MANATEE AVENUE W. (SR 64)  
**LIGHTING PLAN (8)**

SHEET NO.  
 L-13

THE OFFICIAL RECORD OF THIS SHEET IS THE ELECTRONIC FILE DIGITALLY SIGNED AND SEALED UNDER RULE 61G15-23.004, F.A.C.

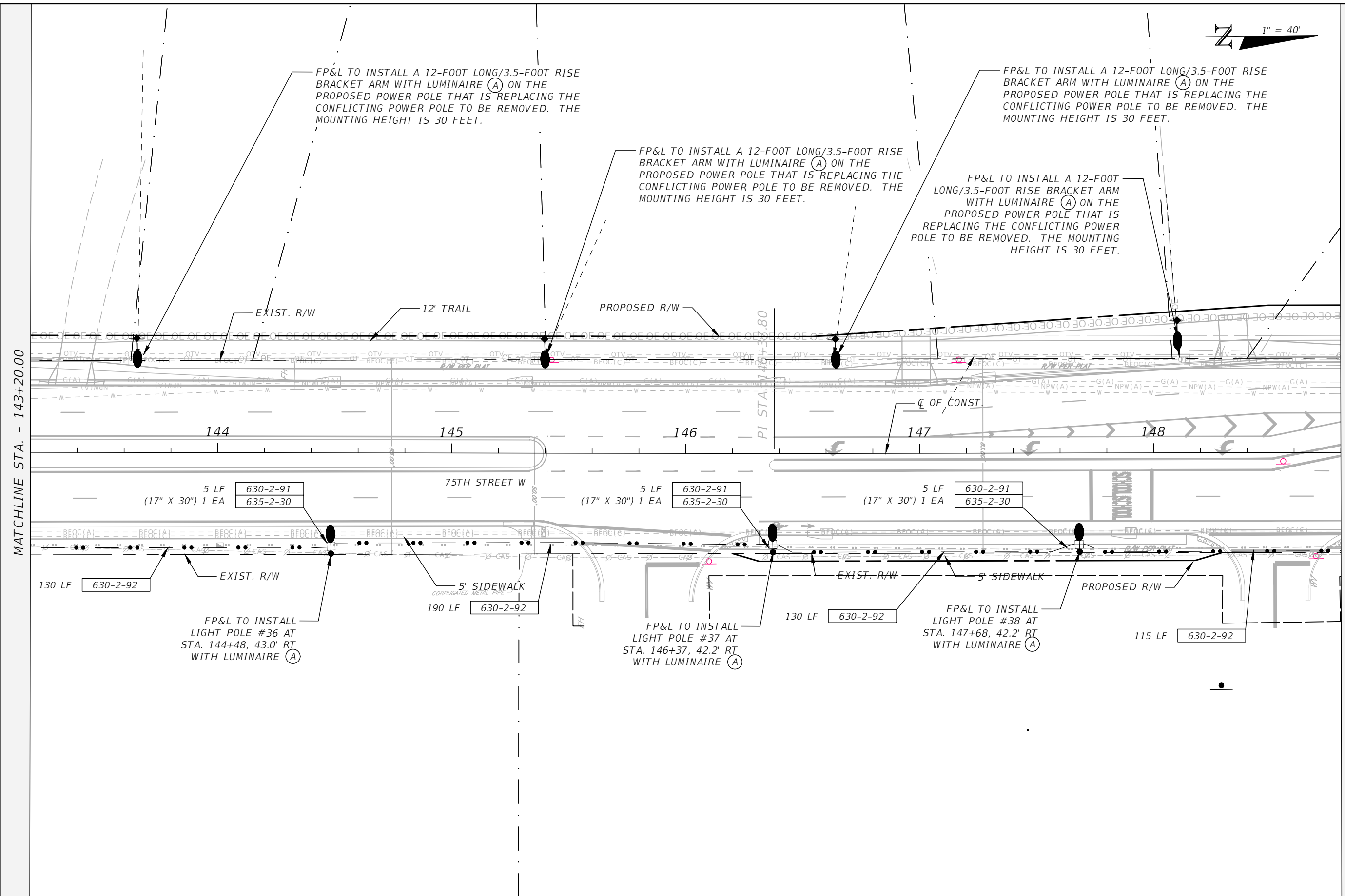
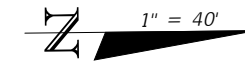

REVISIONS			
NO.	DESCRIPTION	DATE	BY



DAVID J. ALLEN, P.E.  
 P.E. LICENSE NUMBER 58540  
 380 PARK PLACE BOULEVARD  
 SUITE 300  
 CLEARWATER, FLORIDA, 33759  
 (727) 531-3505



75TH STREET WEST FROM  
 20TH AVENUE W. TO MANATEE AVENUE W. (SR 64)  
**LIGHTING PLAN (9)**

SHEET NO.  
 L-14

THE OFFICIAL RECORD OF THIS SHEET IS THE ELECTRONIC FILE DIGITALLY SIGNED AND SEALED UNDER RULE 61G15-23.004, F.A.C.

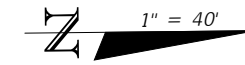

FP&L TO INSTALL A 12-FOOT LONG/3.5-FOOT RISE BRACKET ARM WITH LUMINAIRE (A) ON THE PROPOSED POWER POLE THAT IS REPLACING THE CONFLICTING POWER POLE TO BE REMOVED. THE MOUNTING HEIGHT IS 30 FEET.

FP&L TO INSTALL A 12-FOOT LONG/3.5-FOOT RISE BRACKET ARM WITH LUMINAIRE (A) ON THE PROPOSED POWER POLE THAT IS REPLACING THE CONFLICTING POWER POLE TO BE REMOVED. THE MOUNTING HEIGHT IS 30 FEET.

MATCHLINE STA. - 148+80.00

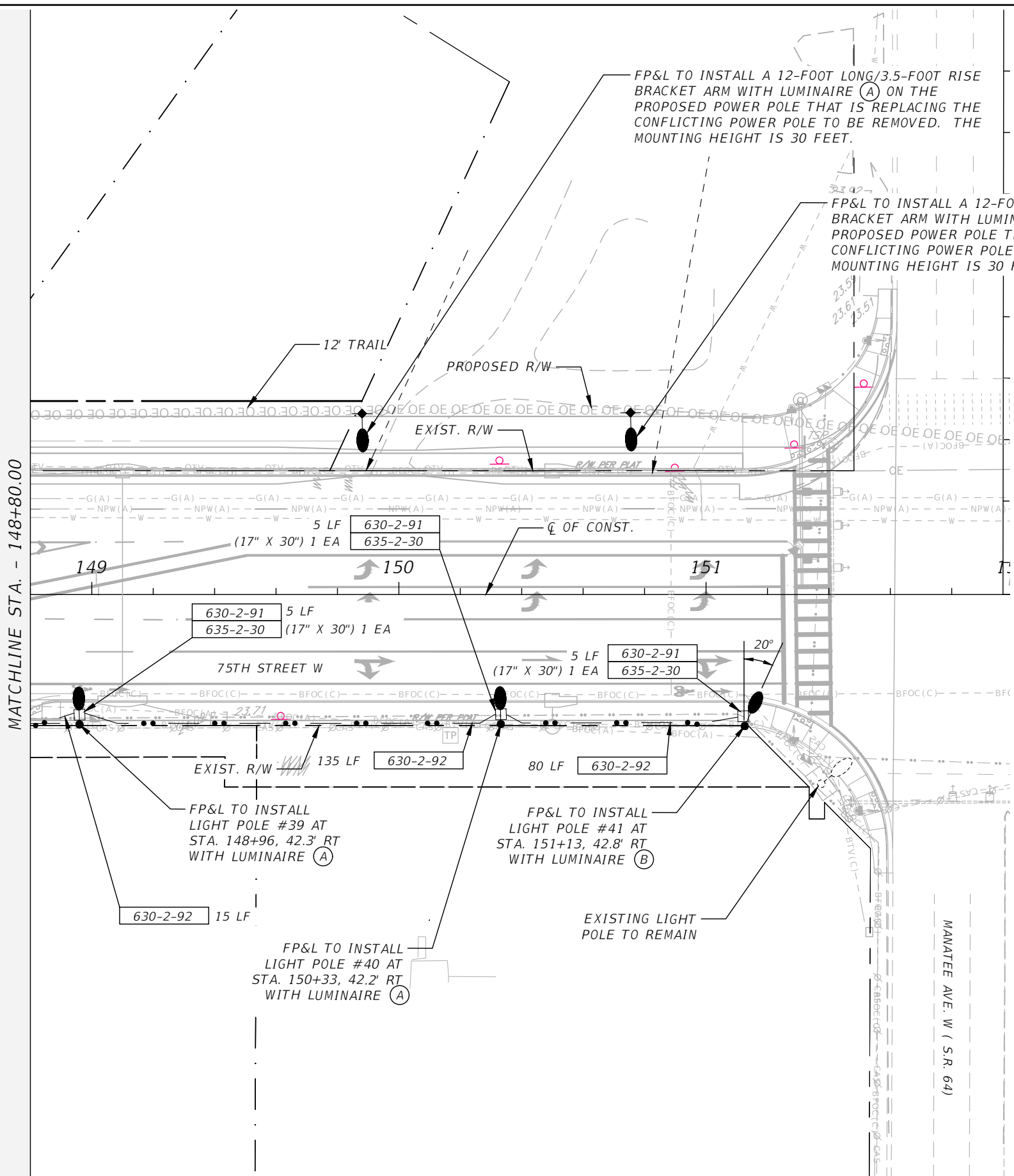

REVISIONS			
NO.	DESCRIPTION	DATE	BY



DAVID J. ALLEN, P.E.  
P.E. LICENSE NUMBER 58540  
380 PARK PLACE BOULEVARD  
SUITE 300  
CLEARWATER, FLORIDA, 33759  
(727) 531-3505

**MANATEE COUNTY**  
PUBLIC WORKS  
COUNTY PROJECT NO:  
6108260

75TH STREET WEST FROM  
20TH AVENUE W. TO MANATEE AVENUE W. (SR 64)  
**LIGHTING PLAN (10)**

SHEET NO.  
L-15

THE OFFICIAL RECORD OF THIS SHEET IS THE ELECTRONIC FILE DIGITALLY SIGNED AND SEALED UNDER RULE 61G15-23.004, F.A.C.