

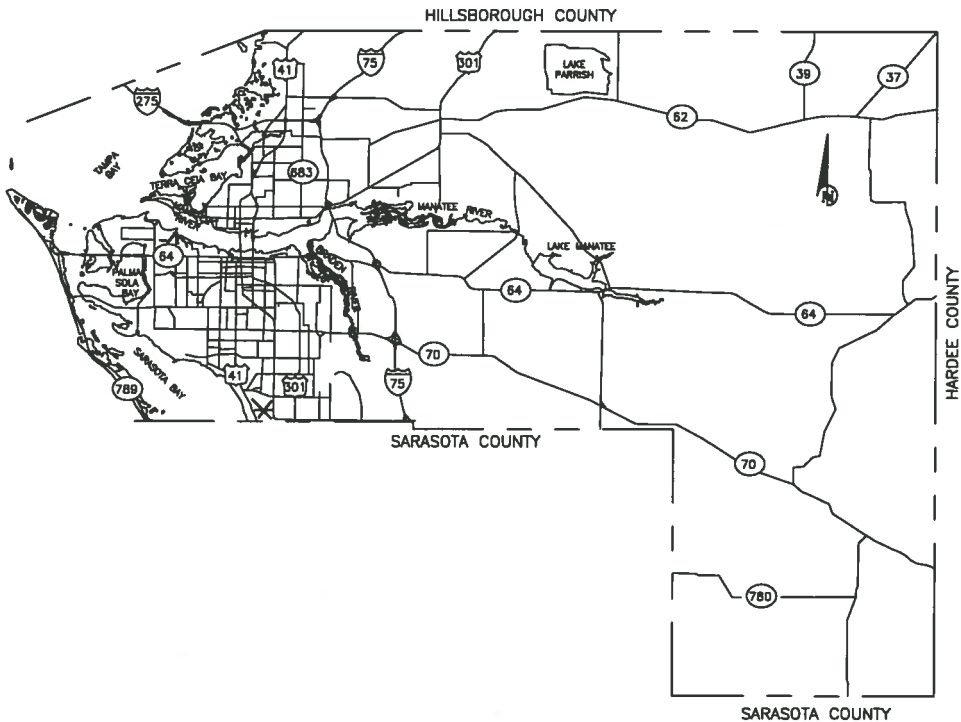

TRANSIT BUS STOP UPGRADES MANATEE COUNTY, FLORIDA 436-9008930

May 2012



PROJECT DESCRIPTION:

DESIGN AND CONSTRUCT SIDEWALKS AND PLATFORMS TO MAKE ADA COMPLIANT

STANDARD SPECIFICATIONS:

GOVERNING STANDARDS AND SPECIFICATIONS: FLORIDA DEPARTMENT OF TRANSPORTATION DESIGN STANDARDS, DATED 2010, AND APPLICABLE ARTICLES AND SUBARTICLES OF DIVISION I AND ALL OF DIVISIONS II & III OF THE FLORIDA DEPARTMENT OF TRANSPORTATION STANDARD SPECIFICATIONS FOR ROAD AND BRIDGE CONSTRUCTION, DATED 2010, AS AMENDED BY CONTRACT DOCUMENTS OR MCPWD STANDARDS, AS NOTED.

STANDARDS SPECIFICATION USED FOR BUS STOP DESIGN:

- FDOT TRANSIT FACILITY HANDBOOK (2007)
- FDOT TRANSIT FACILITIES GUIDELINES
- ACCESSING TRANSIT DESIGN HANDBOOK FOR FLORIDA BUS PASSENGER FACILITIES VERSION II, (2008).

BID PACKAGE 100%

NO. INDEX OF SHEETS

1. COVER SHEET
- 2-2A. SUMMARY OF PAY ITEMS
3. LOCATION MAP
4. BUS STOP #24
5. BUS STOP #256
6. BUS STOP #438
7. BUS STOP #560
8. BUS STOP #705
9. BUS STOP #884
- 10-12. MANATEE COUNTY DETAIL SHEET
- 13-15. FDOT DETAILS
16. EROSION CONTROL
- 17-18. SILT FENCING PLAN

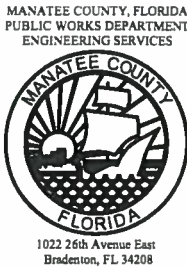
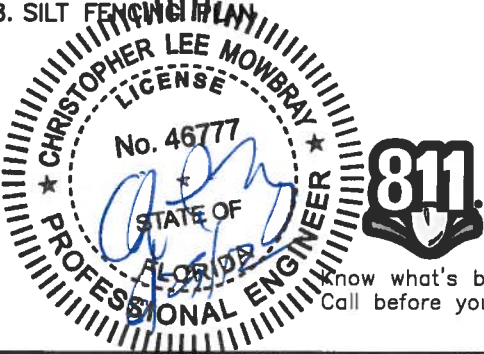

TRANSIT BUS STOP UPGRADES MANATEE COUNTY, FLORIDA

NO.	DATE
BY	
REVISION DESCRIPTION	
NO.	
PROJECT #	436-9008930
SURVEY #	
SEC./TWN./RGE	
SCALE	NTS
	BY DATE
SURVEYED	00/00/00
DESIGNED	AM 03/19/12
DRAWN	DO'M 03/19/12
CHECKED	00/00/00
C. MOWBRAY P.E.	
FLORIDA P.E. # 46777	
Signature & Date	
SHEET 1	

TRANSIT BUS STOP UPGRADES
MANATEE COUNTY, FLORIDA
SUMMARY OF PAY ITEMS

PROJECT NAME:		Bus Stop Number # 24		
	ITEM NO.	DESCRIPTION	UNIT	QUANTITY
		ROADWAY		
1	0101-1	MOBILIZATION	LS	1
2	0102-1	MAINTENANCE OF TRAFFIC	LS	1
3	0110 4	REMOVAL OF EXISTING CONCRETE PAVEMENT	SY	43
4	0104-10-3	SEDIMENT BARRIER	LF	90
5	0120 1	REGULAR EXCAVATION	CY	16
6	0400-1-2	TYPE D CURB CONCRETE CLASS I	CY	2.13
8	0522-1	SIDEWALK CONCRETE, 4" THICK	SY	37
9	522-2	SIDEWALK CONCRETE, 6" THICK	SY	31
10	0570-1-2	PERFORMANCE TURF, SOD	SY	92
11	700-20-40	SINGLE POST SIGN, RELOCATE	AS	1

PROJECT NAME:		Bus Stop Number # 438		
	ITEM NO.	DESCRIPTION	UNIT	QUANTITY
		ROADWAY		
1	0101-1	MOBILIZATION	LS	1
2	0102-1	MAINTENANCE OF TRAFFIC	LS	1
3	0110 4	REMOVAL OF EXISTING CONCRETE PAVEMENT	SY	4
4	0104-10-3	SEDIMENT BARRIER	LF	77
6	0110-4	TYPE D CURB TO BE REMOVED	SY	4
7	0120-1	REGULAR EXCAVATION	CY	1
8	0120-6	EMBANKMENT	CY	7
9	0520-1-10	CONCRETE CURB & GUTTER, TYPE F	LF	21
10	0522-2	SIDEWALK CONCRETE, 6" THICK	SY	34
11	0570-1-2	PERFORMANCE TURF, SOD	SY	6
12	700-20-40	SINGLE POST SIGN, RELOCATE	AS	2

PROJECT NAME:		Bus Stop Number # 256		
	ITEM NO.	DESCRIPTION	UNIT	QUANTITY
		ROADWAY		
1	0101-1	MOBILIZATION	LS	1
2	0102-1	MAINTENANCE OF TRAFFIC	LS	1
3	0110 4	REMOVAL OF EXISTING CONCRETE PAVEMENT	SY	18
4	0104-10-3	SEDIMENT BARRIER	LF	140
5	0120 1	REGULAR EXCAVATION	CY	5
6	0522-1	SIDEWALK CONCRETE, 4" THICK	SY	13
7	522-2	SIDEWALK CONCRETE, 6" THICK	SY	17
8	0570-1-2	PERFORMANCE TURF, SOD	SY	7
9	700-20-40	SINGLE POST SIGN, RELOCATE	AS	1

PROJECT NAME:		Bus Stop Number # 560		
	ITEM NO.	DESCRIPTION	UNIT	QUANTITY
		ROADWAY		
1	0101-1	MOBILIZATION	LS	1
2	0102-1	MAINTENANCE OF TRAFFIC	LS	1
3	0104-10-3	SEDIMENT BARRIER	LF	90
4	0120 1	REGULAR EXCAVATION	CY	7
5	0400-1-25	TRENCH DRAIN CONCRETE CLASS I	CY	1
6	0520-1-7	CONCRETE CURB & GUTTER, TYPE E	LF	15
7	0522-1	SIDEWALK CONCRETE, 4" THICK	SY	16
8	522-2	SIDEWALK CONCRETE, 6" THICK	SY	14
9	0570-1-2	PERFORMANCE TURF, SOD	SY	115
10	700-20-40	SINGLE POST SIGN, RELOCATE	AS	1

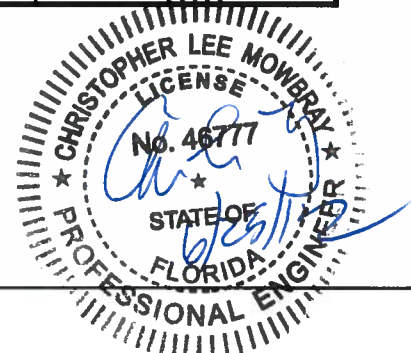

DATE					
BY					
REVISION DESCRIPTION					
NO.					
PROJECT #	438-9008930				
SURVEY #					
SEC./TWN./RGE					
SCALE	NTS				
	BY	DATE			
SURVEYED	-----	00/00/00			
DESIGNED	AAM	03/19/12			
DRAWN	DO'M	03/19/12			
CHECKED	-----	00/00/00			

C. MOWBRAY P.E.
FLORIDA P.E. # 46777

Signature & Date
SHEET 2

S:\P\0 - Engineering - State Highway Engineering\PROJECTS\Transit Bus Stop Upgrades\Unl Bus Stop Upgrades\Unl Bus Stop Upgrades\ITEMS 2A - 6/26/2012 8:38 AM\Drawn\Drawn\11 x 17"

PROJECT NAME:		Bus Stop Number # 705		
	ITEM NO.	DESCRIPTION	UNIT	QUANTITY
		ROADWAY		
1	0101-1	MOBILIZATION	LS	1
2	0102-1	MAINTENANCE OF TRAFFIC	LS	1
3	102-911-2	PA VEMENT MARKING REMOVABLE	SF	361
4	0104-10-3	SEDIMENT BARRIER	LF	140
5	0120 1	REGULAR EXCA VATION	CY	23
6	0120-6	EMBANKMENT	CY	66
7	MC-XXX	RECONSTRUCT GRA TE INLET	EA	1
8	430174201	14x23 ERCP	LF	59
9	430984629	MITERED END SECT, OPTIONAL - ELLIPTICAL 14" x 23"	EA	1
10	0520-1-7	CONCRETE CURB & GUTTER, TYPE E	LF	15
11	0522-1	SIDEWALK CONCRETE, 4" THICK	SY	44
12	522-2	SIDEWALK CONCRETE, 6" THICK	SY	15
13	0570-1-2	PERFORMANCE TURF, SOD	SY	101
13	700-20-40	SINGLE POST SIGN, RELOCA TE	AS	1
14	0711 11123	THERMOPLASTIC, STANDARD, WHITE, SOLID, 12"	LF	60

PROJECT NAME:		Bus Stop Number # 884		
	ITEM NO.	DESCRIPTION	UNIT	QUANTITY
		ROADWAY		
1	0101-1	MOBILIZATION	LS	1
2	0102-1	MAINTENANCE OF TRAFFIC	LS	1
3	0104-10-3	SEDIMENT BARRIER	LF	140
4	0120 1	REGULAR EXCA VATION	CY	8
5	0400-1-25	TRENCH DRAIN CONCRETE CLASS I	CY	1
6	0520-1-7	CONCRETE CURB & GUTTER, TYPE E	LF	15
7	0522-1	SIDEWALK CONCRETE, 4" THICK	SY	16
8	522-2	SIDEWALK CONCRETE, 6" THICK	SY	14
9	0570-1-2	PERFORMANCE TURF, SOD	SY	105
10	700-20-40	SINGLE POST SIGN, RELOCA TE	AS	1



TRANSIT BUS STOP UPGRADES
MANATEE COUNTY, FLORIDA
SUMMARY OF PAY ITEMS

DATE					
BY					
REVISION					
DESCRIPTION					
NO.					
PROJECT #	436-9008930				
SURVEY #					
SEC./TWN./RGE					
SCALE	NTS				
	BY	DATE			
SURVEYED	-----	00/00/00			
DESIGNED	AMM	03/19/12			
DRAWN	DO'M	03/19/12			
CHECKED	-----	00/00/00			

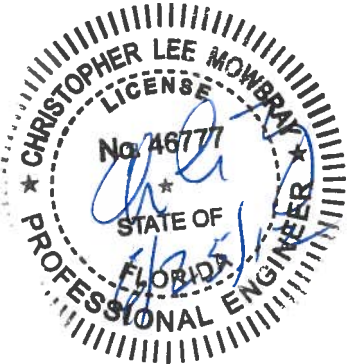

C. MOWBRAY P.E.
FLORIDA P.E. # 46777
Signature & Date
SHEET 2A

C. MOWBRAY P.E.
FLORIDA P.E. # 46777

SHEET 3

S:\PMD-Engineering\Share\1800\2012\Engineering\PROJECTS\Transit Bus Stop Upgrade\DWG\BUS STOP=95-21-12440-24.dwg, 4/22/2012 9:15:41 AM Aldys Alcaraz-Monreal, 11' x 17' 0" inches

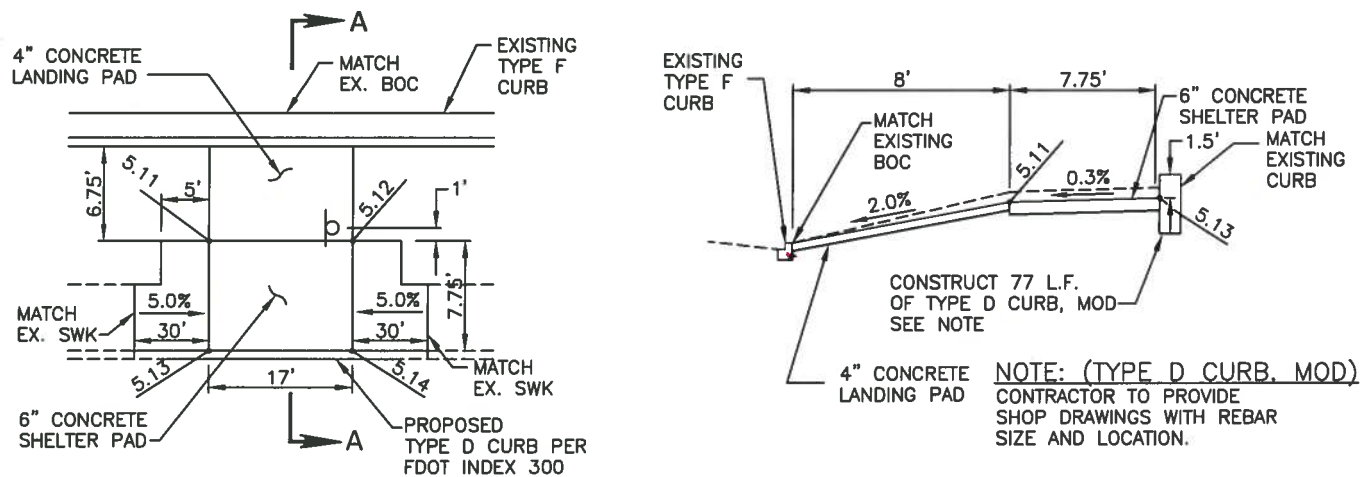
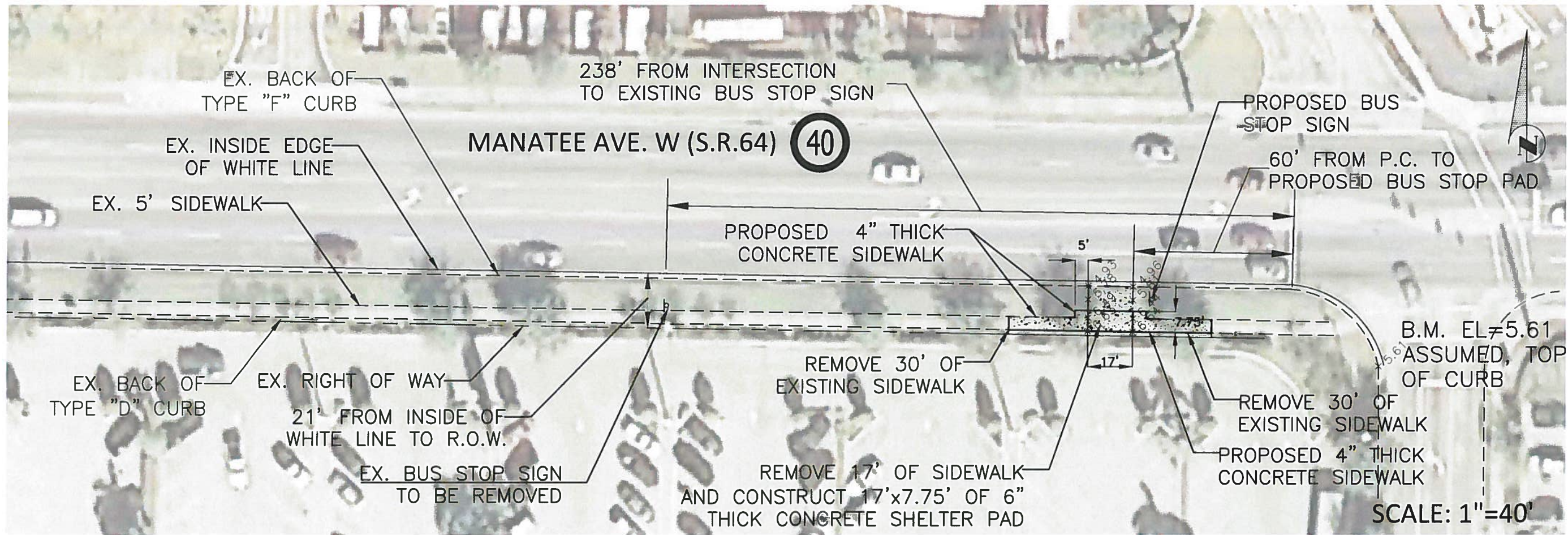

NOTES URBAN CONDITION (WITH/WITHOUT GRASS STRIP):

-IF PERMITTED BY R.O.W., PROVIDE A CONTINUOUS 8' WIDE CONCRETE PAD ALONG THE ENTIRE LENGTH (40' STANDARD BUS-60' ARTICULATED BUS) OF THE BUS STOP ADJACENT TO THE CURB & GUTTER. AN ADDITIONAL 50' LENGTH IS RECOMMENDED FOR EACH ADDITIONAL BUS EXPECTED TO SIMULTANEOUSLY STOP AT THE BUS STOP.

-A.D.A. LANDING PAD MINIMUM DIMENSIONS ARE TO BE PROVIDED UNLESS R.O.W. DOES NOT ALLOW.

**BUS STOP PAD AND SIGNAGE
URBAN/CURB CONDITION**

N.T.S.

SECTION A-A

NOTE: SOD ALL
DISTURBED AREAS

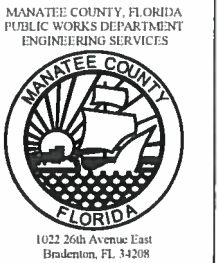
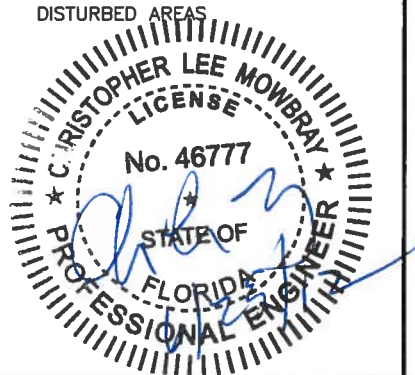

**TRANSIT BUS STOP UPGRADES
MANATEE COUNTY, FLORIDA
STOP I.D. 24**

NO.	DATE	BY	REVISION DESCRIPTION

PROJECT #	436-9008930
SURVEY #	000
SEC./TWN./RGE	28/34S/17E
SCALE	AS NOTED
SURVEYED	00/00/00
DESIGNED	AMM 03/19/12
DRAWN	DO'M/TF 03/20/12
CHECKED	

C. MOWBRAY P.E.
FLORIDA P.E. # 46777

Signature & Date
SHEET 4

S PWD Engineering - Share Highway Engineering PROJECT'S Transit Bus Stop Upgrades DMC BUS STOP-5-21 12 Aug. 256 6/22/2012 9 15 AM Aduys AiceonMontantos, I. 1. ANSI expand B (11 00 x 17 00 inches)

DATE					
BY					
REVISION					
DESCRIPTION					
NO.					
PROJECT #	436-9008930				
SURVEY #	000				
SEC./TWN./RGE	08/35S/18E				
SCALE	AS NOTED				
	BY	DATE			
SURVEYED	-----	00/00/00			
DESIGNED	AAM	03/19/12			
DRAWN	DO'M/TF	03/20/12			
CHECKED	-----				
C. MOWBRAY P.E.					
FLORIDA P.E. # 46777					
Signature & Date					
SHEET 5					



S PWD Engineering - Share Highway Engineering PROJECT'S Transit Bus Stop Upgrades DMC BUS STOP-5-21 12 Aug. 256 6/22/2012 9 15 AM Aduys AiceonMontantos, I. ANSI expand B (11 00 x 17 00 inches)



S:\P\01_Engineering\Share\Highway_Engineering\PROJECTS\Transit Bus Stop Upgrades\DWG\BUS STOP-5-21-12.dwg, 6/22/2012 9:15 AM, AUP, 11.00 x 17.00 inches

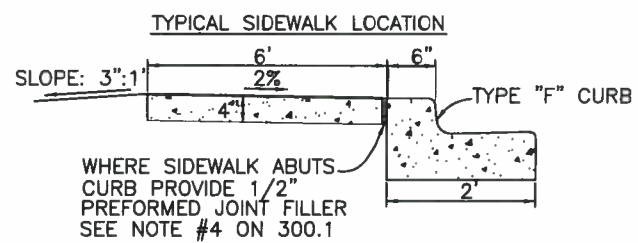
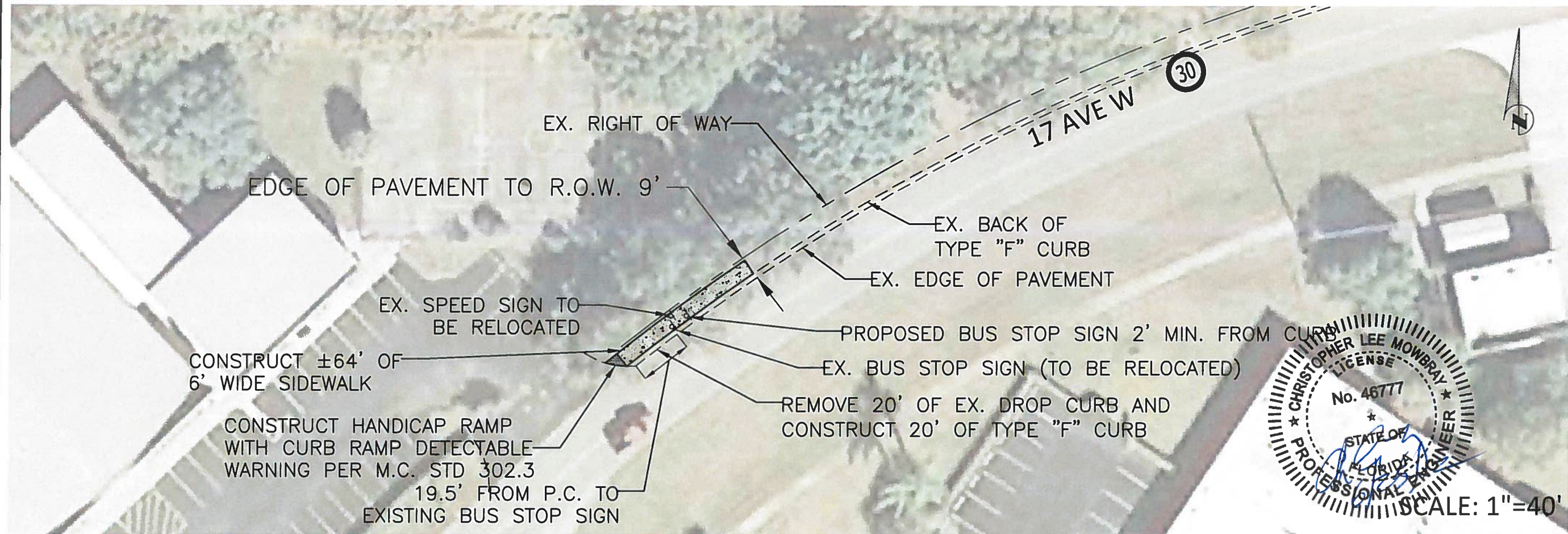

LEGEND	
	SPEED LIMIT MPH
	SIGN

NOTES: URBAN CONDITION (WITH/WITHOUT GRASS STRIP):

-IF PERMITTED BY R.O.W., PROVIDE A CONTINUOUS 8' WIDE CONCRETE PAD ALONG THE ENTIRE LENGTH (40' STANDARD BUS-60' ARTICULATED BUS) OF THE BUS STOP ADJACENT TO THE CURB & GUTTER. AN ADDITIONAL 50' LENGTH IS RECOMMENDED FOR EACH ADDITIONAL BUS EXPECTED TO SIMULTANEOUSLY STOP AT THE BUS STOP.

-A.D.A. LANDING PAD MINIMUM DIMENSIONS ARE TO BE PROVIDED UNLESS R.O.W. DOES NOT ALLOW.

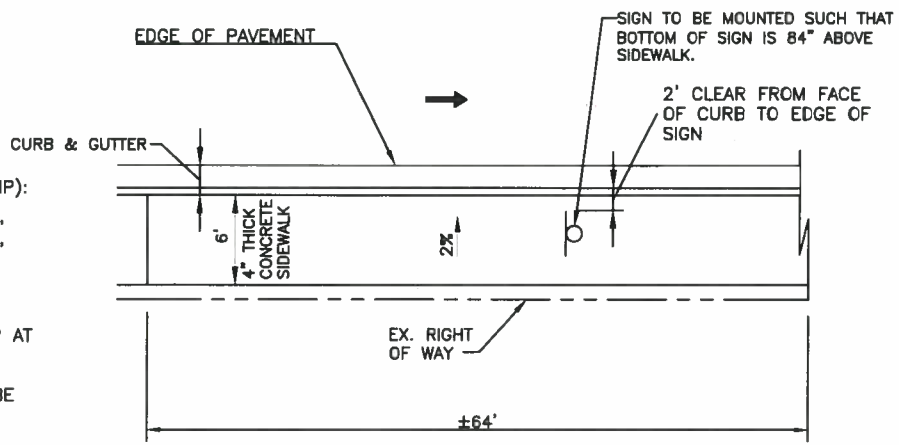

NOTE: SOD ALL DISTURBED AREAS

BUS STOP PAD AND SIGNAGE
URBAN/CURB & GUTTER CONDITION WITHOUT GRASS STRIP
N.T.S.



TRANSIT BUS STOP UPGRADES
MANATEE COUNTY, FLORIDA
STOP I.D. 438

NO.		REVISION DESCRIPTION		BY	DATE
PROJECT #		436-9008930			
SURVEY #		000			
SEC./TWN./RGE		32/34S/17E			
SCALE		AS NOTED			
SURVEYED		-----	00/00/00		
DESIGNED		AAM	03/19/12		
DRAWN		DO'M/TF	03/20/12		
CHECKED		-----			
C. MOWBRAY P.E.					
FLORIDA P.E. # 46777					
Signature & Date					
SHEET 6					

S:\P\010 Engineering - Short Highway Engineering\PROJECTS\Visual Bus Stop Upgrades\Visual Bus Stop-5-21-12.dwg, 5/21/12, 10:02 AM, 11 x 17"

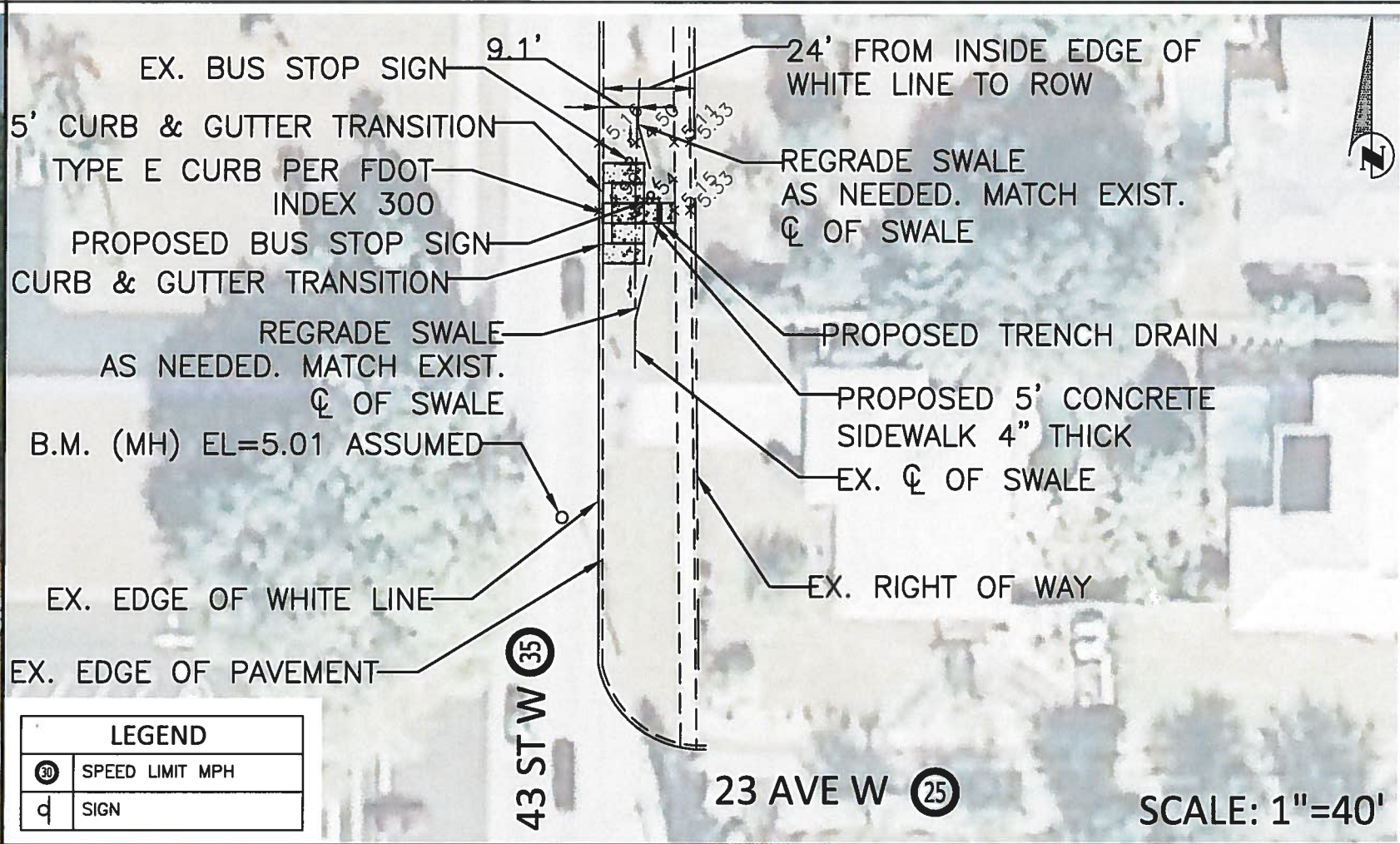

LEGEND	
30	SPEED LIMIT MPH
d	SIGN

MANATEE COUNTY, FLORIDA
PUBLIC WORKS DEPARTMENT
ENGINEERING SERVICES

1022 26th Avenue East
Bradenton, FL 34208

TRANSIT BUS STOP UPGRADES
MANATEE COUNTY, FLORIDA
STOP I.D. 560

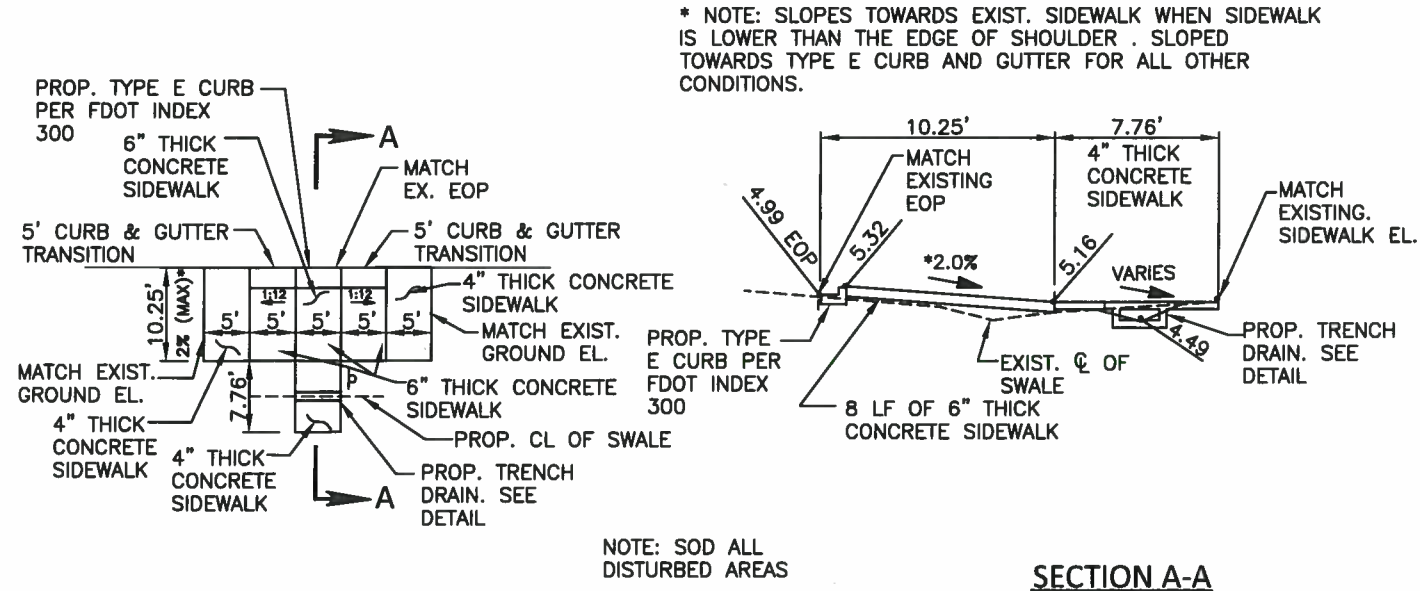

NOTES:

- FOR A BUS STOP IN RURAL CONDITIONS, THE BUS STOP SIGN SHOULD BE LOCATED OUTSIDE THE CLEAR ZONE OF THE ROAD; WHERE POSSIBLE IT IS DESIRABLE TO BUILD A CONCRETE PAD FOR A SHELTER.
- CONCRETE SIDEWALK WITHIN CLEAR ZONE SHOULD MEET ADA CRITERIA.

**BUS STOP PAD AND SINAGE
RURAL/SHOULDER CONDITION**
N.T.S.

SECTION A-A
N.T.S.

NOTE: SOD ALL DISTURBED AREAS

NOTE: SLOPES TOWARDS EXIST. SIDEWALK WHEN SIDEWALK IS LOWER THAN THE EDGE OF SHOULDER. SLOPED TOWARDS TYPE E CURB AND GUTTER FOR ALL OTHER CONDITIONS.

NOTE: SLOPES ARE REPRESENTATIVE AND VARY WITH LOCATION. ADJUST DESIGN TO LOCAL CONDITIONS.

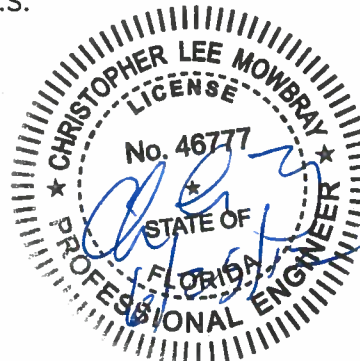
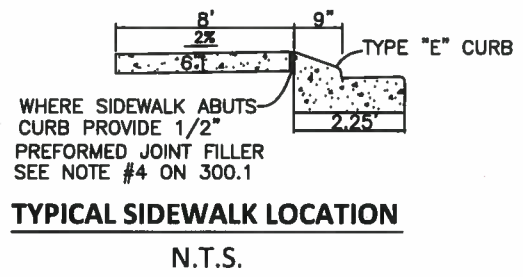
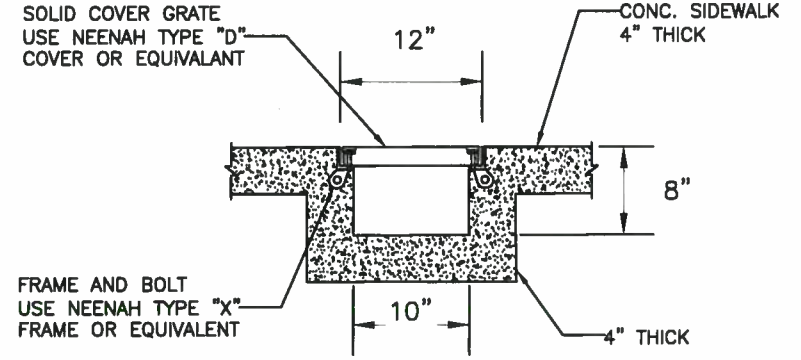
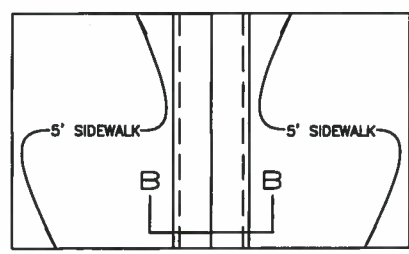

DATE	
BY	
REVISION DESCRIPTION	
NO.	
PROJECT #	436-0008930
SURVEY #	000
SEC./TWN./RGE	33/34S/17E
SCALE	AS NOTED
SURVEYED	00/00/00
DESIGNED	AMM 03/19/12
DRAWN	DO'M/TF 03/20/12
CHECKED	00/00/12
C. MOWBRAY P.E.	
FLORIDA P.E. # 46777	
Signature & Date	
SHEET 7	

**TRANSIT BUS STOP UPGRADES
MANATEE COUNTY, FLORIDA
STOP I.D. 705**

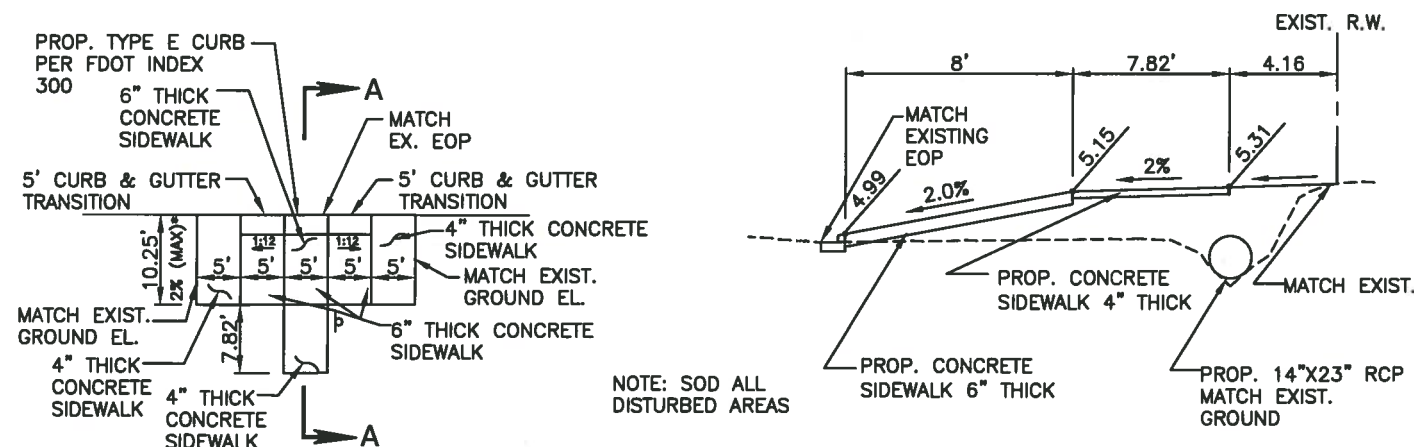
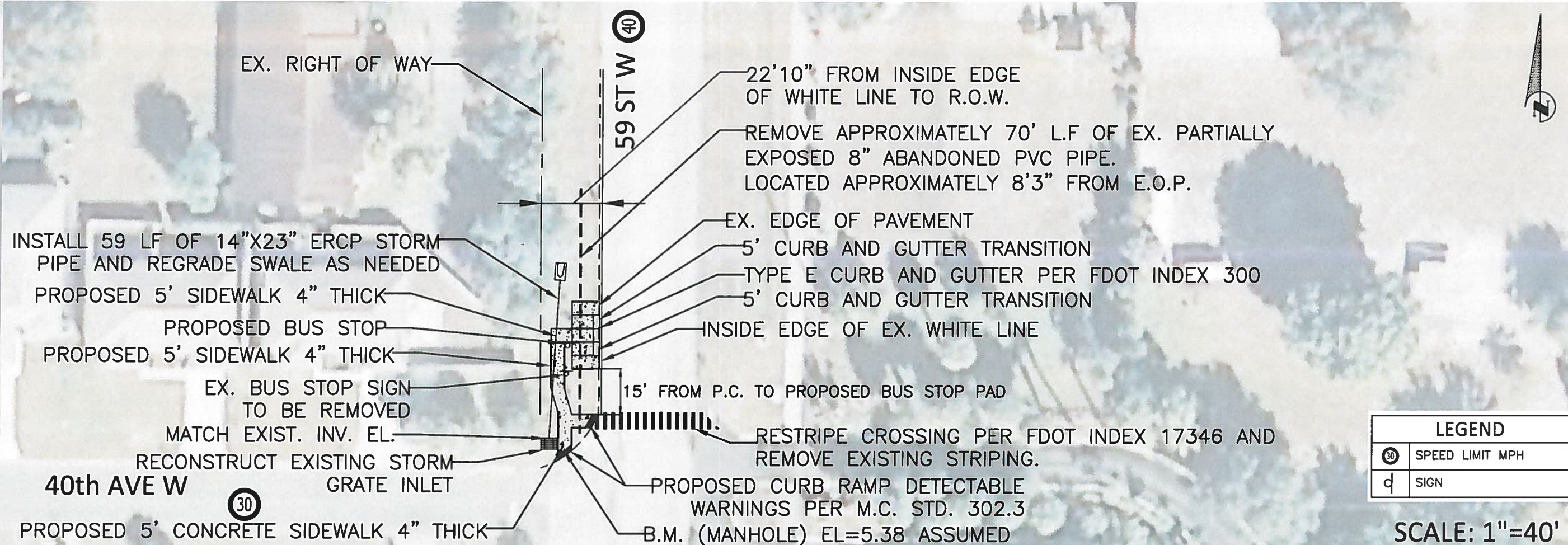

-FOR A BUS STOP IN RURAL CONDITIONS, THE BUS STOP SIGN SHOULD BE LOCATED OUTSIDE THE CLEAR ZONE OF THE ROAD; WHERE POSSIBLE IT IS DESIRABLE TO BUILD A CONCRETE PAD FOR A SHELTER.

- CONCRETE SIDEWALK WITHIN CLEAR ZONE SHOULD MEET ADA CRITERIA.

-SLOPES ARE REPRESENTATIVE AND VARY WITH LOCATION. ADJUST DESIGN TO LOCAL CONDITIONS.

**BUS STOP PAD AND SINAGE
RURAL/SHOULDER CONDITION**
N.T.S.

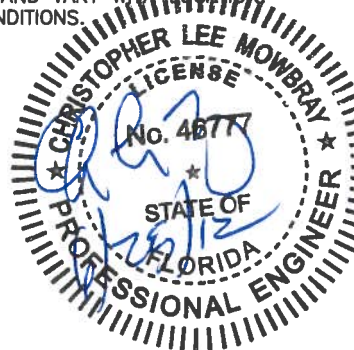

DATE					
BY					
REVISION DESCRIPTION					
NO.					
PROJECT #		436-8008930			
SURVEY #		000			
SEC./TWN./RGE		05/35S/17E			
SCALE		AS NOTED			
SURVEYED	-----	00/00/00			
DESIGNED	AAM	03/19/12			
DRAWN	DO'W/TF	03/20/12			
CHECKED	-----				
C. MOWBRAY P.E.					
FLORIDA P.E. # 46777					
Signature & Date					
SHEET 8					

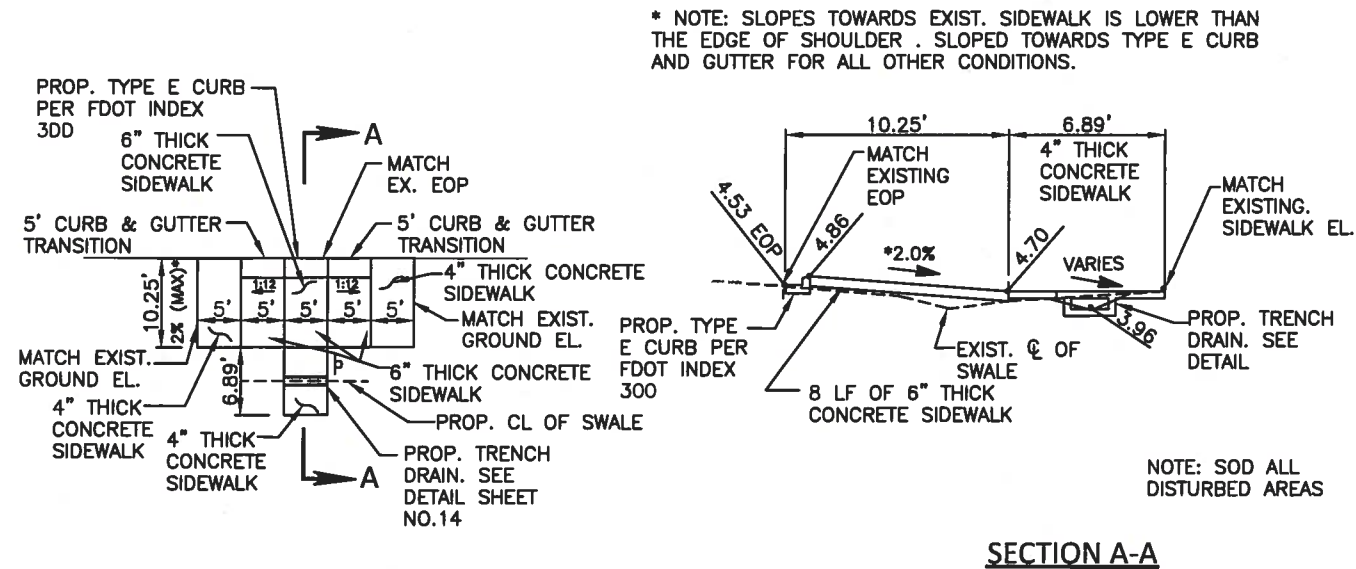
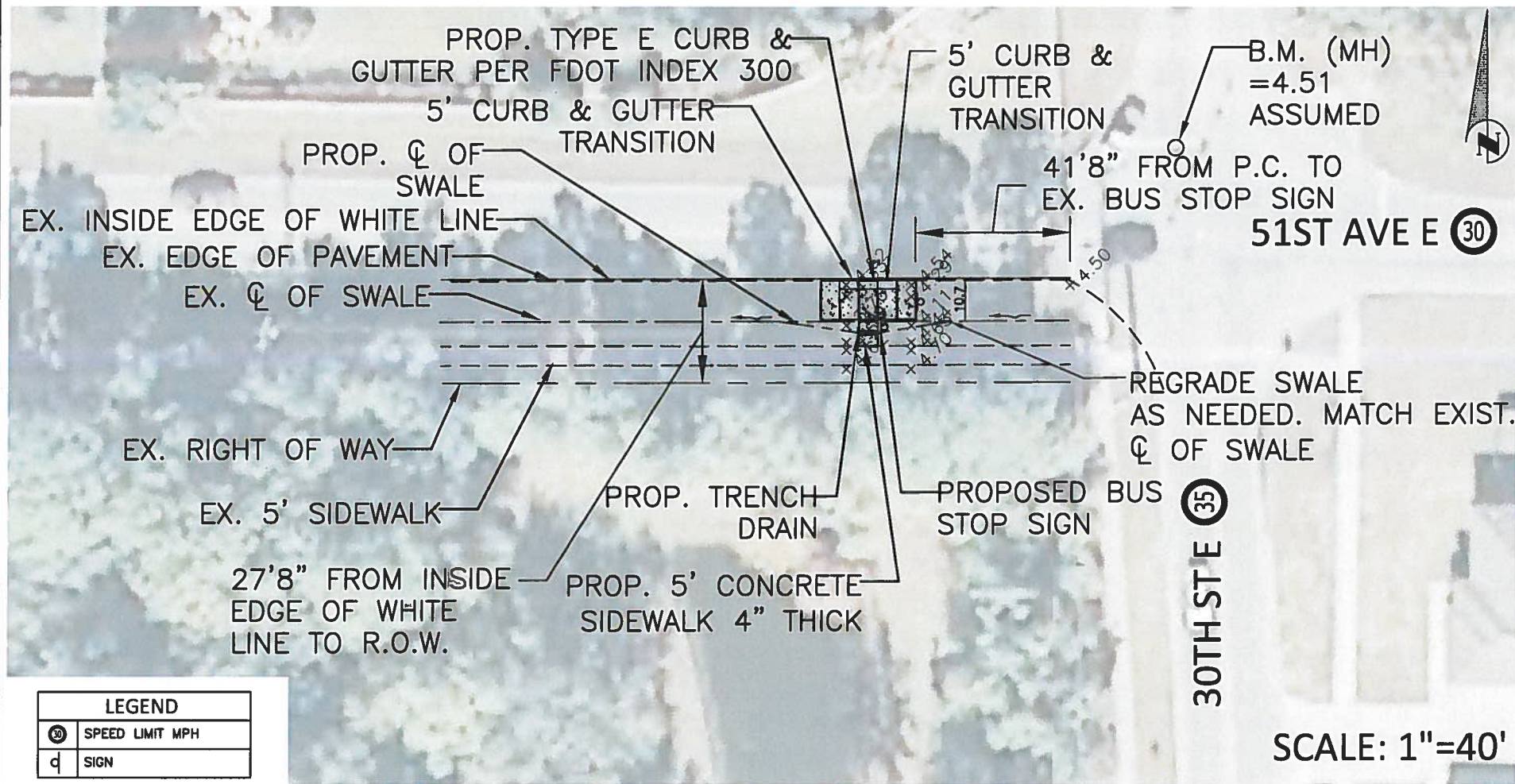

NOTES:

-FOR A BUS STOP IN RURAL CONDITIONS, THE BUS STOP SIGN SHOULD BE LOCATED OUTSIDE THE CLEAR ZONE OF THE ROAD; WHERE POSSIBLE IT IS DESIRABLE TO BUILD A CONCRETE PAD FOR A SHELTER.

- CONCRETE SIDEWALK WITHIN CLEAR ZONE SHOULD MEET ADA CRITERIA.

-SLOPES ARE REPRESENTATIVE AND VARY WITH LOCATION. ADJUST DESIGN TO LOCAL CONDITIONS.

BUS STOP PAD AND SINAGE
RURAL/SOULDER CONDITION
N.T.S.

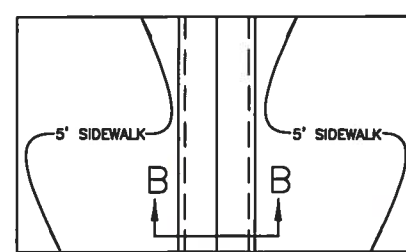

PLAN VIEW
SCALE: N.T.S.

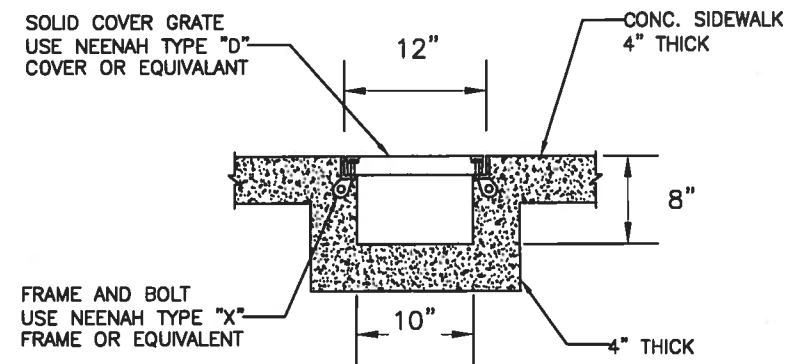

SECTION B-B
SCALE: N.T.S.

TRENCH DRAIN DETAIL
SCALE: N.T.S.

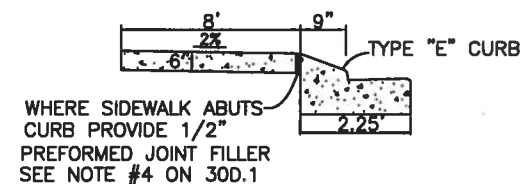

TYPICAL SIDEWALK LOCATION
N.T.S.

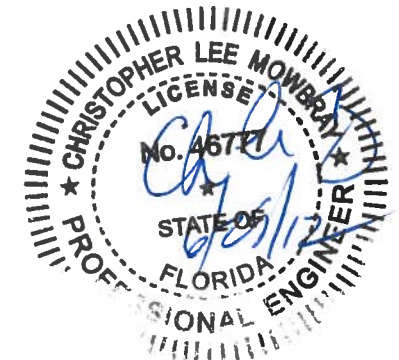

TRANSIT BUS STOP UPGRADES
MANATEE COUNTY, FLORIDA
STOP I.D. 884

NO.	DATE	BY	REVISION DESCRIPTION
PROJECT #	438-9008930		
SURVEY #	000		
SEC./TWN./RGE	08/35S/18E		
SCALE	AS NOTED		
BY	DATE		
SURVEYED	00/00/00		
DESIGNED	AAM 03/19/12		
DRAWN	DO'M/TF 03/20/12		
CHECKED			
C. MOWBRAY P.E.			
FLORIDA P.E. # 46777			
Signature & Date			
SHEET 9			

MEASUREMENTS & QUANTITIES

DIMENSIONS & QUANTITIES													
	Rise R	Span S	X	A	B	C	E	F	G	M			
										Single Pipe	Double Pipe	Triple Pipe	Quad. Pipe
2:1 Slope	12"	18"	2'-10"	1.97'	1.62'	3.59'	1.56'	4'	1.50'	4.92'	7.75'	10.58'	13.42'
	14"	23"	3'-4"	2.01'	1.99'	4.00'	1.89'	5'	1.90'	5.38'	8.71'	12.04'	15.38'
	19"	30"	4'-0"	2.11'	2.92'	5.03'	2.73'	6'	2.37'	6.04'	10.04'	14.04'	18.04'
	24"	38"	5'-0"	2.20'	3.85'	6.05'	3.56'	7'	2.85'	6.79'	11.79'	16.79'	21.79'
	29"	45"	5'-11"	2.34'	4.79'	7.13'	4.39'	8'	3.19'	7.50'	13.42'	19.33'	25.25'
	34"	53"	7'-0"	2.43'	5.72'	8.15'	5.23'	9'	3.57'	8.25'	15.25'	22.25'	29.25'
	38"	60"	7'-10"	2.52'	6.46'	8.98'	5.89'	9'	3.95'	8.92'	16.75'	24.58'	32.42'
	43"	68"	8'-11"	2.62'	7.39'	10.01'	6.73'	10'	4.28'	9.67'	18.58'	27.50'	36.42'
	48"	76"	9'-11"	2.71'	8.33'	11.04'	7.56'	11'	4.59'	10.42'	20.33'	30.25'	40.17'
	53"	83"	10'-8"	2.80'	9.26'	12.06'	8.39'	12'	4.77'	11.08'	21.75'	32.42'	43.08'
58"	91"	11'-8"	2.90'	10.19'	13.09'	9.23'	13'	5.01'	11.83'	23.50'	35.17'	46.83'	
4:1 Slope	12"	18"	2'-10"	2.36'	3.06'	5.42'	3.03'	5'	1.50'	4.92'	7.75'	10.58'	13.42'
	14"	23"	3'-4"	2.44'	3.75'	6.19'	3.70'	6'	1.90'	5.38'	8.71'	12.04'	15.38'
	19"	30"	4'-0"	2.62'	5.47'	8.09'	5.36'	8'	2.37'	6.04'	10.04'	14.04'	18.04'
	24"	38"	5'-0"	2.79'	7.18'	9.97'	7.03'	10'	2.85'	6.79'	11.79'	16.79'	21.79'
	29"	45"	5'-11"	3.05'	8.90'	11.95'	8.70'	12'	3.19'	7.50'	13.42'	19.33'	25.25'
	34"	53"	7'-0"	3.22'	10.62'	13.84'	10.36'	13'	3.57'	8.25'	15.25'	22.25'	29.25'
	38"	60"	7'-10"	3.39'	11.99'	15.38'	11.70'	15'	3.95'	8.92'	16.75'	24.58'	32.42'
	43"	68"	8'-11"	3.56'	13.71'	17.27'	13.36'	17'	4.28'	9.67'	18.58'	27.50'	36.42'
	48"	76"	9'-11"	3.73'	15.43'	19.16'	15.03'	19'	4.59'	10.42'	20.33'	30.25'	40.17'
	53"	83"	10'-8"	3.91'	17.15'	21.06'	16.70'	20'	4.77'	11.08'	21.75'	32.42'	43.08'
58"	91"	11'-8"	4.08'	18.87'	22.95'	18.36'	22'	5.01'	11.83'	23.50'	35.17'	46.83'	

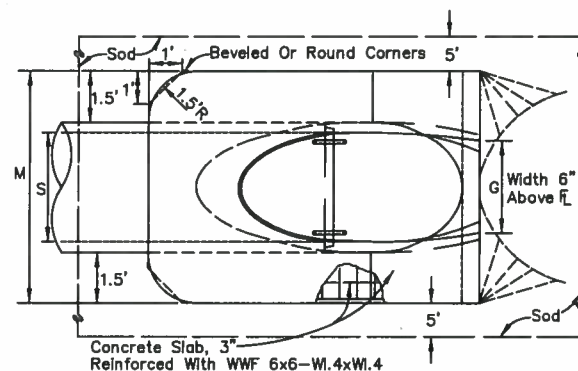

TOP VIEW—SINGLE PIPE

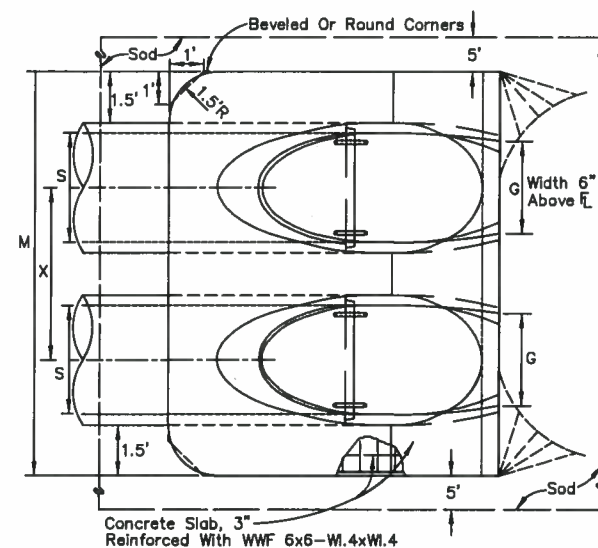

TOP VIEW—MULTIPLE PIPE

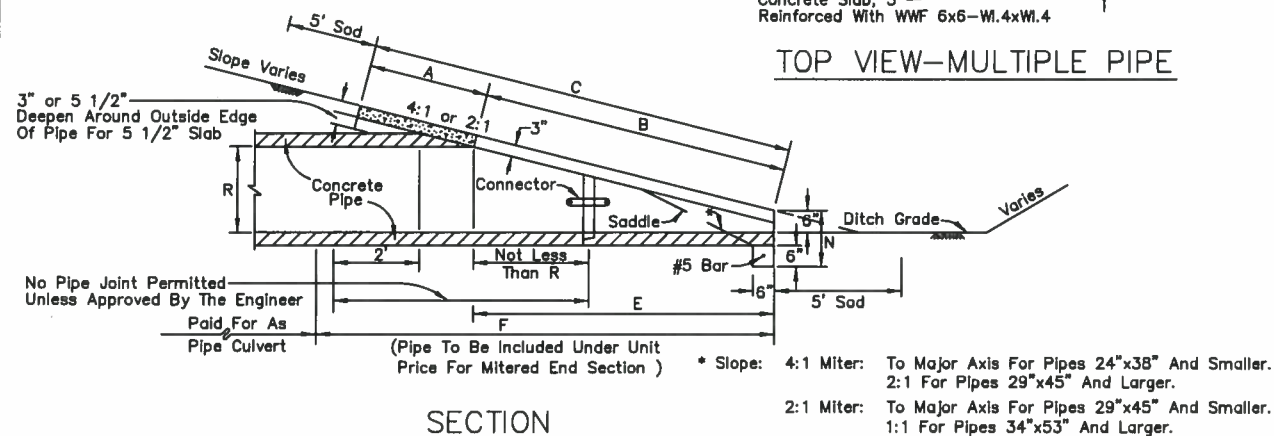

SECTION

MANATEE COUNTY
TRANSPORTATION DEPARTMENT

MITERED END SECTION FOR ELLIPTICAL, SINGLE, AND MULTIPLE PIPES

102.1

NOTE: FILTER FABRIC NOT
REQUIRED WHEN AN
O-RING GASKET IS
USED.

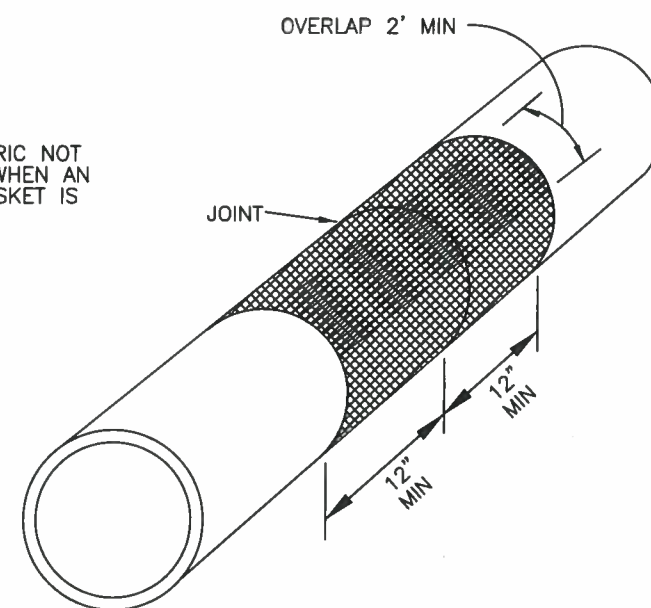

ISOMETRIC VIEW

NOTE: FILTER FABRIC MATERIAL
MUST MEET THE FOLLOWING
ASTM REQUIREMENTS:

ASTM D 4595
ASTM D 4632
ASTM D 4533
ASTM D 4833
ASTM D 4491

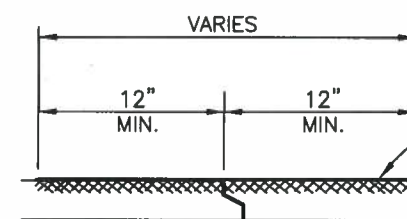

BUTT JOINT

— WOVEN OR NON-WOVEN
FILTER FABRIC
NOTE: NOT NECESSARY
WITH O-RING GASKET

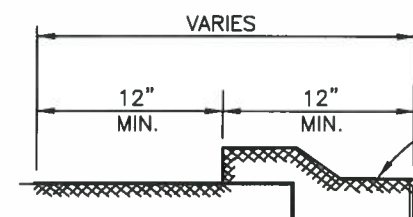

BELL JOINT

— WOVEN OR NON-WOVEN
FILTER FABRIC

MANATEE COUNTY
TRANSPORTATION DEPARTMENT

FILTER FABRIC JACKET

104.0

TRANSIT BUS STOP UPGRADES MANATEE COUNTY, FLORIDA DETAILS

[illegible]

C. MOWBRAY P.E.
FLORIDA P.E. # 46777

Signature & Date
SHEET 10

S:\PMD_Engineering_Share\Highway_Engineering\PROJECTS\Transit Bus Stop Upgrades\DWG\BUS STOP-5-21-12.dwg MC Details 2: 6/22/2012 9:15 AM AutoCAD LT 11.00 * 17.00 inches

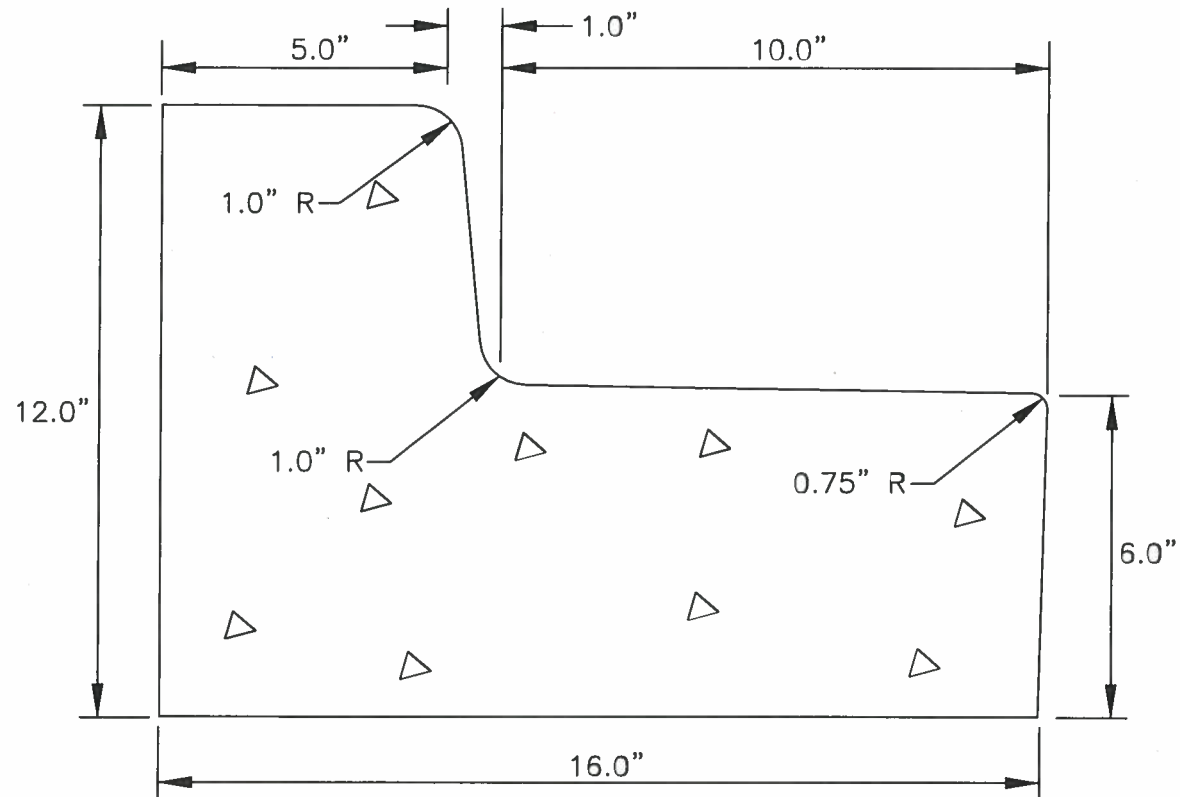

TYPE "AB"
MODIFIED CURB & GUTTER

- A) CLASS 1 CONCRETE 3,000 PSI AT 28 DAYS.
- B) CURB AND GUTTER SHALL MEET THE SPECIFICATIONS ESTABLISHED BY FLORIDA D.O.T. STANDARD SPECIFICATIONS PER F.D.O.T. ROADWAY AND TRAFFIC DESIGN STANDARDS STANDARDS INDEX NO. 300, LATEST REVISION.

MANATEE COUNTY TRANSPORTATION DEPARTMENT		TYPE "AB" MODIFIED CURB & GUTTER	201.3
REV. BY	DATE		
6/12/07 DATE OF B.O.C.C. APPROVAL			

MINIMUM WIDTH OF CLEAR ZONE

TYPE OF FACILITY	DESIGN SPEED (MPH)						MINIMUM CLEAR ZONE (FEET)	
	25 AND BELOW	30	35	40	45	50	55	60 AND ABOVE
RURAL •	6	6 LOCAL 10 COLLECTORS 14 ARTERIALS	6 LOCAL 10 COLLECTORS	10 COLLECTORS 14 ARTERIALS	14 ARTERIALS AND COLLECTORS ADT < 1500	14 ARTERIALS AND COLLECTORS ADT < 1500	18 ARTERIALS AND COLLECTORS ADT < 1500	18 ARTERIALS AND COLLECTORS ADT < 1500
					18 ARTERIALS AND COLLECTORS ADT ≥ 1500	18 ARTERIALS AND COLLECTORS ADT ≥ 1500	24 ARTERIALS AND COLLECTORS ADT ≥ 1500	30 ARTERIALS AND COLLECTORS ADT ≥ 1500
URBAN *	1 1/2	4 **	4 **	4 **	4 **	N/A **	N/A **	N/A **

* FROM FACE OF CURB.

** ON PROJECTS WHERE THE 4' MINIMUM OFFSET CANNOT BE REASONABLY OBTAINED AND OTHER ALTERNATIVES ARE DEEMED IMPRACTICAL, THE MINIMUM MAY BE REDUCED TO 1-1/2'.

• USE RURAL FOR URBAN FACILITIES WHEN NO CURB AND GUTTER IS PRESENT. MEASURED FROM THE EDGE OF THROUGH TRAVEL LANE ON RURAL SECTION.

•• CURB AND GUTTER NOT TO BE USED ON FACILITIES WITH DESIGN SPEED > 45 MPH.

NOTE: ADT IN TABLE REFERS TO DESIGN YEAR ADT.

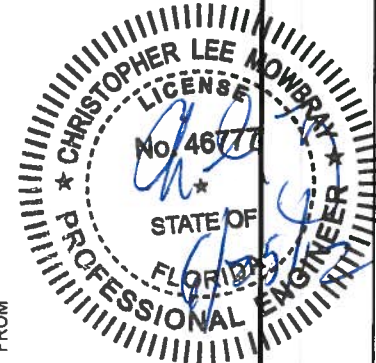

MANATEE COUNTY TRANSPORTATION DEPARTMENT		MINIMUM CLEAR ZONE WIDTHS	402.1
REV. BY	DATE		
6/12/07 DATE OF B.O.C.C. APPROVAL			

MANATEE COUNTY, FLORIDA PUBLIC WORKS DEPARTMENT ENGINEERING SERVICES		MANATEE COUNTY FLORIDA 1022 26th Avenue East Bradenton, FL 34208	
TRANSIT BUS STOP UPGRADES MANATEE COUNTY, FLORIDA DETAILS			
NO.	REVISION DESCRIPTION	BY	DATE
PROJECT #		436-9008930	
SURVEY #		000	
SEC./TWN./RGE		00/00S/00E	
SCALE		NTS	
		BY	DATE
SURVEYED			00/00/00
DESIGNED		AAM	03/19/12
DRAWN		TMF	03/20/12
CHECKED			00/00/00
C. MOWBRAY P.E.			
FLORIDA P.E. # 46777			
Signature & Date			
SHEET 11			

2.2.1: Minimum Distance (curb and gutter condition)



Less than
8'

12' min
6' min
2' std

Image source: Gannett Fleming, Inc.

➤ The sign must be easily visible to the approaching bus driver. For curb and gutter sections, the FDOT Design Standards require a minimum 2 foot distance from the face of the curb to the bus stop sign (Figures 2.2.1-2). For typical rural shoulder sections, the minimum distance is 12 feet from the edge of the traveled way and 6 feet from edge of the shoulder (Figure 2.2.3). The minimum distance will vary according to the design speed of the road.

-

REVISION DESCRIPTION						BY	DATE
NO.							
PROJECT #					436-9008936		
SURVEY #					000		
SEC./TWN./RGE					08/35S/18E		
SCALE					AS NOTED		
		BY	DATE				
SURVEYED	-----		00/00/00				
DESIGNED	AAM		03/19/00				
DRAWN	DO'M/TF		03/20/00				
CHECKED	-----						

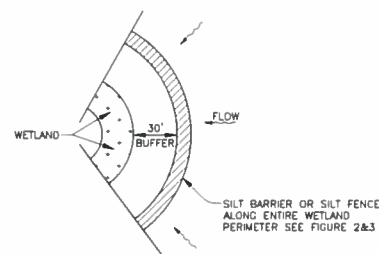

WETLAND BUFFER
FIGURE 1

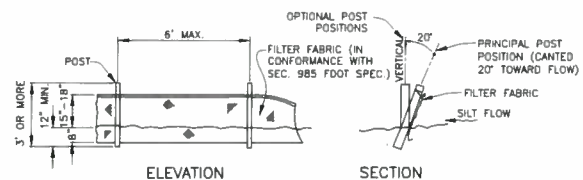

NOTE: SILT FENCE TO BE PAID FOR UNDER THE CONTRACT UNIT PRICE FOR STAKED SILT FENCE (LF)

TYPICAL SILT FENCE
FIGURE 2

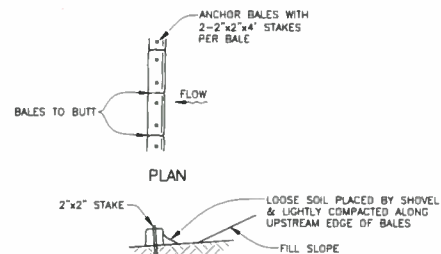

TYPICAL BALE SILT BARRIER
FIGURE 3

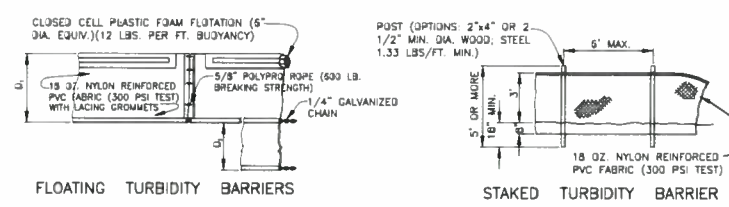

TURBIDITY BARRIERS
FIGURE 4

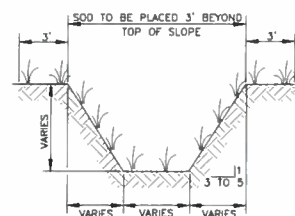
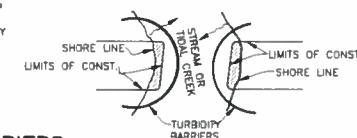

TYPICAL SWALE SECTION
FIGURE 5

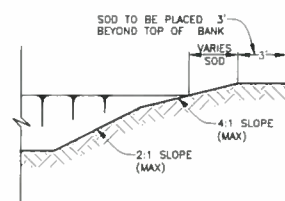

TYPICAL RETENTION/DETENTION POND SECTION
FIGURE 6

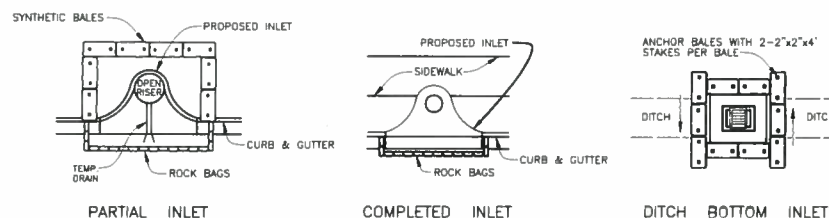

SYNTHETIC BALE PROTECTION AROUND
INLETS OR SIMILAR STRUCTURES
FIGURE 7

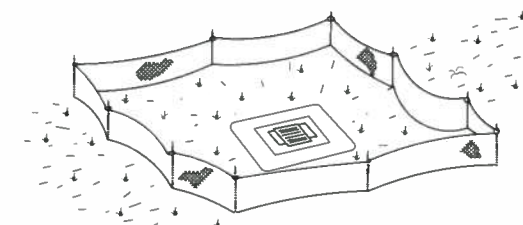

TYPE III SILT FENCE PROTECTION
AROUND DITCH BOTTOM INLETS

STAKED SILT BARRIER OR SILT FENCE
PROTECTION AROUND DITCH BOTTOM INLETS
FIGURE 8

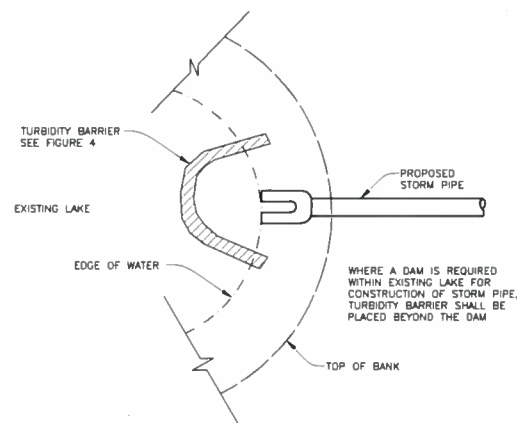

TURBIDITY BARRIER AT CONNECTION OF
STORM PIPE TO EXISTING LAKE
FIGURE 9

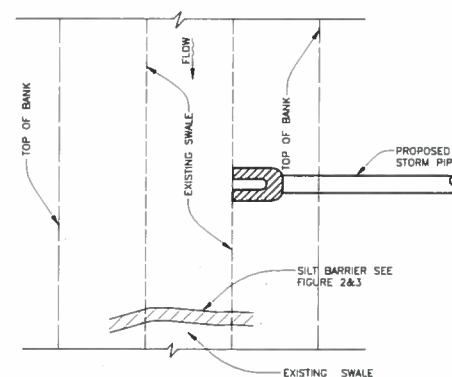

SILT BARRIER AT CONNECTION OF
STORM PIPE TO EXISTING SWALE
FIGURE 10

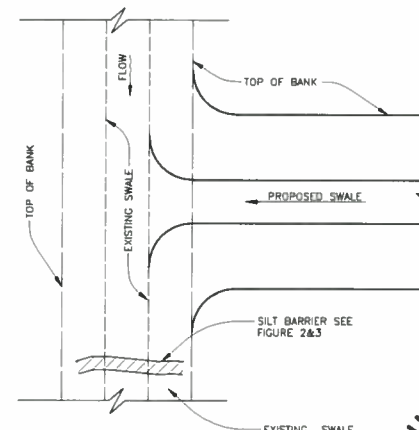

SILT BARRIER AT CONNECTION
OF SWALE TO EXISTING SWALE

FIGURE 11

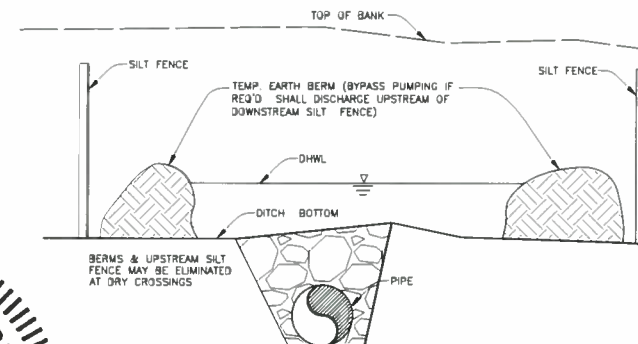

UNDERGROUND PIPE CROSSING
FIGURE 12

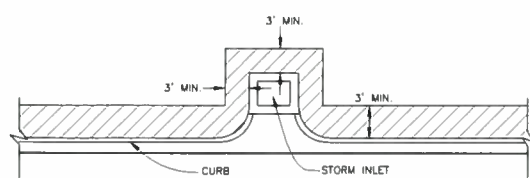

SOD ALONG CURB
AND AROUND INLET
FIGURE 14

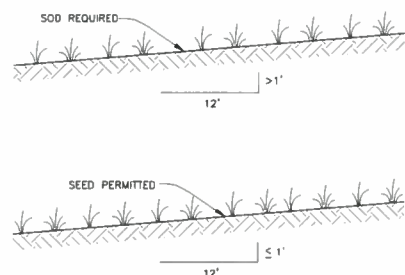

GRASS SLOPES
FIGURE 13

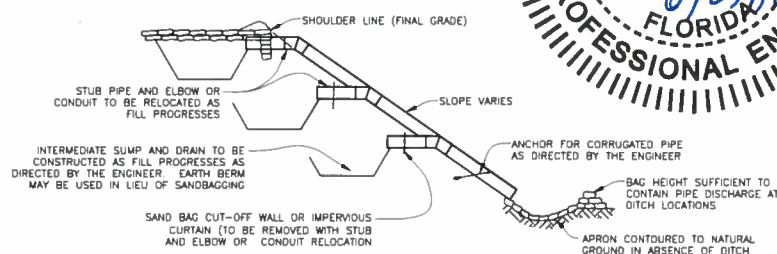

SECTION AA
TEMPORARY SLOPE DRAIN
 FIGURE 15

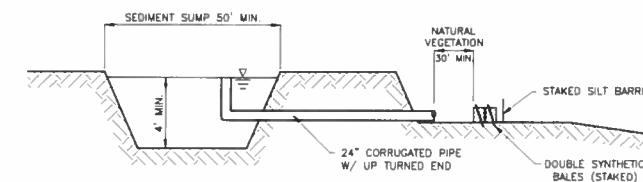

SEDIMENT SUMP SECTION
FIGURE 16

NOTE:
REFERENCE THE FDOT DESIGN STANDARDS
LATEST EDITION FOR ALL TEMPORARY
EROSION CONTROL MEASURES.

**TRANSIT BUS STOP UPGRADES
MANATEE COUNTY, FLORIDA
EROSION CONTROL**

NO.	REVISION DESCRIPTION	BY	DATE
PROJECT #	436-9008930		
SURVEY #	000		
SEC./TWN./RGE	00/00S/00E		
SCALE	NTS		
	BY	DATE	
SURVEYED	-----	00/00/00	
DESIGNED	AAM	03/19/17	
DRAWN	DO'M	03/19/17	
CHECKED	-----	00/00/00	
C. MOWBRAY P.E.			
FLORIDA P.E. # 46777			
Signature & Date			
SHEET 15			

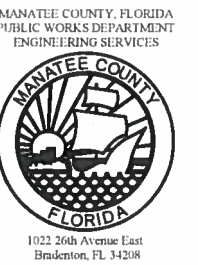
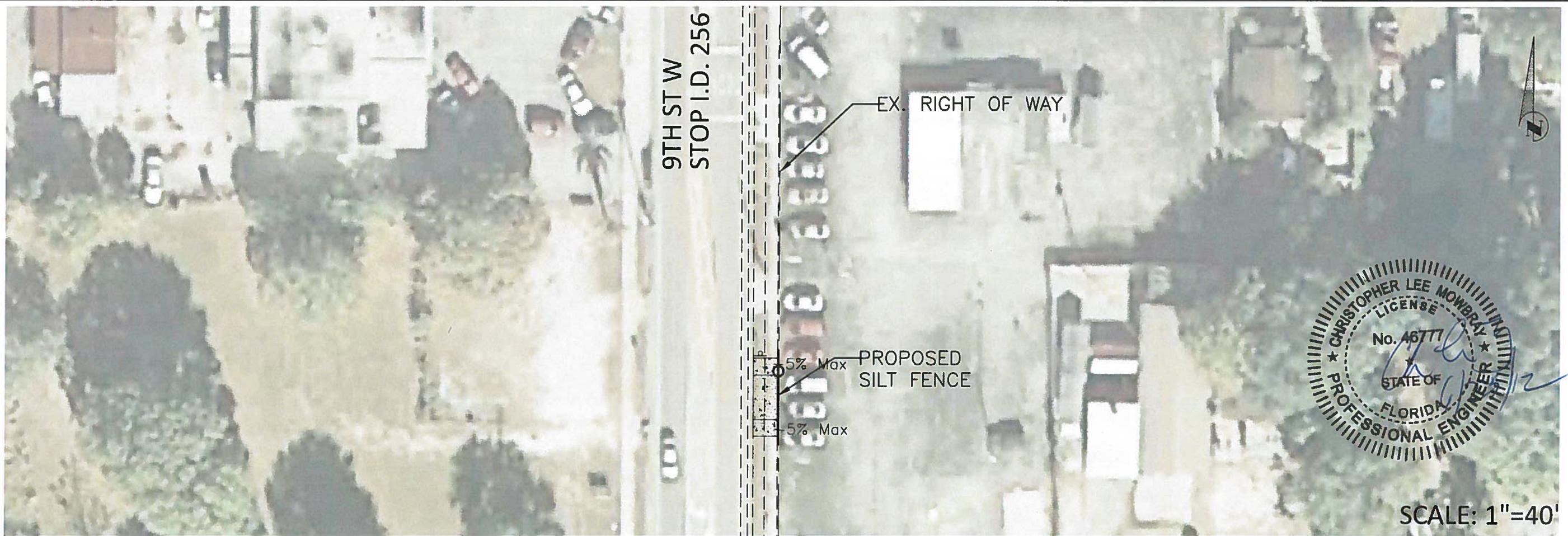
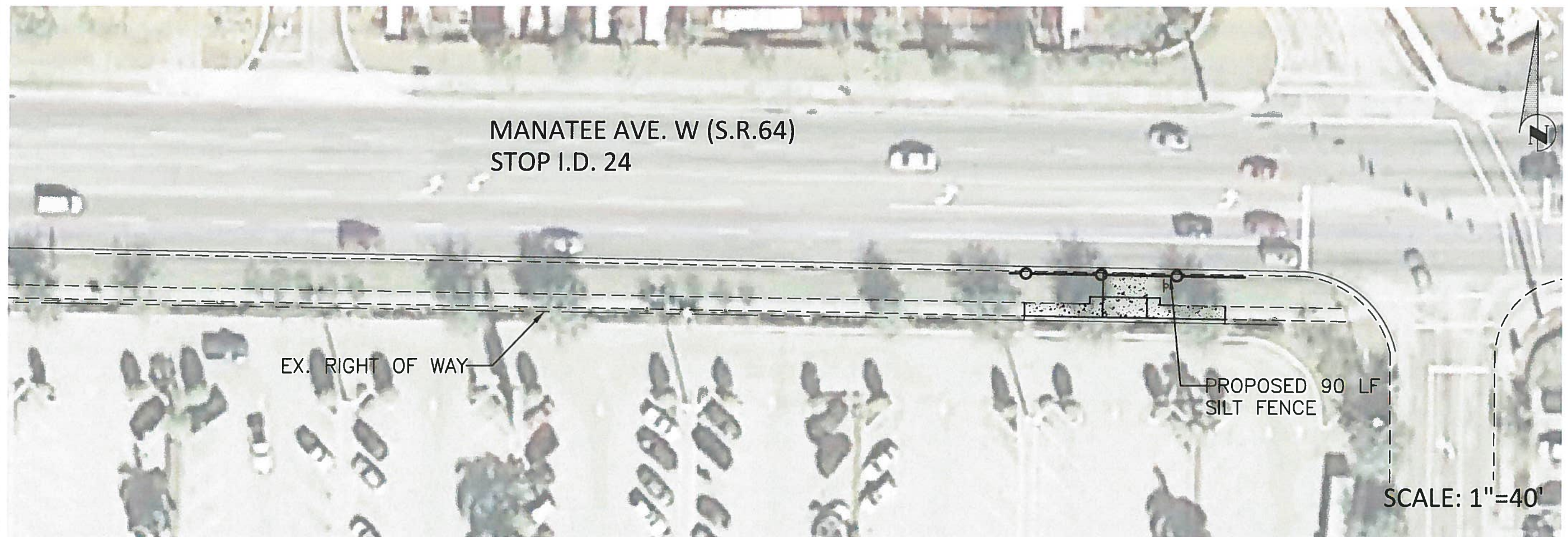

**TRANSIT BUS STOP UPGRADES
MANATEE COUNTY, FLORIDA
SILT FENCING FOR
STOP I.D.'S 24 AND 256**

No.	REVISION DESCRIPTION	BY	DATE
PROJECT #	436-9008930		
SURVEY #	000		
SEC./TWN./RGE	28/34S/17E		
SCALE	1"=40'		
SURVEYED	-----	00/00/00	
DESIGNED	AAM	03/19/12	
DRAWN	DO'M/TF	03/20/12	
CHECKED	-----		
C. MOWBRAY P.E.			
FLORIDA P.E. # 46777			
Signature & Date			
SHEET 16			

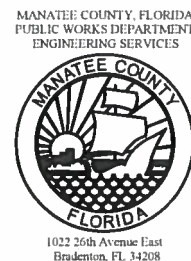
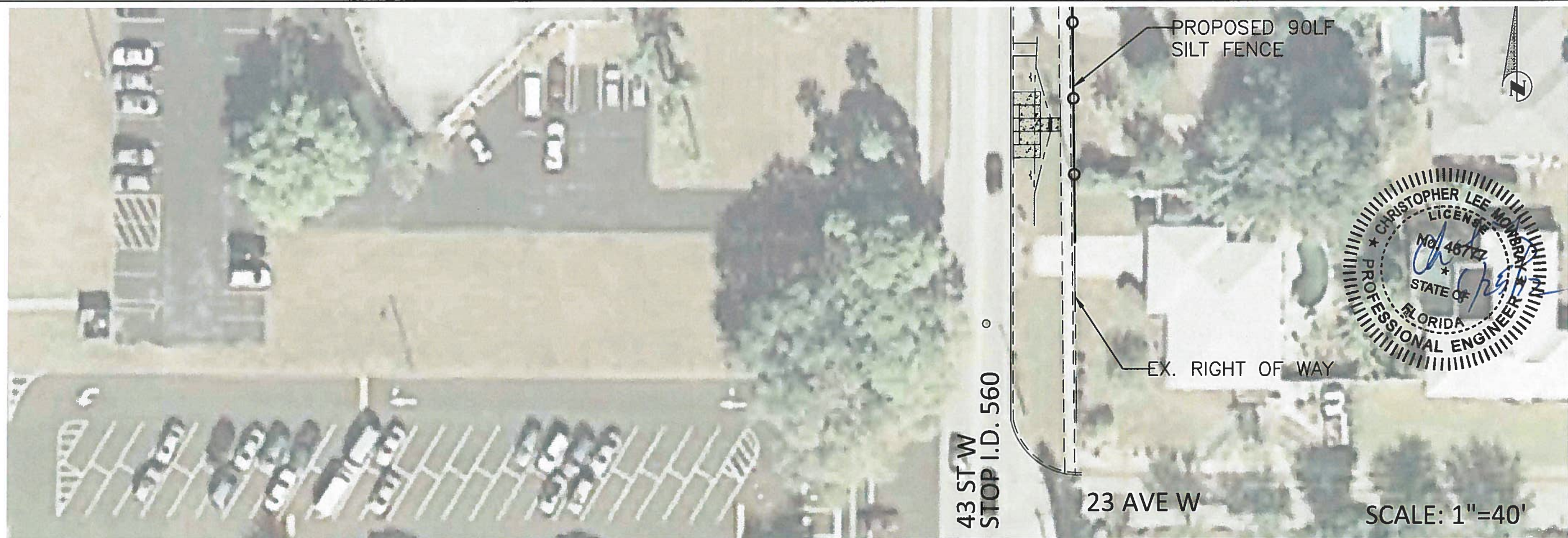
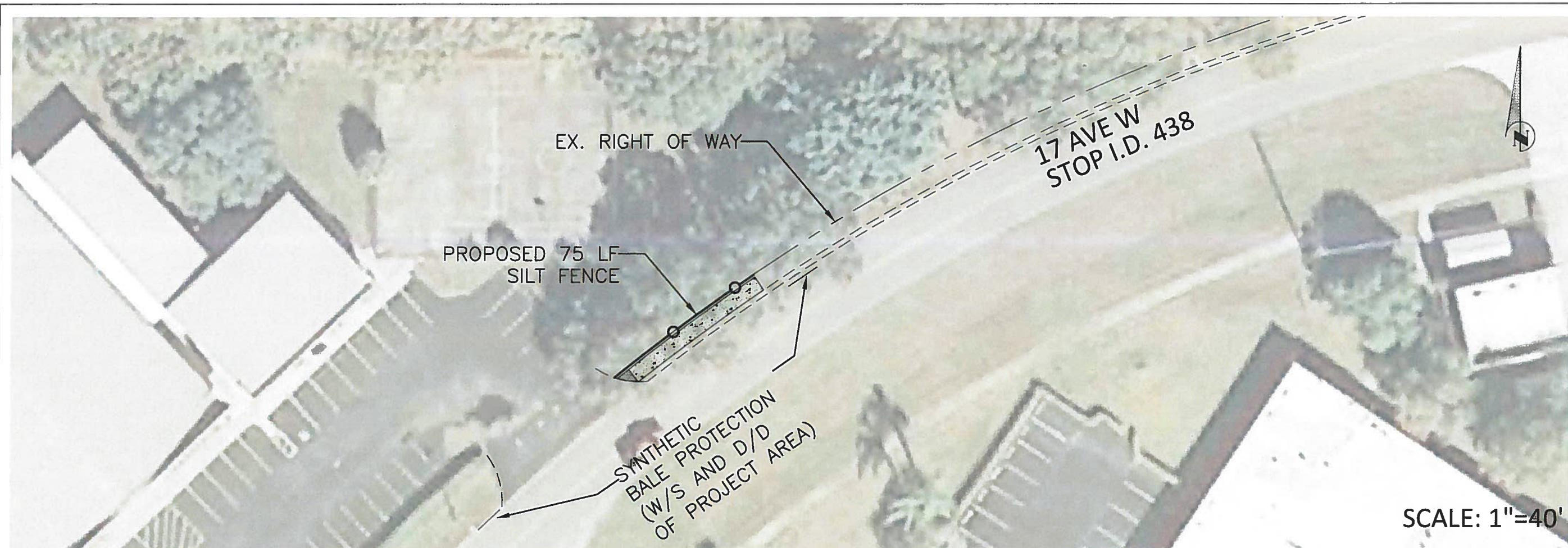

**TRANSIT BUS STOP UPGRADES
MANATEE COUNTY, FLORIDA
SILT FENCING FOR
STOP I.D.'S 438 AND 560**

NO.	REVISION DESCRIPTION	BY	DATE						
PROJECT #		436-9008930							
SURVEY #		000							
SEC./TWN./RGE		28/34S/17E							
SCALE		1"=40'							
SURVEYED	-----	00/00/00							
DESIGNED	AAM	03/19/12							
DRAWN	DO'M/TF	03/20/12							
CHECKED	-----								

C. MOWBRAY P.E.
FLORIDA P.E. # 46777

Signature & Date _____

SHEET 17

