



1112 Manatee Ave. West
Bradenton, FL 34205
purchasing@mymanatee.org

Solicitation Addendum

Addendum No.:	2
Solicitation No.:	IFBC19-TA003100SAM
Project No.:	6091680
Solicitation Title:	SWWRF & SEWRF Belt Filter Press Rehabilitation
Addendum Date:	August 29, 2019
Procurement Contact:	Sherri Meier

IFBC No. 19-TA003100SAM IS AMENDED AS SET FORTH HEREIN. RESPONSES TO QUESTIONS POSED BY PROSPECTIVE BIDDERS ARE PROVIDED BELOW. THIS ADDENDUM IS HEREBY INCORPORATED IN AND MADE A PART OF IFBC No. 19-TA003100SAM.

ADD:

Detail G, Partial Drawing E-00-006 (Rev.1), Bid Set Drawings.

The attached Detail G, Partial Drawing E-00-006 (Rev. 1) Bid Set Drawings, are hereby incorporated into the IFBC No. 19-TA003100SAM.

QUESTIONS AND RESPONSES:

Q1. Reference Specification Section 02618 Pipeline Cleaning. This section requires contractor to provide Bypass Pumping and Pipe cleaning by Pigging. Please identify where pigging and bypassing pumping applies to the project.

R1. Drain piping and vents, as specified on M-00-061 Keynote 5, are required to be cleaned. No other specific pipe has been identified to be cleaned for the project; however, the spec was included if any pipe was found to be requiring cleaning or if due to the Contractors chosen means and method of Construction require pigging and bypass pumping.

Q2. On sheet E-00-612, XFMR T-7 and XFMR T-8 show pad mounted. Note 9 say wall mount. Please advise. If pad mounted is what is required, is the GC to install the pad and if so, is there a detail?

R2. For Drawing e-00-612, key note 9 applies to xfmr-dw1 30 kva only. **ADD – key note 15: provide concrete pad for pad mounted transformer xfmr t-7 and xfmr t-8 per detail g, partial drawing e-00-006 (rev.1) attached. Replace – key note 9 with keynote 15 for xfmr t-7 and xfmr t-8.**

Q3. There are two Variable Speed Drive (VFD) specifications listed; Section 11069 (complete) and Section 16000;2.06,K with conflicting approved VFD manufacturers listed. Please confirm that Manatee County has standardized on Yaskawa Model iQ1000 by ICON Technologies for this project.

R3. Yaskawa Model iQ1000 by ICON Technologies will be acceptable.

Q4. Specification 11069 states that form 11000-A shall be completed by the VFD manufacturer to confirm correct installation. Please confirm that it is a requirement for the supplier to contract with the local Yaskawa Authorized Warranty Provider, ICON Technologies for this inspection and certification.

R4. VFD manufacturer's authorized representative to inspect and certify proper VFD installation.

Q5. Specification section 16000;2.06,K,18&19 lists the specific Yaskawa part numbers. Please confirm that the correct part numbers are as follows and represents the minimum sizing to be used.

- i. Polymer Feed Pumps: Yaskawa by ICON Model iQ1000, pn, CIMR-PW4A0009FXX
- ii. Sludge Feed Pumps: Yaskawa by ICON Model iQ1000, pn, CIMR-PW4A0023FXX
- iii. Belt Filter Press: Yaskawa by ICON Model iQ1000, pn, CIMR-PW4A0023FXX
- iv. All VFDs are to be provided with Yaskawa-ICON pn. SI-EN3 communications cards
- v. All VFDs are to be provided with Yaskawa-ICON output dv/dt filters.

R5. i._Yaskawa by ICON Model iQ1000, pn, CIMR-PW4A0009FXX will be acceptable

ii. Yaskawa by ICON Model iQ1000, pn, CIMR-PW4A0009FXX will be acceptable

iii. Yaskawa by ICON Model iQ1000, pn, CIMR- PW4A0023FXX will be acceptable

iv. Yes - Yaskawa-ICON pn. SI-EN3 communications card

v. Yes - Yaskawa-ICON output dv/dt filters.

Q6. Will the sign-in sheets from the info conference and site visit be provided.

R6. Sign-in sheets are attached to Addendum 2.

NOTE: Items that are ~~struck through~~ are deleted. Items that are underlined have been added or changed. All other terms and conditions remain as stated in the IFBC.

End of Addendum

INSTRUCTIONS:

Receipt of this addendum must be acknowledged as instructed in the solicitation document. Failure to acknowledge receipt of this Addendum may result in the response being deemed non-responsive.

AUTHORIZED FOR RELEASE: Chris Daley

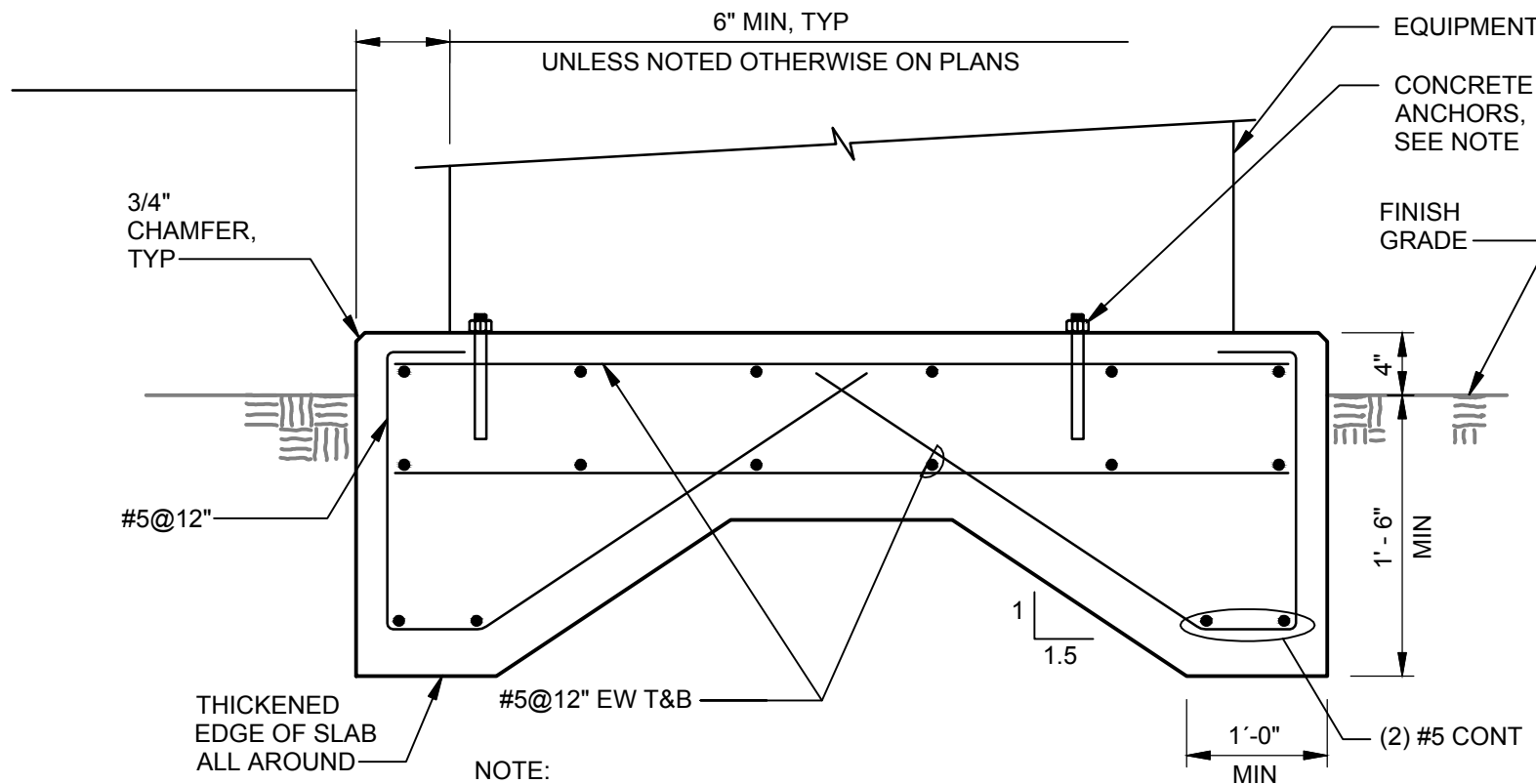

NOTE:

1. WHEN ANCHORAGE OF EQUIPMENT TO PAD IS REQUIRED, THE SIZE, NUMBER, TYPE, LOCATION AND THREAD PROJECTION OF THE ANCHOR BOLTS SHALL BE DETERMINED BY THE EQUIPMENT MANUFACTURER AND AS APPROVED BY THE PROJECT REPRESENTATIVE. ANCHOR BOLTS SHALL BE HELD IN POSITION WITH A TEMPLATE OR OTHER ACCEPTABLE MEANS, MATCHING THE BASE PLATE WHILE PAD IS BEING PLACED.

PAD MOUNTED TRANSFORMER

DETAIL TYP



SCALE: NOT TO SCALE
JOB NUMBER: 152270
DATE: August 28, 2019

ELECTRICAL
INSTALLATION DETAIL SHEET 3
(PARTIAL DRAWING)

E-00-006
REV 1

Procurement Division

Mandatory Site Visit

IFBC No. 19-TA003100SAM

SWWRF & SEWRF Belt Fitter Press Rehabilitation

August 15, 2019 @ 9:30 a.m.

SWWRF 5101 65th St. W., Administration Bldg, Bradenton, FL 34210

[illegible]

SEWRF 3331 Lena Road, Bradenton, FL 34211

[illegible]

SWWRF 5101 65th Street West, Bradenton, FL 34210

[illegible]