

MANATEE COUNTY GOVERNMENT PUBLIC WORKS DEPARTMENT

ADA BOARDING PADS W/ SHELTER SLABS

TABLE OF CONTENTS:

COVER	
CONDITION 1	
A1-001	SITE PLAN
A1-002	EROSION CONTROL PLAN
A1-003	EROSION CONTROL DETAILS
A1-004	SECTIONS
CONDITION 2	
A2-001	SITE PLAN
A2-002	SECTIONS
CONDITION 3	
A3-001	SITE PLAN
A3-002	SECTIONS
CONDITION 4	
A4-001	SITE PLAN
A4-002	SECTIONS
CONDITION 5	
A5-001	SITE PLAN
A5-002	SECTIONS
CONDITION 6	
A6-001	SITE PLAN
A7-002	SECTIONS
CONDITION 7	
A7-001	SITE PLAN & SECTIONS
CONDITION 8	
A8-001	SITE PLAN
A8-002	SECTIONS
CONDITION 9	
A9-001	SITE PLAN
A9-002	SECTIONS
CONDITION 10	
A10-001	SITE PLAN
A10-002	SECTIONS
TYPICAL DETAILS	



BACON GROUP, INC.
ARCHITECTURE
2641 SUNSET POINT ROAD
CLEARWATER, FLORIDA 33759
P: 727.725.0111 - F: 727.725.0111
WWW.BGARCHITECTS.COM
AAC000295

COPYRIGHT 2013. ALL RIGHTS RESERVED - NO PART OF THESE DOCUMENTS MAY BE REPRODUCED OR DISTRIBUTED IN ANY FORM WITHOUT PERMISSION FROM BACON GROUP, INC. ALL INFORMATION IN THESE DOCUMENTS IS CONSIDERED CONFIDENTIAL AND THE PROPERTY OF BACON GROUP, INC.



RICHARD S. BACON, AIA
AR #0011946

COVER
ADA BOARDING PAD PROJECT
MANATEE COUNTY GOVERNMENT PUBLIC WORKS DEPARTMENT
1108 26th AVENUE EAST
BRADENTON, FLORIDA 34208

REVISIONS	
1	
2	
3	

DRAWN BY:
JRB

PRINTED DATE:
March 7, 2017

SHEET ID:
COVER

PROJECT ID:
BG13-07

CULVERT NOTES:

NEW CULVERT TO BE 30" DIAMETER R.C.P.,
ASTM C-76 CLASS III WALL B. R.C.P. LENGTH
TO BE APPROX. 36' INCLUDING MITERED ENDS.
PROVIDE MITERED END SECTIONS, SLOPE
PAYEMENT, PIPE GRATES, ETC. ALL IN
CONFORMANCE WITH FDOT STD. INDEX
DRAWING 273. SLOPE TO BE 4:1. SOLID
SOD ALL NEW SLOPES AND EXPOSED
DITCH BOTTOM. SLOPE BOTTOM OF NEW
CULVERT TO MATCH EXISTING DRAINAGE
DITCH SLOPE. - FIELD VERIFY

SLAB NOTES:

JOINTS @ 5'-0" O.C. 3/4" DEEP.
EXPANSION JOINTS AS SHOWN ON PLANS.
SIDEWALK TO HAVE 1:50 CROSS SLOPE
& TO HAVE BROOM FINISH.

NOTE:

GRADES FROM EXISTING SIDEWALK TO SIDEWALK
MUST BE FIELD VERIFIED.

LEGEND:

 EXTENTS OF NEW SLAB
(EXISTING CONDITIONS MAY VARY
AND SHALL BE FIELD VERIFIED.)

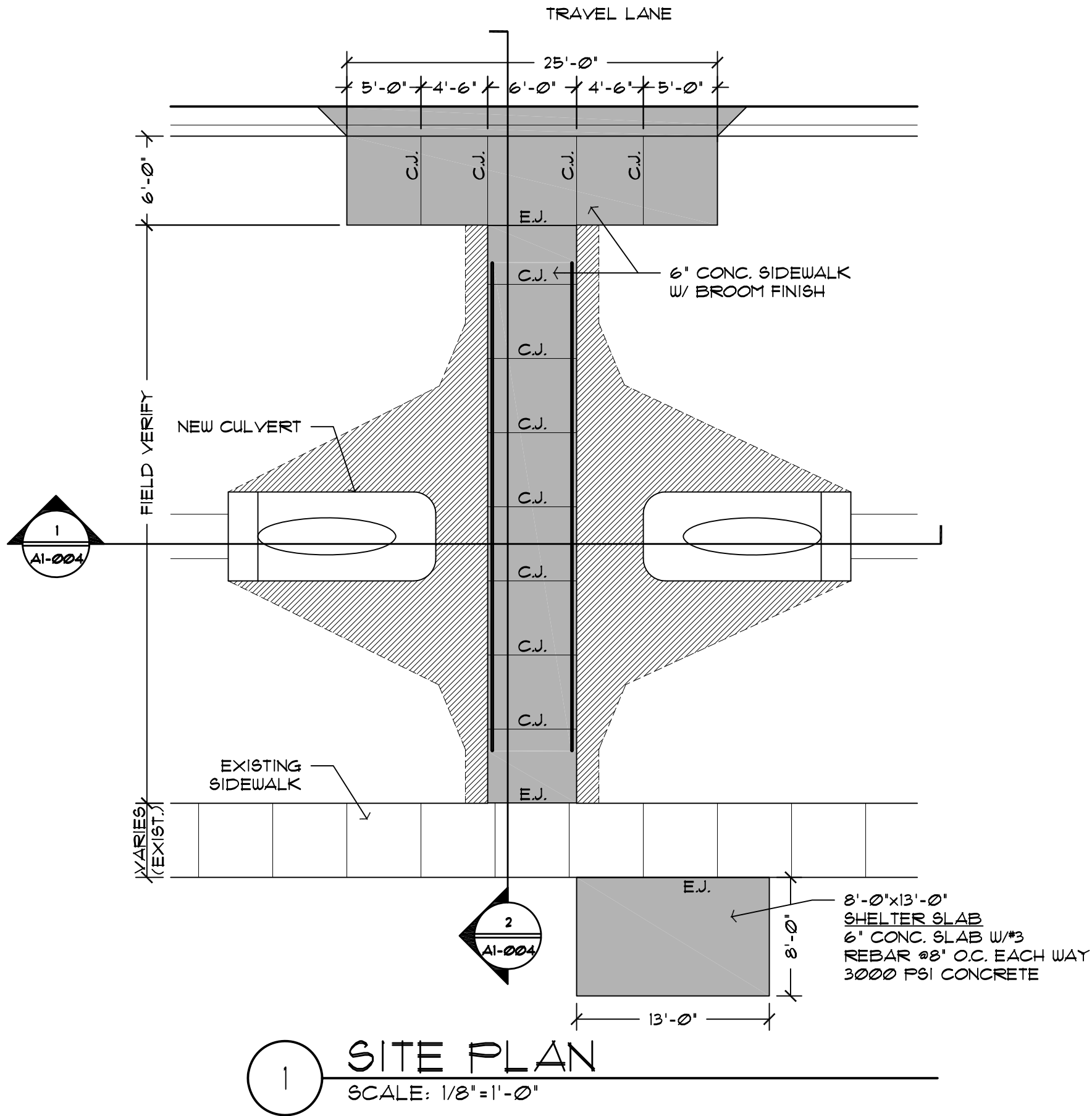

BACON GROUP, INC.
ARCHITECTURE

2641 SUNSET POINT ROAD
CLEARWATER, FLORIDA 33759
P: 727.725.0111 - F: 727.725.0111
WWW.BGARCHITECTS.COM
AAC000295

COPYRIGHT 2013. ALL RIGHTS RESERVED - NO
PART OF THESE DOCUMENTS MAY BE
REPRODUCED OR DISTRIBUTED IN ANY FORM
WITHOUT PERMISSION FROM BACON GROUP,
INC. ALL INFORMATION IN THESE DOCUMENTS
IS CONSIDERED CONFIDENTIAL AND THE
PROPERTY OF BACON GROUP, INC.



RICHARD S. BACON, AIA
AR #0011946

CONDITION 1 SITE PLAN

REVISIONS	
1	
2	
3	

DRAWN BY:
JRB

PRINTED DATE:
March 7, 2017

SHEET ID:
A1 - 001

PROJECT ID:
BG13-07

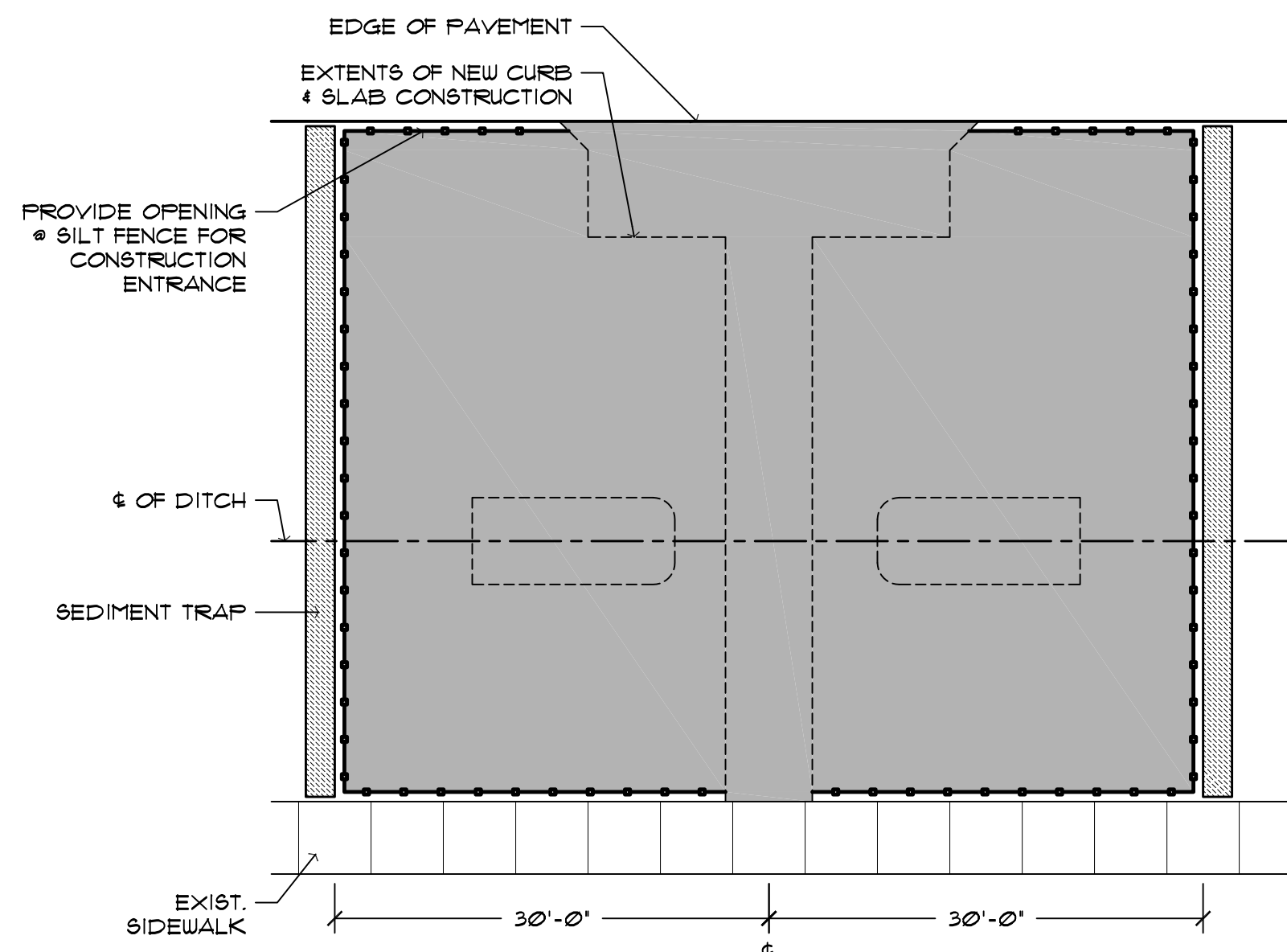

LEGEND

- SILT FENCE
- STANDARD STRAW BALES
- AREA TO BE IMPACTED BY CONSTRUCTION

1 EROSION CONTROL PLAN
SCALE: 3/32" = 1'-0"



RICHARD S. BACON, AIA
AR #0011946

CONDITION 1 EROSION CONTROL PLAN

ADA BOARDING PAD PROJECT
MANATEE COUNTY GOVERNMENT PUBLIC WORKS DEPARTMENT
1108 26th AVENUE EAST
BRADENTON, FLORIDA 34208

REVISIONS	
1	
2	
3	

DRAWN BY:
JRB

PRINTED DATE:
March 7, 2017

SHEET ID:
A1 - 002

PROJECT ID:
BG13-07

- NOTES:
- 1. GEOTEXTILE FABRIC SHALL BE PLACED IN EXCAVATED TRENCH, BACKFILLED, & COMPACTED TO EXIST. GRADE.
 - 2. WOODEN SUPPORT POSTS SHALL BE P.T. 1 1/8" X 1 1/8" X 4'-0". STEEL POSTS SHALL BE 5'-0" STUDDED 'TEE' OR 'U' TYPE. POSTS SHALL BE 8'-0" O.C. IF WOVEN FABRIC & 3'-0" FOR NON-WOVEN FABRIC.
 - 3. FABRIC FENCE SHALL BE ATTACHED DIRECTLY TO UP-SLOPE SIDE OF POSTS.
 - 4. FOR WD. POSTS, ATTACH FABRIC W/ 1/2" STAPLES @ TOP, MIDDLE & 2' AB. GRADE. FOR STEEL POSTS, ATTACH FABRIC W/ WIRE FASTENERS OR 50 LB PLASTIC TIE STRAPS.
 - 5. GEOTEXTILE FABRIC SHALL CONSIST OF WOVEN OR NON-WOVEN POLYESTER, POLYPROPYLENE, STABILIZED NYLON, POLYETHYLENE, OR POLYVINYLDENE CHLORIDE. NON-WOVEN FABRIC MAY BE NEEDLE PUNCHED, HEAT BOUNDED, RESIN BONDED, OR COMBINATIONS THEREOF.

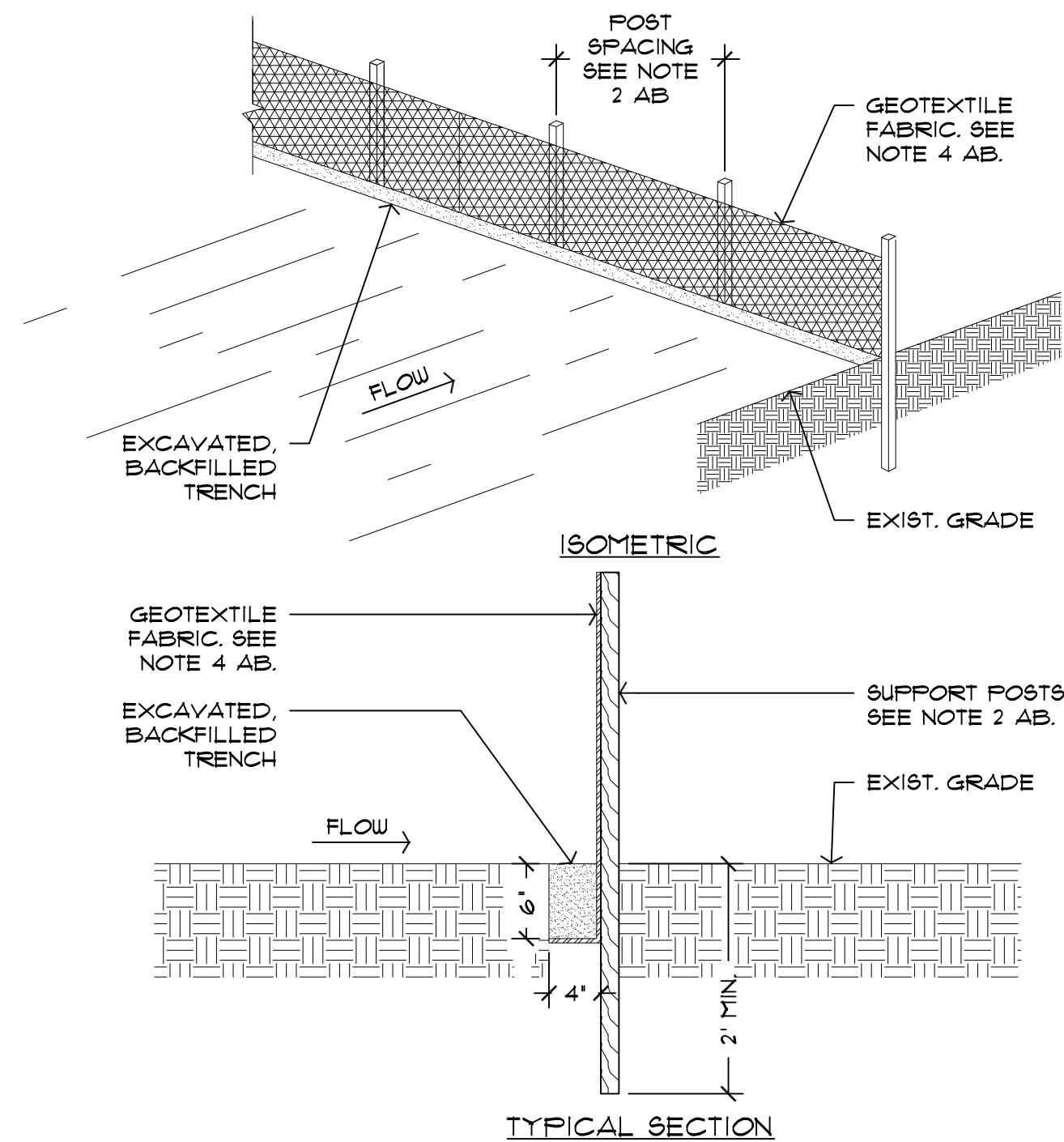

- NOTES:
- 1. TURN STRAW BALE ENDS UP 1'-0" MIN. UP-SLOPE AVERT.
 - 2. STRAW BALES SHALL BUTT TOGETHER AS CLOSE AS POSSIBLE
 - 3. AFTER INSTALLATION OF FIRST BALE, THE FIRST STAKE OF THE NEXT BALE SHALL BE DRIVEN TOWARDS THE PREVIOUS BALE (TYPICAL FOR REMAINDER OF BALES)

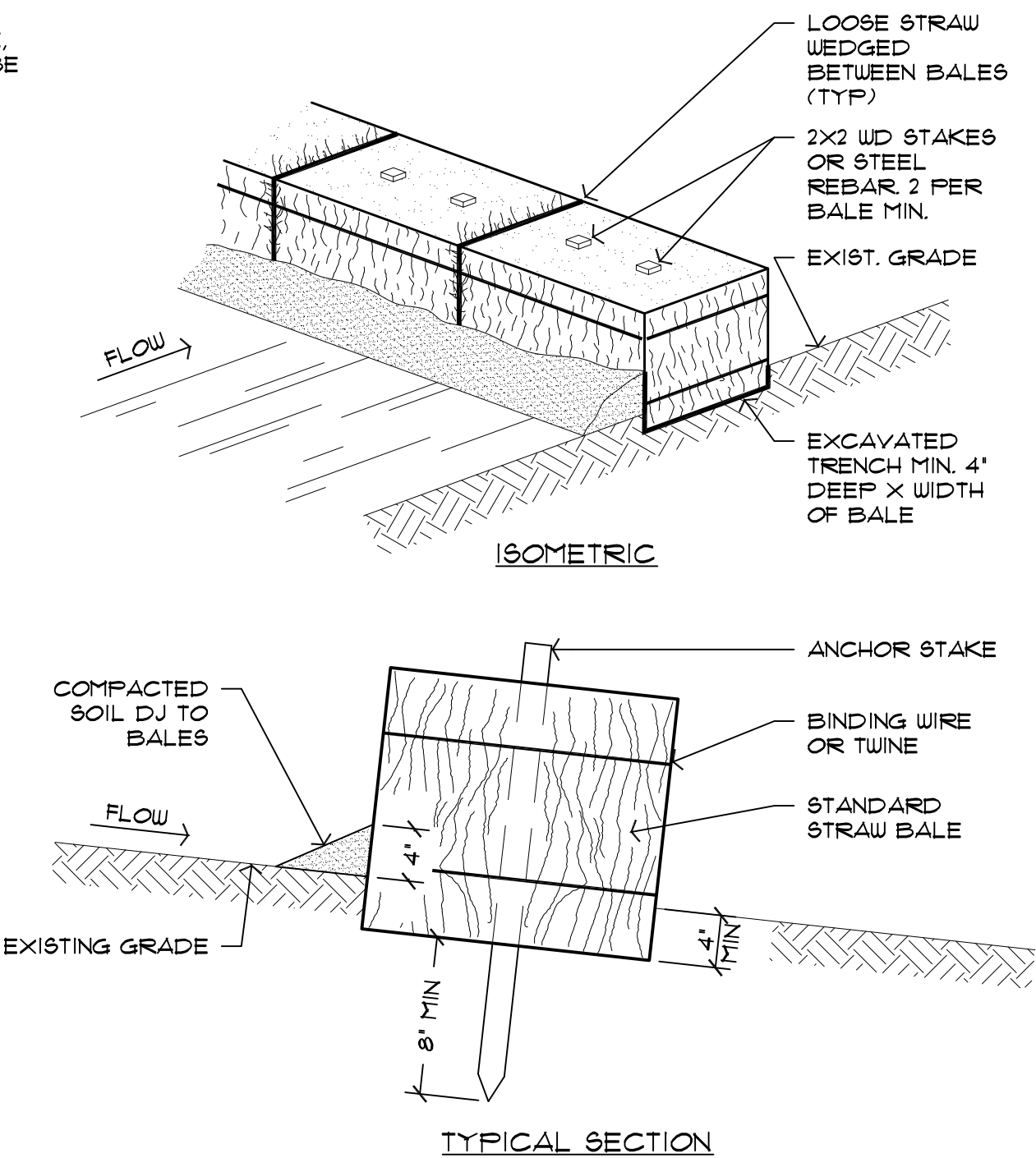

COPYRIGHT 2013. ALL RIGHTS RESERVED - NO PART OF THESE DOCUMENTS MAY BE REPRODUCED OR DISTRIBUTED IN ANY FORM WITHOUT PERMISSION FROM BACON GROUP, INC. ALL INFORMATION IN THESE DOCUMENTS IS CONSIDERED CONFIDENTIAL AND THE PROPERTY OF BACON GROUP, INC.



RICHARD S. BACON, AIA
AR #0011946

CONDITION 1 TYPICAL EROSION CONTROL
DETAILS
ADA BOARDING PAD PROJECT
MANATEE COUNTY GOVERNMENT PUBLIC WORKS DEPARTMENT
1108 26th AVENUE EAST
BRADENTON, FLORIDA 34208

REVISIONS	
1	
2	
3	

DRAWN BY:
JRB

PRINTED DATE:
March 7, 2017

SHEET ID:
A1 - 003

PROJECT ID:
BG13-07



BACON GROUP, INC.
ARCHITECTURE

2641 SUNSET POINT ROAD
CLEARWATER, FLORIDA 33759
P: 727.725.0111 - F: 727.725.0111
WWW.BGARCHITECTS.COM
AAC000295

COPYRIGHT 2013. ALL RIGHTS RESERVED - NO
PART OF THESE DOCUMENTS MAY BE
REPRODUCED OR DISTRIBUTED IN ANY FORM
WITHOUT PERMISSION FROM BACON GROUP,
INC. ALL INFORMATION IN THESE DOCUMENTS
IS CONSIDERED CONFIDENTIAL AND THE
PROPERTY OF BACON GROUP, INC.



RICHARD S. BACON, AIA
AR #0011946

CONDITION 1 SECTION

ADA BOARDING PAD PROJECT
MANATEE COUNTY GOVERNMENT PUBLIC WORKS DEPARTMENT
1108 26th AVENUE EAST
BRADENTON, FLORIDA 34208

REVISIONS

1
2
3

DRAWN BY:

JRB

PRINTED DATE:

March 7, 2017

SHEET ID:

A1 - 004

PROJECT ID:

BG13-07

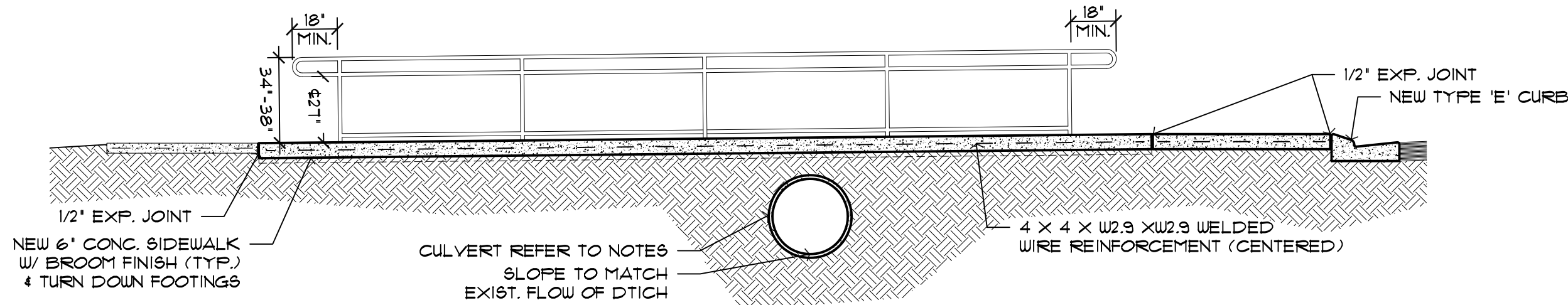

SECTION 2

SCALE: 1/4" = 1'-0"

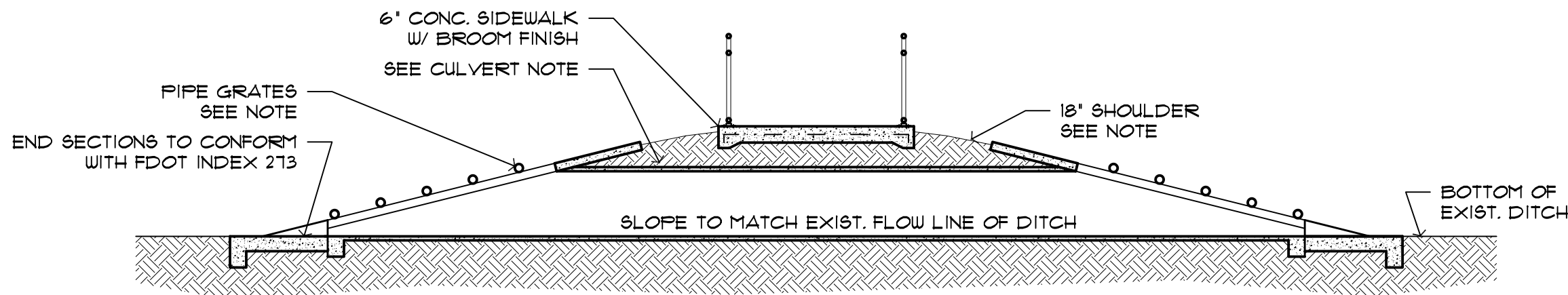

SECTION 1

SCALE: 1/4" = 1'-0"

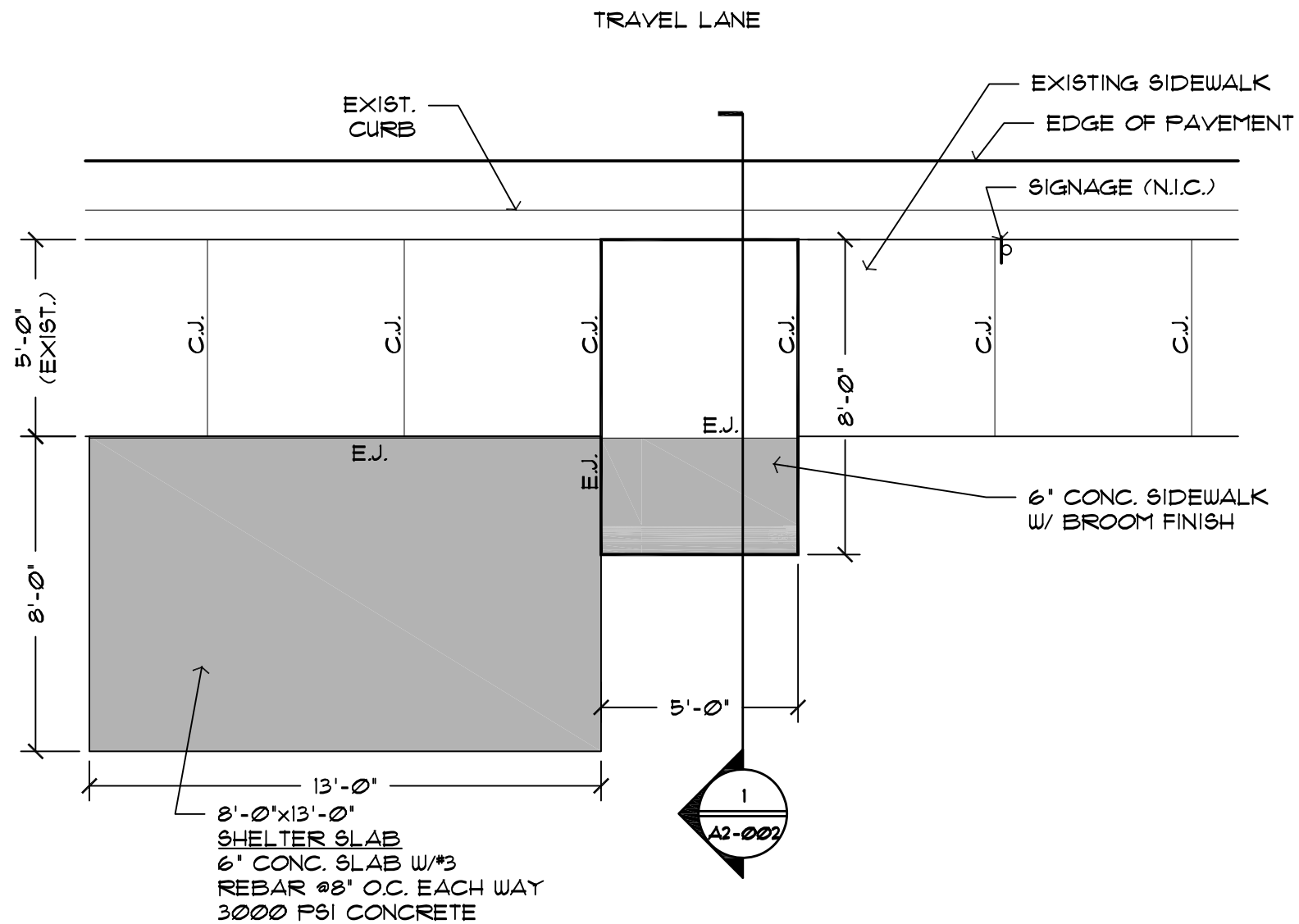

SLAB NOTES:
JOINTS @ 5'-0" O.C. 3/4" DEEP.
EXPANSION JOINTS AS SHOWN ON PLANS.
SIDEWALK TO HAVE 1:50 CROSS SLOPE
& TO HAVE BROOM FINISH.
LEGEND:

 EXTENTS OF NEW SLAB
(EXISTING CONDITIONS MAY VARY
AND SHALL BE FIELD VERIFIED.)

1 **SITE PLAN**
SCALE: 1/4" = 1'-0"



RICHARD S. BACON, AIA
AR #0011946

CONDITION 2 SITE PLAN

ADA BOARDING PAD PROJECT
MANATEE COUNTY GOVERNMENT PUBLIC WORKS DEPARTMENT
1108 26th AVENUE EAST
BRADENTON, FLORIDA 34208

REVISIONS	
1	
2	
3	

DRAWN BY:
JRB

PRINTED DATE:
March 7, 2017

SHEET ID:
A2 - 001

PROJECT ID:
BG13-07



BACON GROUP, INC.
ARCHITECTURE

2641 SUNSET POINT ROAD
CLEARWATER, FLORIDA 33759
P: 727.725.0111 - F: 727.725.0111
WWW.BGARCHITECTS.COM
AAC000095

COPYRIGHT 2013. ALL RIGHTS RESERVED - NO
PART OF THESE DOCUMENTS MAY BE
REPRODUCED OR DISTRIBUTED IN ANY FORM
WITHOUT PERMISSION FROM BACON GROUP,
INC. ALL INFORMATION IN THESE DOCUMENTS
IS CONSIDERED CONFIDENTIAL AND THE
PROPERTY OF BACON GROUP, INC.



RICHARD S. BACON, AIA
AR #0011946

CONDITION 2 SECTIONS

ADA BOARDING PAD PROJECT
MANATEE COUNTY GOVERNMENT PUBLIC WORKS DEPARTMENT
1108 26th AVENUE EAST
BRADENTON, FLORIDA 34208

REVISIONS

1
2
3

DRAWN BY:

JRB

PRINTED DATE:

March 7, 2017

SHEET ID:

A2 - 002

PROJECT ID:

BG13-07

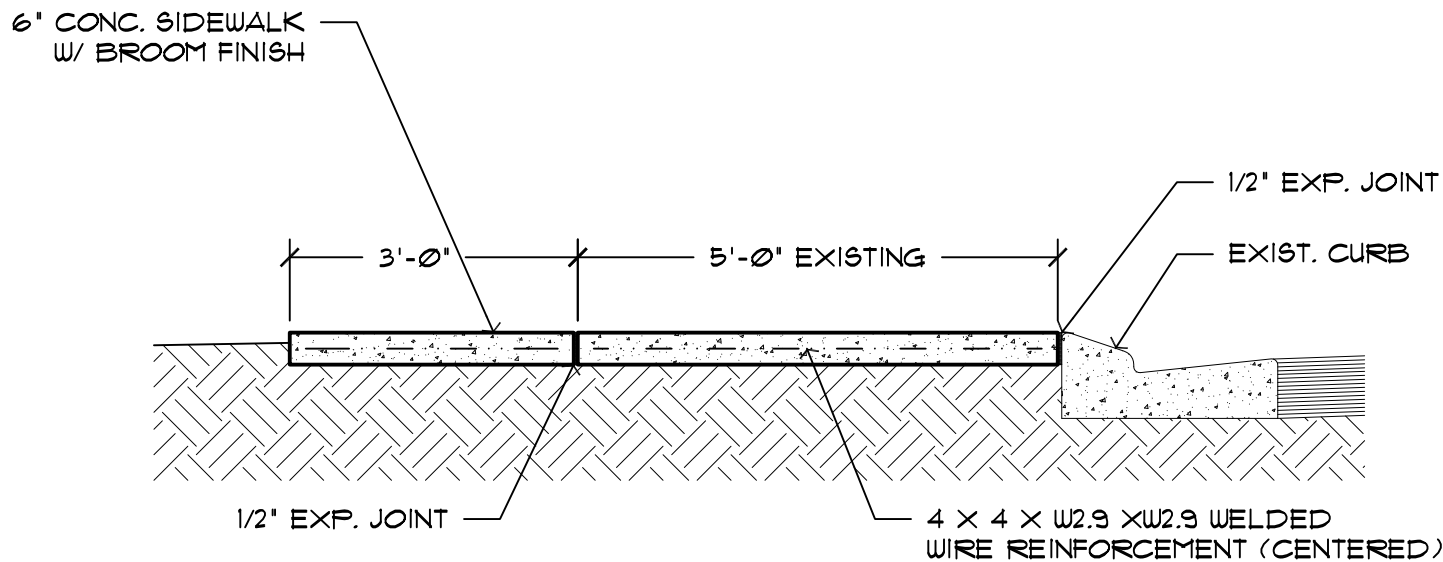

1

SECTION

SCALE: 1/2" = 1'-0"

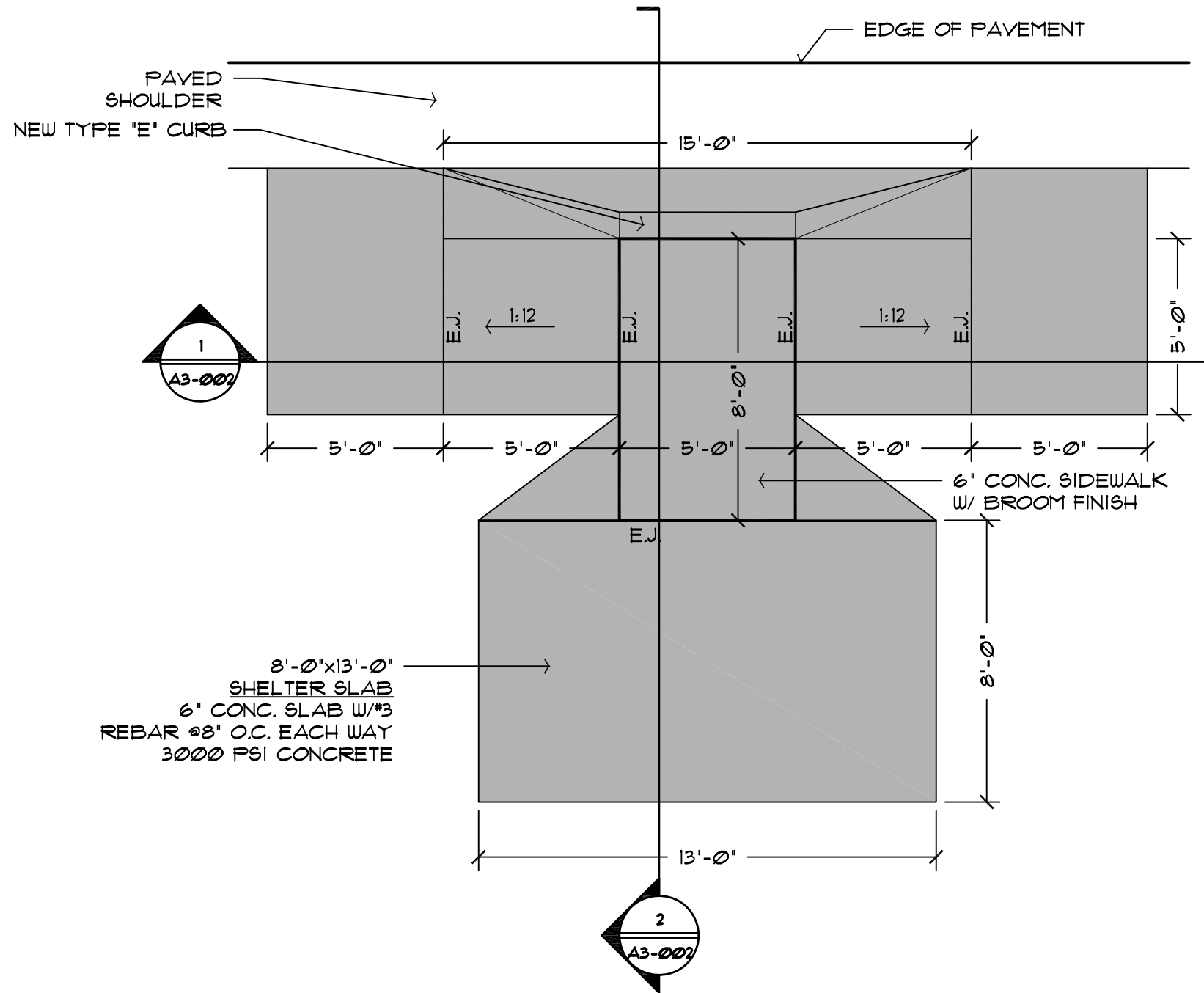

SLAB NOTES:
 JOINTS @ 5'-0" O.C. 3/4" DEEP.
 EXPANSION JOINTS AS SHOWN ON PLANS.
 SIDEWALK TO HAVE 1:50 CROSS SLOPE
 & TO HAVE BROOM FINISH.
LEGEND:

 EXTENTS OF NEW SLAB
 (EXISTING CONDITIONS MAY VARY
 AND SHALL BE FIELD VERIFIED.)

1 SITE PLAN
 SCALE: 1/4" = 1'-0"



BACON GROUP, INC.
 ARCHITECTURE

2641 SUNSET POINT ROAD
 CLEARWATER, FLORIDA 33759
 P: 727.725.0111 - F: 727.725.0111
 WWW.BGARCHITECTS.COM
 AAC000295

COPYRIGHT 2013. ALL RIGHTS RESERVED - NO
 PART OF THESE DOCUMENTS MAY BE
 REPRODUCED OR DISTRIBUTED IN ANY FORM
 WITHOUT PERMISSION FROM BACON GROUP,
 INC. ALL INFORMATION IN THESE DOCUMENTS
 IS CONSIDERED CONFIDENTIAL AND THE
 PROPERTY OF BACON GROUP, INC.



RICHARD S. BACON, AIA
 AR #0011946

CONDITION 3 SITE PLAN

ADA BOARDING PAD PROJECT
 MANATEE COUNTY GOVERNMENT PUBLIC WORKS DEPARTMENT
 1108 26th AVENUE EAST
 BRADENTON, FLORIDA 34208

REVISIONS

1	
2	
3	

DRAWN BY:
JRB

PRINTED DATE:
 March 7, 2017

SHEET ID:
A3 - 001

PROJECT ID:
 BG13-07

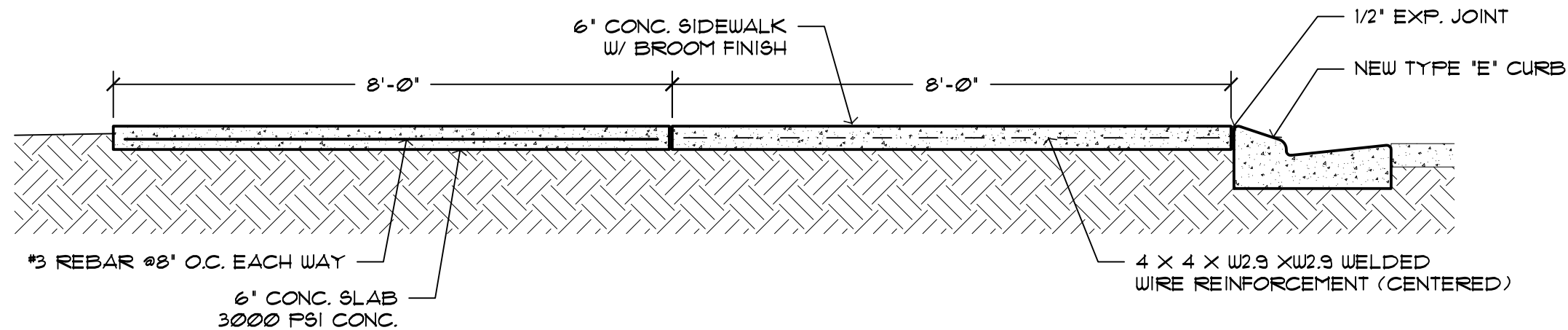

2 SECTION
SCALE: 1/2" = 1'-0"

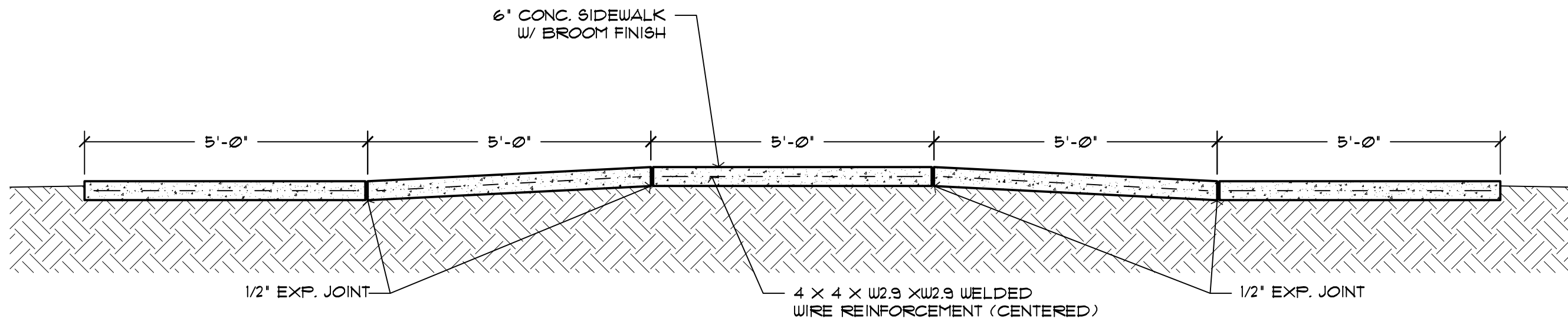

1 SECTION
SCALE: 1/2" = 1'-0"



BACON GROUP, INC.
ARCHITECTURE

2641 SUNSET POINT ROAD
CLEARWATER, FLORIDA 33759
P: 727.725.0111 - F: 727.725.0111
WWW.BGARCHITECTS.COM
AAC0002095

COPYRIGHT 2013. ALL RIGHTS RESERVED - NO
PART OF THESE DOCUMENTS MAY BE
REPRODUCED OR DISTRIBUTED IN ANY FORM
WITHOUT PERMISSION FROM BACON GROUP,
INC. ALL INFORMATION IN THESE DOCUMENTS
IS CONSIDERED CONFIDENTIAL AND THE
PROPERTY OF BACON GROUP, INC.



RICHARD S. BACON, AIA
AR #0011946

CONDITION 3 SECTIONS

ADA BOARDING PAD PROJECT
MANATEE COUNTY GOVERNMENT PUBLIC WORKS DEPARTMENT
1108 26th AVENUE EAST
BRADENTON, FLORIDA 34208

REVISIONS	
1	
2	
3	

DRAWN BY:
JRB

PRINTED DATE:
March 7, 2017

SHEET ID:
A3 - 002

PROJECT ID:
BG13-07

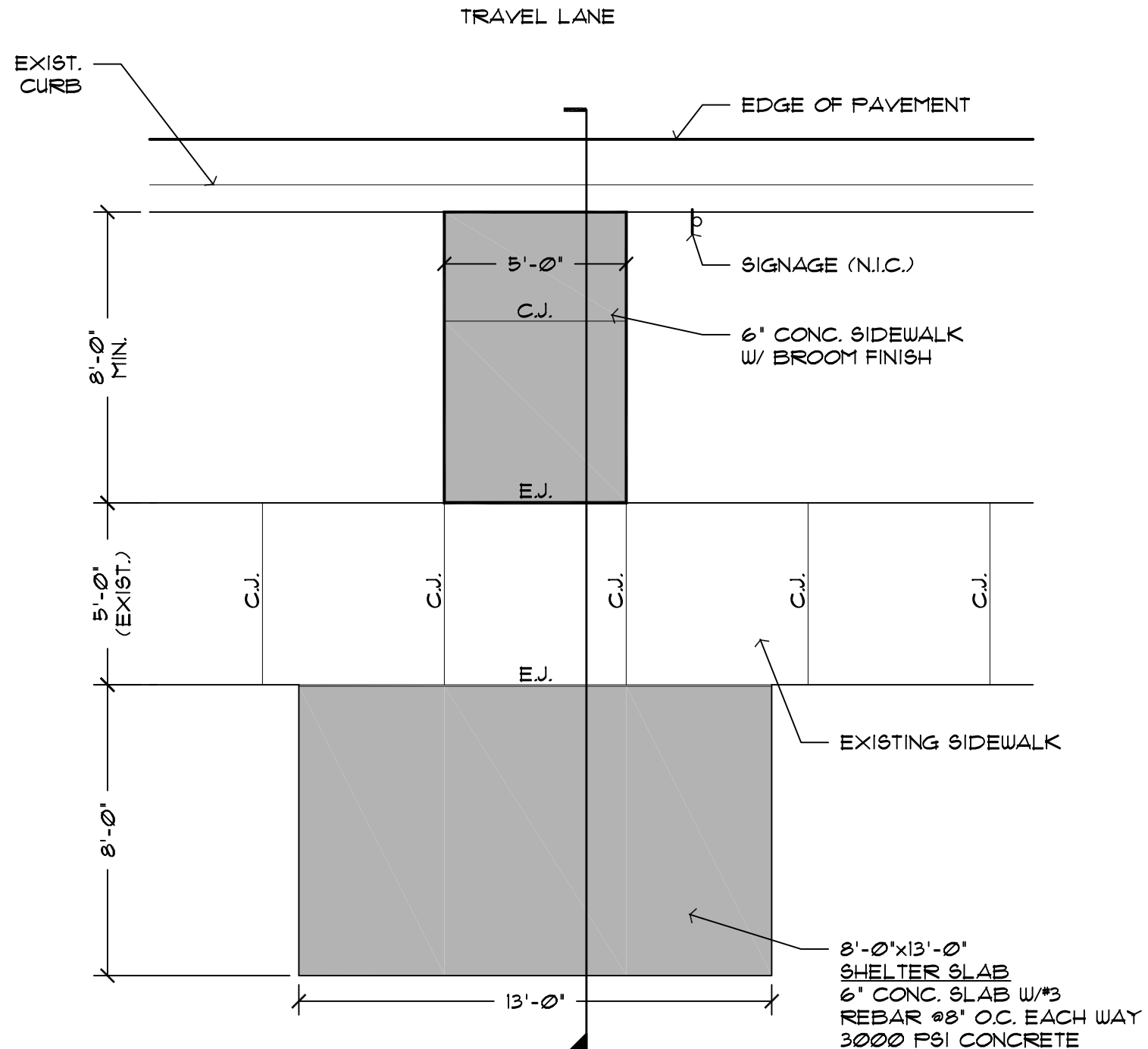

SLAB NOTES:
 JOINTS @ 5'-0" O.C. 3/4" DEEP.
 EXPANSION JOINTS AS SHOWN ON PLANS.
 SIDEWALK TO HAVE 1:50 CROSS SLOPE
 & TO HAVE BROOM FINISH.

LEGEND:

 EXTENTS OF NEW SLAB
 (EXISTING CONDITIONS MAY VARY
 AND SHALL BE FIELD VERIFIED.)

1 SITE PLAN
 SCALE: 1/4" = 1'-0"



BACON GROUP, INC.
 ARCHITECTURE
 2641 SUNSET POINT ROAD
 CLEARWATER, FLORIDA 33759
 P: 727.725.0111 - F: 727.725.0111
 WWW.BGARCHITECTS.COM
 AAC0002095

COPYRIGHT 2013. ALL RIGHTS RESERVED - NO
 PART OF THESE DOCUMENTS MAY BE
 REPRODUCED OR DISTRIBUTED IN ANY FORM
 WITHOUT PERMISSION FROM BACON GROUP,
 INC. ALL INFORMATION IN THESE DOCUMENTS
 IS CONSIDERED CONFIDENTIAL AND THE
 PROPERTY OF BACON GROUP, INC.



RICHARD S. BACON, AIA
 AR #0011946

CONDITION 4 SITE PLAN

ADA BOARDING PAD PROJECT
 MANATEE COUNTY GOVERNMENT PUBLIC WORKS DEPARTMENT
 1108 26th AVENUE EAST
 BRADENTON, FLORIDA 34208

REVISIONS

1	
2	
3	

DRAWN BY:
JRB

PRINTED DATE:
 March 7, 2017

SHEET ID:
A4 - 001

PROJECT ID:
 BG13-07

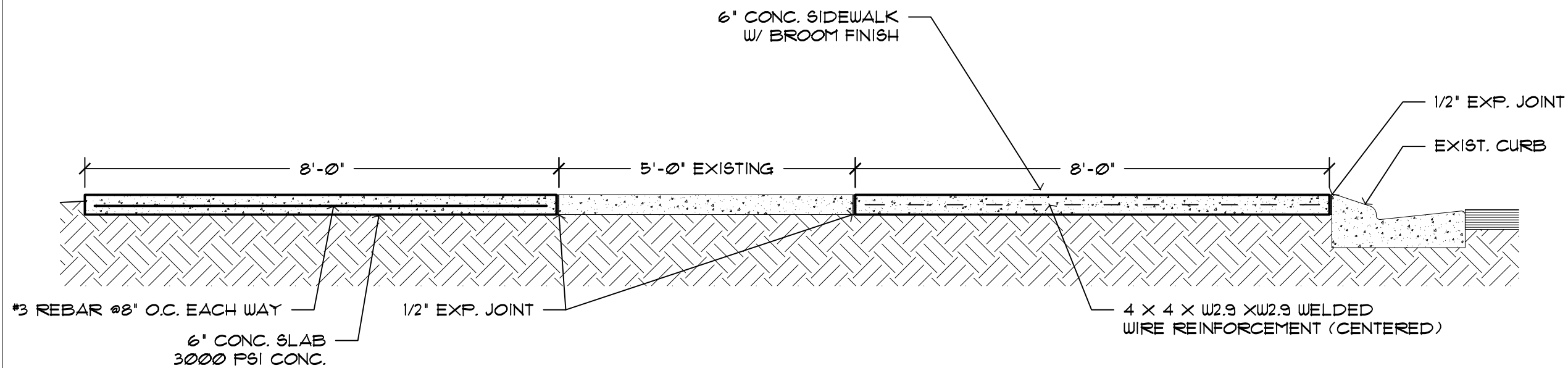

1 SECTION
SCALE: 1/2" = 1'-0"



BACON GROUP, INC.
ARCHITECTURE

2641 SUNSET POINT ROAD
CLEARWATER, FLORIDA 33759
P: 727.725.0111 - F: 727.725.0111
WWW.BGARCHITECTS.COM
AAC000295

COPYRIGHT 2013. ALL RIGHTS RESERVED - NO
PART OF THESE DOCUMENTS MAY BE
REPRODUCED OR DISTRIBUTED IN ANY FORM
WITHOUT PERMISSION FROM BACON GROUP,
INC. ALL INFORMATION IN THESE DOCUMENTS
IS CONSIDERED CONFIDENTIAL AND THE
PROPERTY OF BACON GROUP, INC.



RICHARD S. BACON, AIA
AR #0011946

CONDITION 4 SITE PLAN

ADA BOARDING PAD PROJECT
MANATEE COUNTY GOVERNMENT PUBLIC WORKS DEPARTMENT
1108 26th AVENUE EAST
BRADENTON, FLORIDA 34208

REVISIONS

1
2
3

DRAWN BY:

JRB

PRINTED DATE:

March 7, 2017

SHEET ID:

A4 - 002

PROJECT ID:

BG13-07

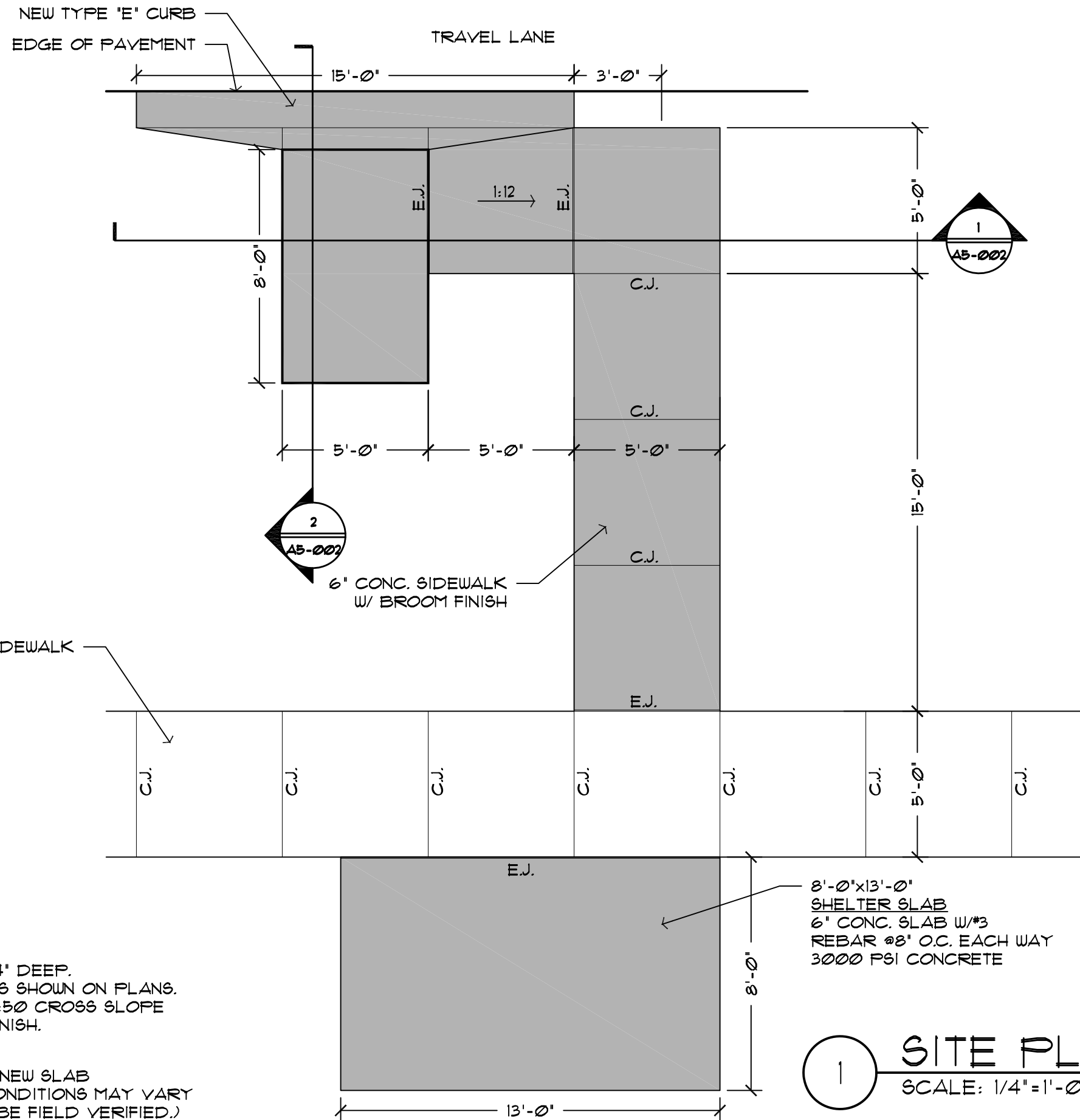

SLAB NOTES:
 JOINTS @ 5'-0" O.C. 3/4" DEEP.
 EXPANSION JOINTS AS SHOWN ON PLANS.
 SIDEWALK TO HAVE 1:50 CROSS SLOPE
 & TO HAVE BROOM FINISH.
LEGEND:
 [Shaded Box] EXTENTS OF NEW SLAB
 (EXISTING CONDITIONS MAY VARY
 AND SHALL BE FIELD VERIFIED.)

1 SITE PLAN
 SCALE: 1/4" = 1'-0"

BACON GROUP, INC.
 ARCHITECTURE
 2641 SUNSET POINT ROAD
 CLEARWATER, FLORIDA 33759
 P: 727.725.0111 - F: 727.725.0111
 WWW.BGARCHITECTS.COM
 AAC000295

COPYRIGHT 2013. ALL RIGHTS RESERVED - NO PART OF THESE DOCUMENTS MAY BE REPRODUCED OR DISTRIBUTED IN ANY FORM WITHOUT PERMISSION FROM BACON GROUP, INC. ALL INFORMATION IN THESE DOCUMENTS IS CONSIDERED CONFIDENTIAL AND THE PROPERTY OF BACON GROUP, INC.

RICHARD S. BACON, AIA
 AR #0011946

CONDITION 5 SITE PLAN

ADA BOARDING PAD PROJECT
 MANATEE COUNTY GOVERNMENT PUBLIC WORKS DEPARTMENT
 1108 26th AVENUE EAST
 BRADENTON, FLORIDA 34208

REVISIONS	
1	
2	
3	

DRAWN BY:
JRB

PRINTED DATE:
 March 7, 2017

SHEET ID:
A5 - 001

PROJECT ID:
 BG13-07

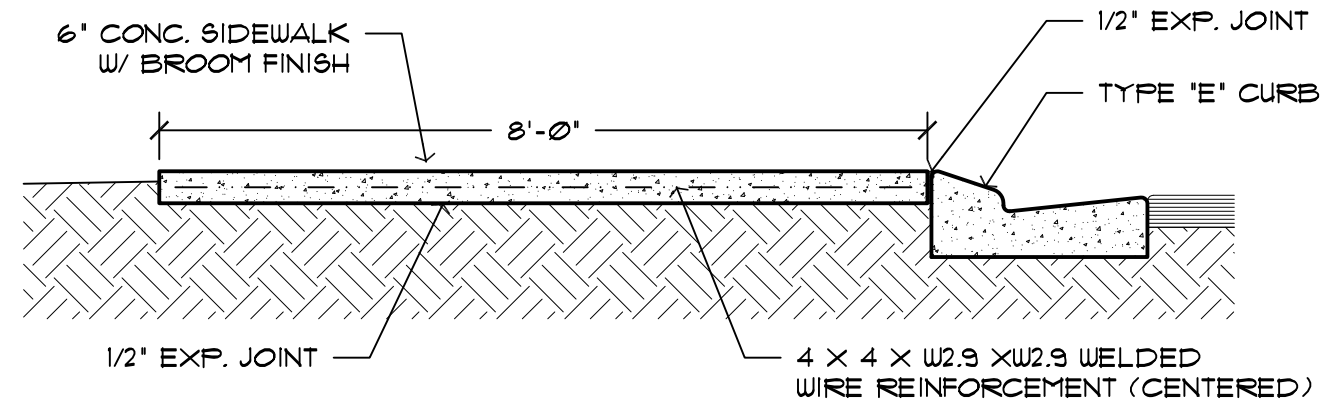

2 SECTION
SCALE: 1/2" = 1'-0"

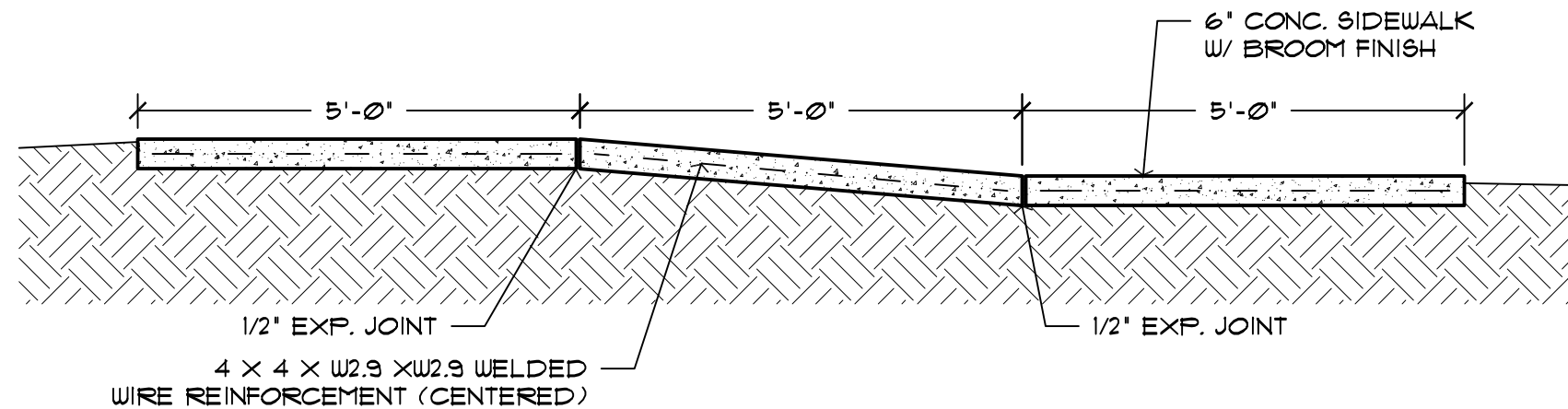

1 SECTION
SCALE: 1/2" = 1'-0"



BACON GROUP, INC.
ARCHITECTURE

2641 SUNSET POINT ROAD
CLEARWATER, FLORIDA 33759
P: 727.725.0111 - F: 727.725.0111
WWW.BGARCHITECTS.COM
AAC0002095

COPYRIGHT 2013. ALL RIGHTS RESERVED - NO
PART OF THESE DOCUMENTS MAY BE
REPRODUCED OR DISTRIBUTED IN ANY FORM
WITHOUT PERMISSION FROM BACON GROUP,
INC. ALL INFORMATION IN THESE DOCUMENTS
IS CONSIDERED CONFIDENTIAL AND THE
PROPERTY OF BACON GROUP, INC.



RICHARD S. BACON, AIA
AR #0011946

CONDITION 5 SECTIONS

ADA BOARDING PAD PROJECT
MANATEE COUNTY GOVERNMENT PUBLIC WORKS DEPARTMENT
1108 26th AVENUE EAST
BRADENTON, FLORIDA 34208

REVISIONS

1
2
3

DRAWN BY:

JRB

PRINTED DATE:

March 7, 2017

SHEET ID:

A5 - 002

PROJECT ID:

BG13-07

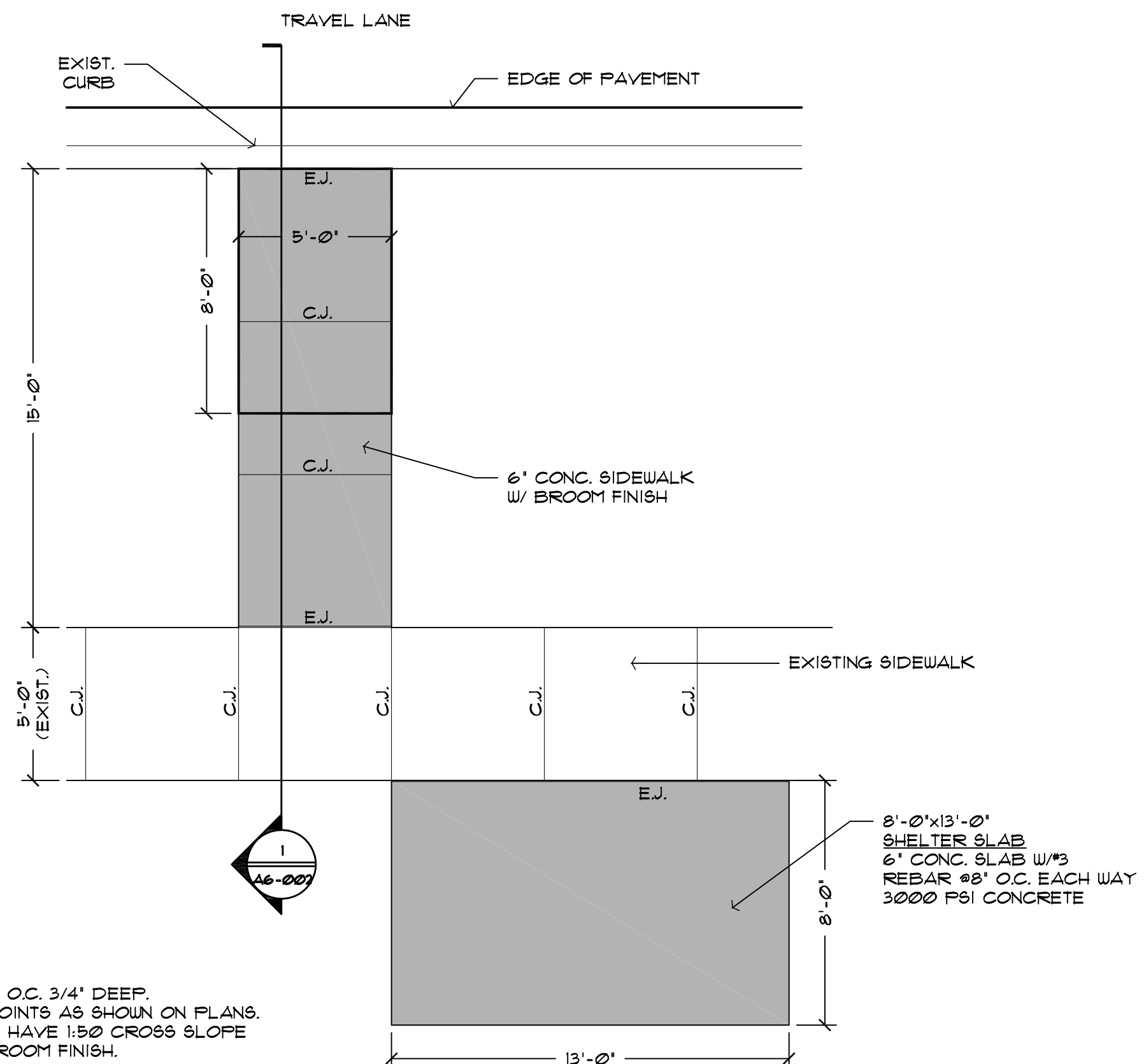

SLAB NOTES:
JOINTS @ 5'-0" O.C. 3/4" DEEP.
EXPANSION JOINTS AS SHOWN ON PLANS.
SIDEWALK TO HAVE 1:50 CROSS SLOPE
& TO HAVE BROOM FINISH.
LEGEND:

 EXTENTS OF NEW SLAB
(EXISTING CONDITIONS MAY VARY
AND SHALL BE FIELD VERIFIED.)

1 **SITE PLAN**
SCALE: 1/4" = 1'-0"



BACON GROUP, INC.
ARCHITECTURE

2641 SUNSET POINT ROAD
CLEARWATER, FLORIDA 33759
P: 727.725.0111 - F: 727.725.0111
WWW.BGARCHITECTS.COM
AAC0002095

COPYRIGHT 2013. ALL RIGHTS RESERVED - NO
PART OF THESE DOCUMENTS MAY BE
REPRODUCED OR DISTRIBUTED IN ANY FORM
WITHOUT PERMISSION FROM BACON GROUP,
INC. ALL INFORMATION IN THESE DOCUMENTS
IS CONSIDERED CONFIDENTIAL AND THE
PROPERTY OF BACON GROUP, INC.



RICHARD S. BACON, AIA
AR #0011946

CONDITION 6 SITE PLAN

ADA BOARDING PAD PROJECT
MANATEE COUNTY GOVERNMENT PUBLIC WORKS DEPARTMENT
1108 26th AVENUE EAST
BRADENTON, FLORIDA 34208

REVISIONS

1
2
3

DRAWN BY:

JRB

PRINTED DATE:

March 7, 2017

SHEET ID:

A6 - 001

PROJECT ID:

BG13-07

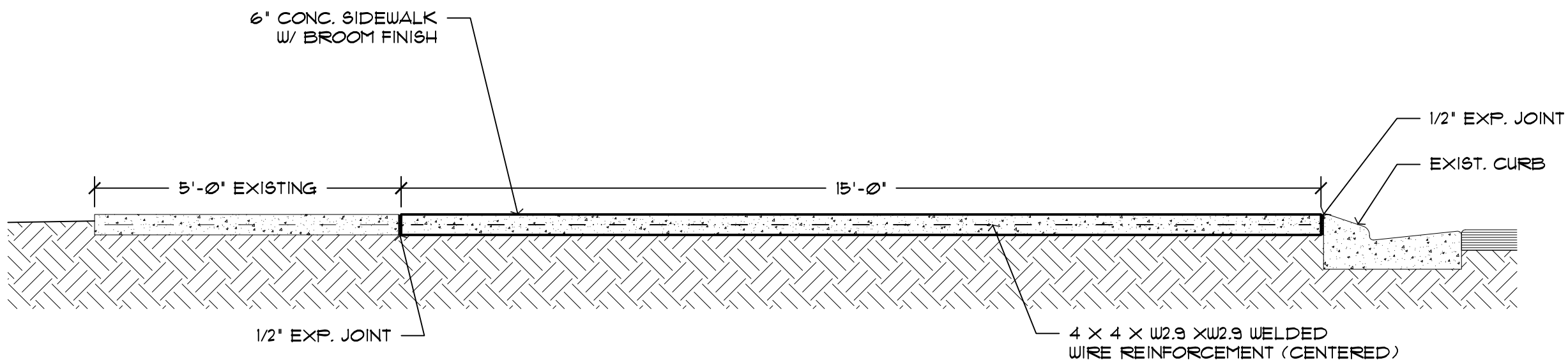

1 SECTION
SCALE: 1/2" = 1'-0"



BACON GROUP, INC.
ARCHITECTURE

2641 SUNSET POINT ROAD
CLEARWATER, FLORIDA 33759
P: 727.725.0111 - F: 727.725.0111
WWW.BGARCHITECTS.COM
AAC000095

COPYRIGHT 2013. ALL RIGHTS RESERVED - NO
PART OF THESE DOCUMENTS MAY BE
REPRODUCED OR DISTRIBUTED IN ANY FORM
WITHOUT PERMISSION FROM BACON GROUP,
INC. ALL INFORMATION IN THESE DOCUMENTS
IS CONSIDERED CONFIDENTIAL AND THE
PROPERTY OF BACON GROUP, INC.



RICHARD S. BACON, AIA
AR #0011946

CONDITION 6 SECTIONS

ADA BOARDING PAD PROJECT
MANATEE COUNTY GOVERNMENT PUBLIC WORKS DEPARTMENT
1108 26th AVENUE EAST
BRADENTON, FLORIDA 34208

REVISIONS

1
2
3

DRAWN BY:

JRB

PRINTED DATE:

March 7, 2017

SHEET ID:

A6 - 002

PROJECT ID:

BG13-07

6" CONC. SIDEWALK
W/ BROOM FINISH

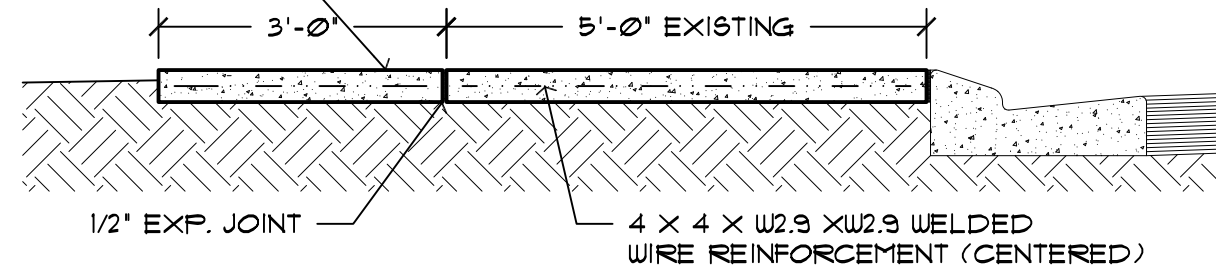

2 SECTION

SCALE: 1/2" = 1'-0"

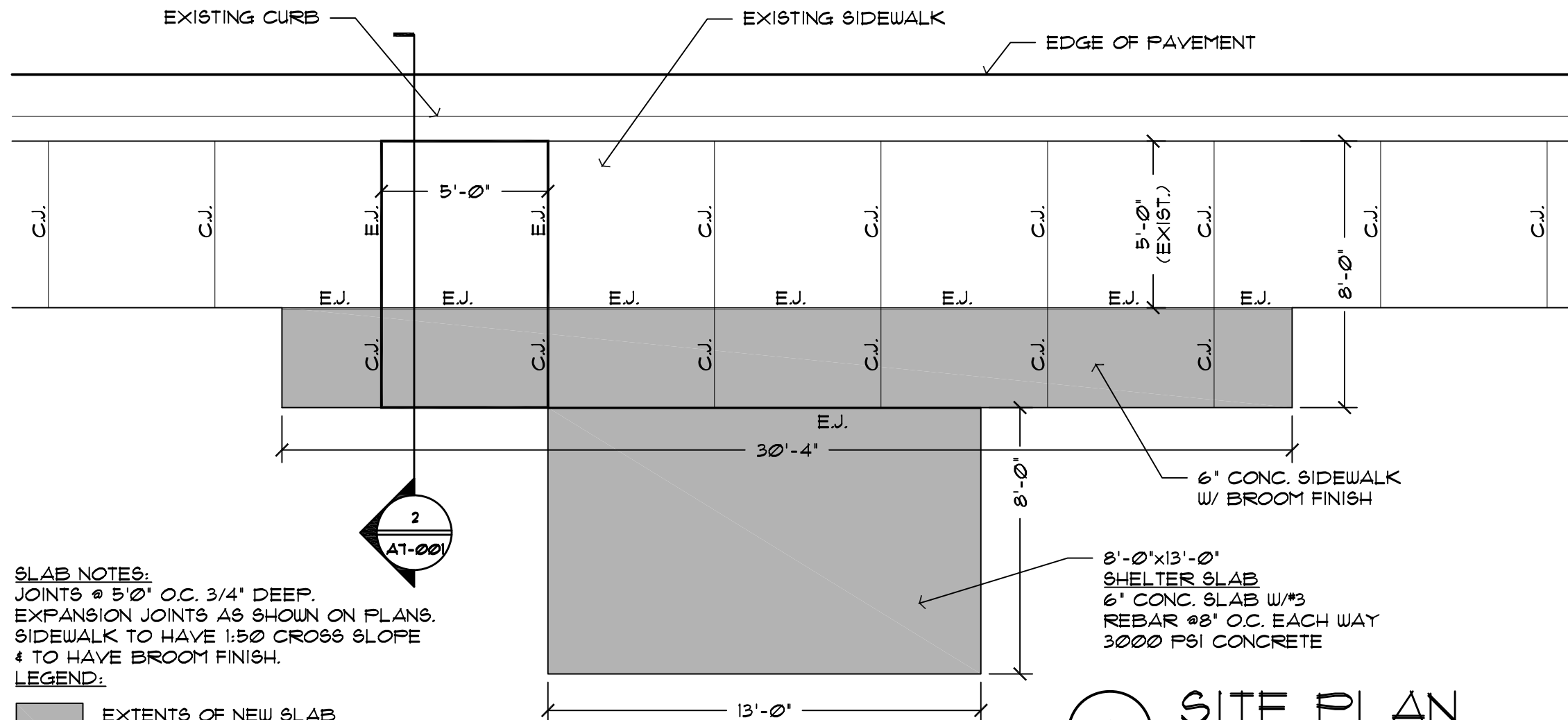

SLAB NOTES:
JOINTS @ 5'-0" O.C. 3/4" DEEP.
EXPANSION JOINTS AS SHOWN ON PLANS.
SIDEWALK TO HAVE 1:50 CROSS SLOPE
& TO HAVE BROOM FINISH.

LEGEND:

 EXTENTS OF NEW SLAB
(EXISTING CONDITIONS MAY VARY
AND SHALL BE FIELD VERIFIED.)

1 SITE PLAN

SCALE: 1/4" = 1'-0"



BACON GROUP, INC.
ARCHITECTURE

2641 SUNSET POINT ROAD
CLEARWATER, FLORIDA 33759
P: 727.725.0111 - F: 727.725.0111
WWW.BGARCHITECTS.COM
AAC000295

COPYRIGHT 2013. ALL RIGHTS RESERVED - NO
PART OF THESE DOCUMENTS MAY BE
REPRODUCED OR DISTRIBUTED IN ANY FORM
WITHOUT PERMISSION FROM BACON GROUP,
INC. ALL INFORMATION IN THESE DOCUMENTS
IS CONSIDERED CONFIDENTIAL AND THE
PROPERTY OF BACON GROUP, INC.



RICHARD S. BACON, AIA
AR #0011946

CONDITION 7 SITE PLAN & SECTION

ADA BOARDING PAD PROJECT
MANATEE COUNTY GOVERNMENT PUBLIC WORKS DEPARTMENT
1108 26th AVENUE EAST
BRADENTON, FLORIDA 34208

REVISIONS

1	
2	
3	

DRAWN BY:
JRB

PRINTED DATE:
March 7, 2017

SHEET ID:
A7 - 001

PROJECT ID:
BG13-07

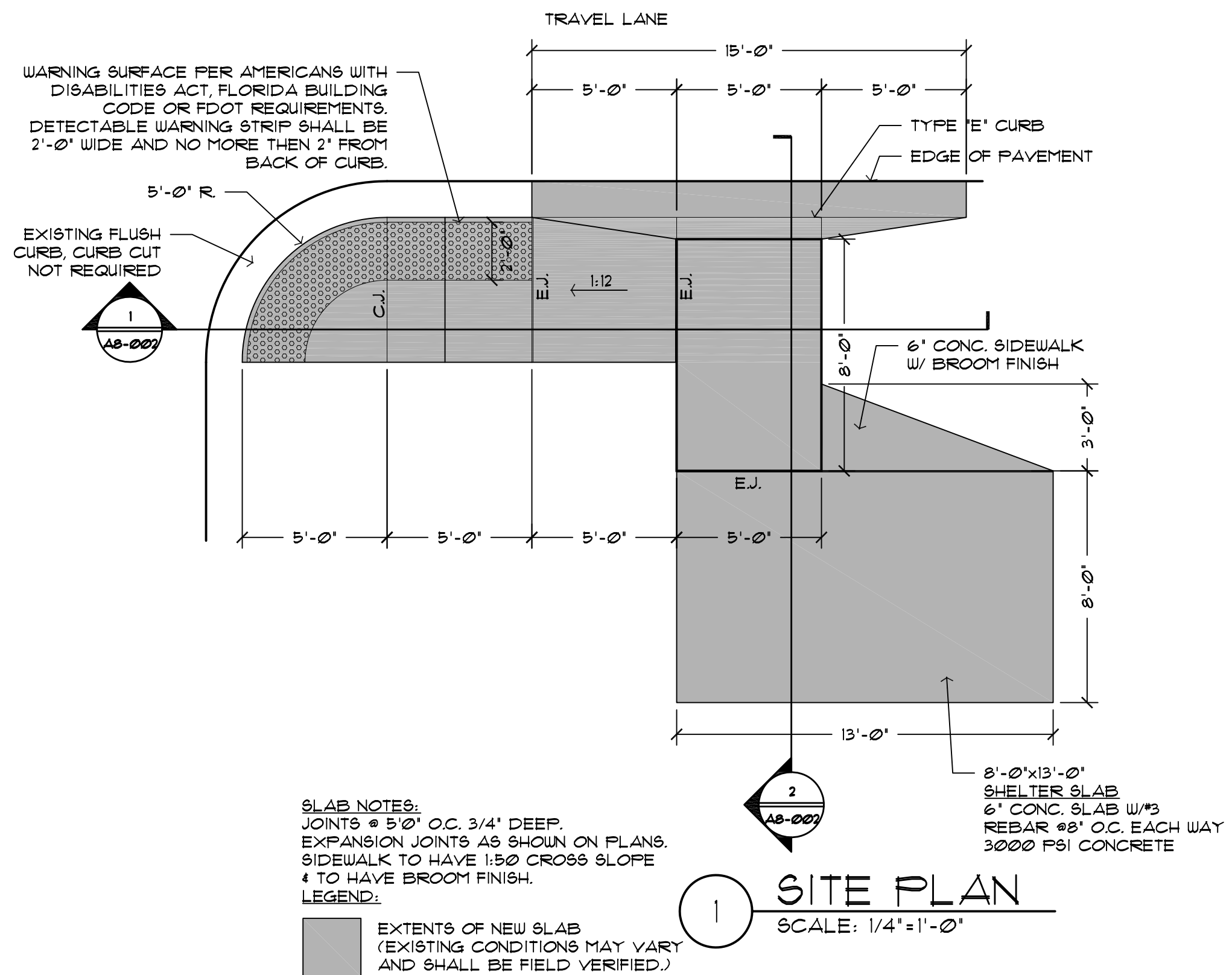

SITE PLAN

SCALE: 1/4"=1'-0"



BACON GROUP, INC.
ARCHITECTURE
2641 SUNSET POINT ROAD
CLEARWATER, FLORIDA 33759
P: 727.725.0111 - F: 727.725.0111
WWW.BGARCHITECTS.COM
AAC000295

COPYRIGHT 2013. ALL RIGHTS RESERVED - NO
PART OF THESE DOCUMENTS MAY BE
REPRODUCED OR DISTRIBUTED IN ANY FORM
WITHOUT PERMISSION FROM BACON GROUP,
INC. ALL INFORMATION IN THESE DOCUMENTS
IS CONSIDERED CONFIDENTIAL AND THE
PROPERTY OF BACON GROUP, INC.



RICHARD S. BACON, AIA
AR #0011946

CONDITION 8 SITE PLAN

ADA BOARDING PAD PROJECT
MANATEE COUNTY GOVERNMENT PUBLIC WORKS DEPARTMENT
1108 26th AVENUE EAST
BRADENTON, FLORIDA 34208

REVISIONS	
1	
2	
3	

DRAWN BY:
JRB

PRINTED DATE:
March 7, 2017

SHEET ID:
A8 - 001

PROJECT ID:
BG13-07

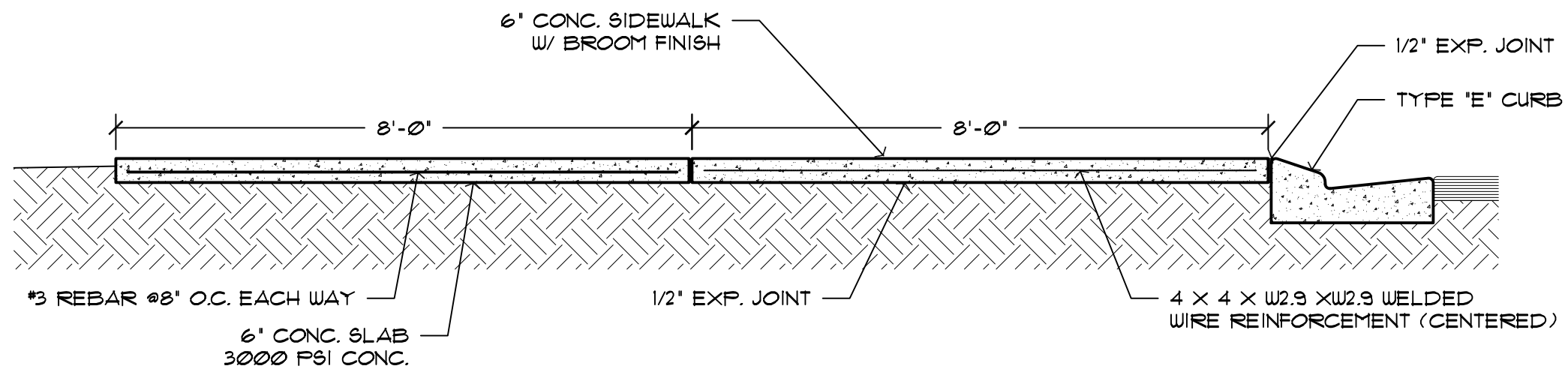

2 SECTION
SCALE: 1/2" = 1'-0"

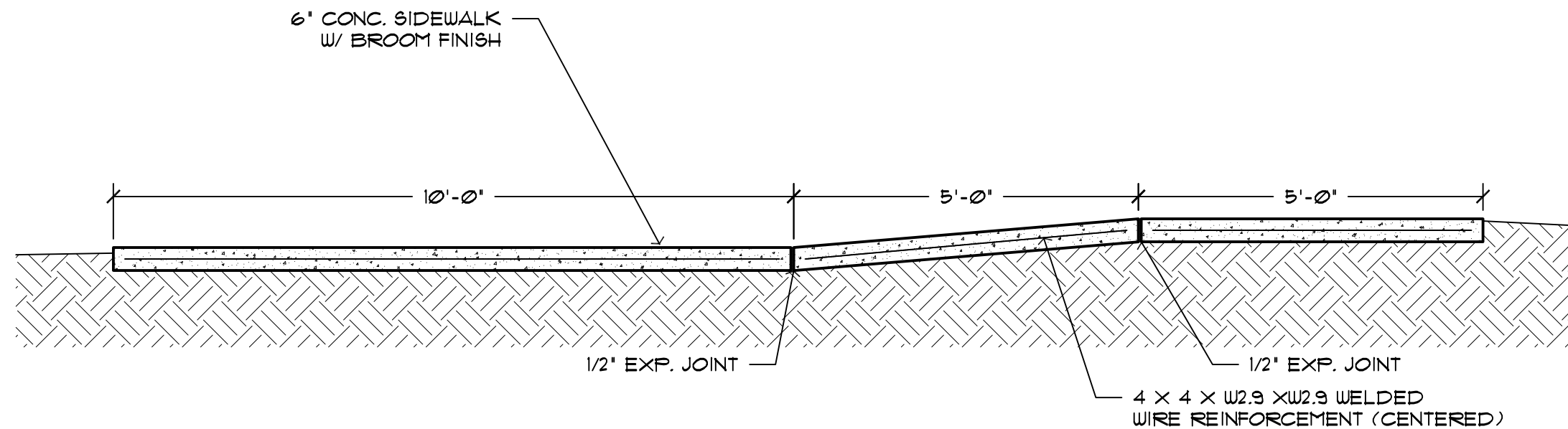

1 SECTION
SCALE: 1/2" = 1'-0"



BACON GROUP, INC.
ARCHITECTURE

2641 SUNSET POINT ROAD
CLEARWATER, FLORIDA 33759
P: 727.725.0111 - F: 727.725.0111
WWW.BGARCHITECTS.COM
AAC000295

COPYRIGHT 2013. ALL RIGHTS RESERVED - NO
PART OF THESE DOCUMENTS MAY BE
REPRODUCED OR DISTRIBUTED IN ANY FORM
WITHOUT PERMISSION FROM BACON GROUP,
INC. ALL INFORMATION IN THESE DOCUMENTS
IS CONSIDERED CONFIDENTIAL AND THE
PROPERTY OF BACON GROUP, INC.



RICHARD S. BACON, AIA
AR #0011946

CONDITION 8 SECTIONS

ADA BOARDING PAD PROJECT
MANATEE COUNTY GOVERNMENT PUBLIC WORKS DEPARTMENT
1108 26th AVENUE EAST
BRADENTON, FLORIDA 34208

REVISIONS

1	
2	
3	

DRAWN BY:
JRB

PRINTED DATE:
March 7, 2017

SHEET ID:
A8 - 002

PROJECT ID:
BG13-07

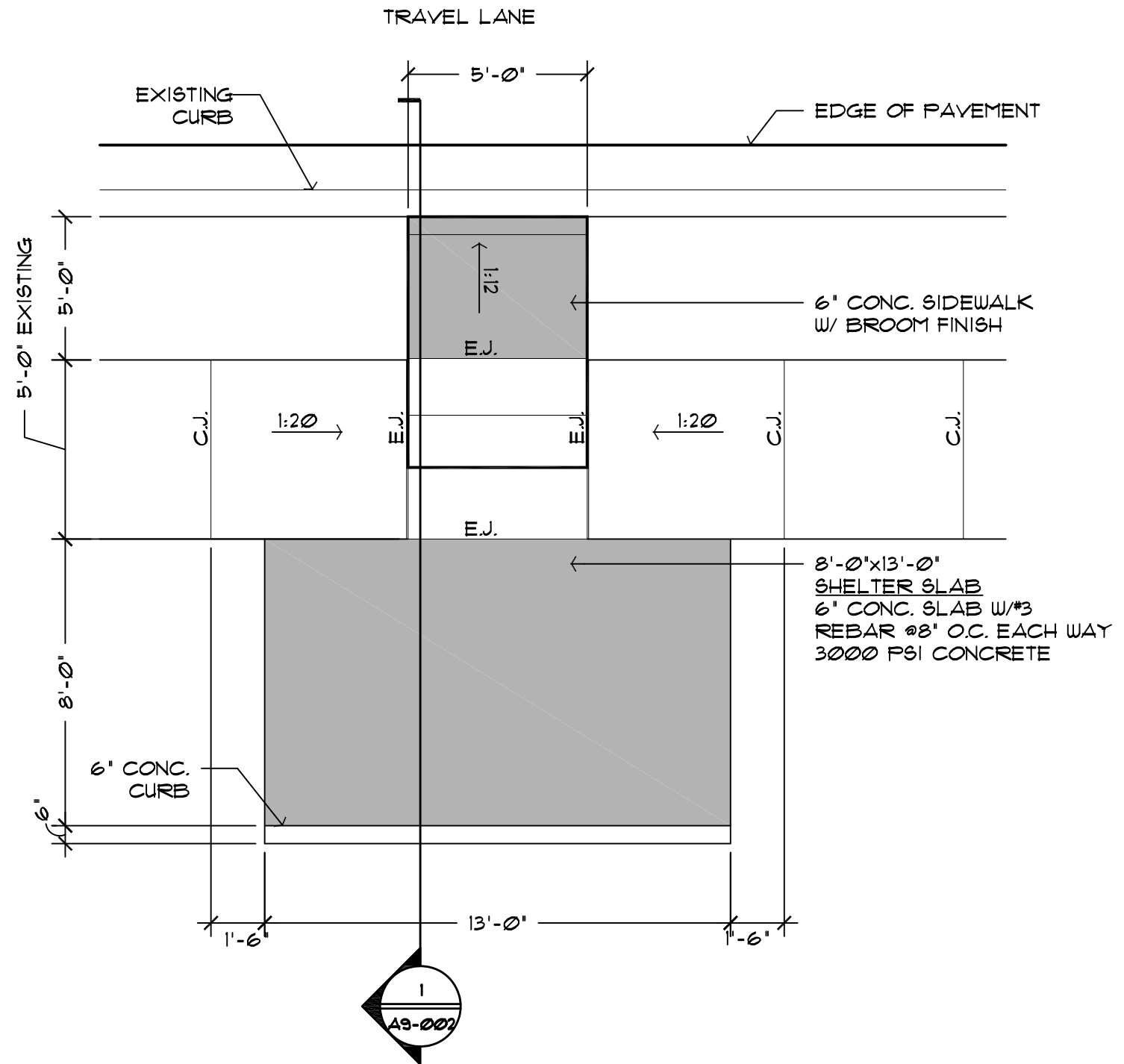

SLAB NOTES:
 JOINTS @ 5'-0" O.C. 3/4" DEEP.
 EXPANSION JOINTS AS SHOWN ON PLANS.
 SIDEWALK TO HAVE 1:50 CROSS SLOPE
 & TO HAVE BROOM FINISH.

LEGEND:

EXTENTS OF NEW SLAB
 (EXISTING CONDITIONS MAY VARY
 AND SHALL BE FIELD VERIFIED.)

1 **SITE PLAN**
 SCALE: 1/4" = 1'-0"



RICHARD S. BACON, AIA
 AR #0011946

CONDITION 9 SITE PLAN

ADA BOARDING PAD PROJECT
 MANATEE COUNTY GOVERNMENT PUBLIC WORKS DEPARTMENT
 1108 26th AVENUE EAST
 BRADENTON, FLORIDA 34208

REVISIONS	
1	
2	
3	

DRAWN BY:
JRB

PRINTED DATE:
 March 7, 2017

SHEET ID:
A9 - 001

PROJECT ID:
 BG13-07

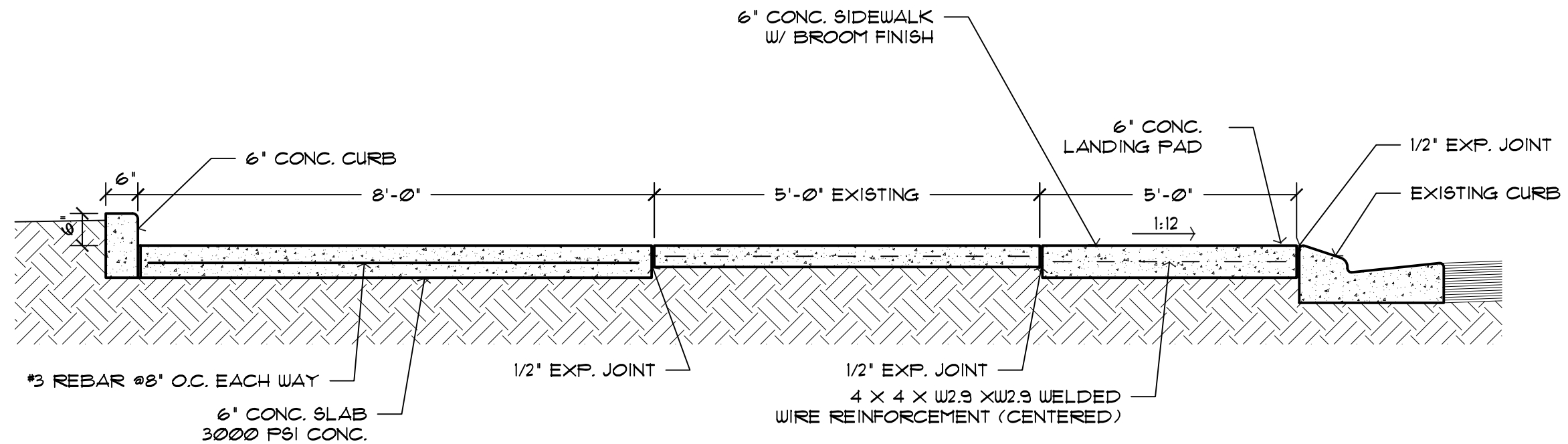

1 SECTION
SCALE: 1/2" = 1'-0"



BACON GROUP, INC.
ARCHITECTURE

2641 SUNSET POINT ROAD
CLEARWATER, FLORIDA 33759
P: 727.725.0111 - F: 727.725.0111
WWW.BGARCHITECTS.COM
AAC0002095

COPYRIGHT 2013. ALL RIGHTS RESERVED - NO PART OF THESE DOCUMENTS MAY BE REPRODUCED OR DISTRIBUTED IN ANY FORM WITHOUT PERMISSION FROM BACON GROUP, INC. ALL INFORMATION IN THESE DOCUMENTS IS CONSIDERED CONFIDENTIAL AND THE PROPERTY OF BACON GROUP, INC.



RICHARD S. BACON, AIA
AR #0011946

CONDITION 9 SECTIONS

ADA BOARDING PAD PROJECT
MANATEE COUNTY GOVERNMENT PUBLIC WORKS DEPARTMENT
1108 26th AVENUE EAST
BRADENTON, FLORIDA 34208

REVISIONS

1
2
3

DRAWN BY:

JRB

PRINTED DATE:

March 7, 2017

SHEET ID:

A9 - 002

PROJECT ID:

BG13-07

TRAVEL LANE

- EDGE OF PAVEMENT

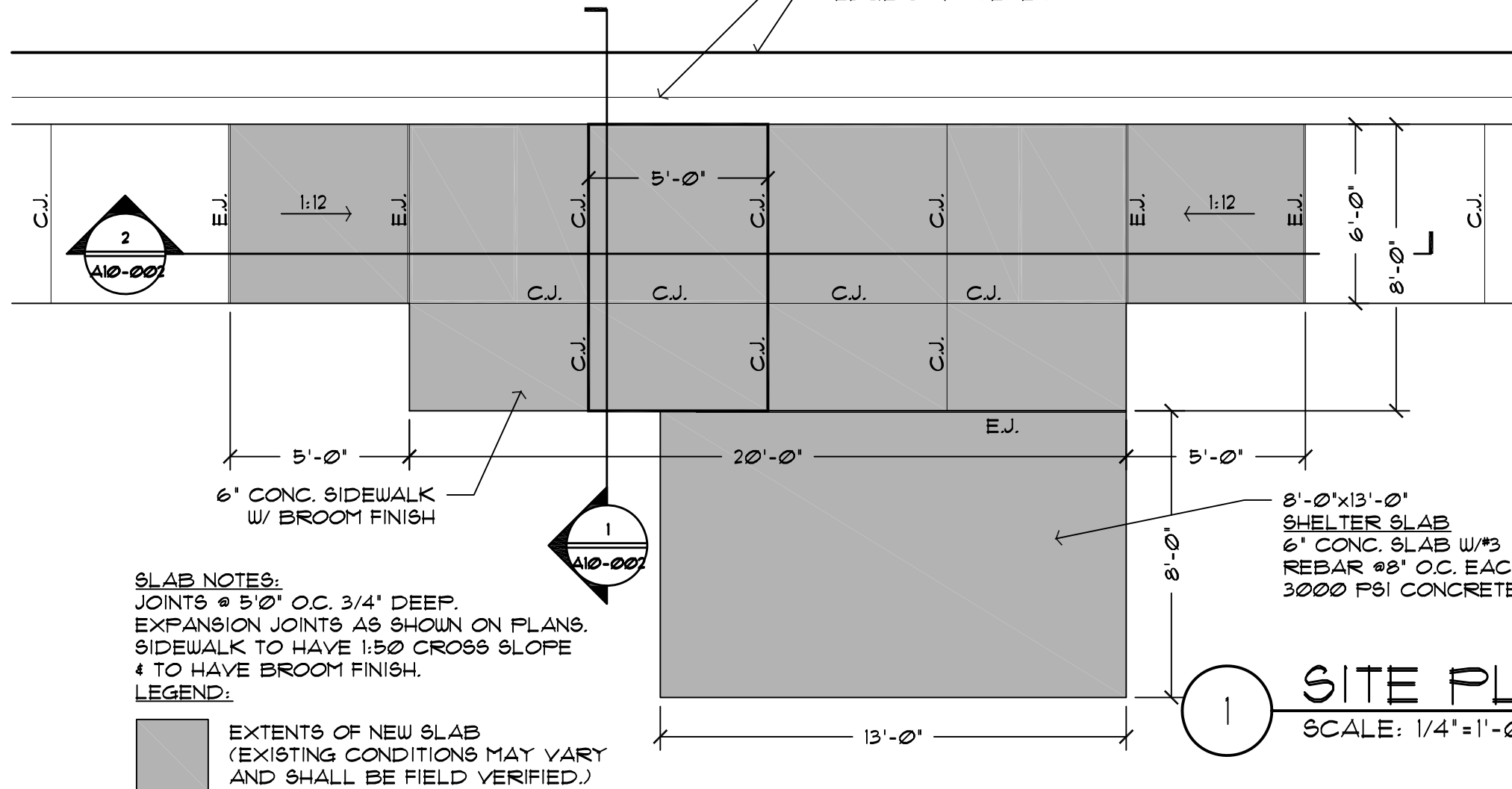

ADA BOARDING PAD PROJECT
MANATEE COUNTY GOVERNMENT PUBLIC WORKS DEPARTMENT
1108 26th AVENUE EAST
BRADENTON, FLORIDA 34208

PROJECT ID:
BC13 07

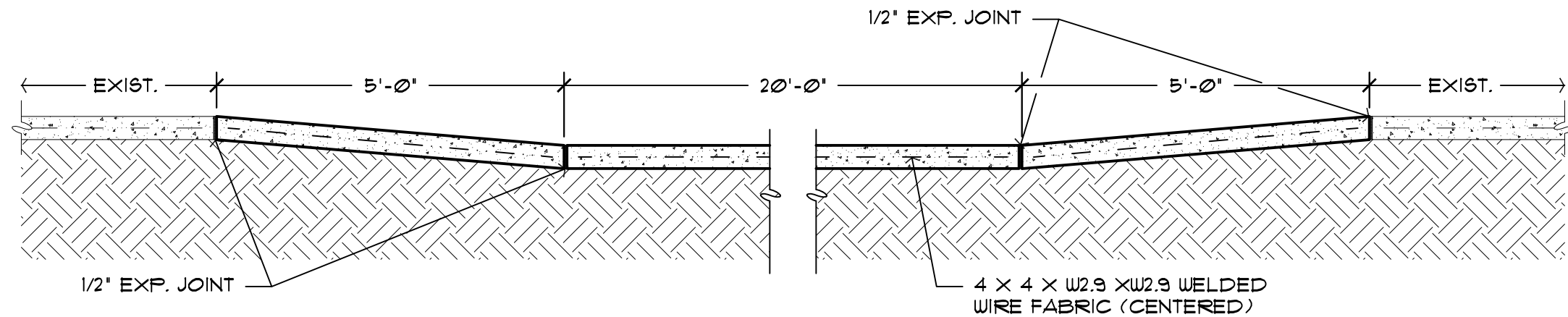

1 TYPICAL SECTION
SCALE: 1/2" = 1'-0"

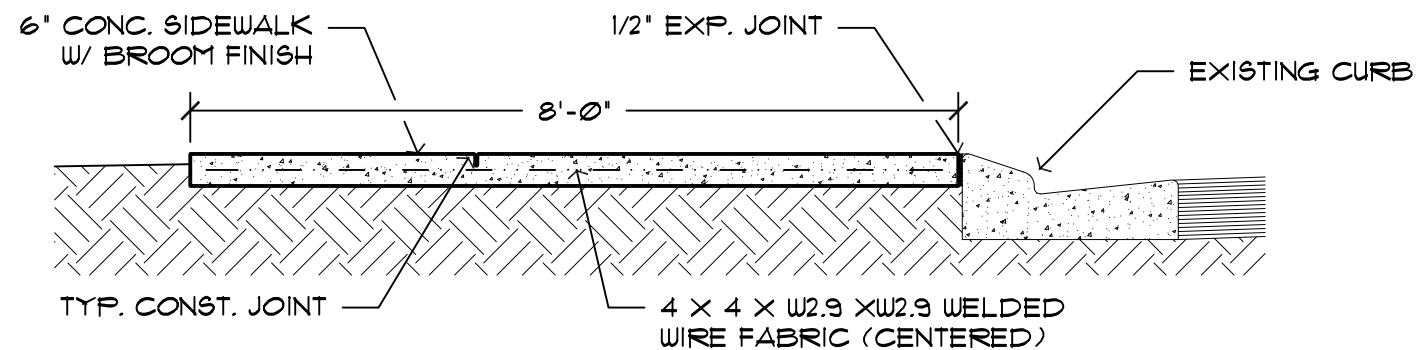

1 TYPICAL SECTION
SCALE: 1/2" = 1'-0"



BACON GROUP, INC.
ARCHITECTURE

2641 SUNSET POINT ROAD
CLEARWATER, FLORIDA 33759
P: 727.725.0111 - F: 727.725.0111
WWW.BGARCHITECTS.COM
AAC000095

COPYRIGHT 2013. ALL RIGHTS RESERVED - NO PART OF THESE DOCUMENTS MAY BE REPRODUCED OR DISTRIBUTED IN ANY FORM WITHOUT PERMISSION FROM BACON GROUP, INC. ALL INFORMATION IN THESE DOCUMENTS IS CONSIDERED CONFIDENTIAL AND THE PROPERTY OF BACON GROUP, INC.



RICHARD S. BACON, AIA
AR #0011946

CONDITION 10 SECTIONS

ADA BOARDING PAD PROJECT
MANATEE COUNTY GOVERNMENT PUBLIC WORKS DEPARTMENT
1108 26th AVENUE EAST
BRADENTON, FLORIDA 34208

REVISIONS

1
2
3

DRAWN BY:

JRB

PRINTED DATE:

March 7, 2017

SHEET ID:

A10 - 002

PROJECT ID:

BG13-07

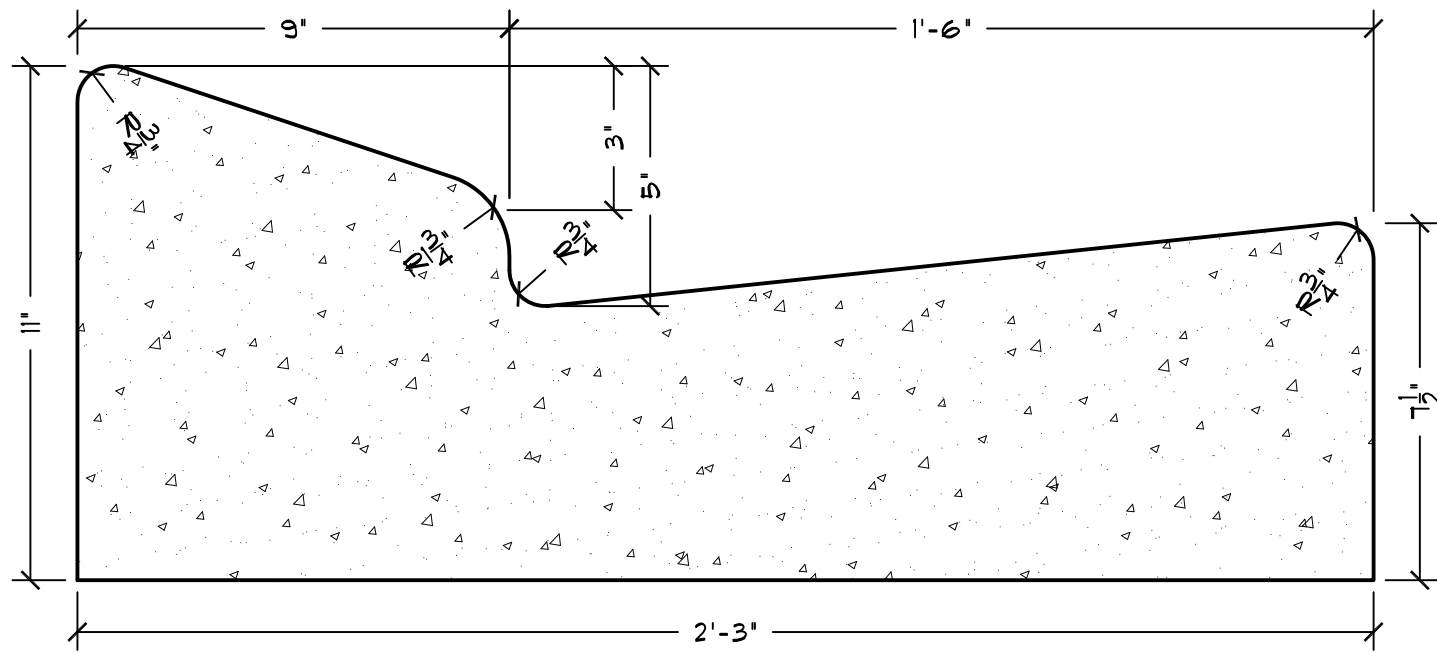

4 TYPE "E" CURB
SCALE: 3"=1'-0"

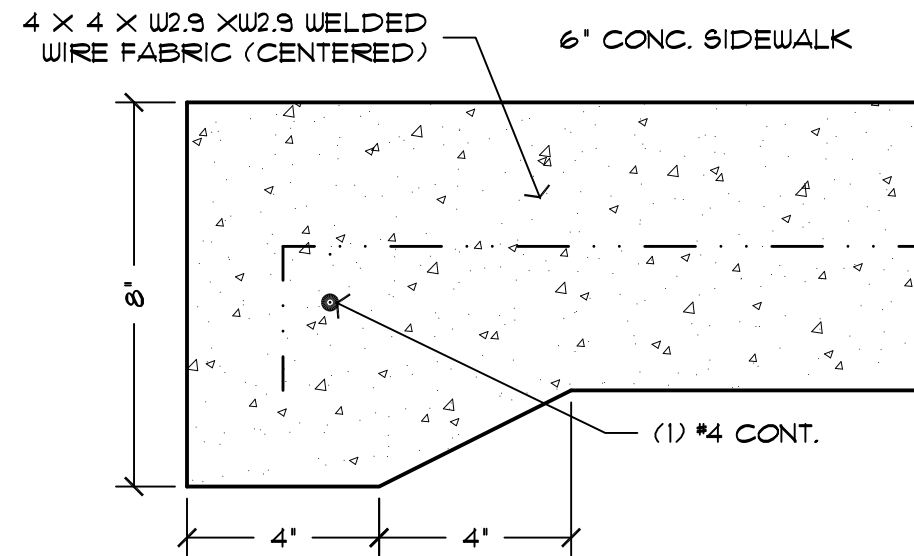

3 TYP. TURNDOWN SLAB
SCALE: 3"=1'-0"

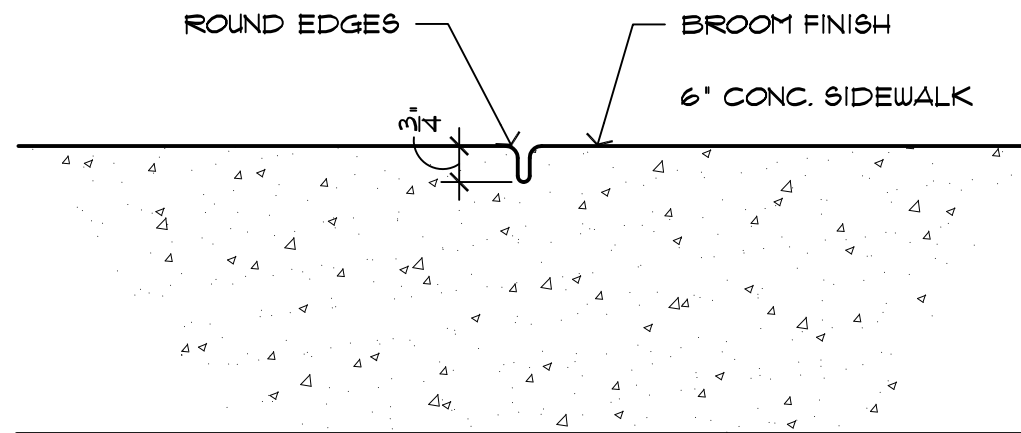

2 TYP. CONSTRUCTION JOINT
SCALE: 3"=1'-0"

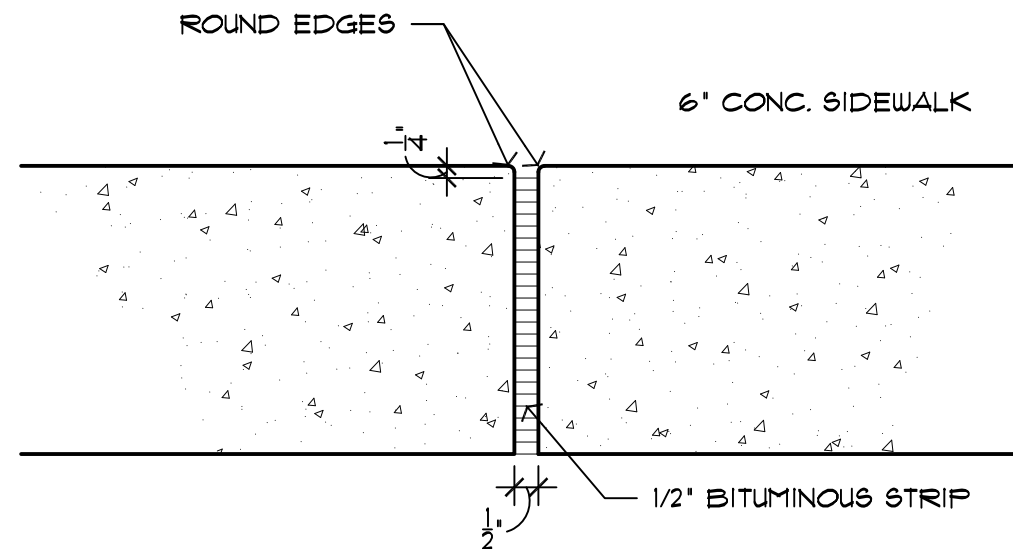

1 TYP. EXPANSION JOINT
SCALE: 3"=1'-0"



BACON GROUP, INC.
ARCHITECTURE

2641 SUNSET POINT ROAD
CLEARWATER, FLORIDA 33759
P: 727.725.0111 - F: 727.725.0111
WWW.BGARCHITECTS.COM
AAC0002095

COPYRIGHT 2013. ALL RIGHTS RESERVED - NO PART OF THESE DOCUMENTS MAY BE REPRODUCED OR DISTRIBUTED IN ANY FORM WITHOUT PERMISSION FROM BACON GROUP, INC. ALL INFORMATION IN THESE DOCUMENTS IS CONSIDERED CONFIDENTIAL AND THE PROPERTY OF BACON GROUP, INC.



RICHARD S. BACON, AIA
AR #0011946

STANDARD DETAILS

ADA BOARDING PAD PROJECT
MANATEE COUNTY GOVERNMENT PUBLIC WORKS DEPARTMENT
1108 26th AVENUE EAST
BRADENTON, FLORIDA 34208

REVISIONS

1	
2	
3	

DRAWN BY:

JRB

PRINTED DATE:

March 7, 2017

SHEET ID:

PROJECT ID:

BG13-07