

MANATEE COUNTY
FLORIDA

August 11, 2009

TO: All Interested Bidders

SUBJECT: **Invitation for Bid # 09-2569-DS**
Canal Road Stormwater Piping from 24th Street East to 29th Street East
(Project No. 6067300 6.2)

ADDENDUM # 2

Bidders are hereby notified that this Addendum shall be acknowledged on pages 00300-1 of the Bid Form and made a part of the above named bidding and contract documents.

The following items are issued to add to, modify, and clarify the bid and contract documents. These items shall have the same force and effect as the original bidding and contract documents, and cost involved shall be included in the bid prices. Bids to be submitted on the specified bid date, shall conform to the additions and revisions listed herein.

The deadline for clarification of questions has expired. This deadline had been established to maintain fair treatment of all potential bidders, while maintaining the expedited nature of the Economic Stimulus that the contracting of this work may achieve.

The followings answers to the questions have been provided by Mr. David Theung and Mr. Mike Reineke, Project Engineers of Wade Trim Inc. and Mr. Jeff Streitmatter, Project Manager, Manatee County Government, Project Management Division.

1. **Attachment: Wade Trim Inc., Letter dated August 11, 2009 (2) two pages.**
Subject of Attachment: Responses to Submitted Questions.
2. **Attachment: Manatee County Government, Memo dated August 10, 2009 (1) one page.**
Subject of Memo: Response to Submitted Question.

Finance Management Department
Mailing Address: Purchasing Division: 1112 Manatee Avenue West, Suite 803, Bradenton, FL 34205
PHONE: 941-708-7528 * FAX: 941-708-7544
www.mymanatee.org

Page 2
August 11, 2009
IFB# 09-2569-DS
ADDENDUM # 2

3. Attachment: Wade Trim Inc. Drawings (7) seven pages.
Subject of Drawings: Responses to Submitted Questions.

Bidders: The Bid Forms attached to this Addendum # 2 Pages 00300-2 thru 00300-5, (Bid "A" and Bid "B") supersede all other Bid Forms issued for this solicitation and must be used in submission of your bid in response to this Invitation For Bid. (4) four pages.

If you have submitted a bid prior to receiving this addendum, you may request in writing that your original, sealed bid be returned to your firm. All sealed bids received will be opened on the date stated.

END OF ADDENDUM # 2

The deadline for submitting sealed Bids at the Manatee County Purchasing Division, 1112 Manatee Avenue West, Suite 803, Bradenton, Florida 34205 is until 3:30 P.M. on August 13, 2009.

Sincerely,

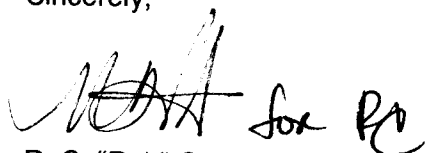

R. C. "Rob" Cuthbert, CPM, CPPO
Purchasing Division Manager

/ds

Attachments

Finance Management Department
Mailing Address: Purchasing Division: 1112 Manatee Avenue West, Suite 803, Bradenton, FL 34205
PHONE: 941-708-7528 * FAX: 941-708-7544
www.mymanatee.org



August 11, 2009

Ms. Donna M. Stevens
Manatee County Government
Construction Buyer
1022 26th Avenue East
Bradenton, FL 34208

Re: Canal Road Piping
Manatee County Project Number: 6067300
Addendum No. 2 Responses

Dear Ms. Stevens:

Per your request, please find our response to the following questions received for the above referenced project:

- Comment 1:** Page 9 in the Special Provisions – Utility Coordination states that 20 mobilizations and 20 de-mobilizations should be included for coordination with utility relocations/adjustments. Please explain.
- Response 1:** Paragraph three in the Utility Coordination section of the Special Provisions shall be edited as follows. The sentence, "For the purpose of this bid, 20 demobilizations and 20 remobilizations will be included in the lump sum bid for Mobilization", has been removed.
- Comment 2:** Please describe the method of measurement and payment for Bid Item 6 – Regular Excavation. Based on the cross sections provided, I see very little excavation; please explain how the bid quantity of 3021 cubic yards was calculated.
- Response 2:** Updated plan cross-sections with excavation limits and earthwork summary are attached. Revised bid form also attached.
- Comment 3:** Sheets 5-7 indicates significant amounts of pipe, structure, and end section removal. Which bid item(s) are to be utilized for this portion of the bid?
- Response 3:** The removal of roadside drainage structures are covered under Bid Item 5, Clearing & Grubbing.
- Comment 4:** On sheet 6, structure 7-A appears to be close to an existing survey marker and may need to be reset. Which bid item are we to utilize for this portion of the bid?
- Response 4:** In accordance with the "Restoration Section," payment for restoring survey monumentation should be included in the applicable pay item, bid item 11. The entire Restoration Section of the Special Provisions shall be revised as follows:

Wade Trim, Inc.
Renaissance 5
8745 Henderson Road, Suite 220
Tampa, FL 33634

813.882.8366
888.499.9624
813.884.5990 fax
www.wadetrim.com



Ms. Donna M. Stevens
August 11, 2009
Page 2

RESTORATION

Payment for restoration shall be covered under the applicable restoration Pay Items as specified in the Bid Form. If a specific restoration Pay Item is not listed in the Bid Form, the cost of such work shall be included in the applicable Pay Item unless otherwise provided under separate restoration section or pay quantity of these Specifications.

Comment 5: On sheet 7, the proposed storm pipe is running under existing pavement and would have to be removed for the storm to be installed. How thick is the existing pavement? How much asphalt is to be installed? Is this quantity covered within any of the bid items?

Response 5: We do not have data on the depth of the existing asphalt. Replacement of existing pavement will require 11.6 tons of asphalt based on 1-3/4 inches of thickness. The quantity is covered in Bid Item 10.

Comment 6: For the project Canal Road Stormwater Piping, note 6 on plan sheet # 3 states all storm pipe to be Class IV. Why is the county selecting to go with Class IV over Class III for this project?

Response 6: Due to the load of the future vehicular use over the proposed pipe, the manufacture has recommended Class IV RCP.

If you have any questions or require additional information, please do not hesitate to contact us.

Sincerely,

WADE TRIM, INC.

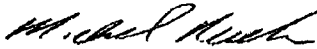

Michael Reineke
Project Manager

MR:jjc
MTE2107.01M (330)
P:\Mte2107\01m\Docs\Transportation\Bid Documents\Addendum2-081108.docx

Attachment

cc: Jeff Streitmatter, Manatee County



MANATEE COUNTY
FLORIDA

**Canal Road Piping
Manatee County Project Number 6067300**

The following is our response to question(s) received for the above referenced project:

Question: On page 00700-13 of the of the bid package, Article 9.1 states that the Contractor must warranty the project for three years. Does the County release the Performance and Payment Bond when the project is completed??

Response: Refer to Section 00030, Paragraph C.16, "PERFORMANCE AND PAYMENT BONDS".

 8-10-09

Jeff Streitmatter
Project Management

Public Works Department / Project Management Division
Mailing Address: P.O. BOX 1000, Bradenton, FL 34206-1000 * Street Address: 1022 26th Avenue East, Bradenton, FL 34208
PHONE: 941.708.7450 * FAX: 941.708.7549
www.mymanatee.org

LARRY BUSTLE * DR. GWENDOLYN Y. BROWN * JOHN R. CHAPPIE * RON GETMAN * DONNA G. HAYES * CAROL WHITMORE * JOE MCCLASH
District 1 District 2 District 3 District 4 District 5 District 6 District 7



**MANATEE COUNTY, FLORIDA
CANAL ROAD PIPING - FINAL DESIGN
FROM 24TH STREET EAST TO 29TH STREET EAST
MANATEE COUNTY PROJECT NO. 6067300**

NO. INDEX OF SHEETS

- 1 KEY SHEET
- 2 SUMMARY OF PAY ITEMS
- 3 GENERAL NOTES & TYPICAL SECTION
- 4 DRAINAGE MAP
- 5-7 PLAN & PROFILE
- 8-11 CROSS SECTIONS
- 12 STORMWATER POLLUTION PREVENTION PLAN
- S1-S2 STRUCTURAL DETAILS

GOVERNING STANDARDS AND SPECIFICATIONS:
 FLORIDA DEPARTMENT OF TRANSPORTATION,
 DESIGN STANDARDS DATED JANUARY 2006,
 STANDARD SPECIFICATIONS FOR ROAD AND BRIDGE
 CONSTRUCTION DATED 2007, AS AMENDED
 BY CONTRACT DOCUMENTS,
 MANATEE COUNTY TRANSPORTATION HIGHWAY & DRAINAGE STANDARDS
 DATED 2007.

ANY COUNTY UTILITIES EFFECTED AS A RESULT OF THIS PROJECT
 SHALL BE DEALT WITH PER THE LATEST VERSION OF THE APPROVED
 MANATEE COUNTY UTILITY STANDARDS.

AT LEAST 72 HOURS IN ADVANCE OF BEGINNING CONSTRUCTION
 THE CONTRACTOR SHALL CONTACT THE LOCAL
 WATER AND SEWER DEPARTMENT TO OBTAIN THE
 USE PERMIT AND/OR OTHER PERMITS AS REQUIRED FOR WORKING
 WITHIN THE DEPARTMENT'S RIGHT-OF-WAY.

UTILITIES SHOWN WHERE INTERPOLATED FROM THE FOLLOWING
 CONSTRUCTION AND RECORD PLANS: 1988 - LARSON ENGINEERING, INC.
 NORTH SUBREGIONAL SEWER SYSTEM, 1988 - GRACE RAUCLIFFE, INC.
 SAFETY IMPROVEMENTS TO CANAL ROAD - 1993 - GRACE RAUCLIFFE, INC.
 SURVEY DATA ALONG CANAL ROAD WAS INTERPOLATED FROM
 GRACE RAUCLIFFE, INC. PLANS DATED 1993.

SURVEY DATA FOR THE EXISTING CANAL ROAD DITCH SYSTEM
 WAS PROVIDED BY BOWEN-SINGLETON & ASSOCIATES, INC.
 DATED 2007.

NO.	DATE	DESCRIPTION

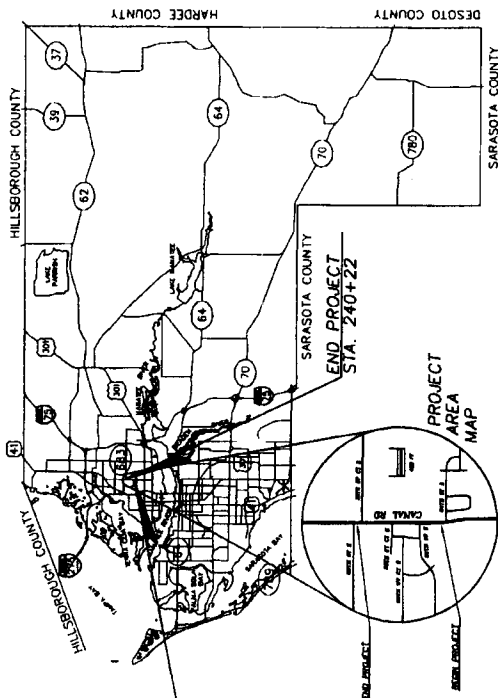

LENGTH OF PROJECT	FEET
ROADWAY	1,351
BRIDGES	N/A
NET LENGTH OF PROJ.	1,351
EXCEPTIONS	N/A
GROSS LENGTH OF PROJ.	1,351

WADE TRIM PROJECT MANAGER : MICHAEL REINEKE

SHOP DRAWINGS
 TO BE SUBMITTED TO:
 DAVID O. THEUNG, PE #44786
 Wade Trim, Inc.
 8745 Henderson Road, Suite 220
 Tampa, Florida 33634
 Vendor No. 59-2417170



PLANS PREPARED BY:

NOTE: THE SCALE OF THESE PLANS MAY
 HAVE CHANGED DUE TO REPRODUCTION.

CONSTRUCTION PLANS
 ENGINEER OF RECORD: DAVID O. THEUNG, P.E.
 P.E. NO.: 44786

PAY ITEM QUANTITIES:

ITEM	PAY ITEM NUMBER	DESCRIPTION	UNIT	QUANTITY
1	101-1	Mobilization	LS	1
2	102-1	Maintenance of Traffic	LS	1
3	104-10-2	Synthetic Bales	LF	20
4	104-11	Floating Turbidity Barrier	LF	45
5	110-1-1	Cleaning & Grubbing	LS	45
6	120-1	Regular Excavation	CY	5928
7	120-8	Embankment (inc. final grading work)	CY	8118
8	285-705	Optional Base, Group 5	SY	70
9	327-70-1	Milling Existing Asphalt Pavement, 1"	SY	94
10	334-1-11	Superpave Asphaltic Conc. Traffic A, SP-9.5	TN	11.6
11	400-1-2	Concrete Class I, Endwalls	CY	11.6
12	400-1-15	Concrete Class I, Miscellaneous	CY	0.2
13	425-1-583	DBI Type H, J Box, <10' Mod	EA	7
14	425-2-71	MH, J7, <10' Mod	EA	3
15	430-175-101	Pipe Culvert, RCP, 0-24'S/CD	LF	16
16	430-175-202	Pipe Culvert, ERCP, 25-36'S/CD	LF	34
17	430-175-203	Pipe Culvert, ERCP, 37-48'S/CD	LF	2580
18	520-1-10	Concrete Curb and Gutter, Type F	LF	35
19	535-73	Guardrail Removal	LF	1196
20	570-1-2	Performance Turf, Sod	SY	6584
21	630-1-12	Signals-Conduit, F&I, Underground	LF	15
22	635-1-11	Pull & Junction Boxes, F&I, Pull Box	EA	1
23	660-2-106	Loop Detector, Inductive, F&I, Type F	EA	2
24	700-20-40	Single Post Sign (Relocate)	AS	1
25		Miscellaneous Work and Cleanup	LS	1
26		Discretionary Work (Roadway)	LS	1
27		Steel Casing, 14"	LF	20
28		Steel Casing, 20"	LF	35
29		6" DIP Class 50 Watermain (R.J.) 6" 45° Bend	LF	35
29		Discretionary Work (Utilities)	EA	4

PAY ITEM NOTES:

- ITEM 6: CONTRACTOR IS ADVISED OF THE POTENTIAL OF SHALLOW LAMEROCK LAYERS IN THE PROJECT VICINITY. ROCK EXCAVATED SHALL BE INCIDENTAL TO REGULAR EXCAVATION. NO ADDITIONAL PAYMENT WILL BE MADE FOR ROCK EXCAVATION.
- REGULAR EXCAVATION INCLUDES REMOVAL OF MATERIAL FOR INSTALLATION OF PIPE AND CONSTRUCTION OF SHALE.
- ITEM 7: EMBANKMENT INCLUDES REPLACEMENT MATERIAL EXCAVATED FOR PIPE INSTALLATION.
- ITEMS 8, 21-24: WILL ONLY BE REQUIRED IF THE 28TH STREET COURT EAST SIGNALIZATION AND INTERSECTION IMPROVEMENTS HAVE BEEN COMPLETE BY THE COUNTY. THESE ITEMS MAY BE DELETED BY THE ENGINEER.

DESIGNED BY	DATE	06/01/09	REVISION DESCRIPTION & DATE	EP	NO
CHECKED BY	DATE	06/01/09	REVISED PER ADDENDUM 1 7/29/09	MR	1
DRAWN BY	DATE	06/01/09	REVISED PER ADDENDUM 2 9/07/09	MR	2
CHECKED BY	DATE	06/01/09			
SUPERVISED BY	DATE	06/01/09			
DAVID O. THEWING, PE #41286					



**CANAL ROAD PIPING
FINAL DESIGN**
FROM 24TH STREET EAST TO 29TH STREET EAST
MANATEE COUNTY, FLORIDA

ENGINEER

PROJ. No. 6087300
Dwg. Date 06/01/09

WADETRIM
www.wadetrtrim.com
6115 Henderson Road, Suite 200, Tampa, FL 33634
Professional Engineer, David O. Thewing, PE No. 41196
Certificate of Authorization No. 3802

**SUMMARY OF
PAY ITEMS**

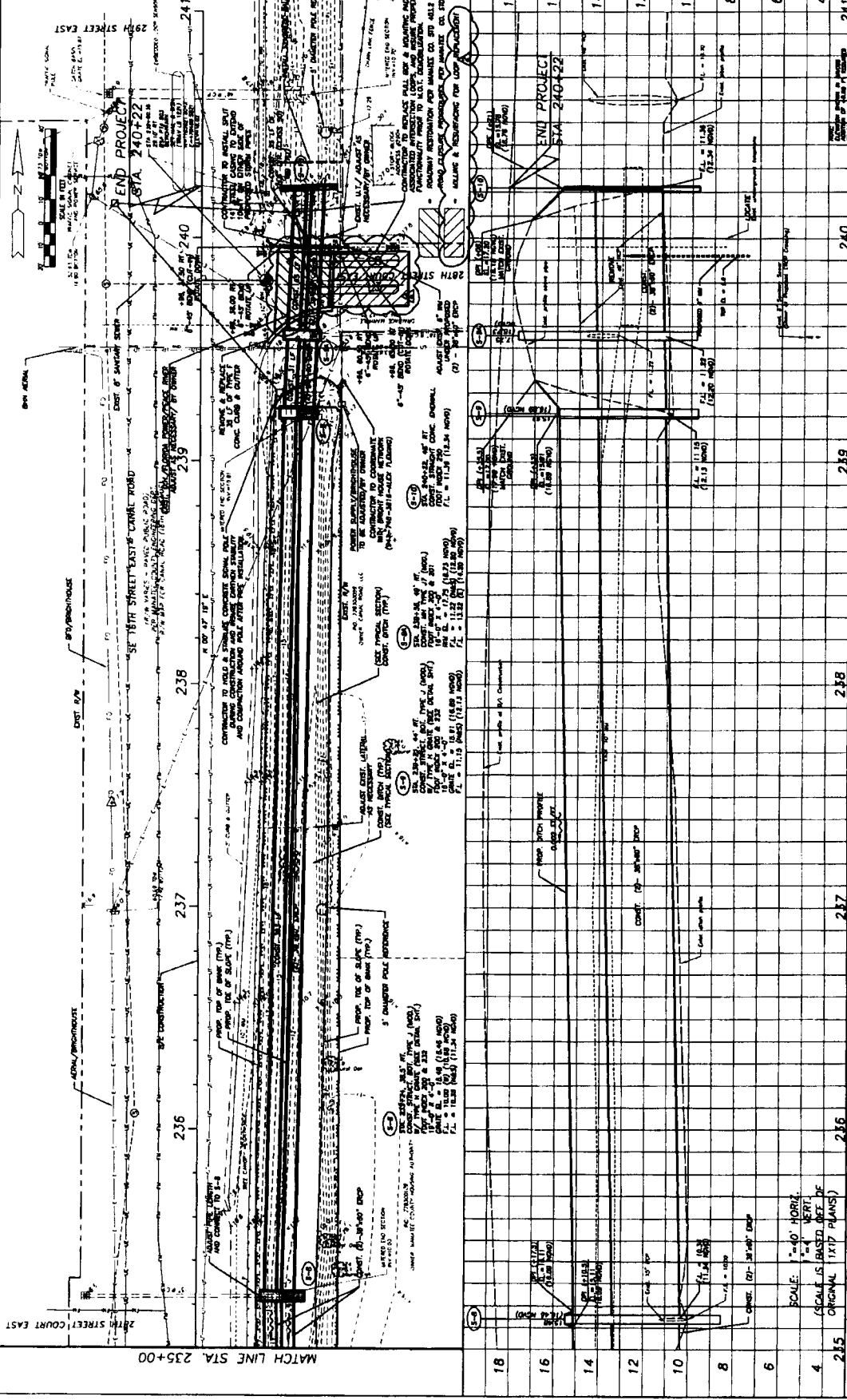

NO.	DATE	REVISION DESCRIPTION & DATE	BY	NO.
DESIGNED BY	MR	08/01/08	REVISION DESCRIPTION & DATE	235
CHECKED BY	PS	08/01/08	REVISED PER ADDENDUM 2 8/07/09	236
DRAWN BY	KR	08/01/08		237
CHECKED BY	PS	08/01/08		238
SUPERVISED BY	DAVID D. THEUNIS, PE #44786			239

ENGINEER	240
Proj. No.	6087000
Draw. Date	03/01/09

WADETRIM	
8745 Henderson Road, Suite 270, Tampa, FL 33634	
813 862-8388 FAX 813 864-5990 www.wadetr.com	
Certificate of Authorization No. 3827	

MANATEE COUNTY FLORIDA	
CANAL ROAD PIPING FINAL DESIGN	
FROM 24TH STREET EAST TO 29TH STREET EAST MANATEE COUNTY, FLORIDA	

PLAN & PROFILE

SCALE: 1"=40' HORIZ.
1"=4' VERT.
SCALE IS BASED ON 12"=12' ORIGINAL (11/17 PLANS)

DESIGNED BY: MR
CHECKED BY: PS
DRAWN BY: KR
CHECKED BY: PS
SUPERVISED BY: DAVID D. THEUNIS, PE #44786

NOTE:
ELEVATION SHOWN IN NAVD88
ADDITION OF +0.98 FT REQUIRED
TO CONVERT ELEVATION TO NGVD.

ESTIMATED
LIMITS OF EXCAVATION

BEON PROJECT
STA 228+71

BEON PROJECT
STA 228+71

BEON PROJECT
STA 228+71

BEON PROJECT
STA 228+71

BEON PROJECT
STA 228+71

BEON PROJECT
STA 228+71

BEON PROJECT
STA 228+71

BEON PROJECT
STA 228+71

SUBJECT	REVISION	DATE	BY	NO.

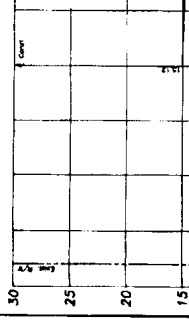
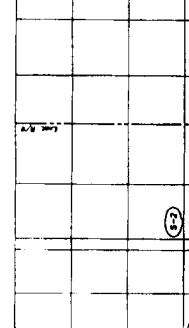
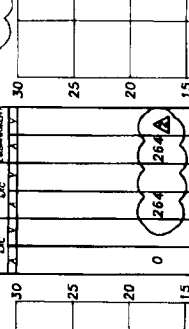
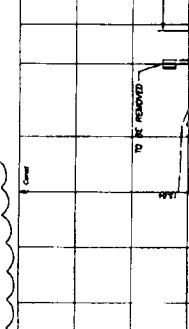
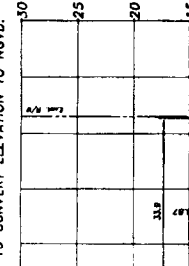

DESIGNED BY	DATE	REVISION DESCRIPTION & DATE	BY	NO.
MP	06/1/08	REVISED PER ADDENDUM 2.9/07/08	MP	1
PS	06/1/08			
DR	06/1/08			
LS	06/1/08			

LEADER
1 - SAND
2 - CLAYEY SAND
3 - SAND AND FINEGRAINED ROCK
4 - LIMESTONE
5 - SILTY SLT.

DESIGNED BY: MP
CHECKED BY: PS
DRAWN BY: DR
CHECKED BY: LS
SUPERSEDED BY: DAVID C. THEUNG, PE 44788

REVISION DESCRIPTION & DATE
REVISED PER ADDENDUM 2.9/07/08

DATE: 06/1/08
DATE: 06/1/08
DATE: 06/1/08
DATE: 06/1/08

DATE: 06/1/08
DATE: 06/1/08
DATE: 06/1/08
DATE: 06/1/08

ENGINEER

PROJ. NO. 6087300
DWG. DATE 05/01/09

WADETRIM
814 Henderson Road, Suite 200, Tampa, FL 33604
Phone: (813) 973-1100
Fax: (813) 973-1101
E-mail: info@wadetrim.com
Professional Seal No. 44788

CANAL ROAD PIPING
FINAL DESIGN
FROM 24TH STREET EAST TO 29TH STREET EAST
MANATEE COUNTY, FLORIDA

MANATEE COUNTY
FLORIDA

CROSS SECTIONS

SHEET NO. 9

NOTE: ELEVATION SHOWN IN NAVD83 ADDITION OF +0.98 FT REQUIRED TO CONVERT ELEVATION TO MGYD.

--- ESTIMATED LIMITS OF EXCAVATION

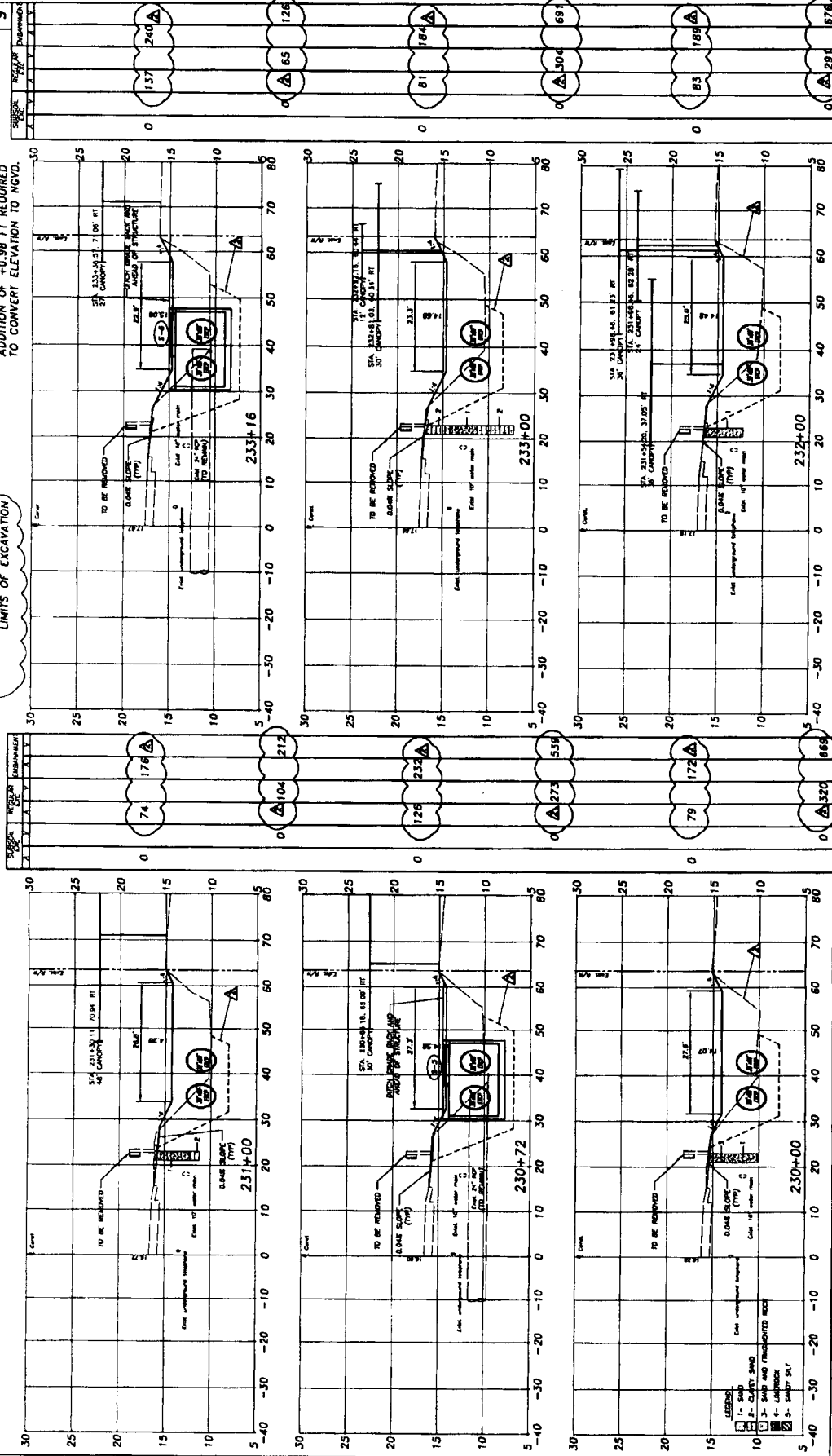

DESIGNED BY	MR	DATE	6/6/78	REVISION DESCRIPTION & DATE	BY	NO.
CHECKED BY	PS	DATE	6/6/78	REVISED PER ADDENDUM 2 8/07/09	MR	1
DRAWN BY	AR	DATE	6/6/78			
CHECKED BY	LS	DATE	6/6/78			
SUPERVISED BY	DAVID O. THUNG, PE	4/7/88				

WADETRIM
 8745 Henderson Road, Suite 200, Tampa, FL 33634
 813.882.8388 FAX 813.884.8930 PC No. 44106
 Certificate of Accreditation No. 3862

**CANAL ROAD PIPING
 FINAL DESIGN**
 FROM 24TH STREET EAST TO 28TH STREET EAST
 MANATEE COUNTY, FLORIDA



PROJ. NO.	6067300
ENGR. DATE	05/01/09
CROSS SECTIONS	

NOTE: ELEVATION SHOWN IN NAVD88
ADDITION OF +0.38 FT. REQUIRED
TO CONVERT ELEVATION TO NGVD.

ESTIMATED
LIMITS OF EXCAVATION

SECTION REGULAR SUBSEQUENT

NO. 10

SECTION REGULAR SUBSEQUENT

NO. 10

SECTION REGULAR SUBSEQUENT

NO. 10

SECTION REGULAR SUBSEQUENT

NO. 10

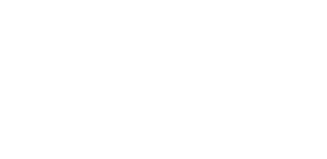
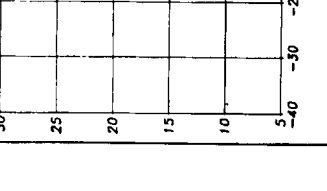
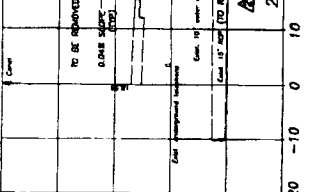
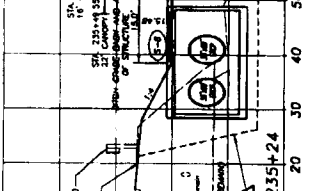
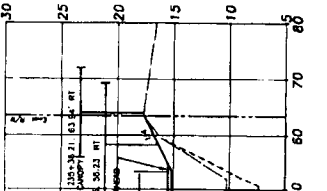
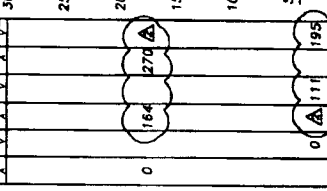
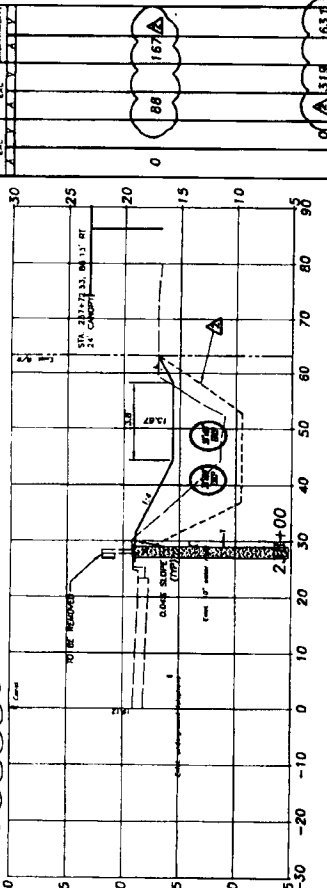

DESIGNED BY: [] DATE: []
CHECKED BY: [] DATE: []
DRAWN BY: [] DATE: []
CHECKED BY: [] DATE: []
SUPERVISED BY: [] DATE: []

REVISION DESCRIPTION & DATE

REVISED PER AGREEMENT 3.8.07/08

BY: INC

BY: A

DATE: []

DATE: []

DATE: []

DATE: []

DATE: []

DATE: []

WADETRIM

ENGINEER

PROJ. NO. 0667000

DRG. DATE 05/07/09

2716 Hamilton Road, Suite 700, Tampa, FL 33604

Professional Engineer, State of Florida, No. 44188

Professional Engineer, State of Florida, No. 44188

Professional Engineer, State of Florida, No. 44188

Professional Engineer, State of Florida, No. 44188

Professional Engineer, State of Florida, No. 44188

Professional Engineer, State of Florida, No. 44188

CANAL ROAD PIPING

FINAL DESIGN

FROM 24TH STREET EAST TO 29TH STREET EAST

MANATEE COUNTY, FLORIDA

MANATEE COUNTY FLORIDA

MANATEE COUNTY FLORIDA

MANATEE COUNTY FLORIDA

MANATEE COUNTY FLORIDA

MANATEE COUNTY FLORIDA

MANATEE COUNTY FLORIDA

MANATEE COUNTY FLORIDA

CROSS SECTIONS

CROSS SECTIONS

CROSS SECTIONS

CROSS SECTIONS

CROSS SECTIONS

CROSS SECTIONS

CROSS SECTIONS

CROSS SECTIONS

CROSS SECTIONS

CROSS SECTIONS

CROSS SECTIONS

SHEET NO.	11
PROJECT NO.	608700
DATE	05/01/09
ENGINEER	

NOTE:
ELEVATION SHOWN IN NAVD83
ADDITION OF +0.98 FT REQUIRED
TO CONVERT ELEVATION TO NGVD.

ESTIMATED
LIMITS OF EXCAVATION

DESCRIPTION	GT	F
TOTAL REGULAR EXCAVATION	3928	
EMBANKMENT	1023	
PIPE & STRUCTURE VOLUME	(-)/1905	
TOTAL EMBANKMENT	818	

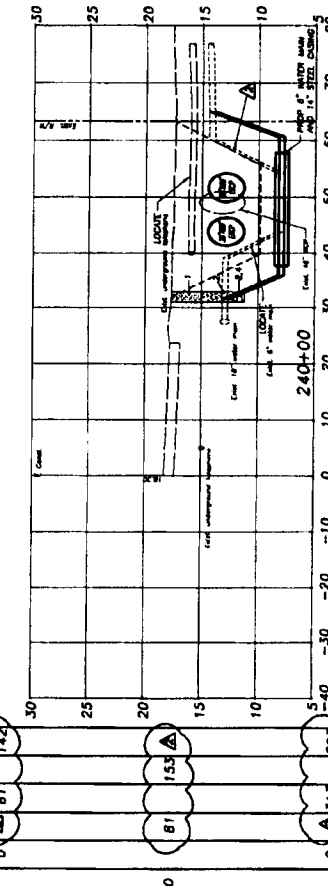
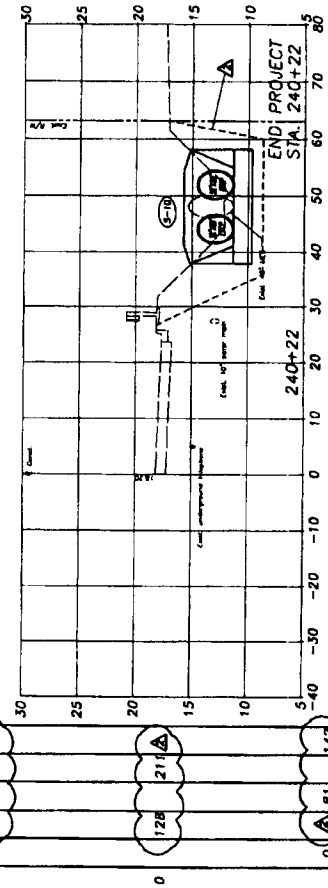
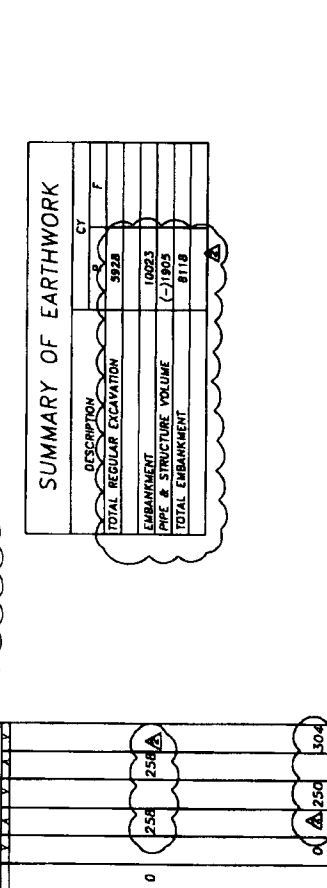
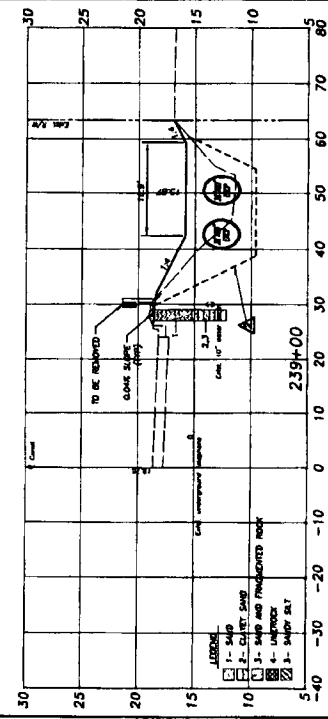
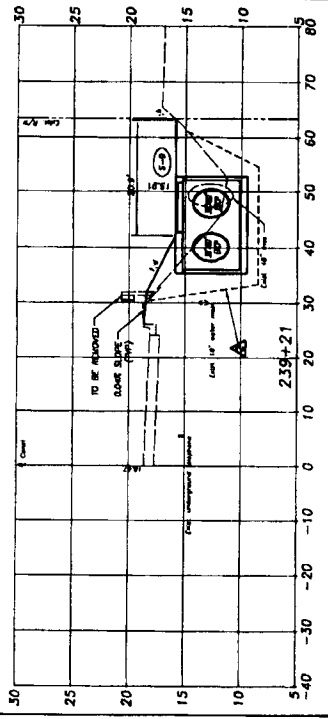
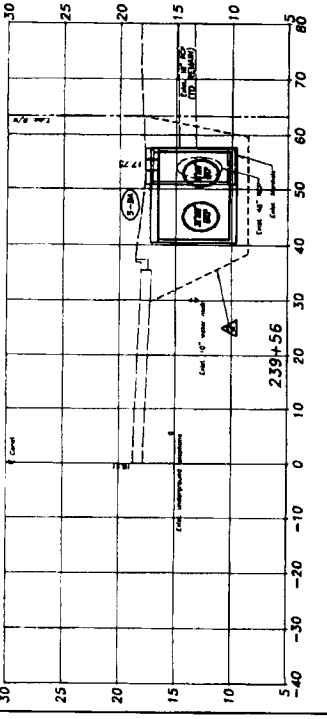

DESIGNED BY	MR	DATE	05/01/09
CHECKED BY	PS	DATE	05/01/09
DRAWN BY	HR	DATE	05/01/09
CHECKED BY	LS	DATE	05/01/09
SUPERVISED BY	DAVID O. THEJONG, PE #4786		

REVISION DESCRIPTION & DATE
REVISED PER ADDENDUM 2, 8/07/09

MANATEE COUNTY
FLORIDA

WADETRM
815 Manatee Road, Suite 200, Tampa, FL 33634
813.882.8996 FAX 813.882.8995
Professional Engineer PE No. 44186
Certificate of Authorization No. 3963

CANAL ROAD PIPING
FINAL DESIGN
FROM 24TH STREET EAST TO 28TH STREET EAST
MANATEE COUNTY, FLORIDA

CROSS SECTIONS

PROJECT NO. 608700
DRAWN DATE 05/01/09

LEGEND:
1- SAND
2- CLAY SAND
3- SAND AND FRAGMENTED ROCK
4- UNBANKED
5- SAND SILT

**BID FORM
SECTION 00300**

(Submit in Triplicate)

IFB# 09-2569-DS

(Page 1 of 2)

(ADDENDUM #1)

(ADDENDUM #2)

(Bid "A" - Based on Completion Time of 220 Calendar Days)

PROJECT NAME: <u>Canal Road Stormwater Piping from 24th St. East to 29th St. East</u> PROJECT NUMBER 6067300						
Item No.	FDOT ITEM	DESCRIPTION	U/M	QTY.	BID PRICE PER UNIT	TOTAL BID PRICE
1	101-1	Mobilization	LS	1	\$	\$
2	102-1	Maintenance of Traffic	LS	1	\$	\$
3	104-10-2	Synthetic Bales	LF	20	\$	\$
4	104-11	Floating Turbidity Barrier	LF	45	\$	\$
5	110-1-1	Clearing & Grubbing	LS	1	\$	\$
6	120-1	Regular Excavation (Addendum #1) (Addendum #2)	CY	5928	\$	\$
7	120-6	Embankment (Inc. final grading work) (Addendum #1) (Addendum #2)	CY	8118	\$	\$
8	285-705	Optional Base, Group 5 (Addendum #1)	SY	70	\$	\$
9	327-70-1	Milling Existing Asphalt Pavement, 1" (Addendum #1)	SY	94	\$	\$
10	334-1-11	Superpave Asphaltic Conc, Traffic A, SP-9.5 (Addendum #1)	TN	11.6	\$	\$
11	400-1-2	Concrete Class I, Endwalls	CY	11.6	\$	\$
12	400-1-15	Concrete Class I, Miscellaneous	CY	0.2	\$	\$
13	425-1-583	DBI Type H, J. Bot. <10'. Mod	EA	7	\$	\$
14	425-2-71	MH, J-7, <10', Mod (Addendum #1)	EA	3	\$	\$
15	430-175-101	Pipe Culvert, RCP, 0-24"S/CD (Addendum #1)	LF	16	\$	\$
16	430-175-202	Pipe Culvert, ERCP, 25-36"S/CD (Addendum #1)	LF	34	\$	\$
17	430-175-203	Pipe Culvert, ERCP, 37-48"S/CD (Addendum #1)	LF	2590	\$	\$

BIDDER _____

DATE _____

**BID FORM
SECTION 00300
(Submit in Triplicate)
IFB# 09-2569-DS
(Page 2 of 2)
(ADDENDUM # 1)
(ADDENDUM # 2)**

(Bid "A" - Based on Completion Time of 220 Calendar Days)

PROJECT NAME: Canal Road Stormwater Piping from 24th St. East to 29th St. East						
PROJECT NUMBER 6067300						
Item No.	FDOT ITEM	DESCRIPTION	U/M	QTY.	BID PRICE PER UNIT	TOTAL BID PRICE
18	520-1-10	Concrete Curb and Gutter, Type F	LF	35	\$	\$
19	536-73	Guardrail Removal	LF	1196	\$	\$
20	570-1-2	Performance Turf, Sod	SY	6584	\$	\$
21	630-1-12	Signals-Conduit, F & I Underground	LF	15	\$	\$
22	635-1-11	Pull & Junction Boxes, F & I, Pull Box	EA	1	\$	\$
23	660-2-106	Loop Detector, Inductive, F & I Type F	EA	2	\$	\$
24	700-20-40	Single Post Sign (Relocate)	AS	1	\$	\$
25		MISCELLANEOUS WORK AND CLEANUP	LS	1	\$	\$
		DISCRETIONARY WORK (ROADWAY)				\$52,500.00
		SUBTOTAL ROADWAY				\$
26		Steel Casing, 14" (Addendum #1)	LF	20	\$	\$
27		Steel Casing, 20" (Addendum #1)	LF	35	\$	\$
28		6" DIP Class 50 Watermain (RJ)	LF	35	\$	\$
29		6" 45 ° (degree) Bend	EA	4	\$	\$
		DISCRETIONARY WORK (UTILITIES)				\$2,000.00
		SUBTOTAL UTILITIES				\$
		TOTAL BID PRICE				\$

BIDDER _____

DATE _____

**BID FORM
SECTION 00300**

(Submit In Triplicate)

IFB# 09-2569-DS

(Page 1 of 2)

(ADDENDUM #1)

(ADDENDUM #2)

(Bid "B" - Based on Completion Time of 160 Calendar Days)

PROJECT NAME: <u>Canal Road Stormwater Piping from 24th St. East to 29th St. East</u>						
PROJECT NUMBER 6067300						
Item No.	FDOT ITEM	DESCRIPTION	U/M	QTY.	BID PRICE PER UNIT	TOTAL BID PRICE
1	101-1	Mobilization	LS	1	\$	\$
2	102-1	Maintenance of Traffic	LS	1	\$	\$
3	104-10-2	Synthetic Bales	LF	20	\$	\$
4	104-11	Floating Turbidity Barrier	LF	45	\$	\$
5	110-1-1	Clearing & Grubbing	LS	1	\$	\$
6	120-1	Regular Excavation (Addendum #1) (Addendum #2)	CY	5928	\$	\$
7	120-6	Embankment (Inc. final grading work) (Addendum #1) (Addendum #2)	CY	8118	\$	\$
8	285-705	Optional Base, Group 5 (Addendum #1)	SY	70	\$	\$
9	327-70-1	Milling Existing Asphalt Pavement, 1" (Addendum #1)	SY	94	\$	\$
10	334-1-11	Superpave Asphaltic Conc, Traffic A, SP-9.5 (Addendum #1)	TN	11.6	\$	\$
11	400-1-2	Concrete Class I, Endwalls	CY	11.6	\$	\$
12	400-1-15	Concrete Class I, Miscellaneous	CY	0.2	\$	\$
13	425-1-583	DBI Type H, J. Bot. <10', Mod	EA	7	\$	\$
14	425-2-71	MH, J-7, <10', Mod (Addendum #1)	EA	3	\$	\$
15	430-175-101	Pipe Culvert, RCP, 0-24"S/CD (Addendum #1)	LF	16	\$	\$
16	430-175-202	Pipe Culvert, ERCP, 25-36"S/CD (Addendum #1)	LF	34	\$	\$
17	430-175-203	Pipe Culvert, ERCP, 37-48"S/CD (Addendum #1)	LF	2590	\$	\$

BIDDER _____

DATE _____

**BID FORM
SECTION 00300**

(Submit in Triplicate)

IFB# 09-2569-DS

(Page 2 of 2)

(ADDENDUM #1)

(ADDENDUM #2)

(Bid "B" - Based on Completion Time of 160 Calendar Days)

PROJECT NAME: Canal Road Stormwater Piping from 24th St. East to 29th St. East PROJECT NUMBER 6067300						
Item No.	FDOT ITEM	DESCRIPTION	U/M	QTY.	BID PRICE PER UNIT	TOTAL BID PRICE
18	520-1-10	Concrete Curb and Gutter, Type F	LF	35	\$	\$
19	536-73	Guardrail Removal	LF	1196	\$	\$
20	570-1-2	Performance Turf, Sod	SY	6584	\$	\$
21	630-1-12	Signals-Conduit, F & I Underground	LF	15	\$	\$
22	635-1-11	Pull & Junction Boxes, F & I, Pull Box	EA	1	\$	\$
23	660-2-106	Loop Detector, Inductive, F & I Type F	EA	2	\$	\$
24	700-20-40	Single Post Sign (Relocate)	AS	1	\$	\$
25		MISCELLANEOUS WORK AND CLEANUP	LS	1	\$	\$
		DISCRETIONARY WORK (ROADWAY)				\$52,500.00
		SUBTOTAL ROADWAY				\$
26		Steel Casing, 14" (Addendum #1)	LF	20	\$	\$
27		Steel Casing, 20" (Addendum #1)	LF	35	\$	\$
28		6" DIP Class 50 Watermain (RJ)	LF	35	\$	\$
29		6" 45 ° (degree) Bend	EA	4	\$	\$
		DISCRETIONARY WORK (UTILITIES)				\$2,000.00
		SUBTOTAL UTILITIES				\$
		TOTAL BID PRICE				\$

BIDDER: _____ DATE _____