



MANATEE COUNTY  
FLORIDA

**FACSIMILE**

January 22, 2009

TO: All Interested Bidders

SUBJECT: Invitation for Bid #09-0250DC  
North Regional Water Reclamation Facility Influent Structure  
ADDENDUM #2

**Bidders are hereby notified that this Addendum shall be acknowledged on the Bid Form and made a part of the above named bidding and contract documents.**

The following items are issued to add to, modify, and clarify the bid and contract documents. These items shall have the same force and effect as the original bidding and contract documents, and cost involved shall be included in the bid prices. Bids to be submitted on the specified bid date, shall conform to the additions and revisions listed herein.

1. See attached information as prepared by URS Corporation, Project Engineer.
2. February 4, 2009, 5:00 P.M., has been set as the deadline for receipt of questions.

If you have submitted a bid prior to receiving this addendum you may request in writing that your original, sealed bid be returned to your firm. All sealed bids received will be opened on the date stated.

Bids will be received at Manatee County Purchasing, 1112 Manatee Avenue West, Suite 803, Bradenton, Florida 34205 until **February 19, 2009 at 3:00 P.M.**

Sincerely,

R.C. "Rob" Cuthbert, C.P.M.  
Purchasing Division Manager

/dcr  
Attachments

Financial Management Department - Purchasing Division  
1112 Manatee Avenue West, Suite 803, Bradenton, FL 34205  
PHONE: 941.749.3074 \* FAX: 941.749.3034  
[www.mymanatee.org](http://www.mymanatee.org)



# Memorandum

Date: January 16, 2008  
To: Deborah Carey-Reed, Manatee County Purchasing Department  
Cc: Chuck Froman, Manatee County Project Management  
From: Craig Osmanski, P.E. *CPO*  
Subject: **Text for Addendum No. 2  
IFB 09-0250DC, NWRf Influent Structure (6011281)**

## Permits

### **1. FDEP Wastewater Permit – Minor Revision to a Wastewater Facility**

**PA File Number:** FLA012617-020-DW1/MR

**Status:** Approved 10/16/08. Forwarded to Manatee Co. on 10/23/08

**Contractor Requirements to Obtain Permit:** None

**See attached Permit.**

### **2. Stormwater Permit – Environmental Resource Permit through FDEP**

**Application Number:** 41-0288451-001

**Status:** Approved 12/10/08. Forwarded to Manatee Co. on 12/23/08

**Contractor Requirements to Obtain Permit:** None

**See attached Permit.**

### **3. Manatee County Planning Department Final Site Plan**

**Application Number:** PDPI-04-30 / FSP-08-19

**Status:** Approved. Copies forwarded to Building Dep't 10/22/08. Copies forwarded to Manatee Co. 10/23/08.

**Contractor Requirements to Obtain Permit:** None

**See attached Permit.**

### **4. Manatee County Building Department Building Permit**

**Application Number:** 08100356

**Status:** Ready for Pick-Up. Status summary forwarded to Manatee Co. on 11/3/08

**Contractor Requirements to Obtain Permit:** Submit information and pay balance of fee (\$3,948.63).

**See attached permit status report from Manatee County Building Department Website.**

## On the Drawings

Sheet C-2. Add Note 4 as follows:

"4. Provide a minimum of 6 signs around the perimeter of the stormwater pond stating, "Stormwater Treatment Pond – no mowing or spraying of aquatic vegetation allowed unless authorized by FDEP. Call 813/632-7600 for more information" such that there is a sign posted a minimum of every 100 feet around the perimeter of the

URS Corporation  
7650 West Courtney  
Campbell Causeway  
Tampa, FL 33607-1462  
Tel: 813.286.1711  
Fax: 813.286.6587  
www.urscorp.com

pond. The signs shall be typical blank aluminum traffic sign including bolts, steel posts and any other necessary accessories. Sign shall have white background with minimum 1-inch high back reflective lettering."

Sheet C-3. Add Note 3 as follows:

"3. All new yard piping shall be restrained joint."

Sheet S-12, on Details "Ext. Mas. Jamb Detail" and "Ext. Mas. Head Detail", delete the word 'Stucco' in its entirety.

Sheet S-12, "Door Frame and Hardware Notes", delete the model number "295I" and replace with "290I".

Sheet M-2, Equipment List, Note 7.

Delete Note 7 in its entirety and replace with "7. Manual bar Screen (See Detail 1 on Sheet M-8)".

Sheet M-8, Detail 1, Manual Bar Screen.

After the "1/2" x 2 1/2" 316L stainless steel bar" callout, add "Bar spacing shall be 1-inch clear opening".

Sheet M-9, Detail 8, Watertight Cover Plate; Delete "Detail 8" in its entirety.

Sheet M-3, Delete "24" Magnetic Flow Meter" and replace with "Flowmeter Sensors (refer to specifications)".

Sheet M-4, Delete "24" Flow Meter" and replace with "Flowmeter Sensors (refer to specifications)".

Sheet M-7, Delete "24" Mag Meter" and replace with "Flowmeter Sensors (refer to specifications)".

Sheet M-8, Detail 12, Baffle Plate and Support; Delete "Detail 12" in its entirety and replace with new "Detail 12", attached.

Sheet M-9, Detail 8, Watertight Cover Plate; Delete "Detail 8" in its entirety.

### **In the Specifications**

Delete the "Table of Contents" and replace with new "Table of Contents", attached.

Section 01150, Measurement and Payment, 1.07 Bid Item 2.

Add the following:

"This Bid Item shall also include the fees for obtaining Building Permits. The Engineer pre-applied for the Manatee County Building Permit (Permit #08100356). The Manatee County Building Department review is complete and the remaining fee (\$3,948.63) and Contractor's information will be due at pick-up. The winning Contractor shall obtain the Building Permit for the North WRF Influent Structure from the Manatee County Building Department."

Section 02220, Excavation, Backfill, Fill and Grading for Structures, 1.02, A, 2.

Replace with:

"Compaction tests shall be taken every 1,000 square feet for the Influent Structure footprint."

Section 03180, Corrosion Resistant Polymer Lining.

Delete "Section 03180" in its entirety.

Section 05500, Miscellaneous Metals

Delete paragraph "2.04, L" in its entirety.

Section 07500, Membrane Roofing

Add new "Section 07500, Membrane Roofing", attached.

Section 09703, Protective Coatings

Paragraph 1.01, A; Delete in its entirety and replace with:

- "A. The Contractor shall furnish all labor, materials and equipment to apply a cured in place fiberglass liner system to the influent structure influent channel, screen channels (3), effluent boxes, effluent splitter box, RAS influent boxes (walls and bottom), grit unit (walls and bottom), and drain pump station interior walls and bottom."

Section 11295, Coplastic Stop, Slide and Weir Gates

Paragraph 1.01, A; at the end of the last sentence, add " , Plasti-Fab, Tualatin, Oregon or equal."

Paragraph 2.01, B; page 5, line 6, following "... support members only." , add new sentence:

"Or, the exterior material shall be a monolithic structure of fiberglass reinforced copolymer at least ¼-inch thick leaving no joints and entirely watertight."

Section 17010, Instrumentation.

Paragraph 1.01, D, 1. After "4-20 mA output" add, "to the SCADA Panel".

Paragraph 2.01, A. Delete "GE Panametrics AquaTrans AT 868 IP67/68"

Paragraph 2.01, F. Delete "36-inch" and replace with "24-inch."

### Questions

William W. Moore, Cardinal Contractors, Inc., 12/16/08

Question 1: Specification Page 05500-10 Paragraph 2.04(L) calls for aluminum floor plates and frames with 316 SS fasteners. On drawing S-1 the typical cover plate detail shows all items to be 316 SS with no fasteners. On drawing S-, detail "A" shows stainless steel cover plate. Drawing M-3 shows aluminum checkered cover plate. Drawing M-9 detail 8 shows aluminum diamond tread cover plate with fasteners. Please clarify if cover plate is to be aluminum or stainless steel and if fasteners are required.

Response 1: The channels, splitter box and RAS return channels covers shall be 3/8-inch thick checkered 316 stainless steel in accordance Sheet S-1.

Question 2: On drawing S-2 the door head and jamb details show stucco on the block wall. The typical wall section of the electrical room does not show any stucco. Please clarify if stucco is required as it is also not covered in the specifications.

Response 2: Delete all references to stucco on the block wall shown on Sheet S-12. There is no stucco work on this project.

Question 3: The typical wall section for the electrical room on sheet S-12 calls for waterproof cold-applied roof membrane. Please provide specifications for the roofing and whether or not any metal fascia will be required around the edges of the roof.

Response 3: Specification Section 07500, Membrane Roofing is attached and included as part of Addendum No. 1.

Mark Kelly, Encore Construction Company, 12/18/08

Question 1: Please provide a north-south section view of the grit chamber shown on S-16.

- Response 1: Section "C" on S-7 and Section "D" on S-8 provide north-south grit tank and headworks sections.
- Question 2: Please provide a Section view through column line C on sheet S-3  
Response 2: See answer to Encore Question 1 above.
- Question 3: Please clarify the dimensions of beam 6. The beam schedule on sheet S-13 shows the dimension as 24" x 24"/32".  
Response 3: See Sheet S-13: Beam B-6 (lower left hand corner of sheet) for beam layout.
- Question 4: On sheet S-3 there are two beams that do not have a designation on the schedule. These are the beams with the top of beam elevations 59.79. Please clarify the dimensions.  
Response 4: See Sheet S-11, Section "C" for dimensions.
- Question 5: On sheet S-4, along the edges of the slab at elevation 60.50 there is a 1/2 " gap. Is this gap intended to be an expansion joint? If so please clarify the limits as the 1/2" gap is also shown in locations that the cantilevered slab that do not abut any other structure.  
Response 5: It is a gap, not an expansion joint. A gap runs east-west along the tank wall and north-south along the tank flume.
- Question 6: Please provide the normal water levels in the channel and the grit tank.  
Response 6: Water elevations are shown on Sheet M-3.
- Question 7: Please provide a detail for the drain sump that is referred to on sheet S-6.  
Response 7: The catch basin is a FDOT Index 232, Type C Modified as shown on Sheet M-3.

Frank Rexford, Vogel Brothers, 1/7/09

- Question 1: Specification 03180 and 09703 Part 1, 1.01, A contain duplication of system applications. Please clarify.  
Response 1: Delete Specification Section 03180 in its entirety. The influent channel, screen channels (3), effluent boxes, effluent splitter box, RAS influent boxes (walls and bottom), grit unit (walls and bottom), and drain pump station interior walls and bottom shall be coated in accordance with Section 09703, Protective Coatings.

Eric Hutton, Dixie Metal, via Frank Rexford, Vogel Brothers

- Question 1: Manual Bar Screen/ Ref: Sheets M2 and M8. Please clarify the spacing required for the 1/2" x 2 1/2" bars.  
Response 1: Bar screen clear space opening shall be 1-inch.
- Question 2: Aluminum Stair Tower / Ref: Sheets M2, S14, and S15. No plan view or details showing how the tower ties into the top of the structure, please clarify.  
Response 2: The stairtower ties into the vertical face of concrete in accordance with Note 2 on Sheet S-14.
- Question 3A: Plate Cover / Ref: Sheets S5 and M3. Structural drawings call out the cover plates as stainless steel, but the mechanical drawings call them out as aluminum. Please clarify.  
Response 3A: The channels, splitter box and RAS return channels covers shall be 3/8-inch thick checkered 316 stainless steel in accordance with Sheet S-1.
- Question 3B: Sheet S5, grids A-B and 3-8; please confirm that these (6) areas also receive plate covers.  
Response 3B: Grids A-B and 3-8 shall have 316 stainless steel covers in accordance with Sheet S-1.

Melinda Lindsay, RTD, 1/9/09

Question 1: Is the checker plate aluminum or stainless steel? Drawing M-3 & M-4 shows aluminum and drawing S-5 shows stainless steel.

Response 1: The channels, splitter box and RAS return channels covers shall be 3/8-inch thick checkered 316 stainless steel in accordance with Sheet S-1 and S-5.

Question 2: For the checker plate do you want supports for the spans over 6'?

Response 2: All covers shall 316 stainless steel in accordance with Sheet S-1. Spans greater than 6 feet have supports in accordance with Sheet S-5.

Paul Rimel, C&B Piping Inc, 1/13/09

Question 1: Will you allow TR Flex, Filed Loc Gasket or Megalugs as a restraint system in lieu of harnassed restraint type with tie-rods for DI pipe and fittings for this project?

Response 1: All buried yard piping shall be restrained. Restrained joints shall be in accordance with Specification Section 02615, Ductile Iron Pipe and Fittings.

Mike Stensrud, Tnemec, 12/19/08 (as summarized by URS)

Question 1: Tnemec's products are specified in Section 09900 Heavy Duty Finishes. Section 09703 Protective Coatings specifies fiber reinforced lining. We would like to propose an alternate system for the severe Influent Structure Environment – Tnemec's Perma Shield System.

Response 1: Specification Section 09703 shall be as written. "Or Equal" manufacturers are acceptable.

Fred Trippensee, Trippensee & Company, Inc, 12/18/08 (as summarized by URS)

Question 1: Specification Section 14551, Shaftless Screw Conveyors and Appurtenances. We request that you add BioSec Enviro, Inc as an acceptable supplier.

Response 1: Specification Section 14551 shall be as written. "Or Equal" manufacturers are acceptable.

Paul Conner, L-3 Communication-Scandia Technologies, 1/9/09

Question 1: We would like clarification on the influent Transit Time Flowmeter. Specifications under Div 17010 reflect a transit time flowmeter to be furnished Page 17010-2 under Part 2 (2.01) and the transmitter on page 17010-3 is specified to be programmed for 36" ductile iron pipe. 2.01 (F). But there are some contract drawing issues: 1) drawing M-3 reflects a 24" magnetic flow meter, 2) drawing M-4 reflects a 24" flow meter and 24" spool, 3) drawing M-7 reflects a 24" mag meter. Drawing E-3 seems to reflect the two influent channels having dual sensors being tied back into a flow meter transmitter. This would confirm the transit time flowmeter. Can you confirm that both channels will be tied in and summed at the transmitter? Also please confirm the diameter 24" or 36" where the sensors will be mounted. This will require 4 sensors and mounting for both influent pipes. Which will also confirm the preprogrammed diameter. We would also like to know what the expected flowrate will be.

Response 1: The flow meter shall be transit time type (Eastech Badger Vantage 4400 or approved equal) in accordance with specification Section 17010, Instrumentation. For this project, sensors will be provided on only one influent pipe, per the Mechanical sheets. The conduit for future sensors shall be provided as shown on E-3. The influent pipe diameter for the flowmeter mounting is 24" per the Mechanical sheets. The peak future flowrate is 21.25 mgd per influent pipe. The current plant flowrate of 0 to 8 mgd will be delivered by the south influent pipe.

David Wilson, Universal Painting, 1/9/09

Question 1: Does the influent flume get coated with the same protective coating that the influent channels get?

Response 1: The influent channel, screen channels (3), effluent boxes, effluent splitter box, RAS influent boxes (walls and bottom), grit unit (walls and bottom), and drain pump station interior walls and bottom shall be coated in accordance with Section 09703, Protective Coatings.

John Opperman, TAW Control Systems & Automation, 1/13/09

Question 1: Are there enough tags on the existing Citect HMI license for this project or will it need to be upgraded?

Response 1: The SCADA Citect HMI software vendor has indicated that the site license was recently upgraded (summer 2008) from 1500 points to 5000 points. His recollection is that the site just went over the 1500 point count, so we believe there are more than enough available points to incorporate the new influent struction I/O points without further upgrade.

Jeff Berning, Reynolds, Inc., 1/13/09

Question 1: Section A1-A1 shown on plan sheet C-8 does not accurately portray what is shown on plan sheet C-2. The section on C-8 is showing concrete sloping upward on either side of the structure while C-2 shows this should be flat on either side of the structure. Please clarify the limits and dimensions on the 4" thick concrete pad around Control Structure ST-2.

Response 1: The limits shall be as shown on Sheet C-2.

Question 2: Plan sheet S-1. There is a note that states, All areas that convey/contain the wastewater shall have a stainless steel plate cover plate at their top to allow personnel access and to limit odor. The plans are vague in showing these plates. Is the thickness of all plates to be 3/8" as shown in section A on S-5? What type of stainless steel is required? Who is responsible for design of any intermediate support members? Please review and clarify.

Response 2: The channels, splitter box and RAS return channels covers shall be 3/8-inch thick checkered 316 stainless steel in accordance with Sheet S-1.

Question 3: Also on sheet S-16 & S-17, the grit tanks are shown, but no details for the cover plate are provided. Please advise.

Response 3: See Typical Cover Plate Bearing Detail on Sheet S-1.

Question 4: On sheet M-9, Detail #8, a watertight cover plate detail is shown. Does this detail apply to all cover plates and as discussed in question 2 & 3 above?

Response 4: No, See Typical Cover Plate Bearing Detail on Sheet S-1.

Question 5: Note 2 on S-6 limits us to 10' pour length on the elevated walkway at 56.50. Is this limitation on each individual pour or simply on control joints? Please clarify this intent of this requirement.

Response 5: The intent is to pour 10-foot long sections that are not adjacent to each other. The "infill" sections would then be constructed as per "Typical Construction Joints" on Sheet S-1.

Question 6: Section A/S-6 shows a footing elevation of 22.50 for the 2 - F4 footings. Are all other footings at elevation 26.00? Please clarify

Response 6: See Sheet S-2: "Footing Schedule" for elevations. Note that the top of the grit tank foundation is 27.50 and the top of the stair foundation is 27.96. The "PC" foundations have a top elevation of 26.00.

- Question 7: Plan sheet S-2, note 7. Please clarify the intent of this note  
Response 7: The slab-on-grade construction is a series of 1'-9" x 3'-9" rectangles. Filling in the area between column line "8" (or "2") and the exterior face of the grit tanks.
- Question 8: Plan sheets S-6, 9, 10 & 16 shows 18" piles, however I do not see a specification section on the piling. I assume we bid 40 ft piles and any piles in excess of this will be handled by a change order? Please provide a specification for the piling.  
Response 8: See Sheet S-1: Typical augered cast-in-place detail, for information regarding piling.
- Question 9: Plan Sheet S-9 appears to show 3 piles below the center foundation. The plan views do not show any piles here. Please clarify.  
Response 9: Provide piles as per detail "PC6" on Sheet S-10.
- Question 10: Plan sheet S-3, note 3 states we cannot pour the elevated slabs until the supporting beams have reached 100% design strength. Does this apply even if the shoring is left in place? This could affect the schedule. Especially for the 300 day schedule.  
Response 10: A shoring design, signed and sealed by a Florida P.E., that takes into account all the beam, slab, and applied construction loads would be acceptable to URS. URS would still prefer the beam and slab be separate pours, except as noted in the plans.
- Question 12: Plan sheet S-5, Are the cap slabs between the screen channels placed over stone fill or stay-in-place forms?  
Response 12: See Sheet S-4: Note 1, for abandoning formwork in-place. Do not use stone fill or sand fill.
- Question 13: Typical Wall Section on plan sheet S-12. I see no specs for the cold-applied roof membrane on the roof of the electrical room. Please provide.  
Response 13: Specification Section 07500, Membrane Roofing is attached and included as part of Addendum No. 1.
- Question 14: Plan Sheet S-12 calls for a model 295I flush aluminum door by Alutech. They have no such model. Perhaps this should be a model 290I, the specs for the 290I match the specs on the S-12. Please verify.  
Response 14: Change Model 295I to read 290I. See Sheet S-12: "Frame Elevation," for information regarding wind load capacity, that any Alutech door (or approved equal) must meet.
- Question 15: Plan sheet S-2 show the electrical room door as Left Hand Reverse swing but section A/S-6 shows the door handle on the left side of the door. Please clarify.  
Response 15: Sheet S-2 is correct.

Eric Hutton, Dixie Metal, via Frank Rexford, Vogel Brothers, 1/14/09

- Question 1: Aluminum Baffle Plates / Ref sheets M2, M6, and M8: Detail on sheet M8 says 5' x ? x ¼", M6 indicates 2'10" wide and terminating at the stop plate, M2 shows it being the full 72' length of the channel. Please clarify.  
Response 1: Delete Detail 12 on Sheet M-8 and replace with new Detail 12, attached.
- Question 2: Aluminum Baffle Plates / Ref sheets M2, M6, and M8: What is the size of the aluminum I-Beam support post?  
Response 2: Delete Detail 12 on Sheet M-8 and replace with new Detail 12, attached.

William W. Moore, Cardinal Contractors, Inc., 1/14/09



Question 1: In reference to question #1 in our previous RFI dated December 16, 2008 regarding what type of material the cover plates are made of we have an additional question. Our supplier has pointed out that no details are provided on the drawings for stiffener bars to be welded to the plates as some of them span up to 6'. Please advise if any stiffeners will be required and if so please provide details of the stiffeners.

Response 1: The channels, splitter box and RAS return channels covers shall be 3/8-inch thick checkered 316 stainless steel in accordance with Sheet S-1.

Question 2: We also wish to point out the following discrepancy. Spec. Section 03180 covers "Corrosion Resistant Polymer Lining" for various areas of the headworks. Spec Section 09703 "Protective Coatings" calls for cured in place fiberglass liner system in the headworks. Please advise which system should be used in our bid.

Response 2: Delete Specification Section 03180 in its entirety. The influent channel, screen channels (3), effluent boxes, effluent splitter box, RAS influent boxes (walls and bottom), grit unit (walls and bottom), and drain pump station interior walls and bottom shall be coated in accordance with Section 09703, Protective Coatings.

Mark J Heath, TLC Diversified, 1/14/09

Question 1: Sheet S-13, please clarify under the beam reinforcement schedule for the top reinforcement, this is usually Top and Bottom, what is Top Right-Left mean?

Response 1: Beam callouts are from the left to right and bottom to top of Sheet S-3. For left to right callouts, the top reinforcing bars run from left to right on the sheet. For bottom to top sheet callouts, the top reinforcing bars run from bottom to top on the sheet.

Mark Kelly, Encore Construction Company, 1/15/09

Question 1: Please provide the spacing require for the 1/2" x 2 1/2" Manual Screen shown on Sheet M-2 and Detail 1 on Sheet M-8.

Response 1: Bar screen clear space opening shall be 1-inch.

Question 2: There is no plan view or detail showing how the aluminum stair tower, shown on M-2, S-14 and S-15, ties into the top of the structure can be found. Please clarify.

Response 2: The staitower ties into the vertical face of concrete in accordance with Note 2 on Sheet S-14.

Question 3: In regards to the plate covers shown on S-5 and M-3, the structural drawings call out the cover plates as stainless steel, but the mechanical drawings call out aluminum. Please clarify. Additionally, on Sheet S-5, grids A-B and 3-9, please confirm that these six (6) areas also receive plate covers.

Response 3: The channels, splitter box and RAS return channels covers shall be 3/8-inch thick checkered aluminum plate in accordance with the Mechanical sheets and Specification Section 05500. Grids A-B and 3-8 shall have 316 stainless steel covers.

Question 4: In regards to the Aluminum Baffle Plates shown on M-2, M-6 and M-8, the detail shown on M-8 says 5' x ? x 1/4"; sheet M-6 indicates 2'10" wide and terminating at the stop plate; and sheet M-2 shows it being the full 72' length of the channel. Please clarify.

Response 4: See Revised Detail 12, attached. The baffle plate runs the entire width of the channel.

Question 5: There are three (3) stop gates noted on sheet M-2, however, there are no details to indicate material or construction. Please clarify.

Response 5: See specification Section 11295.

Paul Conner, L-3 Communication-Scandia Technologies, 1/15/09

Question 1: We need to know the SCADA system manufacturer and version number.

How many tag capability does it have?

What percentage is used?

How many computers and monitors are involved?

Response 1: The SCADA Citech HMI software vendor has indicated that the site license was recently upgraded (summer 2008) from 1500 points to 5000 points. His recollection is that the site just went over the 1500 point count, so we feel there are more than enough available points to incorporate the new influent structure I/O points without further upgrade.  
The original McKim & Creed construction drawings for the SCADA system show two workstations.

**PERMIT DETAILS**

Detailed information for permit 08100356 is shown directly below, contractor information is listed at the bottom of the page. Information regarding plans review, inspections, permit issue status and the certificate issue status can be found by following the links in the left navigation bar.

Permit Number:	08100356
Parcel ID:	655700109
Section:	26
Township:	33S
Range:	18E
Zoning/Overlay:	PDPI/MULTIPLE
Flood Zone:	Ae+
Fire District:	North River Fire Dept
Owner:	Manatee County
Address:	8500 69th St E
*Prime Contractor:	MC00000-- To Be Determined
Permit Type:	Commercial
Application Date:	Oct 14, 2008
Issue Date:	
Cert. Occupancy or Cert. Completion Date:	
Certificate Type:	No Certificate Type Found
Target Date:	Nov 19, 2008 <u>Current Review Time</u>
Status:	Open
Declared Value:	\$5,000,000.00
Source:	Tresun
Comments:	Flood:Influent Struct.I.E. Headworks @ CountyWastewater Treatment Plant*Setbacks Per Pdpi-04-30/Fsp-08-19N.Regional Water Recl.Facility
<b>Note: If source is Supermit these are legacy permits and have incomplete data</b>	

**PERMIT ISSUE STATUS**

The permit will only be issued when the required fees are paid, all plan stops have been approved and the necessary documentation has been submitted and accepted. To verify all plan stops have been approved select the button labeled "Plan Check" on the left navigation bar.

**Permit Information**

Permit Number 08100356  
 Permit Status Code Open  
 Permit Owner Manatee County  
 Permit Address 8500 69th St E

3 current holds found, displaying all current holds.

**Current Holds**

Hold Reason and Contact Information	Event	Operator	Date
Need Gc On Permit	P	cblake	Oct 27, 2008
Need Elec/Plmb/Concrete Subs	P	cblake	Oct 27, 2008
Contact Ken Labarr @ 749-3070	C	ebarker	Oct 27, 2008

2 released holds found, displaying all released holds.

**Released Holds**

Reason	Released By	Event
Jim Staples S/O In Comm. Drawer	Cblake	Permit
Health Hold For Plan Review	Cherry	Certificate

4 permit fees found, displaying all permit fees.

**Permit Fees**

Fee ID	Fee Description	Fee Total	Paid To Date	Permit Balance Due	Certificate Balance Due
EC	ELEVATION CERTIFICATE	\$50.00	\$0.00	\$50.00	\$50.00
FMP	FLOOD MANAGEMENT FEE	\$731.00	\$0.00	\$731.00	\$731.00
NEW COMM	NEW CONSTRUCTION - COMM	\$5,006.38	\$1,275.21	\$3,731.17	\$3,731.17
RADON FEE	RADON	\$94.46	\$0.00	\$94.46	\$94.46
<b>Totals:</b>		<b>\$5,223.84</b>	<b>\$1,275.21</b>	<b>\$3,948.63</b>	<b>\$3,948.63</b>

**PLANS REVIEW**

Permits will only be issued when the appropriate plan stops have been approved, required fees are paid, and the necessary documentation has been submitted and accepted. To verify fees due, select the button labeled "Permit Issue" above.

**Permit Information**

Permit Number 08100356  
 Permit Status Code Open  
 Permit Owner Manatee County  
 Permit Address 8500 69th St E

13 plan reviews found, displaying all plan reviews.

**Plan Check**

Review Stop & Number	Status	Received Date	Completed Date	Notes
Permitting Revision 1	Approved	Oct 14, 2008	Oct 14, 2008	
Zoning Revision 1	Approved	Oct 15, 2008	Oct 27, 2008	
Infrastructure-6th Ave E Revision 1	Not Required	Oct 28, 2008	Oct 28, 2008	
Health Department Revision 1	Approved	Oct 16, 2008	Oct 21, 2008	
Fire Department Revision 1	Approved	Oct 23, 2008	Oct 23, 2008	
Impact Fees Revision 1	Approved	Oct 15, 2008	Oct 27, 2008	
Utilities Revision 1	Not Required	Oct 28, 2008	Oct 28, 2008	
Floodplain Management Revision 1	Approved	Oct 15, 2008	Oct 21, 2008	
Plans Review Revision 1	Approved	Oct 23, 2008	Oct 23, 2008	
Electrical Review Revision 1	Approved	Oct 24, 2008	Oct 24, 2008	
Plumbing Review Revision 1	Approved	Oct 22, 2008	Oct 22, 2008	
In Tracking Revision 1	Approved	Oct 27, 2008	Oct 28, 2008	
Ready For Issuance Revision 1	Approved	Oct 28, 2008	Oct 28, 2008	

Thank you for using the Manatee County Permitting System. If you have any questions on this permit for:

- Driveway (Infrastructure): (941) 708-7483
- Health Dept: (941) 748-0747
- Environmental Mngt: (941) 742-5980
- Impact Fee: (941) 749-3070
- Planning: (941) 749-3070
- Plans Review: (941) 749-3078
- Zoning/Setbacks: (941) 749-3078



# MANATEE COUNTY GOVERNMENT

PLANNING DEPARTMENT  
"TO SERVE WITH EXCELLENCE"

---

September 12, 2008

Manatee County Government  
1112 Manatee Avenue West  
Bradenton, Florida 34205

RE: North County Wastewater Treatment Plant Influent Structure  
PDPI-04-30/FSP-08-19  
DTS#:20080191  
Sec. 26 Twp. 33 Rge. 18  
DPID#655700109  
Setbacks: See Site Plan  
Zoning: PDPI  
FLUC:PSP  
Proposed Use: New Influent Structure, headworks & driveway extension  
Special Conditions: n/a

Dear Sir:

This Final Site Plan has been reviewed by the appropriate reviewing agencies and is found to be in compliance with the Manatee County Land Development Code (LDC) and Comprehensive Plan.

This approval shall expire **September 12, 2012**. This application is approved by the Planning Director under the provisions of LDC Section 508.8.1.3.

Please note that in addition to the approved application, a valid Certificate Level of Service (CLOS) is required pursuant to LDC Section 510. The CLOS expiration date for this application is (9/12/12).

**Building permits shall be obtained prior to the expiration of a CLOS or the Final Site Plan, whichever occurs first.**

Construction associated with issued building permit(s) may continue to completion after Final Site Plan and CLOS expirations if the building permit(s) remain valid and do not expire.

In the event the CLOS expires prior to the expiration date of the Final Site Plan, a new

traffic study must be approved prior to the issuance of any building permits.

Approval is based on the following conditions and requirements stipulated by the respective departments:

The Inspection Department shall be notified 48 hours prior to commencement of construction. Please contact Inspection Services at 748-4501 extension 3335.

**A. Manatee County Plan Implementation Division:**

1. There shall be six (6) inch vertical curb around all landscape islands and abutting all landscape areas not protected by wheelstops. This shall be installed prior to issuance of a C.O. or T.C.O for this project.
2. Extension of the main driveway shall be completed prior to either a Certificate of Occupancy or Certificate of Completion, whichever is applicable.

If there are any questions pertaining to the planning conditions, please contact Laurie Suess, Principal Planner, Plan Implementation Division, at (941) 749-3070, extension 6885.

**B. Concurrency/Transportation/Planning:**

1. Applications for Certificate of Level of Service Compliance for potable water, sanitary sewer, solid waste, transit, drainage, fire flow and traffic have been approved.

If there are any questions pertaining to concurrency and/or transportation, please contact Susan Barfield at 749-3070 extension 3842.

**C. Utilities/Access/Drainage/Planning:**

1. Certification(signed and sealed) for CO release shall be submitted to Ken LaBarr with the Planning Department once the project is 100% complete and meets substantial compliance with the approved plans. This certification shall include all Site Plan requirements including but not limited to Right of Way and easement dedications, confirmation of As Built drawing submittal to the SWFWMD and all associated required



improvements. A Final Zoning Inspection will be completed within 48 hours. (two working days) If inadequate, a Deficiency Notice will be forwarded to the Engineer of record and or the owner noting same. Certifications listing outstanding construction or substantial deviations are considered STATUS/PROGRESS reports.

**NOTE: Any changes to existing approved plans must be re-submitted through the review process for acceptance and revised Construction Plans must be submitted to this office for approval.**

If there are any questions please contact Ken LaBarr, Zoning Inspector, at (941) 749-3070, extension 6840.

**D. Manatee County Health Department:**

1. No comment.

If there are any questions pertaining to the Health Department conditions, please contact Terri Stripling, Environmental Specialist II, at (941) 748-0747, extension 1415.

**E. Fire Protection Requirements:**

1. No objection.

The proposed project is located within the jurisdiction of the North River Fire District and the contact person is Ron Cales (Tel:721-6700).

You are advised that the fire district is involved in the review and approval process including a final inspection prior to the issuance of a Certificate of Occupancy. It is the applicant's responsibility to contact the above reference fire district to obtain the specific fire protection requirements for this project.

You are advised that the Fire District collects fees for all new construction. Those districts collect their fees individually. Please contact them for information. These fees must be paid prior to issuance of a building permit.

**F. Environmental Planning Division:**

1. Erosion and Sediment Control devices shall be installed as detailed on the approved plan. Construction Plans, ERP and NPDES permit approvals must be obtained prior to commencement of construction. Additional sediment and erosion control (S&EC) devices may be required at the discretion of the Planning Department's Environmental Planning Division where necessary to prevent adverse stormwater run-off during site construction.

If there are any questions pertaining to the Environmental Planning Division conditions, please contact Dorothy Rainey at (941) 749-3070.

The application for a building permit constitutes an agreement on the part of the owner to abide by all of the foregoing conditions and stipulations. Furthermore, it will be necessary for the engineer and/or architect of record to certify that all site improvements as approved have been completed prior to the issuance of a Certificate of Occupancy (C.O.). All improvements and structures must be installed per the approved Final Site Plan. Any deviations to the approved Final Site Plan must be submitted as a Revised Final Site Plan in accordance with section 508.S.4.(3) of the LDC. In no case shall the Final Site Plan approval exceed the date set forth on the approved Level of Service (LOS) Certificate.

Please be aware that structures existing on the site that are to remain should be indicated as such on the Final Site Plan. Existing structures not shown on the plan or indicated on the plan to be removed, shall be removed prior to issuing a C.O. unless otherwise provided for in the approval of the Final Site Plan.

The issuance of a C.O. is dependent on reaching the minimum improvements indicated on the Final Site Plan. Stipulations that condition to the C.O. must be approved in writing by the respective department, prior to the C.O. being issued.

The issuance of a Final Acceptance is dependent on reaching the minimum improvements indicated on the plan. Stipulations that condition the Final Acceptance must be approved in writing by respective department, prior to the Final Acceptance being issued.

You may not apply for nor shall Manatee County issue any Building Permits for this project after expiration of this approval as stated on Page 1 of this letter. This regulation supersedes the prior policy of issuing permits within one year of the most recent Certificate of Occupancy. To complete the project you must obtain all permits prior to expiration of this approval. Manatee County shall not extend this approval nor,

Influent Structure @ NWWTP  
PDPI-03-30/FSP-08-19  
September 12, 2008  
Page 5

after this approval's expiration, renew any expired or invalidated permit. Failure to meet deadlines for progressive development, inspections, completion, and occupancy certification after this approval's expiration may result in the loss of development rights.

Manatee County shall not extend this approval nor, after this approval's expiration, renew any expired or invalidated permit. Failure to meet deadlines for progressive development, inspections, completion, and occupancy certification after this approval's expiration may result in the loss of development rights.

**A copy of this letter, signed by the property owner/developer/agent, and an Erosion and Sediment Control Plan (ESCP), must be presented when applying for a building permit along with the approved plan.**

Sincerely,

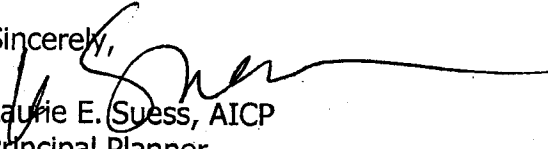

Laurie E. Suess, AICP  
Principal Planner  
Plan Implementation Section

LES/lis  
Attachment

cc: Property Owner  
RC Members  
Fire Chief  
Records Management

I have read and understand this letter and agree to the conditions and regulations herein.

10/22/08  
Date

G.P. [Signature]  
Property Owner/Agent



# Florida Department of Environmental Protection

Southwest District Office  
13051 North Telecom Parkway  
Temple Terrace, Florida 33637-0926

Charlie Crist  
Governor

Jeff Kottkamp  
Lt. Governor

Michael W. Sole  
Secretary

Mr. Wayne Roberts, P.E., Deputy Director  
Manatee County Project Management  
Public Works  
1026 26<sup>th</sup> Avenue East  
Bradenton, Florida 34208

**DEC 17 2008**

Dear Mr. Roberts:

Enclosed is the Environmental Resource Permit, FDEP Project No. 41-0288451-001 issued pursuant to part IV of Chapter 373, Florida Statutes, and Title 62 Florida Administrative Code.

Appeal rights for you and for any affected third party are described in the text of the Permit along with conditions, which must be met when authorized activities are undertaken.

You, as the applicant, are responsible for all aspects of permit compliance. You should therefore review this permit document carefully to ensure compliance with the general conditions and specific conditions contained herein. You should, therefore, review this permit document carefully to ensure compliance with the 25 General Conditions and 22 Specific Conditions contained therein.

Contact the Department's Industrial Wastewater Section in writing for a permitting determination prior to discharging produced ground water from any construction dewatering activity. The discharge may require a separate Industrial Wastewater permit.

The issuance of this Environmental Resource Permit does not constitute the review or approval of a NPDES Stormwater permit or Pollution Prevention Plan. Construction activities that disturb more than one (1) acres of land are required to obtain a NPDES permit. The Permittee is advised to contact the Department's NPDES stormwater program at (850) 245-7522 prior to the commencement of any construction.

If you have any questions about this document, please contact me at (813) 632-7600, ext. 398.

Thank you for your participation in the permit process and in managing the natural resources of the State of Florida.

Sincerely,

Dennis Pierson  
Environmental Resource Permitting

Enclosure: Environmental Resource Permit Number 41-0288451-001 (15 pages), with attachments.



# Florida Department of Environmental Protection

Southwest District Office  
13051 North Telecom Parkway  
Temple Terrace, Florida 33637-0926

Charlie Crist  
Governor

Jeff Kotkamp  
Lt. Governor

Michael W. Sole  
Secretary

## ENVIRONMENTAL RESOURCE PERMIT

PERMITTEE/AUTHORIZED ENTITY:  
Mr. Wayne Roberts, P.E., Deputy Director  
Manatee County Project Management  
Public Works  
1026 26<sup>th</sup> Avenue East  
Bradenton, Florida 34208

Permit Number: 41-0288451-001

Date of Issue: **DEC 10 2008**

Expiration Date of Construction Phase:

County: Manatee **DEC 10 2013**

Project: Surface Water Management  
System for the Influent Structure  
at the North Water Reclamation  
Facility

---

This project requires a Standard General Permit. The Department has the authority to issue this permit per the following references:

Part IV of Chapter 373, Florida Statutes  
Chapter 62-330 and 62-343, Florida Administrative Code  
Operating Agreements with the water management districts in Chapter 62-113, Florida  
Administrative Code

This permit also constitutes certification compliance with water quality standards under Section 404 of the Clean Water Act, 33 U.S.C. 1344.

As staff to the Board of Trustees, the Department has reviewed the activity described below, and has determined that the activity is not on state-owned submerged lands. Therefore, your project is exempt from the further requirements of Chapter 253, Florida Statutes.

This permit is subject to the limits, conditions, and locations of work shown in the attached drawings, and is also subject to the attached 25 General Conditions and 21 Specific Conditions, which are a binding part of this permit. You are advised to read and understand these drawings and conditions prior to commencing the authorized activities, and to ensure the work is conducted in conformance with all the terms, conditions, and drawings. If you are utilizing a contractor, the contractor also should read and understand these drawings and conditions prior to commencing the authorized activities. Failure to comply with all drawings and conditions shall constitute grounds for revocation of the permit and appropriate enforcement action.

Operation of the facility is not authorized except when determined to be in conformance with all applicable rules and with the general and specific conditions of this permit / certification / authorization, as specifically described below.

You are hereby advised that authorizations also may be required by other federal, state, and local entities. This authorization does not relieve you from the requirements to obtain all other required permits and authorizations.

#### **SPGP REVIEW – NOT APPROVED**

A copy of this authorization has also been sent to the U.S. Army Corps of Engineers (USACOE) for review. The USACOE may require a separate permit. Failure to obtain this authorization prior to construction could subject you to enforcement action by that agency.

#### **ACTIVITY DESCRIPTION:**

This project is to construct a wet detention surface water management system (SWMS) to serve a 2.47 acre site with 0.49 acres of impervious surface at the North Water Reclamation Facility. Runoff from a new headworks building, an existing emergency generator building, a new asphalt drive, and associated green space will be conveyed to a wet detention via a two-foot wide concrete drop curb and gutter inlet on the west side of the access drive. The remaining 1.58 acres within the project area is mostly green space and will remain undisturbed. A v-swale will be added to this greenspace area to maintain the existing flow pattern. The wet detention pond will measure 0.39 acres at top of bank and is encircled by a berm. The pond will treat the first one inch of runoff from the project area and attenuate the discharge rate from a 24-hr / 25-yr storm. Treated surface water runoff will discharge from the pond through a skimmer-equipped control structure to the adjacent Wade Canal. The pond berm and road fill encroach into a 100 year flood plain. Flood plain compensation for the encroachment is provided in the pond.

No impacts to wetlands or other surface waters are proposed or authorized by this permit.

The facility project plans are shown on the attached drawings that are respectively entitled "Overall Site Plan (Sheet C-1)", "Paving, Grading and Drainage (Sheet C-2)", "Yard Piping Plan (Sheet C-3)", "Detail Yard Piping Plan (Sheet C-4)", "Erosion Control Details (Sheet C-7)", and "Civil Details (Sheets C-6 and C-8)". The drawing set was prepared by URS. Sheets C-1, C-3, C-4, and C-8 were received by the Department on May 8, 2008, Sheets C-2 and C-6 were received August 11, 2008, and Sheet C-7 was received on December 5, 2008.

## **ACTIVITY LOCATION:**

The project site is located at 8500 69<sup>th</sup> Street East, Palmetto, Section 26, Township 33 South, Range 18 East, Manatee County.

## **GENERAL CONDITIONS:**

1. All activities shall be implemented as set forth in the plans, specifications and performance criteria as approved by this permit. Any deviation from the permitted activity and the conditions for undertaking that activity shall constitute a violation of this permit.
2. This permit or a copy thereof, complete with all conditions, attachments, exhibits, and modifications, shall be kept at the work site of the permitted activity. The complete permit shall be available for review at the work site upon request by Department staff. The permittee shall require the contractor to review the complete permit prior to commencement of the activity authorized by this permit.
3. Activities approved by this permit shall be conducted in a manner, which does not cause violations of state water quality standards. The permittee shall implement best management practices for erosion and a pollution control to prevent violation of state water quality standards. Temporary erosion control shall be implemented prior to and during construction and permanent control measures shall be completed within 7 days of any construction activity. Turbidity barriers shall be installed and maintained at all locations where the possibility of transferring suspended solids into the receiving waterbody exists due to the permitted work. Turbidity barriers shall remain in place at all locations until construction is completed and soils are stabilized and vegetation has been established. Thereafter the permittee shall be responsible for the removal of the barriers. The permittee shall correct any erosion or shoaling that causes adverse impacts to the water resources.
4. Water quality data for the water discharged from the permittee's property or into the surface waters of the state shall be submitted to the Department as required by the permit. Analyses shall be performed according to procedures outlined in the current edition of Standard Methods for the Examination of Water and Wastewater by the American Public Health Association or Methods for Chemical Analyses of Water and Wastes by the U.S. Environmental Protection Agency. If water quality data are required, the permittee shall provide data as required on volumes of water discharged, including total volume discharged during the days of sampling and total monthly volume discharged from the property or into surface waters of the state.

5. Department staff must be notified in advance of any proposed construction dewatering. If the dewatering activity is likely to result in offsite discharge or sediment transport into wetlands or surface waters, a written dewatering plan must either have been submitted and approved with the permit application or submitted to the Department as a permit prior to the dewatering event as a permit modification. The permittee is advised that the rules of the Southwest Florida Water Management District state that a water use permit may be required prior to any use exceeding the thresholds in Chapter 40D-2, F.A.C.
6. Stabilization measures shall be initiated for erosion and sediment control on disturbed areas as soon as practicable in portions of the site where construction activities have temporarily or permanently ceased, but in no case more than 7 days after the construction activity in that portion of the site has temporarily or permanently ceased.
7. Off site discharges during construction and development shall be made only through the facilities authorized by this permit. Water discharged from the project shall be through structures having a mechanism suitable for regulating upstream stages. Stages may be subject to operation schedules satisfactory to the Department.
8. The permittee shall complete construction of all aspects of the surface water management system, including wetland compensation (grading mulching, planting), water quality treatment features, and discharge control facilities prior to beneficial occupancy or use of the development being served by this system.
9. The following shall be properly abandoned and/or removed in accordance with the applicable regulations:
  - a. Any existing wells in the path of construction shall be properly plugged and abandoned by a licensed well contractor.
  - b. Any existing septic tanks on site shall be abandoned at the beginning of construction.
  - c. Any existing fuel storage tanks and fuel pumps shall be removed at the beginning of construction.
10. All surface water management systems shall be operated to conserve water in order to maintain environmental quality and resource protection; to increase the efficiency of transport, application and use; to decrease waste; to minimize unnatural runoff from the property and to minimize dewatering of offsite property.
11. At least 48 hours prior to commencement of activity authorized by this permit, the permittee shall submit to the Department a written notification of commencement using an "Environmental Resource Permit Construction Commencement" notice (Form No. 62-343.900(3), F.A.C.) indicating the actual start date and the expected completion date.



12. Each phase or independent portion of the permitted system must be completed in accordance with the permitted plans and permit conditions prior to the occupation of the site or operation of site infrastructure located within the area served by that portion or phase of the system. Each phase or independent portion of the system must be completed in accordance with the permitted plans and permit conditions prior to transfer of responsibility for operation and maintenance of that phase or portion of the system to a local government or other responsible entity.
13. Within 30 days after completion of construction of the permitted activity, the permittee shall submit a written statement of completion and certification by a registered professional engineer or other appropriate individual as authorized by law, utilizing the required "Environmental Resource Permit As-Built Certification by a Registered Professional" (Form No. 62-343.900(5), F.A.C.), and "Request for Transfer of Environmental Resource Permit Construction Phase to Operation Phase" (Form 62-343-900(7), F.A.C.). Additionally, if deviation from the approved drawings is discovered during the certification process a copy of the approved permit drawings must accompany the certification with deviations noted.
14. This permit is valid only for the specific processes, operations and designs indicated on the approved drawings or exhibits submitted in support of the permit application. Any substantial deviation from the approved drawings, exhibits, specifications or permit conditions, including construction within the total land area but outside the approved project area(s), may constitute grounds for revocation or enforcement action by the Department, unless a modification has been applied for and approved. Examples of substantial deviations include excavation of ponds, ditches or sump areas deeper than shown on the approved plans.
15. The operation phase of this permit shall not become effective until the permittee has complied with the requirements of the conditions herein, the Department determines the system to be in compliance with the permitted plans, and the entity approved by the Department accepts responsibility for operation and maintenance of the system. The permit may not be transferred to the operation and maintenance entity approved by the Department until the operation phase of the permit becomes effective. Following inspection and approval of the permitted system by the Department, the permittee shall request transfer of the permit to the responsible operation and maintenance entity approved by the Department, if different from the permittee. Until a transfer is approved by the Department pursuant to Section 62-343.110(1)(d), F.A.C., the permittee shall be liable for compliance with the terms of the permit.
16. Should any other regulatory agency require changes to the permitted system, the Department shall be notified of the changes prior to implementation so that a determination can be made whether a permit modification is required.

17. This permit does not eliminate the necessity to obtain any required federal, state, local and special district authorizations including a determination of the proposed activities' compliance with the applicable comprehensive plan prior to the start of any activity approved by this permit.
18. This permit does not convey to the permittee or create in the permittee any property right, or any interest in real property, nor does it authorize any entrance upon or activities on property which is not owned or controlled by the permittee, or convey any rights or privileges other than those specified in the permit and Chapter 40D-4 or Chapter 40D-40, F.A.C.
19. The permittee is hereby advised that Section 253.77, F.S., states that a person may not commence any excavation, construction, other activity involving the use of sovereign or other lands of the state, the title to which is vested in the Board of Trustees of the Internal Improvement Trust Fund without obtaining the required lease, license, easement, or other form of consent authorizing the proposed use. Therefore, the permittee is responsible for obtaining any necessary authorizations from the Board of Trustees prior to commencing activity on sovereignty lands or other state-owned lands.
20. The permittee shall hold and save the Department harmless from any and all damages, claims, or liabilities which may arise by reason of the activities authorized by the permit or any use of the permitted system.
21. Any delineation of the extent of a wetland or other surface water submitted as part of the permit application, including plans or other supporting documentation, shall not be considered binding unless a specific condition of this permit or a formal determination under section 373.421(2), F.S., provides otherwise.
22. The permittee shall notify the Department in writing within 30 days of any sale, conveyance, or other transfer of ownership or control of the permitted system or the real property at which the permitted system is located. All transfers of ownership or transfers of a permit are subject to the requirements of section 62-343.130, F.A.C. The permittee transferring the permit shall remain liable for any corrective actions that may be required as a result of any permit violations prior to such sale, conveyance or other transfer.
23. Upon reasonable notice to the permittee, Department authorized staff with proper identification shall have permission to enter, inspect, sample and test the system to insure conformity with Department rules, regulations and conditions of the permits.
24. If historical or archaeological artifacts are discovered at any time on the project site, the permittee shall immediately notify the Department and the Florida Department of State, Division of Historical Resources.

25. The permittee shall immediately notify the Department in writing of any previously submitted information that is later discovered to be inaccurate.

**SPECIFIC CONDITIONS:**

1. The permittee shall notify the Department in writing at least 48 hours prior to commencing the work authorized in this permit (see General Condition #11).

2. All submittals required herein shall be directed to:

Department of Environmental Protection  
Environmental Administrator  
Submerged Lands & Environmental Resources  
Southwest District  
13051 North Telecom Parkway  
Temple Terrace, Florida 33637-0926

hereafter referred to as "the Department". Such submittals include, but are not limited to, record drawings, progress reports, mitigation monitoring reports and water quality monitoring reports. All submittals shall include the permittee's name and permit number.

3. The permittee shall be aware of and operate under number 1 through 25 of the aforementioned "General Conditions". The General Conditions are binding upon the permittee and enforceable pursuant to Chapter 403 of the Florida Statutes.
4. The structure/work authorized by this permit shall not be placed/conducted on any property, other than that owned by the permittee, without the prior written approval of that property owner.
5. In the event that the permittee files for bankruptcy prior to completion of all work permitted and required by this permit, the permittee must notify the Department within 30 days of filing. The notification shall identify the bankruptcy court and case number and shall include a copy of the bankruptcy petition.
6. Subsequent to the selection of the contractor to perform the authorized activity and prior to the initiation of work authorized by this permit, the permittee, (or authorized agent) and the contractor, shall attend a pre-construction conference with a representative of the Department's Submerged Lands and Environmental Resources staff. The permittee shall notify the Department in writing subsequent to contractor selection to request scheduling of the subject conference.

7. Progress reports for the project shall be submitted to the Department beginning April 1, 2009, and shall continue to be submitted quarterly until construction of the permitted project is completed. The cover page shall indicate the permit number, project name and the permittee name. Progress reports must be submitted to the Department if there is no ongoing construction. Reports shall include the current project status and the construction schedule for the following three months.

The report shall include the following information:

- a. Date permitted activity was begun; if work has not begun on-site, please indicate.
  - b. Brief description and extent of the work (i.e. construction, management, maintenance) completed since the previous report or since the permit was issued. Show on copies of the permit drawings those areas where work has been completed.
  - c. Brief description and extent of the work (i.e. construction, management, maintenance) anticipated in the next three months. Indicate on copies of the permit drawings those areas where it is anticipated that work will be done.
  - d. This report shall include on the first page, just below the title, the certification of the following statement by the individual who supervised preparation of the report: "This report represents a true and accurate description of the activities conducted during the three month period covered by this report."
8. All drawings, record drawings, land surveys and as-built surveys required herein shall be certified by a Professional Engineer or Registered Land Surveyor, as appropriate, registered in the State of Florida.
  9. The permittee shall submit two copies of signed, dated and sealed as-built drawings to the Department for Department review and approval within 30 days of completion of construction. The as-built drawings shall be based on the Department permitted construction drawings, which should be revised to reflect changes made during construction. Both the original design and constructed elevation must be clearly shown. The plans must be clearly labeled as "as-built" or "record" drawings. Surveyed dimensions and elevations required shall be verified and signed, dated and sealed by a Florida registered surveyor or engineer. Record drawings shall include the invert elevations of all culverts and controlling elevations of all permitted structures as shown in the permitted drawings. *As-builts shall be submitted to the Department regardless of whether or not deviations are present. In addition to the "As-built Certification" form, the permittee shall submit the "Request for Transfer of Environmental Resource Permit Construction Phase to Operation Phase" as required in General Condition #13.*

The following information shall be verified on the following as-built drawings signed and sealed by Mr. David Wilcox, P.E., #34942:

<u>Plan View/ Cross-Section</u>	<u>Sheet Number</u>	<u>Date</u>
Overall Site Plan	C-1	April 25, 2008
Paving, Grading and Drainage	C-2	August 8, 2008
Yard Piping Plan	C-3	April 25, 2008
Detail Yard Piping Plan	C-4	April 25, 2008
Civil Details	C-6	August 8, 2008
Civil Details	C-8	April 25, 2008

#### **EROSION CONTROL CONDITIONS:**

10. Best management practices for erosion control shall be implemented prior to demolition and/or construction and maintained at all times during construction to prevent siltation and turbid discharges in excess of State water quality standards pursuant to Rule 62-302, F.A.C. Methods shall include, but are not limited to the use of staked hay bales, staked filter cloth, sodding, seeding, and mulching; staged construction; and the installation of turbidity screens around the immediate project site. Erosion control methods shall be implemented prior to demolition and/or construction as described or depicted in the attached Sheets "Overall Site Plan, C-1", "Grading and Drainage, C-2", and "Erosion Control Details, C-7".
11. Grass seed, or sod shall be installed and maintained on exposed slopes and disturbed soil areas within 48 hours of completing final grade, and at other times as necessary, to prevent erosion, sedimentation or turbid discharges into waters of the state and/or adjacent wetlands. A vegetative cover that stabilizes and prevents erosion of the fill material shall be established within 60 days of sodding or seeding. Turbidity barriers/erosion control devices shall be removed upon establishment of a substantial vegetative cover.
12. All ditches and swales from the point at which they receive runoff from the project area and through their entire downstream length shall be well maintained and stabilized to ensure that they are not subject to erosion.

#### **CONSTRUCTION CONDITIONS:**

13. This permit does not authorize the odor control building that is labeled on the attached drawings as future construction by others. A permit modification will be required to address future construction.

14. The authorized stormwater management system shall be completed prior to or simultaneously with associated upland development. Occupation of the site shall be in accordance with General Condition 12.
15. Excavation of the detention ponds and swales are limited to the permitted design specifications as depicted on the attached "Grading and Drainage, Sheet C-2". If a clay confining layer or limestone bedrock is encountered during construction the Department shall be immediately notified and construction in the affected area shall cease until the Department approves further activity.

**OPERATION CONDITIONS:**

16. The wet detention system's treatment volume shall be discharged in no less than 120 hours (5 days) with no more than one-half the total volume being discharged within the first 60 hours (2.5-days).
17. The successful establishment and survival of littoral shelf vegetation within the wet detention pond is necessary for stormwater quality treatment and permit compliance. A minimum of 35 percent littoral shelf coverage of native vegetation, concentrated at the outfall is required for biological assimilation of pollutants. The successful establishment of non-emergent vegetation, such as trees and shrubs, may also be included in the littoral shelf area. Should the establishment of native vegetation not be accomplished within 24 months of construction of the wet detention pond, the permittee shall plant the littoral shelf to achieve the required 35 percent vegetative cover. Details of the percent cover by native vegetation within the littoral shelf shall be included with the progress reports required in specific condition #7. Periodic replanting is required if coverage falls below the 35 percent level.
18. Signs shall be posted a minimum of every 100 feet around the perimeter of all wet detention ponds stating "**Stormwater Treatment Pond – No mowing or spraying of aquatic vegetation allowed unless authorized by FDEP. Call 813/632-7600 for more information.**" These information signs shall be installed prior to the Transfer to Operation Phase and are required for the proper operation and maintenance of the stormwater treatment system.
19. The Operation and Maintenance Entity shall perform inspections beginning 12 months after operation is authorized and every 12 months thereafter and submit inspection reports in the form required by the Department, FDEP Form # 62-343.900(6), *Inspection Certification*.
20. The maintenance of the storm water system shall be in accordance with the attached Operation and Maintenance Guidelines. It is the responsibility of the permittee to ensure that that the stormwater management system is functioning as designed.

21. The permittee shall notify the Department of any sinkhole development in the surface water management system within 48 hours after discovery and must submit a detailed sinkhole evaluation and repair plan for approval by the Department within 30 days of discovery.
22. The permitted surfacewater management system shall only be used for the purpose of controlling stormwater runoff from the site and shall not be used to dispose of or store any solid/liquid waste or products generated or used during operation or construction of the facility.

## **END OF SPECIFIC CONDITIONS**

### **RIGHTS OF AFFECTED PARTIES`**

This permit is hereby granted. This action is final and effective on the date filed with the Clerk of the Department unless a sufficient petition for an administrative hearing is timely filed under sections 120.569 and 120.57 of the Florida Statutes as provided below. If a sufficient petition for an administrative hearing is timely filed, this action automatically becomes only proposed agency action on the application, subject to the result of the administrative review process. Therefore, on the filing of a timely and sufficient petition, this action will not be final and effective until further order of the Department. Because an administrative hearing may result in the reversal or substantial modification of this action, the applicant is advised not to commence construction or other activities until the deadlines noted below for filing a petition for an administrative hearing or request for an extension of time have expired.

Mediation is not available.

A person whose substantial interests are affected by the Department's action may petition for an administrative proceeding (hearing) under sections 120.569 and 120.57 of the Florida Statutes. The petition must contain the information set forth below and must be filed (received by the clerk) in the Office of General Counsel of the Department at 3900 Commonwealth Boulevard, Mail Station 35, Tallahassee, Florida 32399-3000. Mediation may also be pursued as specified below.

Under rule 62-110.106(4) of the Florida Administrative Code, a person whose substantial interests are affected by the Department's action may also request an extension of time to file a petition for an administrative hearing. The Department may, for good cause shown, grant the request for an extension of time. Requests for extension of time must be filed with the Office of General Counsel of the Department at 3900 Commonwealth Boulevard, Mail Station 35, Tallahassee, Florida 32399-3000, before the applicable deadline. A timely request for extension of time shall toll the running of the time period for filing a petition until the request is acted upon. If a request is filed late, the Department may still grant it upon a motion by the requesting

party showing that the failure to file a request for an extension of time before the deadline was the result of excusable neglect.

If a timely and sufficient petition for an administrative hearing is filed, other persons whose substantial interests will be affected by the outcome of the administrative process have the right to petition to intervene in the proceeding. Intervention will be permitted only at the discretion of the presiding officer upon the filing of a motion in compliance with rule 28-106.205 of the Florida Administrative Code.

In accordance with rules 28-106.111(2) and 62-110.106(3)(a)(4), petitions for an administrative hearing by the applicant must be filed within 21 days of receipt of this written notice. Petitions filed by any persons other than the applicant, and other than those entitled to written notice under section 120.60(3) of the Florida Statutes, must be filed within 21 days of publication of the notice or within 21 days of receipt of the written notice, whichever occurs first. Under section 120.60(3) of the Florida Statutes, however, any person who has asked the Department for notice of agency action may file a petition within 21 days of receipt of such notice, regardless of the date of publication.

The petitioner shall mail a copy of the petition to the applicant at the address indicated above at the time of filing. The failure of any person to file a petition for an administrative hearing or pursue mediation as provided below within the appropriate time period shall constitute a waiver of those rights.

A petition that disputes the material facts on which the Department's action is based must contain the following information:

(a) The name and address of each agency affected and each agency's file or identification number, if known;

(b) The name, address, and telephone number of the petitioner; the name, address, and telephone number of the petitioner's representative, if any, which shall be the address for service purposes during the course of the proceeding; and an explanation of how the petitioner's substantial interests are or will be affected by the agency determination;

(c) A statement of when and how the petitioner received notice of the agency decision;

(d) A statement of all disputed issues of material fact. If there are none, the petition must so indicate;

(e) A concise statement of the ultimate facts alleged, including the specific facts that the petitioner contends warrant reversal or modification of the agency's proposed action;

(f) A statement of the specific rules or statutes that the petitioner contends require reversal or modification of the agency's proposed action; and

(g) A statement of the relief sought by the petitioner, stating precisely the action that the petitioner wishes the agency to take with respect to the agency's proposed action.



A petition that does not dispute the material facts on which the Department's action is based shall state that no such facts are in dispute and otherwise shall contain the same information as set forth above, as required by rule 28-106.301.

Under sections 120.569(2)(c) and (d) of the Florida Statutes, a petition for administrative hearing must be dismissed by the agency if the petition does not substantially comply with the above requirements or is untimely filed.

In addition to petitioning for an administrative hearing, any person who has previously filed a petition for an administrative hearing may pursue mediation. If a written mediation agreement with all parties to the proceeding (i.e., the applicant, the Department, and any person who has filed a timely and sufficient petition for a hearing) is filed with the Department within 10 days after the deadline for filing a petition for an administrative hearing, the time limitations imposed by sections 120.569 and 120.57 shall be tolled to allow mediation to proceed. The agreement must contain all the information required by rule 28-106.404. The agreement must be received by the clerk in the Office of General Counsel of the Department at 3900 Commonwealth Boulevard, Mail Station 35, Tallahassee, Florida 32399-3000, before the deadline noted above. Pursuing mediation will not adversely affect the right to a hearing if mediation does not result in a settlement.

Unless otherwise agreed by the parties, the mediation must be concluded within sixty days of the execution of the agreement. If mediation results in settlement of the administrative dispute, the Department must enter a final order incorporating the agreement of the parties. As noted above, persons seeking to protect their substantial interests that would be affected by such a final decision modified through mediation must file their petitions within 21 days of receipt or publication of this notice as provided above, or they shall be deemed to have waived their right to a proceeding under sections 120.569 and 120.57. If mediation terminates without settlement of the dispute, the Department shall notify all parties in writing that the administrative hearing processes under sections 120.569 and 120.57 remain available for disposition of the dispute, and the notice will specify the deadlines that then will apply for challenging the agency action and electing remedies under those two statutes.

This permit constitutes an order of the Department. Subject to the provisions of paragraph 120.68(7)(a) of the Florida Statutes, which may require a remand for an administrative hearing, the applicant has the right to seek judicial review of the order under section 120.68 of the Florida Statutes, by the filing of a notice of appeal under rule 9.110 of the Florida Rules of Appellate Procedure with the Clerk of the Department in the Office of General Counsel, 3900 Commonwealth Boulevard, Mail Station 35, Tallahassee, Florida, 32399-3000; and by filing a copy of the notice of appeal accompanied by the applicable filing fees with the appropriate district court of appeal. The notice of appeal must be filed within 30 days from the date when the order is filed with the Clerk of the Department. The applicant, or any party within the meaning of section 373.114(1)(a) or 373.4275 of the Florida Statutes, may also seek appellate review of the order before the Land and Water Adjudicatory Commission under section 373.114(1) or

Influent Structure at the North Water Reclamation Facility

Permit No. 41-0288451-001

Page 13 of 15

373.4275 of the Florida Statutes. Requests for review before the Land and Water Adjudicatory Commission must be filed with the Secretary of the Commission and served on the Department within 20 days from the date when the order is filed with the Clerk of the Department.

Executed in Temple Terrace, Florida.

STATE OF FLORIDA DEPARTMENT  
OF ENVIRONMENTAL PROTECTION

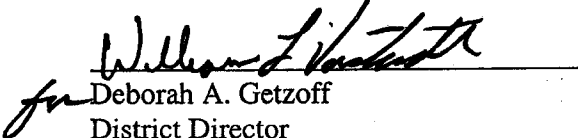
  
for Deborah A. Getzoff  
District Director  
Southwest District

DAG/dp

cc: Mr. David Wilcox, P.E., Water/Wastewater Group Manager, URS Corporation Southern,  
7650 West Courtney Campbell Causeway, Tampa, Florida 33607-1462  
File

Attachments:

Project Location Map, 1 page  
Operation and Maintenance Guidelines, 4 pages  
Overall Site Plan, Sheet C-1  
Paving, Grading and Drainage, Sheet C-2  
Yard Piping Plan, Sheet C-3  
Detail Yard Piping Plan, Sheet C-4  
Erosion Control Details, Sheet C-7  
Civil Details, Sheets C-6 and C-8  
As-built certification/62-343.900(5)  
Inspection certification/62-343.900(6)  
Transfer construction to operation phase/62-343.900(7)  
Transfer of ERP and Notification of Sale of a Facility or SWMS/62-343.900(8)  
NPDES Stormwater Construction Activity brochure, 2 pages

CERTIFICATE OF SERVICE

The undersigned duly designated deputy clerk hereby certifies that this permit, including all copies were mailed before the close of business on, 12/10, 2008, to the above listed persons.

FILING AND ACKNOWLEDGMENT

FILED, on this date, pursuant to 120.52(9), Florida Statutes, with the designated Department Clerk, receipt of which is hereby acknowledged.

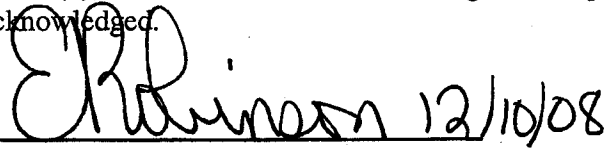
 12/10/08

Clerk

Date

Project Name: Manatee County Inlet  
Structure at the North Water Reclamation  
Facility.  
File Name: Manatee County Public Works  
File No. 41-0288451-001

A: 8500 69th St E, Palmetto, FL 34221-9064

Project

Need help on the go? Get Voice Activated Directions for free. Call 1-800-FREE411 (1-800-373-3411).

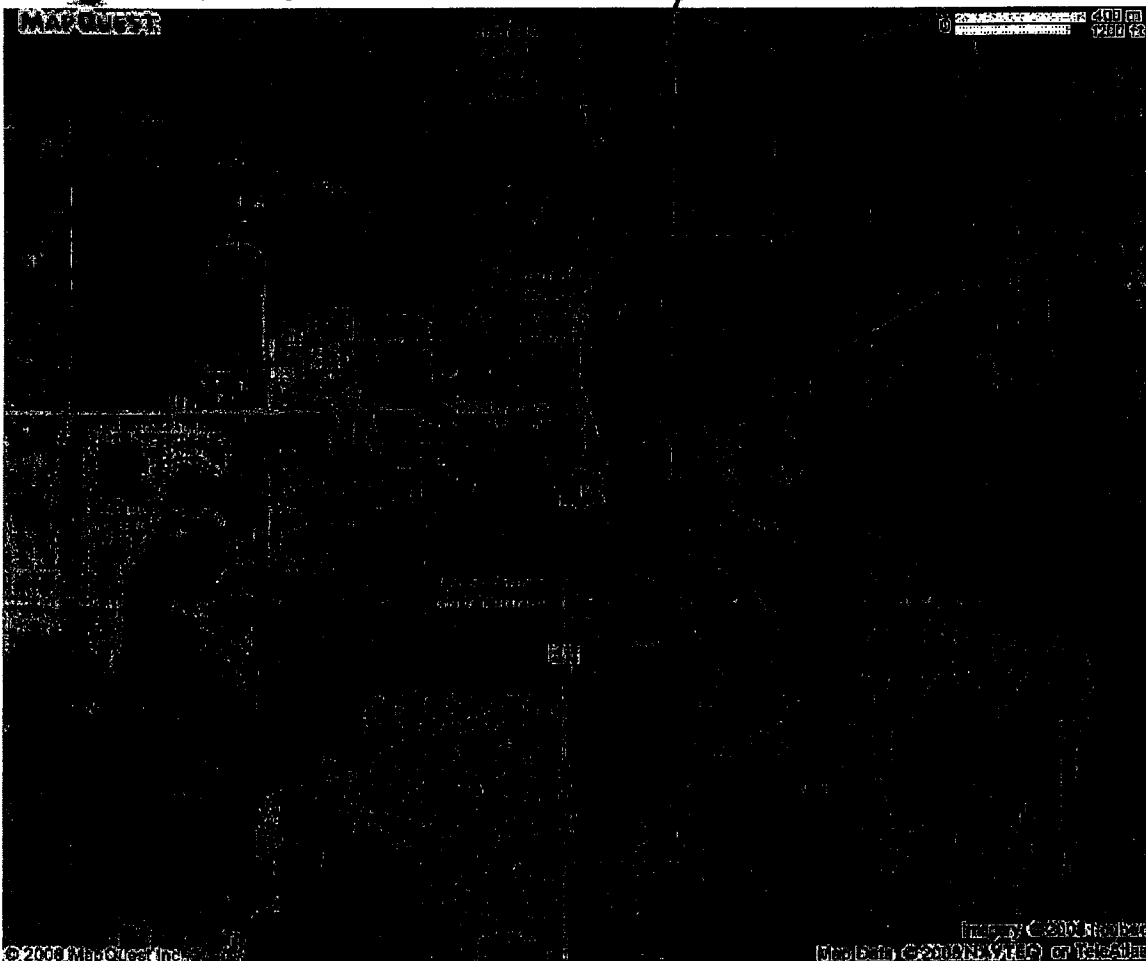

## 4.0 OPERATION AND MAINTENANCE GUIDELINES

Manatee County, (refer to address below) will be responsible for the ownership and maintenance of the proposed stormwater system. The contact is Wayne Roberts, P.E., Deputy Director Public Works, Manatee County Project Management.

Ownership Address: Manatee County  
1026 26<sup>th</sup> Avenue East  
Bradenton, FL 34208  
(ph # 941-708-7450)  
(fx # 941-708-7549)

### 4.1 Operation

The project's stormwater management system is a gravity operated system and requires no operator action.

### 4.2 General Maintenance

1. All stormwater pipes, inlets, catch basins, manholes, flumes, pond inflow and outfall structures (including oil skimmers), and discharge pipes should be inspected on a regular basis (monthly or quarterly) and after major rainfalls. They should be maintained by removing built-up debris and vegetation and repairing deteriorating structures.
2. Chemicals, oils, greases or similar wastes are not to be disposed of directly to the stormwater facility or through storm sewers. Treatment ponds are designed to treat normal road, parking lot, roof and yard runoff only. Some chemicals may interfere with a treatment pond's functions or kill vegetation and wildlife. Dispose of these potentially dangerous materials properly by taking them to recycling facilities or to collection locations sponsored by many local governments.

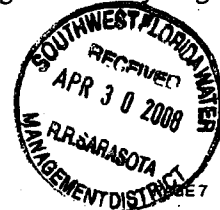

Also, do not dispose of grass clippings in a SWMS. Grass clippings pose problems by smothering desirable vegetation, clogging outfall structures and, when they decompose, may cause unsightly algae blooms that can kill fish.

3. Accumulated pond sediments may contain heavy metals such as lead, cadmium and mercury, as well as other potentially hazardous materials. Therefore, sediments removed from storm sewers, inlets, pipes and ponds should be disposed of at an approved facility (check with the County Solid Waste Department or the Florida Department of Environmental Protection for disposal facilities approved to accept treatment pond sediment).
4. During any repair or maintenance activity, use care to avoid causing erosion or siltation to adjacent or off-site areas.
5. Mosquito growth can be minimized in a SWMS by the following measures:
  - o Do not dump grass clippings or other organic debris into a SWMS – decaying grass clippings and other decomposing vegetation create ideal conditions for breeding mosquitoes.
  - o Clean out any obstructions that get into the system. Debris can obstruct flow and harbor mosquito eggs and larvae.
  - o Remove water lettuce and water hyacinth, which nourish and shelter mosquito larvae.
  - o Stock ponds with predatory “mosquito fish” – Gambusia minnows, which may be collected from other ponds and ditches and introduced into your SWMS. Remember, the introduction of grass carp into your SWMS will require SWFWMD approval.

#### 4.3 Ditches and Swales

1. Ditches and swales should be periodically mowed and cleaned of accumulated refuse. During the mowing operations, ditches and swales should be inspected for bare spots, damage or erosion. Bare areas should be sodded or seeded to replace the grass cover. In the case of erosion, replace the missing soils and bring the area back to grade.
2. Some ditches are designed to store runoff for short periods of time utilizing ditch blocks or inlet inlets. These ditch blocks or inlets should not be removed or altered.

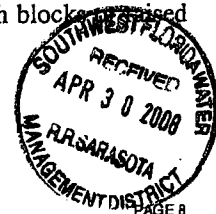

#### 4.4 Dry Retention Ponds (Percolation Ponds)

1. On a monthly or quarterly basis, and following a storm event, the entity responsible for maintenance should make an inspection of the pond and its outfall structure to ensure that the system is operating properly. If standing water persists longer than 72 hours after a normal summer rain event, or if wetland vegetation such as cattails grow in the pond, the stormwater facility may be in need of repair. Repairs may be as simple as scarifying or raking the pond bottom, or may consist of removing the bottom sediment (approximately the top foot of soil) and replacing the soil with clean sand.
2. Mow frequently enough to prevent thatch buildup. Pick up grass clippings after cutting. Limit fertilizer use around the pond, and do not fertilize grass in the pond area.
3. Resod any areas (sides or bottom) where grass or sod has been removed or eroded.
4. Keep the outfall structures clear of debris and vegetation.

#### 4.5 Effluent Filtration

In general, if approximately 36 hours after a rain event you notice that water discharges over the top of the concrete control structure, rather than through the perforated pipe, it may be a signal that the pond is not functioning properly.

1. On a monthly or quarterly basis, and following a storm event, inspect the pond and its outfall structure to ensure that the system is operating properly.  
  
Repairs may be as simple as scarifying or raking the filter sand, forcing water through the cleanout to cleanse the perforated pipe, or as involved as replacing the filter media.
2. Mow frequently enough to prevent thatch buildup. Pick up grass clippings after cutting. Limit fertilizer use around the pond, and do not fertilize grass in the pond area.
3. Resod any areas where grass has been removed or eroded. Do not sod over the filter media. Place stone or gravel over the filter media for stabilization, if necessary.
4. Keep the outfall structure clear of debris and vegetation.



#### 4.6 Wet Detention Ponds

1. All sodded side slopes and berms should be maintained by the procedure outlined for ditches and swales. Inflow structures should be maintained by the procedures outlined under 'General Maintenance.'
2. Maintain, rather than remove, wetland vegetation that becomes established in the littoral zone. Do not cut, mow, use herbicide or grass carp to remove any of the vegetation in the littoral zone without prior approval from the district. Refer to the conditions of the permit and construction notes for further instructions.
3. On a monthly or quarterly basis, and after severe rainfall events, check the area in front of the outfall control structure for built-up sediments, vegetation, trash and debris that impair the operation of the structure. Remove sediment, vegetation, trash and debris to an approved disposal site.
4. When littoral zone vegetation and sediment accumulate to such an extent that water depth decreases, the littoral zone may need to be regraded and revegetated. When it appears that a pond has reached this state, it is best to contact a SWFWMD representative prior to large-scale maintenance.





**SITE NOTES**

- CONTRACTOR TO VERIFY THE LOCATION OF THE CONNECTION POINT OF EXISTING PIPES TO THE PROPOSED PIPING. THE LOCATION OF THE EXISTING PIPES SHALL BE THE RESPONSIBILITY OF THE CONTRACTOR.
- CONTRACTOR TO ADJUST ALL EXISTING WAIVE MARKERS AND LOGS WITHIN THE PROPOSED ROAD TO MATCH FINISHED GRADES.

BORING	DEPTH (FT)	CLAY	SAND	GRAVEL	WATER	LOG
B-1	10.00	10.00	0.00	0.00	10.00	10.00
B-2	10.00	10.00	0.00	0.00	10.00	10.00
B-3	10.00	10.00	0.00	0.00	10.00	10.00
B-4	10.00	10.00	0.00	0.00	10.00	10.00
B-5	10.00	10.00	0.00	0.00	10.00	10.00
B-6	10.00	10.00	0.00	0.00	10.00	10.00
B-7	10.00	10.00	0.00	0.00	10.00	10.00
B-8	10.00	10.00	0.00	0.00	10.00	10.00
B-9	10.00	10.00	0.00	0.00	10.00	10.00
B-10	10.00	10.00	0.00	0.00	10.00	10.00
B-11	10.00	10.00	0.00	0.00	10.00	10.00
B-12	10.00	10.00	0.00	0.00	10.00	10.00
B-13	10.00	10.00	0.00	0.00	10.00	10.00
B-14	10.00	10.00	0.00	0.00	10.00	10.00
B-15	10.00	10.00	0.00	0.00	10.00	10.00
B-16	10.00	10.00	0.00	0.00	10.00	10.00
B-17	10.00	10.00	0.00	0.00	10.00	10.00
B-18	10.00	10.00	0.00	0.00	10.00	10.00
B-19	10.00	10.00	0.00	0.00	10.00	10.00
B-20	10.00	10.00	0.00	0.00	10.00	10.00

**BORING NOTES**

- LOCATIONS BASED ON THE NORTHWEST CORNER OF THE EXISTING FENCE.
- PLAN VIEW IS PRELIMINARY FOR DRIVING BORING LOCATION ONLY AND MAY NOT BE INDICATIVE OF FINAL PLAN.
- SEE SHEET C-7 FOR BORING LOGS, NOTES AND LOGS.
- APPROXIMATE BORING LOCATION.
- APPROXIMATE LOCATION OF DOUBLE RING INFILTRATION TEST (DR).

**APPROVED**  
**STATE OF FLORIDA**  
  
**DEC 10 2003**  
  
**DEPARTMENT OF**  
**ENVIRONMENTAL PROTECTION**

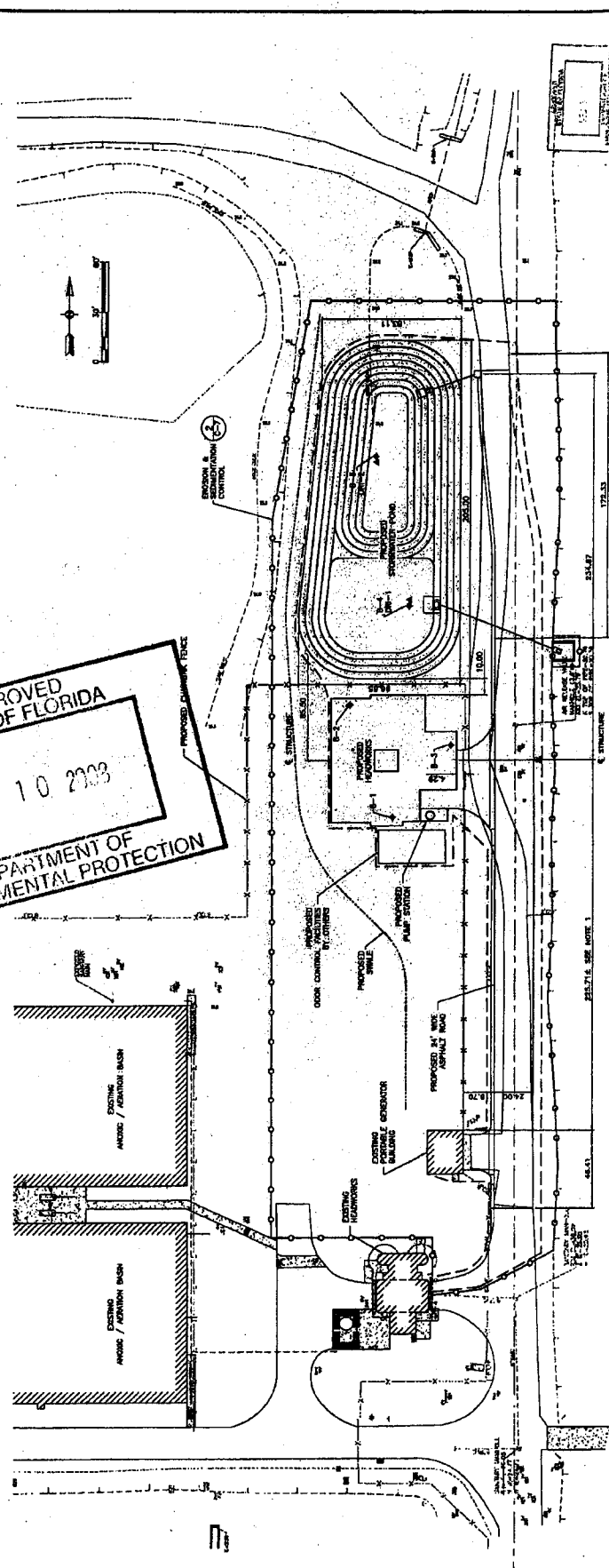
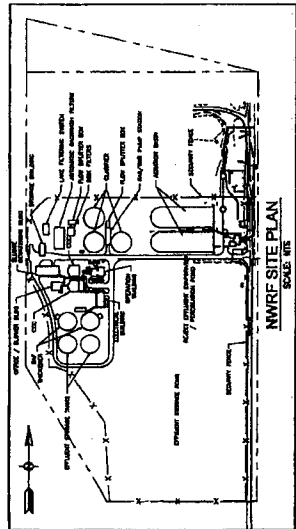

**OVERALL SITE PLAN**  
**HORIZONTAL CONTROL**  
**AND BORING LOCATIONS**

**INFLUENT STRUCTURE**  
**AT THE**  
**NORTH WATER RECLAMATION FACILITY**  
**MANATEE COUNTY GOVERNMENT**  
**MANATEE COUNTY, FLORIDA**

PROJECT STATUS  
PRELIMINARY  
CONSTRUCTION

C-1

---

URS JOB NUMBER  
12007031  
P.E. D. WILSON  
D.R. C. GOSWAMI  
D.R. C. GOSWAMI  
DATE: 04/22/03  
BY: D. WILSON

REVISIONS

NO.	DATE	DESCRIPTION

---

**URS**  
7450 Wood Crossing  
Cypress Creek, Florida 32827  
Tel: (407) 246-1171 Fax: (407) 246-4477  
Florida Engineering Number: 000002

MANATEE COUNTY GOVERNMENT  
NORTH WATER RECLAMATION FACILITY  
MANATEE COUNTY, FLORIDA

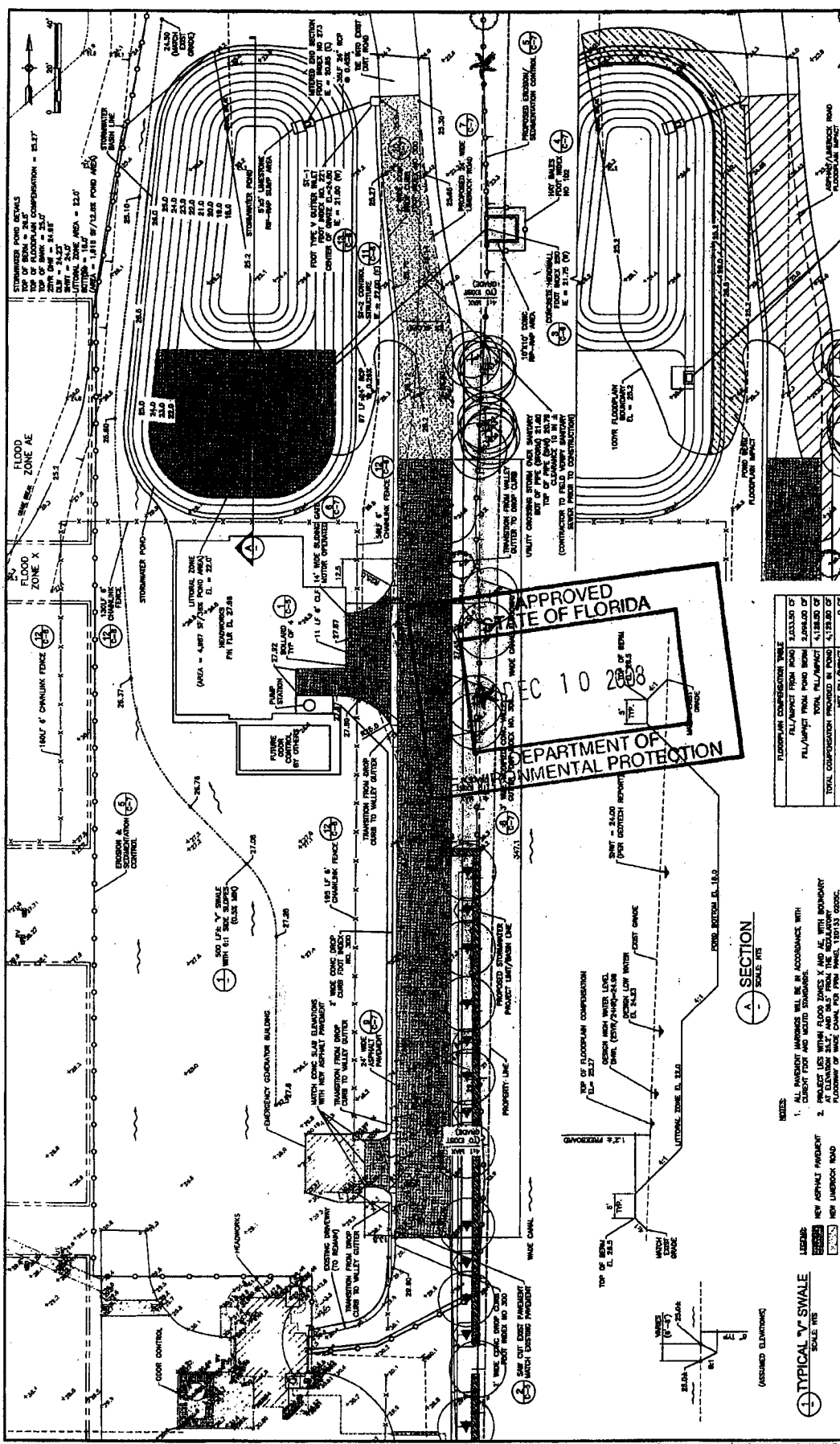

PROJECT STATUS  
PRELIMINARY  
CONSTRUCTION

C-2

PAVING, GRADING AND DRAINAGE

FLOODPLAIN IMPACT

INFLUENT STRUCTURE  
AT THE  
NORTH WATER RECLAMATION FACILITY  
MANATEE COUNTY GOVERNMENT  
MANATEE COUNTY, FLORIDA

ALL EXISTING AND PROPOSED STRUCTURES WILL BE IN ACCORDANCE WITH  
1. COUNTY FISH AND WILDLIFE STANDARDS;  
2. STATE FISH AND WILDLIFE STANDARDS;  
3. FEDERAL AND STATE REGULATIONS;  
4. FLOODPLAIN REGULATIONS;  
5. FLOODPLAIN REGULATIONS;  
6. FLOODPLAIN REGULATIONS;  
7. FLOODPLAIN REGULATIONS;  
8. FLOODPLAIN REGULATIONS;  
9. FLOODPLAIN REGULATIONS;  
10. FLOODPLAIN REGULATIONS;  
11. FLOODPLAIN REGULATIONS;  
12. FLOODPLAIN REGULATIONS;  
13. FLOODPLAIN REGULATIONS;  
14. FLOODPLAIN REGULATIONS;  
15. FLOODPLAIN REGULATIONS;  
16. FLOODPLAIN REGULATIONS;  
17. FLOODPLAIN REGULATIONS;  
18. FLOODPLAIN REGULATIONS;  
19. FLOODPLAIN REGULATIONS;  
20. FLOODPLAIN REGULATIONS;  
21. FLOODPLAIN REGULATIONS;  
22. FLOODPLAIN REGULATIONS;  
23. FLOODPLAIN REGULATIONS;  
24. FLOODPLAIN REGULATIONS;  
25. FLOODPLAIN REGULATIONS;  
26. FLOODPLAIN REGULATIONS;  
27. FLOODPLAIN REGULATIONS;  
28. FLOODPLAIN REGULATIONS;  
29. FLOODPLAIN REGULATIONS;  
30. FLOODPLAIN REGULATIONS;  
31. FLOODPLAIN REGULATIONS;  
32. FLOODPLAIN REGULATIONS;  
33. FLOODPLAIN REGULATIONS;  
34. FLOODPLAIN REGULATIONS;  
35. FLOODPLAIN REGULATIONS;  
36. FLOODPLAIN REGULATIONS;  
37. FLOODPLAIN REGULATIONS;  
38. FLOODPLAIN REGULATIONS;  
39. FLOODPLAIN REGULATIONS;  
40. FLOODPLAIN REGULATIONS;  
41. FLOODPLAIN REGULATIONS;  
42. FLOODPLAIN REGULATIONS;  
43. FLOODPLAIN REGULATIONS;  
44. FLOODPLAIN REGULATIONS;  
45. FLOODPLAIN REGULATIONS;  
46. FLOODPLAIN REGULATIONS;  
47. FLOODPLAIN REGULATIONS;  
48. FLOODPLAIN REGULATIONS;  
49. FLOODPLAIN REGULATIONS;  
50. FLOODPLAIN REGULATIONS;  
51. FLOODPLAIN REGULATIONS;  
52. FLOODPLAIN REGULATIONS;  
53. FLOODPLAIN REGULATIONS;  
54. FLOODPLAIN REGULATIONS;  
55. FLOODPLAIN REGULATIONS;  
56. FLOODPLAIN REGULATIONS;  
57. FLOODPLAIN REGULATIONS;  
58. FLOODPLAIN REGULATIONS;  
59. FLOODPLAIN REGULATIONS;  
60. FLOODPLAIN REGULATIONS;  
61. FLOODPLAIN REGULATIONS;  
62. FLOODPLAIN REGULATIONS;  
63. FLOODPLAIN REGULATIONS;  
64. FLOODPLAIN REGULATIONS;  
65. FLOODPLAIN REGULATIONS;  
66. FLOODPLAIN REGULATIONS;  
67. FLOODPLAIN REGULATIONS;  
68. FLOODPLAIN REGULATIONS;  
69. FLOODPLAIN REGULATIONS;  
70. FLOODPLAIN REGULATIONS;  
71. FLOODPLAIN REGULATIONS;  
72. FLOODPLAIN REGULATIONS;  
73. FLOODPLAIN REGULATIONS;  
74. FLOODPLAIN REGULATIONS;  
75. FLOODPLAIN REGULATIONS;  
76. FLOODPLAIN REGULATIONS;  
77. FLOODPLAIN REGULATIONS;  
78. FLOODPLAIN REGULATIONS;  
79. FLOODPLAIN REGULATIONS;  
80. FLOODPLAIN REGULATIONS;  
81. FLOODPLAIN REGULATIONS;  
82. FLOODPLAIN REGULATIONS;  
83. FLOODPLAIN REGULATIONS;  
84. FLOODPLAIN REGULATIONS;  
85. FLOODPLAIN REGULATIONS;  
86. FLOODPLAIN REGULATIONS;  
87. FLOODPLAIN REGULATIONS;  
88. FLOODPLAIN REGULATIONS;  
89. FLOODPLAIN REGULATIONS;  
90. FLOODPLAIN REGULATIONS;  
91. FLOODPLAIN REGULATIONS;  
92. FLOODPLAIN REGULATIONS;  
93. FLOODPLAIN REGULATIONS;  
94. FLOODPLAIN REGULATIONS;  
95. FLOODPLAIN REGULATIONS;  
96. FLOODPLAIN REGULATIONS;  
97. FLOODPLAIN REGULATIONS;  
98. FLOODPLAIN REGULATIONS;  
99. FLOODPLAIN REGULATIONS;  
100. FLOODPLAIN REGULATIONS;

APPROVED  
STATE OF FLORIDA  
DEC 10 2008  
DEPARTMENT OF  
ENVIRONMENTAL PROTECTION

SECTION A  
SCALE: 1/8" = 1'-0"

TYPICAL "V" SWALE  
SCALE: 1/8" = 1'-0"

SECTION A  
SCALE: 1/8" = 1'-0"

LEGEND:  
NEW ASPHALT PAVEMENT  
NEW UNGRAVELLED ROAD  
EXISTING ASPHALT PAVEMENT  
EXISTING UNGRAVELLED ROAD  
EXISTING CONCRETE PAVEMENT  
EXISTING CONCRETE ROAD

NOTES:  
1. ALL EXISTING AND PROPOSED STRUCTURES WILL BE IN ACCORDANCE WITH  
2. COUNTY FISH AND WILDLIFE STANDARDS;  
3. STATE FISH AND WILDLIFE STANDARDS;  
4. FEDERAL AND STATE REGULATIONS;  
5. FLOODPLAIN REGULATIONS;  
6. FLOODPLAIN REGULATIONS;  
7. FLOODPLAIN REGULATIONS;  
8. FLOODPLAIN REGULATIONS;  
9. FLOODPLAIN REGULATIONS;  
10. FLOODPLAIN REGULATIONS;  
11. FLOODPLAIN REGULATIONS;  
12. FLOODPLAIN REGULATIONS;  
13. FLOODPLAIN REGULATIONS;  
14. FLOODPLAIN REGULATIONS;  
15. FLOODPLAIN REGULATIONS;  
16. FLOODPLAIN REGULATIONS;  
17. FLOODPLAIN REGULATIONS;  
18. FLOODPLAIN REGULATIONS;  
19. FLOODPLAIN REGULATIONS;  
20. FLOODPLAIN REGULATIONS;  
21. FLOODPLAIN REGULATIONS;  
22. FLOODPLAIN REGULATIONS;  
23. FLOODPLAIN REGULATIONS;  
24. FLOODPLAIN REGULATIONS;  
25. FLOODPLAIN REGULATIONS;  
26. FLOODPLAIN REGULATIONS;  
27. FLOODPLAIN REGULATIONS;  
28. FLOODPLAIN REGULATIONS;  
29. FLOODPLAIN REGULATIONS;  
30. FLOODPLAIN REGULATIONS;  
31. FLOODPLAIN REGULATIONS;  
32. FLOODPLAIN REGULATIONS;  
33. FLOODPLAIN REGULATIONS;  
34. FLOODPLAIN REGULATIONS;  
35. FLOODPLAIN REGULATIONS;  
36. FLOODPLAIN REGULATIONS;  
37. FLOODPLAIN REGULATIONS;  
38. FLOODPLAIN REGULATIONS;  
39. FLOODPLAIN REGULATIONS;  
40. FLOODPLAIN REGULATIONS;  
41. FLOODPLAIN REGULATIONS;  
42. FLOODPLAIN REGULATIONS;  
43. FLOODPLAIN REGULATIONS;  
44. FLOODPLAIN REGULATIONS;  
45. FLOODPLAIN REGULATIONS;  
46. FLOODPLAIN REGULATIONS;  
47. FLOODPLAIN REGULATIONS;  
48. FLOODPLAIN REGULATIONS;  
49. FLOODPLAIN REGULATIONS;  
50. FLOODPLAIN REGULATIONS;  
51. FLOODPLAIN REGULATIONS;  
52. FLOODPLAIN REGULATIONS;  
53. FLOODPLAIN REGULATIONS;  
54. FLOODPLAIN REGULATIONS;  
55. FLOODPLAIN REGULATIONS;  
56. FLOODPLAIN REGULATIONS;  
57. FLOODPLAIN REGULATIONS;  
58. FLOODPLAIN REGULATIONS;  
59. FLOODPLAIN REGULATIONS;  
60. FLOODPLAIN REGULATIONS;  
61. FLOODPLAIN REGULATIONS;  
62. FLOODPLAIN REGULATIONS;  
63. FLOODPLAIN REGULATIONS;  
64. FLOODPLAIN REGULATIONS;  
65. FLOODPLAIN REGULATIONS;  
66. FLOODPLAIN REGULATIONS;  
67. FLOODPLAIN REGULATIONS;  
68. FLOODPLAIN REGULATIONS;  
69. FLOODPLAIN REGULATIONS;  
70. FLOODPLAIN REGULATIONS;  
71. FLOODPLAIN REGULATIONS;  
72. FLOODPLAIN REGULATIONS;  
73. FLOODPLAIN REGULATIONS;  
74. FLOODPLAIN REGULATIONS;  
75. FLOODPLAIN REGULATIONS;  
76. FLOODPLAIN REGULATIONS;  
77. FLOODPLAIN REGULATIONS;  
78. FLOODPLAIN REGULATIONS;  
79. FLOODPLAIN REGULATIONS;  
80. FLOODPLAIN REGULATIONS;  
81. FLOODPLAIN REGULATIONS;  
82. FLOODPLAIN REGULATIONS;  
83. FLOODPLAIN REGULATIONS;  
84. FLOODPLAIN REGULATIONS;  
85. FLOODPLAIN REGULATIONS;  
86. FLOODPLAIN REGULATIONS;  
87. FLOODPLAIN REGULATIONS;  
88. FLOODPLAIN REGULATIONS;  
89. FLOODPLAIN REGULATIONS;  
90. FLOODPLAIN REGULATIONS;  
91. FLOODPLAIN REGULATIONS;  
92. FLOODPLAIN REGULATIONS;  
93. FLOODPLAIN REGULATIONS;  
94. FLOODPLAIN REGULATIONS;  
95. FLOODPLAIN REGULATIONS;  
96. FLOODPLAIN REGULATIONS;  
97. FLOODPLAIN REGULATIONS;  
98. FLOODPLAIN REGULATIONS;  
99. FLOODPLAIN REGULATIONS;  
100. FLOODPLAIN REGULATIONS;

REVISIONS

NO.	BY	DATE	DESCRIPTION
1			
2			
3			
4			
5			
6			
7			
8			
9			
10			

URS  
1800 West Century Parkway  
Suite 700  
Tampa, FL 33609  
Tel: (813) 288-1771 Fax: (813) 288-4557  
Public Engineering Number: 000002

US JOB NUMBER  
120072031  
FILE NO. 120020  
ERIC C. OSKAMER  
ENR D. ELIS  
FILE DATE  
August 5, 2008



- NOTES:
1. SEE THE INTO EXISTING YARD PAVING, SEE WORK SCHEDULE.
  2. CONTRACTOR SHALL VERIFY ELEVATIONS OF THE EXISTING YARD PAVING AND EXISTING UTILITY LOCATIONS AND SHALL CORRECT ANY DISCREPANCIES TO CORRECT ADJUST OF 1/8" TO 3/4" MAX LINES ON NORTH SOUTH BOUND TO MATCH ELEVATIONS OF EXISTING 30" W/L LINES AT THE TIE-IN POINT. EXISTING PIPES SHALL CROSS OVER EXISTING 30" W/L TIE-IN POINTS.
  3. EXISTING PIPES SHALL CROSS OVER EXISTING 30" W/L TIE-IN POINTS.

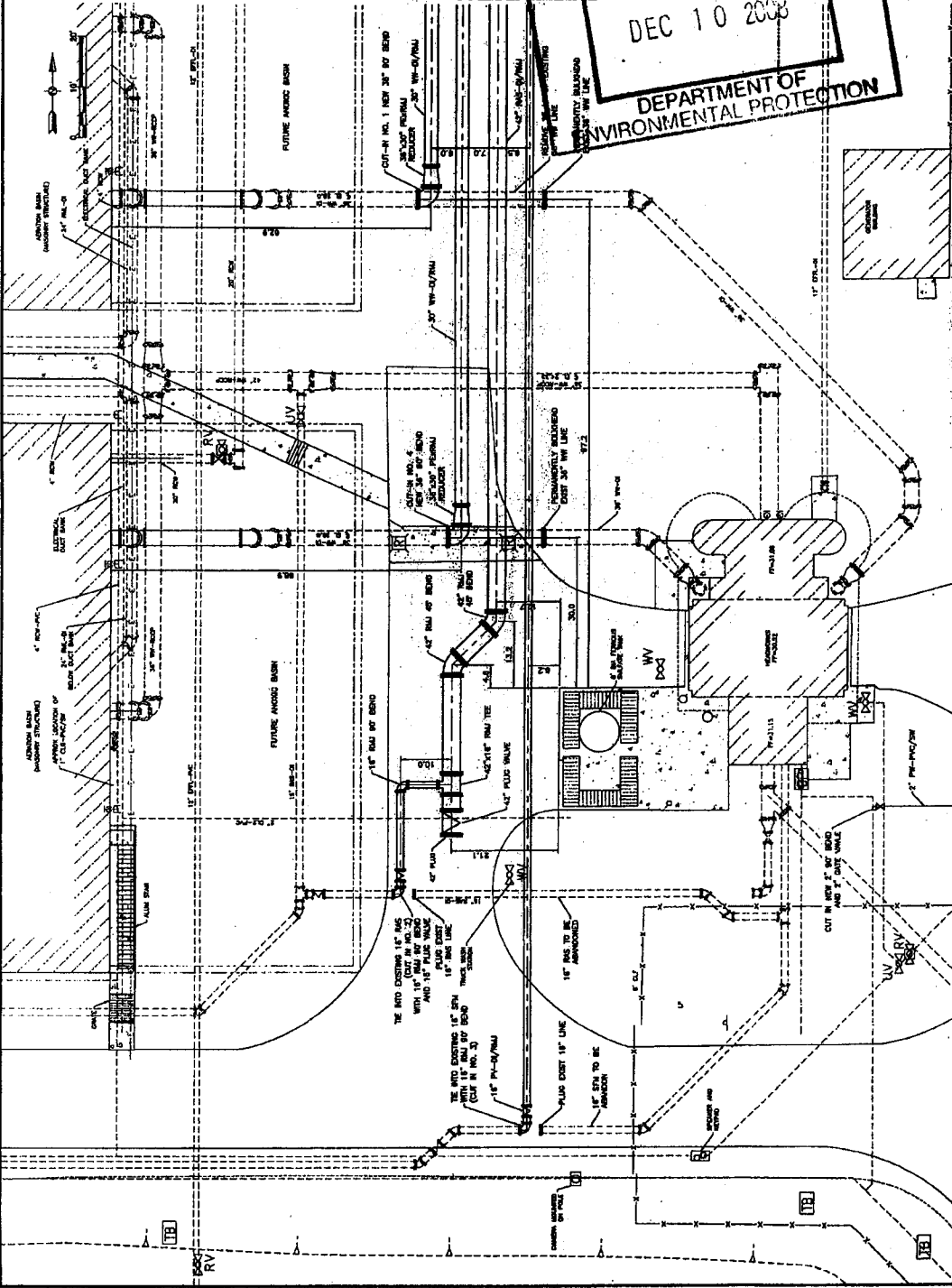

PROJECT STATUS  
 PRELIMINARY  
 NOT FOR  
 CONSTRUCTION  
 C-4



DETAIL YARD PIPING PLAN

INFLUENT STRUCTURE  
 AT THE  
 NORTH WATER RECLAMATION FACILITY  
 MANATEE COUNTY GOVERNMENT  
 MANATEE COUNTY, FLORIDA



URS JOB NUMBER  
 12007051  
 FILE D. NUMBER  
 12007051  
 FILE D. DATE  
 APRIL 22, 2005

NO.	BY	DATE	DESCRIPTION	REVISIONS

**URS**  
 2800 West Ovington  
 Ovington, Kentucky  
 Telephone: 606-251-1711  
 Fax: 606-251-1712  
 Project: 12007051

VERTICAL SCALE: 1" = 10' HORIZONTAL SCALE: 1" = 10' SEE SHEET C-3 FOR PIPING PLAN





DETAILS TAKEN FROM SHEET C-7 OF THE INFLUENT STRUCTURE AT THE NORTH WATER RECLAMATION FACILITY CONSTRUCTION PLANS.

18 Oz. Nylon Reinforced P.V.C. Fabric (300 P.S.I. Test) Post, (Options: 2"x4" Or 2"-1/2" Min. Dia. Wood; Steel 1.33 lbs./ft. Min.)

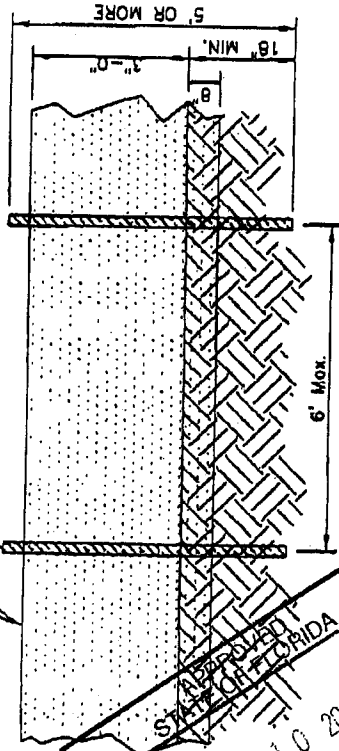

Notes: Refer to Latest Edition of F.D.O.T. "Roadway and Traffic Design Standards" Index No. 102 for Additional Details and Specifications.

- CONTRACTOR SHALL INSTALL EROSION CONTROL DEVICES PRIOR TO ANY OTHER CONSTRUCTION ACTIVITIES. THE DEVICE SHALL BE INSTALLED IN THE LOCATIONS ON DRAWINGS AND ANYWHERE ELSE THERE IS A POTENTIAL FOR EROSION AS SEDIMENT EXIT THE WORK AREA.
- CONTRACTOR SHALL INSPECT INSTALLED EROSION CONTROL DEVICE WEEKLY DURING CONSTRUCTION AND AFTER HEAVY RAINS FOR DAMAGE. MAINTENANCE SHALL INCLUDE CLEANING BUILT-UP SEDIMENT BEHIND THE BARRIERS AND/OR REPLACING DAMAGED SECTIONS.
- THE EROSION CONTROL DEVICE SHALL BE MAINTAINED BY THE CONTRACTOR UNTIL PERMANENT STAND OF GRASS (OR OTHER PERMANENT STABILIZATION) IS ESTABLISH
- IN NO CASE SHOULD HAY BALES BE USED AS EROSION CONTROL.

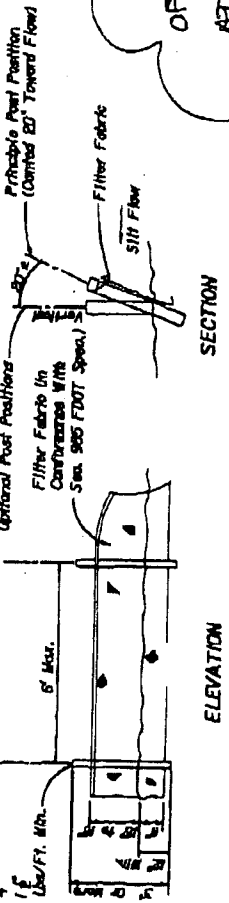

SECTION

ELEVATION

Note: Silt Fence to be post for under the mentioned unit price for Standard Silt Fence (SIL)

TYPE III SILT FENCE

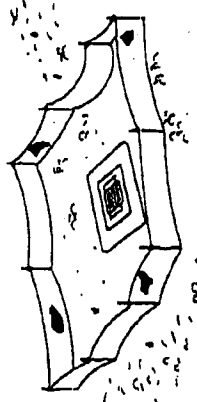

Type III Silt Fence Protection Around Ditch Bottom Inlets.

Do not deploy in a manner that silt fences will act as a dam across permanent flow watercourses. Silt fences are to be used at upland locations and turbidity barriers used at permanent bodies of water.

SILT FENCE APPLICATIONS

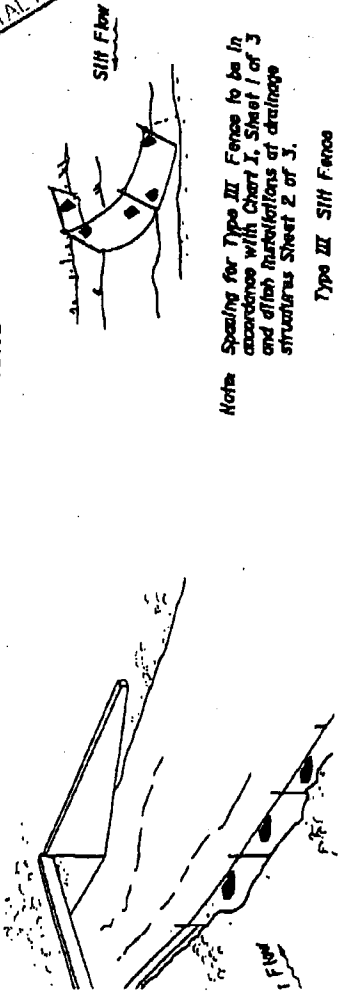

Note: Spacing for Type III Fence to be in accordance with Chart 1, Sheet 1 of 3 and ditch turbidities at drainage structures Sheet 2 of 3.

Type III Silt Fence

Type III Silt Fence

FDOT INDEX 102

P. 82 BAILED HAY OR STRAW BARRIERS & SILT FENCES



EROSION/SEDIMENTATION CONTROL DEVICE



INCHES 1/8 3/16 1/4 5/16 3/8 1/2 5/8 3/4 7/8 1 1 1/4 1 1/2 1 3/4 2 2 1/4 2 1/2 2 3/4 3 3 1/4 3 1/2 3 3/4 4 4 1/4 4 1/2 4 3/4 5 5 1/4 5 1/2 5 3/4 6 6 1/4 6 1/2 6 3/4 7 7 1/4 7 1/2 7 3/4 8 8 1/4 8 1/2 8 3/4 9 9 1/4 9 1/2 9 3/4 10

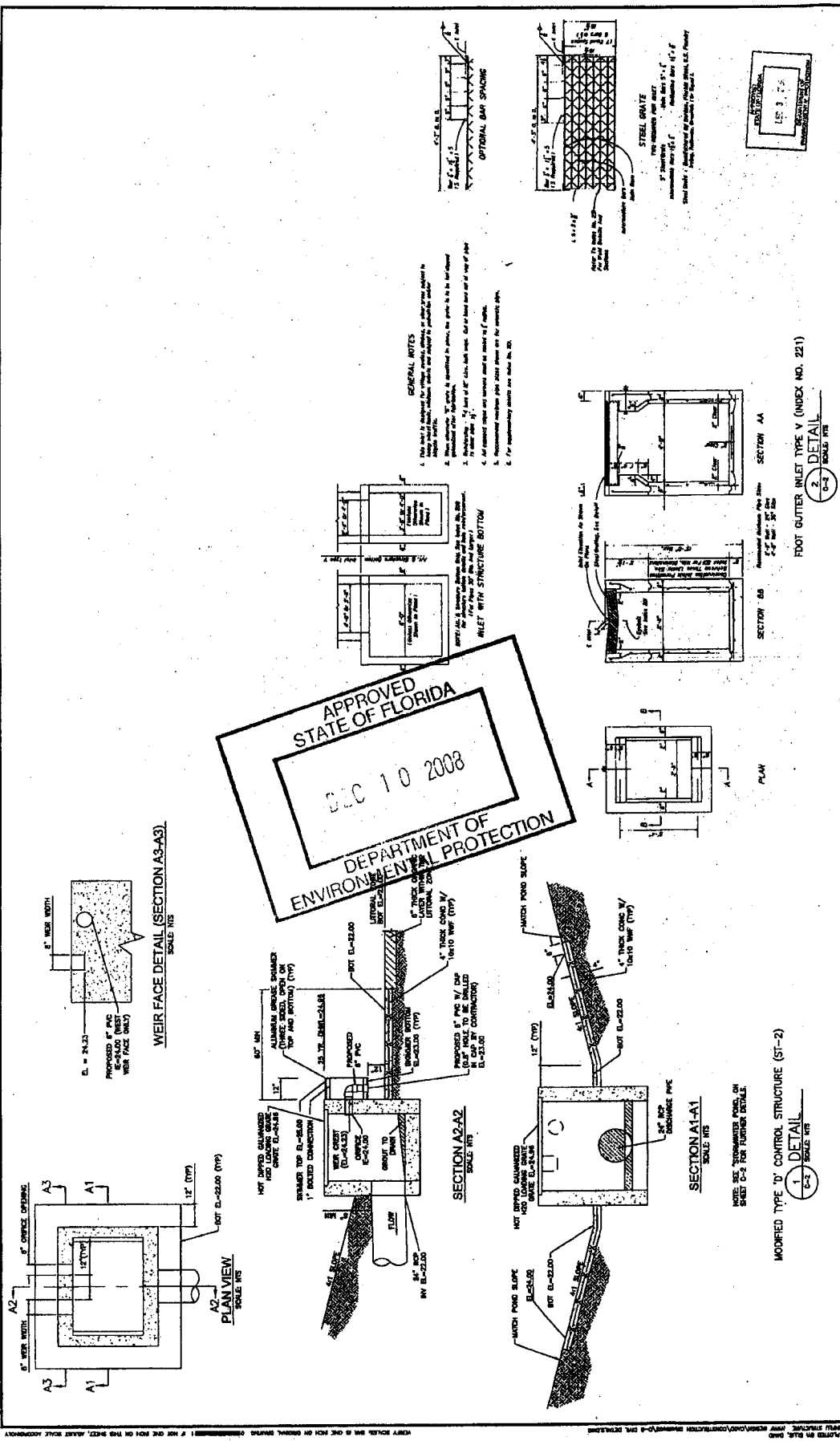

		<b>INFLUENT STRUCTURE AT THE NORTH WATER RECLAMATION FACILITY</b> MANATEE COUNTY GOVERNMENT MANATEE COUNTY, FLORIDA		<b>CIVIL DETAILS</b>		PROJECT STATUS: <b>PALENT CONSTRUCTION</b> DRAWING NO.: <b>C-8</b>	
URS JOB NUMBER 13007031	DATE: <b>APRIL 21, 2008</b>	FILE NAME: <b>ST-2</b>	DESCRIPTION: <b>MODIFIED TYPE 'D' CONTROL STRUCTURE</b>	REVISIONS:	DATE:	BY:	CHECKED:
PREPARED BY: <b>W. WALKER</b>	CHECKED BY: <b>C. OSAMUNDI</b>	DATE: <b>APRIL 21, 2008</b>	PROJECT NO.: <b>000000</b>	DRAWING NO.: <b>C-8</b>	SHEET NO.:	TOTAL SHEETS:	PROJECT STATUS:

## ENVIRONMENTAL RESOURCE PERMIT Construction Commencement Notice

Project:

Phase:

I hereby notify the Department of Environmental Protection that the construction of the surface water management system authorized by Environmental Resource Permit Number \_\_\_\_\_ has commenced / is expected to commence on \_\_\_\_\_ and will require a duration of approximately \_\_\_\_\_ months \_\_\_\_\_ weeks \_\_\_\_\_ days to complete. It is understood that should the construction term extend beyond one year, I am obligated to submit the Annual Status Report for surface Water Management System Construction.

PLEASE NOTE: If the actual construction commencement date is not known, Department staff should be so notified in writing in order to satisfy permit conditions.

\_\_\_\_\_  
Permittee or Authorized Agent

Title and Company

Date

Phone

Address



ENVIRONMENTAL RESOURCE PERMIT  
AS-BUILT CERTIFICATION BY A REGISTERED PROFESSIONAL

Permit Number:

Project Name:

I hereby certify that all components of this surface water management system have been built substantially in accordance with the approved plans and specifications and are ready for inspection. Any substantial deviations (noted below) from the approved plans and specifications will not prevent the system from functioning as designed when properly maintained and operated. These determinations are based upon on-site observation of the system conducted by me or by my designee under my direct supervision and/or my review of as-built plans certified by a registered professional or Land Surveyor licensed in the State of Florida.

Name (please print)

\_\_\_\_\_  
Signature of Professional

Company Name

Florida Registration Number

Company Address

Date

City, State, Zip Code

Telephone Number

(Affix Seal)

Substantial deviations from the approved plans and specifications:

(Note: attach two copies of as-built plans when there are substantial deviations)

Within 30 days of completion of the system, submit two copies of the form to:

## ENVIRONMENTAL RESOURCE PERMIT INSPECTION CERTIFICATION

Permit Number:

Project Number:

Inspection Date(s):

Inspection results: (check one)

I hereby certify that I or my designee under my direct supervision have inspected the system at the above referenced project and that the system appears to be functioning in accordance with the requirements of the permit and Chapter 373 F.S. (as applicable).

The following necessary maintenance was conducted:

I hereby certify that I or my designee under my direct supervision has inspected the system at the above referenced project and that the system does not appear to be functioning in accordance with the requirements of the permit and Chapter 373 F.S. (as applicable). I have informed the operation and maintenance entity of the following: (a) that the system does not appear to be functioning properly, (b) that maintenance is required to bring the system into compliance, and (c) if maintenance measures are not adequate to bring the system into compliance, the system may have to be replaced or an alternative design constructed subsequent to Department approval.

Name

\_\_\_\_\_  
Signature of Professional Engineer

Company Name

Florida Registration Number

Company Address

Date

City, State, Zip Code

Telephone Number

(affix seal)

Within 30 days of completion of the inspection, submit two copies of the form to the following Department Office:

Department of Environmental Protection

## Request for Transfer of Environmental Resource Permit Construction Phase to Operation Phase

(To be completed and submitted by the operating entity)

Florida Department of Environmental Protection

It is requested that Department Permit Number \_\_\_\_\_ authorizing the construction and operation of a surface water management system for the below mention project be transferred from the construction phase permittee to the operation phase operating entity.

Project:

From: Name:  
Address:  
City: State: Zip:

To: Name:  
Address:  
City: State: Zip:

The surface water management facilities are hereby accepted for operation and maintenance in accordance with the engineers certification and as outlined in the restrictive covenants and articles of incorporation for the operating entity. Enclosed is a copy of the document transferring title of the operating entity for the common areas on which the surface water management system is located. Note that if the operating entity has not been previously approved, the applicant should contact the Department staff prior to filing for a permit transfer.

The undersigned hereby agrees that all terms and conditions of the permit and subsequent modifications, if any, have been reviewed, are understood and are hereby accepted. Any proposed modifications shall be applied for and obtained prior to such modification.

Operating Entity:

\_\_\_\_\_  
Name

Title:

Telephone:

Enclosure

- copy of recorded transfer of title surface water management system
- Coy of plat(s)
- Copy of recorded restrictive covenants, articles of incorporation, and certificate of incorporation.

**Florida Department of Environmental Protection**  
**NPDES Stormwater Section**  
2600 Blair Stone Road, MS #2500  
Tallahassee, FL 32399-2400

- Carefully read the permit language.
- Develop and implement your SWPPP.
- Complete an NOI in its entirety.
- Submit the NOI along with the application fee of \$150 for small construction projects or \$300 for large construction projects to the Notices Center. Authorization is granted 48 hours after the date of the complete NOI is post-marked to DER. The Notices Center will send an acknowledgment letter after receiving and processing your complete NOI and fee.
- Re-apply for coverage every five years (if construction activity exceeds five years).

**Please Note**

*The application fee schedule for NPDES permits always refer to the most current version of Part 17, Florida Administrative Code (F.A.C.), to confirm the current fee schedule for your permit. Make checks payable to the Florida Department of Environmental Protection.*

**Where can I find more information?**

DER's web site provides more information on permit coverage and requirements, permit web links, and electronic versions of the CCR, all regulations and forms required, and SWPPP guidance. In addition, the NPDES Stormwater Notices Center provides hard copies of permits and forms.

**NPDES Stormwater Section**

Florida Department of Environmental Protection  
2600 Blair Stone Road, MS #2500  
Tallahassee, FL 32399-2400  
(850) 245-7522

NPDES-stormwater@dep.state.fl.us  
[www.dep.state.fl.us/water/stormwater/mpdcs/](http://www.dep.state.fl.us/water/stormwater/mpdcs/)

**NPDES Stormwater Notices Center**

Florida Department of Environmental Protection  
2600 Blair Stone Road, MS #2510  
Tallahassee, FL 32399-2400  
(866) 336-6312 (toll free) or (850) 297-1232



PRINTED ON RECYCLED PAPER





# Florida Department of Environmental Protection

Southwest District Office  
13051 North Telecom Parkway  
Temple Terrace, Florida 33637-0926

Charlie Crist  
Governor

Jeff Kottkamp  
Lt. Governor

Michael W. Sole  
Secretary

October 16, 2008

Mr. Wayne Roberts, P.E., Acting Director  
Manatee County Project Management  
1026 26<sup>th</sup> Avenue East  
Bradenton, FL 34208

Re: Minor Revision  
MC North WRF  
PA File No. FLA012617-020-DW1/MR  
Manatee County

Dear Mr. Roberts:

In accordance with Rule 62-620.325(2), Florida Administrative Code (FAC), the Department received your request for a minor revision of the permit conditions of the above-referenced domestic wastewater treatment facility permit, FLA012617, which expires on May 8, 2010.

This revision involves the construction of a new headworks and a drain lift station.

Prior to placing the new facilities into operation or any individual unit processes into operation, for any purpose other than testing for leaks and equipment operation, the permittee shall complete and submit to the Department DEP Form 62-620.910(12), Notification of Completion of Construction for Domestic Wastewater Facilities. [Rule 62-620.630(2), FAC, 10-23-00]

Within six months after a facility is placed in operation, the permittee shall provide written certification to the Department on Form 62-620.910(13) that record drawings pursuant to Chapter 62-600, F.A.C., and that an operation and maintenance manual pursuant to Chapters 62-600 and 62-610, F.A.C., as applicable, are available at the location specified on the form. [Rule 62-620.630(7), FAC, 10-23-00]

This permit revision authorizing the above changes must be attached to your original permit and, together with any other preceding modification/revision(s), becomes a part of that permit.

Sincerely,

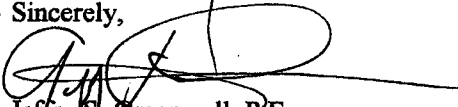
*for*  
  
Jeffrey S. Greenwell, P.E.  
Water Facilities Administrator  
Southwest District Office

JSG/mqm

cc: Daniel T. Gray, Utility Operations Director, Manatee County  
Craig P. Osmanski, P.E., URS Corporation  
Vicki Wheeler, Environmental Specialist, FDEP

PLOTTED January 15, 2009 3:08 PM PLOTTED BY: ELLS, DAVID  
 X:\MANATEE PROJECTS\12007031 INFLU STRUCTURE NWRP DESIGN\CADE\CONSTRUCTION DRAWINGS\M-8 MEC-HAN CAL DETAILS.DWG

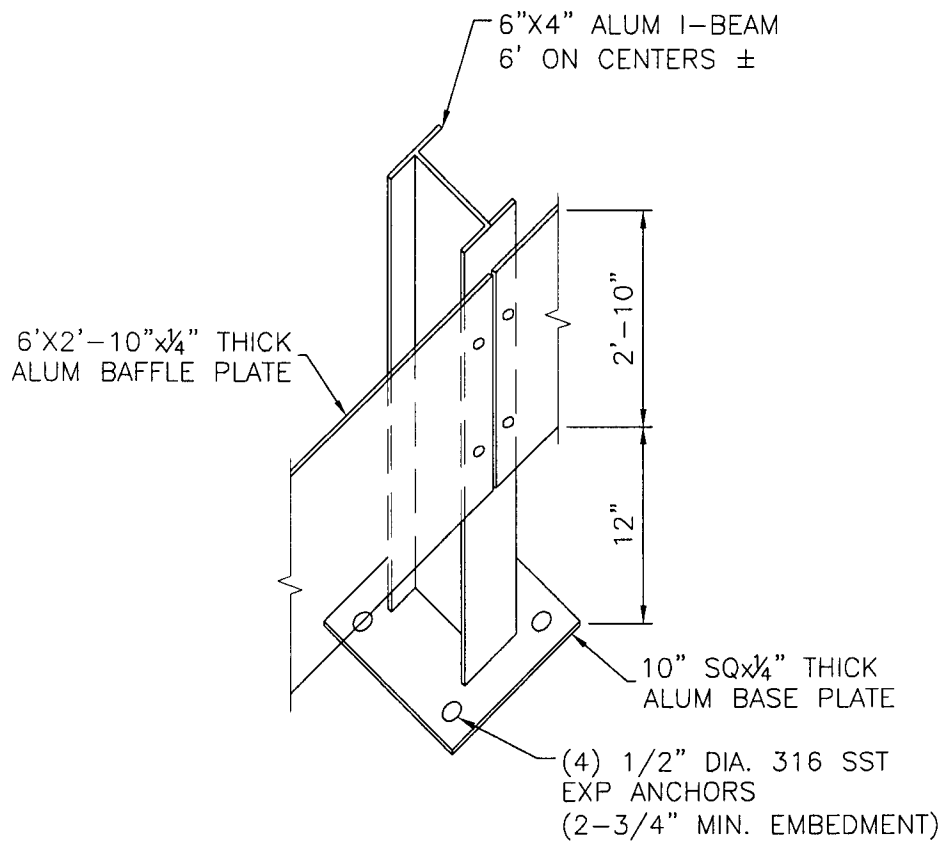

BAFFLE PLATE & SUPPORT

12
**DETAIL**  
 SCALE: NTS

<small>7650 West Courtney Campbell Cswy, Suite 700 Tampa, Florida 33607 Ph: (813) 286-1711 Fax: (813) 286-6587 Florida Engineering Number: 000002</small>	<p>INFLUENT STRUCTURE</p> <p>BAFFLE PLATE</p>	PROJECT NO.
		-
		DESN/APVD DME/CO
		DATE Jan 2009
		FIGURE NO.

**MANATEE COUNTY  
INFLUENT STRUCTURE AT THE  
NORTH WATER RECLAMATION FACILITY**

<u>Section No.</u>	<u>Description</u>	<u>Page No.</u>
<b>DIVISION 1 - GENERAL REQUIREMENTS</b>		
01005	General Requirements	01005-1
01010	Summary of Work	01010-1
01014	Construction Sequence	01014-1
01015	Control of Work	01015-1
01030	Special Project Procedures	01030-1
01045	Cutting and Patching	01045-1
01050	Field Engineering and Surveying	01050-1
01090	Reference Standards	01090-1
01150	Measurement and Payment	01150-1
01152	Request for Payment	01152-1
01153	Change Order Procedure	01153-1
01200	Project Meetings	01200-1
01310	Construction Schedule and Project Restraints	01310-1
01340	Shop Drawings, Project Data and Samples	01340-1
01370	Schedule of Values	01370-1
01380	Construction Photographs	01380-1
01410	Testing and Testing Laboratory Services	01410-1
01510	Temporary and Permanent Utilities	01510-1
01570	Traffic Regulation	01570-1
01580	Project Identification and Signs	01580-1
01600	Material and Equipment	01600-1
01620	Storage and Protection	01620-1
01700	Contract Closeout	01700-1
01710	Cleaning	01710-1
01720	Project Record Documents	01720-1
01721	Redline Drawings	01721-1
01730	Operating and Maintenance Data	01730-1
01740	Warranties and Bonds	01740-1



**MANATEE COUNTY  
INFLUENT STRUCTURE AT THE  
NORTH WATER RECLAMATION FACILITY**

<u>Section No.</u>	<u>Description</u>	<u>Page No.</u>
<b>DIVISION 2 - SITE WORK</b>		
02001	Special Provisions To Division 2	02001-1
02064	Modification to Existing Structures, Piping and Equipment	02064-1
02100	Site Preparation	02100-1
02220	Excavation, Backfill, Fill and Grading for Structures	02220-1
02221	Trenching, Bedding and Backfill for Pipe	02221-1
02223	Excavation Below Grade and Crushed Stone or Shell Refill	02223-1
02260	Finish Grading	02260-1
02276	Temporary Erosion and Sedimentation Control	02276-1
02355	Lumber Left in Place	02355-1
02430	Storm Drainage Structures	02430-1
02444	Fencing	02444-1
02480	Landscaping	02480-1
02485	Seeding and Sodding	02485-1
02513	Asphalt Concrete Paving	02513-1
02514	Soil Cement Base	02514-1
02515	Shell Base Materials	02515-1
02575	Pavement Repair and Restoration	02575-1
02615	Ductile Iron Pipe and Fittings	02615-1
02617	Installation and Testing of Pressure Pipe	02617-1
02622	PVC Pipe and Fittings (AWWA C-900 & C-905)	02622-1
02640	Valves and Appurtenances	02640-1
02999	Miscellaneous Work and Cleanup	02999-1

**DIVISION 3 – CONCRETE WORK**

03010	Concrete Work	03010-1
-------	---------------	---------

**DIVISION 4 – MASONRY**

04220	Unit Masonry	04220-1
-------	--------------	---------

**DIVISION 5 – METALS**

05500	Miscellaneous Metals	05500-1
-------	----------------------	---------

**MANATEE COUNTY  
INFLUENT STRUCTURE AT THE  
NORTH WATER RECLAMATION FACILITY**

<u>Section No.</u>	<u>Description</u>	<u>Page No.</u>
<b>DIVISION 7 – THERMAL MOISTURE PROTECTION</b>		
07500	Membrane Roofing	07500-1
<b>DIVISION 9 – FINISHES</b>		
09703	Protective Coatings	09703-1
09900	Heavy Duty Finishes	09900-1
<b>DIVISION 11 - EQUIPMENT</b>		
11295	Coplastix Slide and Weir Gates	11295-1
11310	Grit Removal System	11310-1
11314	Recessed Impeller Pumps	11314-1
11315	Self-Cleaning Influent Filters/Screen	11315-1
11316	Vertical Centrifugal Pumps	11316-1
<b>DIVISION 14 – CONVEYING SYSTEMS</b>		
14551	Shaftless Screw Conveyors and Appurtenances	14551-1
<b>DIVISION 15 – MECHANICAL</b>		
15110	Pipe Hangers and Supports	15110-1
15120	Process Piping and Appurtenances	15120-1
<b>DIVISION 16 – ELECTRICAL</b>		
16010	Basic Electrical Requirements	16010-1
16015	Basic Electrical Materials and Methods	16050-1
16060	Grounding	16060-1
16075	Electrical Identification	16075-1
16123	600 Volt or Less Wire and Cable	16123-1

**MANATEE COUNTY  
INFLUENT STRUCTURE AT THE  
NORTH WATER RECLAMATION FACILITY**

<u>Section No.</u>	<u>Description</u>	<u>Page No.</u>
16130	Raceways	16130-1
16135	Boxes	16135-1
16140	Wiring Devices	16140-1
16410	Enclosed Switches and Circuit Breakers	16410-1
16416	Transient Voltage Surge Suppressor	16416-1

**DIVISION 16 – ELECTRICAL, continued**

16442	Panelboards	16442-1
16444	Motor Controllers	16444-1
16461	Dry-Type Transformers	16461-1
16511	Lighting	16511-1
16800	Lightning Protection System	16800-1
16900	SCADA	16900-1

**DIVISION 17 – INSTRUMENTATION**

17010	Instrumentation	17010-1
-------	-----------------	---------

**SUPPLEMENTAL INFORMATION**

Geotechnical Report

**SECTION 07500**

**MEMBRANE ROOFING**

**PART 1 GENERAL**

**1.01 SCOPE OF WORK**

- A. Furnish all labor, materials, equipment and incidentals required and install single ply, adhered roofing membrane over insulation, provided herein, with base flashing, cap flashing, metal coping system, overflow scuppers, other flashing and appurtenances, all as shown on the Drawings and as specified herein.
- B. The entire roofing system shall be installed by a licensed, authorized roofing contractor of the system manufacturer providing the warranty. The roofing contractor shall be trained and qualified to install the system in strict accordance with the system manufacturer's details, specification and recommendations.

**1.02 SUBMITTALS**

- A. Submit to the Engineer, in accordance with Section 01340, shop drawings showing details of construction and installation for insulation with fastener layout, coping system, membrane, flashings, pourable sealer and other sealants and detailed technical data on membrane and flashing materials, insulation and all other components proposed. Submittals shall include at least the following:
  - 1. Provide, with shop drawings, certification that the roofer who will execute the work is an authorized applicator of the roofing system proposed.

**1.03 REFERENCE STANDARDS**

- A. American Society for Testing and Materials (ASTM)
  - 1. ASTM B32 - Standard Specification for Solder Metal.
  - 2. ASTM B370 - Standard Specification for Copper Sheet and Strip for Building Construction.
  - 3. ASTM C136 - Standard Test Method for Sieve Analysis of Fine and Coarse Aggregates.
  - 4. ASTM C165 - Standard Test Method for Measuring Compressive Properties of Thermal Insulation.
  - 5. ASTM C209 - Standard Test Methods for Cellulosic Fiber Insulating Board.
  - 6. ASTM C518 - Standard Test Method for Steady-State Heat Flux Measurements and Thermal Transmission Properties by Means of the Heat Flow Meter Apparatus.
  - 7. ASTM C755 - Standard Practice for Selection of Vapor Retarders for Thermal Insulation.

8. ASTM D297 - Standard Test Methods for Rubber Products-Chemical Analysis.
  9. ASTM D412 - Standard Test Methods for Vulcanized Rubber and Thermoplastic Rubbers and Thermoplastic Elastomers - Tension.
  10. ASTM D573 - Standard Test Method for Rubber-Deterioration in an Air Oven.
  11. ASTM D624 - Standard Test Method for Tear Strength of Conventional Vulcanized Rubber and Thermoplastic Elastomers.
  12. ASTM D746 - Standard Test Method for Brittleness Temperature of Plastics and Elastomers by Impact.
  13. ASTM D816 - Standard Test Methods for Rubber Cements.
  14. ASTM D1149 - Standard Test Method for Rubber Deterioration-Surface Ozone Cracking in a Chamber.
  15. ASTM D1622 - Standard Test Method for Apparent Density of Rigid Cellular Plastics.
  16. ASTM D2240 - Standard Test Method for Rubber Property-Durometer Hardness.
  17. ASTM E96 - Standard Test Methods for Water Vapor Transmission of Materials.
- B. Factory Mutual (FM)
1. FM 4450 - Class I Insulated Steel Deck Roofs.
- C. Underwriter Laboratories (UL)
1. UL 1256 - UL Standard for Safety Fire Test of Roof Deck Constructions.
- D. Steel Metal and Air Conditioning Contractors' National Association (SMACNA).
- E. Where reference is made to one of the above standards, the revision in effect at the time of bid opening shall apply.

**1.04 QUALITY ASSURANCE**

- A. Well in advance of commencement of roofing operations but after representative new roofing substrate has been constructed and prepared for roofing, a pre-roofing conference shall be held to inspect the substrate. All parties having an interest in the roofing or work on the roofs shall be informed of the conference by the Contractor.
- B. Parties to the conference shall include the Owner, Contractor, roofing subcontractor and his/her foreman, roofing membrane and insulation manufacturers, plumbing subcontractor, HVAC subcontractor and a representative of any other trade classification having work on a roof and deemed by the Owner to attend.

- C. The conference shall include an inspection by all parties of the membrane substrate and its conformance with the Drawings, the approved shop drawings and the approved roofing manufacturer's specifications and instructions. All objections to approval of the substrate shall be noted by the Owner's representative. Coordinate efforts to remedy objections and prepare the substrate properly to receive roofing and flashing so that the warranty can be issued. Work of this Section shall commence after remedies are made.

**1.05 DELIVERY, STORAGE AND HANDLING**

- A. Deliver materials with manufacturer's labels intact and legible.
- B. Store and handle roofing materials in a manner which will ensure that there is no possibility of significant moisture pick-up or damage. Store in a dry, well ventilated, weathertight place. Do not leave unused materials on the roof over night and when roofing work is not in progress. Remove damaged materials from the Site.

**1.06 MANUFACTURERS' INSTRUCTIONS, REPRESENTATION AND INSPECTION**

- A. The service of a representative of the membrane and of the insulation manufacturers shall be provided as required for instruction in preparation and application of roofing materials. The manufacturers shall supply such service and inspection as required to produce the warranted roofing system.

**1.07 WARRANTY**

- A. The roofing system shall be warranted for a period of 10 years by the membrane manufacturer and/or supplier to be watertight.
- B. This warranty shall be provided to the Owner upon completion of the insulated membrane system. Warranty shall be in written form, fully executed by the membrane manufacturer (Warrantor).
- C. In the event the roof fails to perform, the Warrantor shall make, at his/her expense, repairs to the roof to enable it to perform as warranted.

**PART 2 PRODUCTS**

**2.01 MATERIALS**

- A. Membrane roofing and flashing materials and components as specified below shall be as produced by Carlisle Tire and Rubber Co. or certified by them as compatible with system, all as required so that the warranty may be issued. An equal warranted system with an approved in-seam sealant system - Firestone; Goodyear or equal will be considered for approval. The materials, system and installation shall be as required to produce an acceptable FM Class 1, I90 roof.
  - 1. Membrane roofing - Ethylene Propylene Diene Monomer (EPDM) compounded elastomer, 0.060-in thick, fire retardant type, supplied in 10-ft widths and in longest possible lengths for roof size of the project, conforming to the following minimum physical properties.

- a. Color - Grey/Black
  - b. Specific Gravity - ASTM D297 - 1.18 plus or minus 0.03
  - c. Tensile Strength - ASTM D412 - 1305 psi minimum.
  - d. Elongation - ASTM D412 - 350 percent minimum.
  - e. Tear Resistance, Die C - ASTM D624 - 175 lbf/in minimum.
  - f. Shore A Hardness (5 Second Reading) - ASTM D2240 - 60 plus or minus 10
  - g. Ozone Resistance - ASTM D1149 - 7 days, 100 pphm, 104 degrees F, 50 percent Extension - No Cracks
  - h. Heat Aging (Accelerated) - ASTM D573 (7 days/240 degrees F) - Tensile strength minimum 1200 psi Elongation - minimum 225 percent, tear resistance - minimum 150 lbf/in.
  - i. Brittleness Temperature - ASTM D746 - minus 75 degrees F
  - j. Permeability, Water Vapor - ASTM E96 - Proc. BW - 2.0 perm-mils
  - k. Factory Seam Strength - ASTM D816, modified - Membrane ruptured
2. Membrane flashing - Uncured EPDM, 0.060-in thick, Carlisle Sure-Seal Elastofom Flashing.
  3. Tie-in flashing - Neoprene, 0.060-in thick, Carlisle Neoprene Elastofom Flashing.
  4. Provide bonding adhesive, splicing cement, in-seam sealant, water cut-off mastic, molded pipe flashing, Carlisle Sure-Seal Nite Seal, lap sealant, pourable sealer, rubber nailing strips with galvanized screw fasteners to wood and with approved galvanized fasteners to masonry, system recovery board and other required appurtenances, all as required for the completion of this project so that the warranty may be issued.
- B. Solder for metal flashing shall be ASTM B32 60/40 tin/lead with approved rosin flux.
  - C. Metal for flashing shall be ASTM B101, Type I, Class A, 16 oz lead coated copper, cold rolled for spring lock flashing and receiver piece and soft temper elsewhere. Spring lock pieces shall be able to be removed without deforming flashing.
  - D. Metal coping assembly shall be formed 0.063-in aluminum of the profile shown, Permasnap Coping System by Hickman Construction Products, similar by MM System Corp.; Metal-Era Inc., or equal with PVF<sub>2</sub> finish in black color as selected by the Owner. Provide with corners and intersections factory welded watertight, concealed splice plates (in matching color) and required support chairs and other system appurtenances. Mechanically fasten with drilled-in expansion anchors to withstand wind load of 130 mph.

1. Finish system shall be Kynar 500 PVF by Penwalt Corp., formulated by a licensed formulator to contain 70 percent PVF<sub>2</sub> resin and applied by a licensed applicator. Epoxy prime coat shall be applied to both sides to a dry film thickness of approximately 0.2 mil. One coat of PVF color coating shall be applied to exposed sides to provide a dry film thickness of not less than 0.8 mil, 1.0 mil total coating.
  2. The surface condition of this finish coat shall be 100 percent free of holidays, drip marks, scratches, roll marks or abrasions that are visible from a distance of 5-ft in good light when in installed position. Surfaces shall be free of checking, crazing, peeling, or loss of adhesion.
- G. Pipe flashing clamps shall be screw type, 300 series stainless steel as approved.

### **PART 3 EXECUTION**

#### **3.01 SUBSTRATE SURFACE**

- A. Steel deck surfaces to receive insulation shall be free of roughness or projections, with a smooth clean surface which will allow application of materials.
- B. Surfaces shall not contain any grease, oil or any other contaminants which could effect the insulation.

#### **3.02 ROOFING MEMBRANE INSTALLATION**

- A. The timing of roofing operations, with respect to adverse weather conditions, shall be subject to the approval of the Engineer. No roofing operations shall be started until surfaces to receive the same have been inspected and approved as to quality and condition. Roofing and flashing substrate materials shall be dry throughout, clean and free from depressions or projections.
- B. Good roofing practices shall be observed at all times subject to the approval of the Engineer.
- C. Adhere membrane 100 percent to the properly prepared substrate with system bonding cement applied at approved rate.
- D. Overlap adjacent membrane sheets 3-in minimum, clean with system cleaner and apply system splicing cement at approved rate. While cement is drying (before lapping), apply a bead of system in-seam sealant in approved configuration and where required. Lap and splice the sheets. When set, clean edge, apply system lap sealant and feather to completely cover splice edge.
- E. Provide additional securement for membrane at perimeter, at roof openings, at vertical walls and other protrusions using system fastener strips and approved fasteners.
- F. Use roof membrane material for required base flashing with the system uncured EPDM flashing at inside and outside corners and where approved. Provide system pourable sealer pockets where required. Terminate base flashings to membrane with system termination details as approved.
- G. Adhere roof walkway material to the completed membrane as shown and when ordered, following system methods.



- H. All installation shall be in accordance with the approved shop drawings, the details shown and the manufacturer's instructions all as required so the warranty may be issued.
- I. Provide pourable system sealer as required to make watertight all conduit and appurtenances.

**3.03 METAL FLASHING WORK AND COPING INSTALLATION**

- A. Surfaces to be covered with metal shall be free from defects of every description and clean of dirt and other foreign matter before sheet metal work is started.
- B. Provide flashings as indicated on the Drawings and in all locations where the use of flashing may reasonably be inferred as necessary to make the work of this Section complete in its intent to provide leakproof conditions throughout.
- C. Seams, unless otherwise specified or detailed, shall be flat locked and soldered. Tinning and soldering shall be done slowly with well-heated coppers. Pre-tin all copper in areas to be soldered. When soldering, ample solder shall be used so that the seam shall show at least 1-in of evenly flowed solder. A liberal amount of flux shall be brushed into the seam.
- D. Top piece of spring lock flashing shall be set in masonry under through-wall flashing. The counter flashing over the roof base flashing shall be separately installed spring lock pieces, lap jointed 6-in minimum and installed as shown. Provide fabricated inside corner pieces soldered watertight.
- E. Fabricate and install flashing in accordance with practices of SMACNA. Provide joints ready for caulking where required.
- F. Interlocking type expansion joints as approved shall be placed at 25-ft maximum along continuous flashing runs.
- G. Metal work when completed shall be thoroughly cleaned. Excess flux shall be neutralized by washing with a 5 to 10 percent solution of washing soda. After cleaning, metal shall be flushed with clean water.
- H. Fabricate and set pipe cap flashings, watertight as shown and as detailed on approved shop drawings.
- I. Mechanically fasten and install coping system watertight conforming to final shop drawings.

**3.04 ROOFING MEMBRANE FLOOD TESTING**

- A. All roof areas shall be given a 24-hour, 1-in minimum deep flood test. Repairs if required shall be performed at no additional cost to the Owner.

**END OF SECTION**