

Plotted By: Weisman, Drew    Sheet: Set-LAKE MANATEE WATERSHED IMPROVEMENTS PROJECT PHASE 2B (PART 1)    Layout: C10 COVER SHEET    March 26, 2025    05:08:44pm    K:\Lak-Civil\013735000 Duette Pres\Cadd\PlanSheets\C10 COVER SHEET.dwg    This document, together with the concepts and designs presented herein, as an instrument of service, is intended only for the specific purpose and client for which it was prepared. Reuse of and improper reliance on this document without written authorization and adaptation by Kimley-Horn and Associates, Inc. shall be without liability to Kimley-Horn and Associates, Inc.

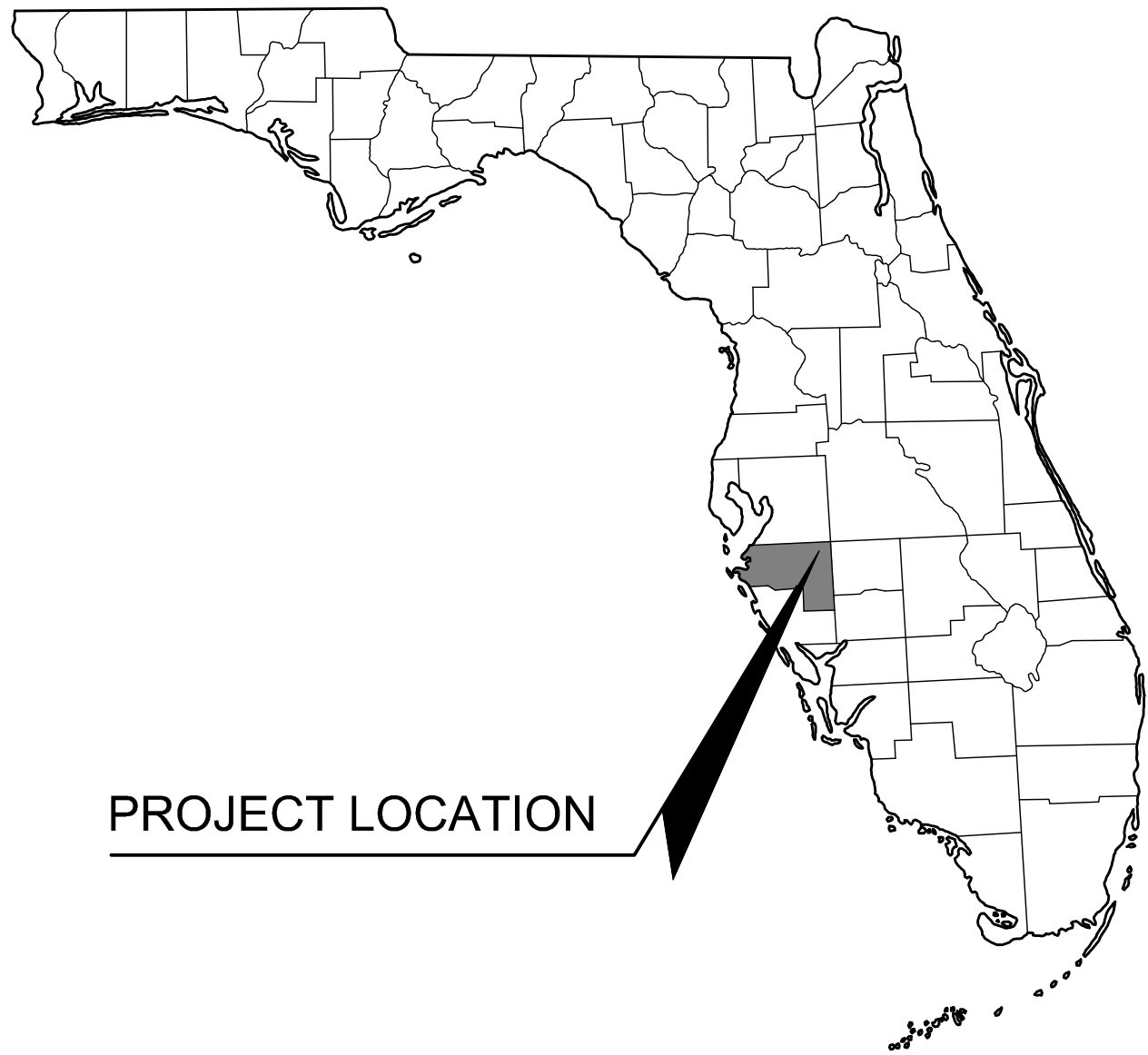

PROJECT LOCATION

PROJECT CONTACTS

**OWNER/APPLICANT:**  
MANATEE COUNTY BOARD OF COUNTY COMMISSIONERS  
MANATEE COUNTY PARKS AND NATURAL RESOURCES DEPARTMENT  
PO BOX 100  
BRADENTON, FLORIDA 34205  
CONTACT: CHARLIE HUNSICKER  
PHONE: (941) 742-5923

**ENGINEER:**  
KIMLEY-HORN AND ASSOCIATES, INC.  
109 KENTUCKY AVENUE  
LAKELAND, FL 33801  
PHONE: 704-333-5131  
CONTACT: ROBERT "BO" CONERLY, P.E.

**ENVIRONMENTAL SCIENTIST:**  
MANATEE COUNTY BOARD OF COUNTY COMMISSIONERS  
1112 MANATEE AVENUE WEST, SUITE 203  
BRADENTON, FL 34205  
PHONE: (941)-742-5980  
CONTACT: ALISSA POWERS P.W.S.

**SURVEYOR:**  
PARK COSTAL SURVEYING, LLC  
470 TREASURE ROAD  
VENICE, FLORID 34293  
PHONE: 941-493-7060  
CONTACT: TRAVIS D. PARK P.S.M.

**LIDAR SOURCE:**  
SOUTHWEST FLORIDA WATER MANAGEMENT DISTRICT  
PHONE: 352-796-7211

**FLORIDA POWER AND LIGHT:**  
PHONE: 941-776-5200

# FOR BID PURPOSES ONLY

## 100% PLANS

### FOR

# LAKE MANATEE WATERSHED

# IMPROVEMENTS PROJECT PHASE 2B

## (PART 1)

(MANATEE COUNTY WORK ASSIGNMENT #CO6006508)

## MARCH 2025

SECTION 31, TOWNSHIP 33 SOUTH, RANGE 22 EAST  
27°34'09.49"N 82°08'14.25"W

PROJECT LOCATION

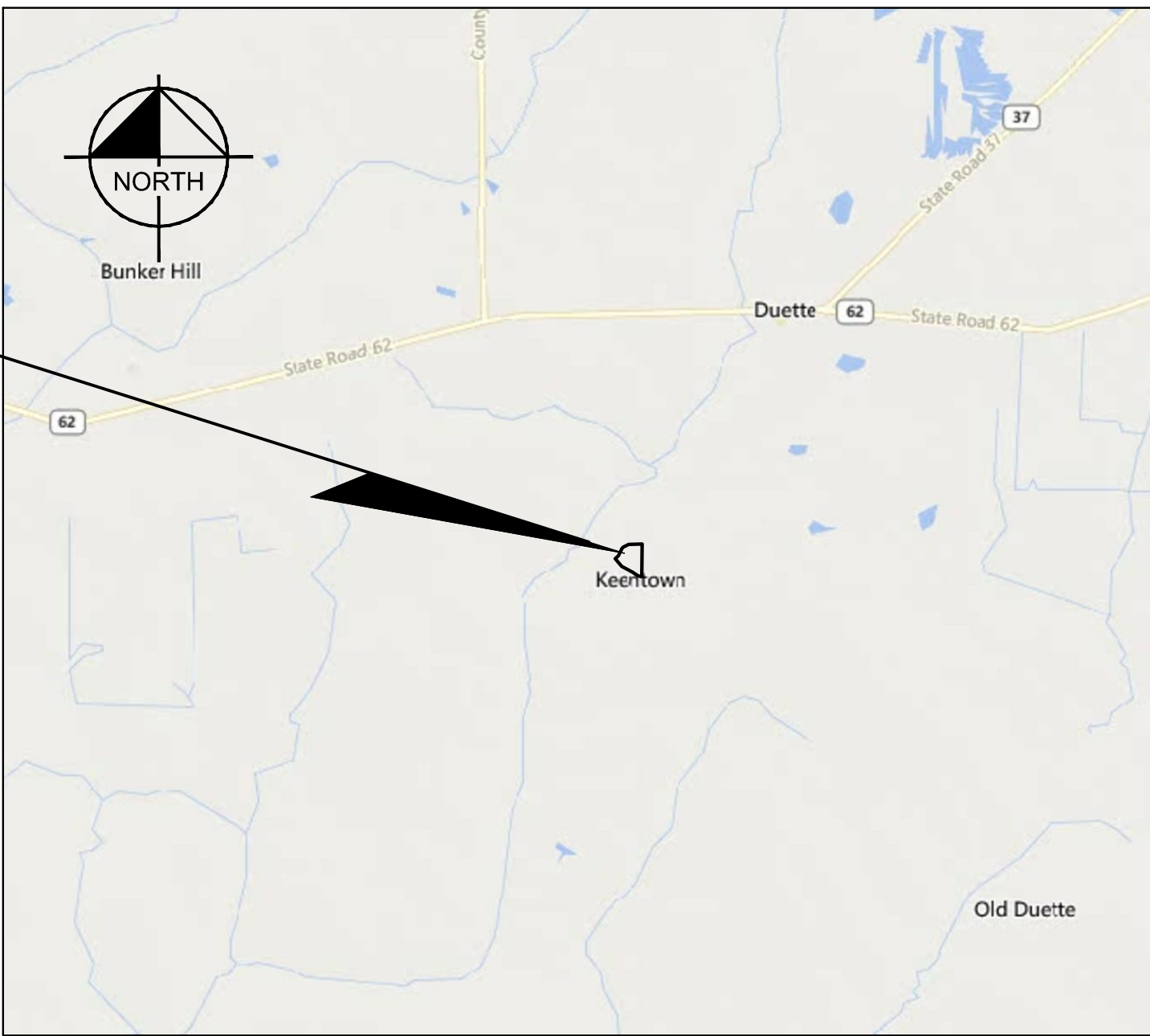

VICINITY MAP  
N.T.S.

Sheet List Table	
Sheet Number	Sheet Title
C10	COVER SHEET
C20	GENERAL NOTES
C30	EXISTING CONDITIONS
C40	OVERALL GRADING AND DRAINAGE PLAN
C41	DETAILED GRADING AND DRAINAGE PLAN PHASE 1
C42	DETAILED GRADING AND DRAINAGE PLAN PHASE 2
L0	LANDSCAPE PLAN
L1	LANDSCAPE SPECIFICATIONS
L2	LANDSCAPE DETAILS

GENERAL SITE CONSTRUCTION NOTES

- THE PURPOSE OF THIS PROJECT IS ECOLOGICAL RESTORATION. THE CONTRACTORS WORKING ON THIS SITE SHALL TAKE GREAT CARE IN AVOIDING UNNECESSARY IMPACTS TO WETLAND, VEGETATION, AND ANIMALS.
- THE INFORMATION PROVIDED IN THESE PLANS IS TO ASSIST THE CONTRACTOR IN ASSESSING THE NATURE AND EXTENT OF THE CONDITIONS WHICH MAY BE ENCOUNTERED DURING THE COURSE OF WORK. ALL CONTRACTORS ARE DIRECTED PRIOR TO BIDDING TO CONDUCT INVESTIGATIONS THEY DEEM NECESSARY TO ARRIVE AT THEIR OWN CONCLUSIONS REGARDING THE ACTUAL CONDITIONS THAT MAY BE ENCOUNTERED AND UPON WHICH THEIR BIDS WILL BE BASED.
- THE CONTRACTOR SHALL OBTAIN AND/OR VERIFY EXISTENCE OF ALL REQUIRED PERMITS PRIOR TO STARTING CONSTRUCTION. THE CONTRACTOR SHALL BE RESPONSIBLE FOR OBTAINING ANY PERMITS NOT FURNISHED BY THE OWNER.
- PRIOR TO THE START OF CONSTRUCTION ACTIVITY IT SHALL BE THE CONTRACTOR'S RESPONSIBILITY TO NOTIFY "SUNSHINE STATE ONE CALL (1-800-432-4770)", MANATEE COUNTY PUBLIC WORKS DEPARTMENT, FLORIDA POWER & LIGHT, VERIZON AND ANY OTHER UTILITIES (ELECTRIC, PHONE, GAS, CABLE, ETC.) IT IS THE CONTRACTORS RESPONSIBILITY TO TO PROTECT EXISTING UTILITIES FROM DAMAGE.
- ALL MATERIALS AND CONSTRUCTION SHALL BE IN ACCORDANCE WITH NRCS STANDARDS AND SPECIFICATIONS.
- IF HUMAN REMAINS OR ARCHEOLOGICAL ARTIFACTS ARE DISCOVERED DURING THE COURSE OF CONSTRUCTION, THE CONTRACTOR MUST STOP WORK IMMEDIATELY AND PROMPTLY NOTIFY THE PROJECT MANAGER.
- THE CONTRACTOR SHALL NOT ENTER UPON, OR ALTER THE WETLAND PRESERVE AREAS THAT MAY BE ONSITE OR DIRECTLY ADJACENT TO THE PROJECT AREA EXCEPT AS NOTED IN THESE DRAWINGS. ALL WORK PERFORMED IN THE VICINITY OF OPEN WATER AND/OR WETLANDS IS TO BE PERFORMED IN COMPLIANCE WITH THE ENVIRONMENTAL PERMITS FOR THE SITE. THE CONTRACTOR WILL BE RESPONSIBLE FOR ANY FINE RESULTING FROM VIOLATION OF PERMIT CONDITIONS.
- IT IS THE CONTRACTORS RESPONSIBILITY TO CALCULATE AND VERIFY ALL CUT AND FILL QUANTITIES OF EARTHWORK FOR THE PROJECT. A BULKING FACTOR SHOULD BE TAKEN INTO ACCOUNT WHEN FIGURING VOLUMES OF FILL PLACEMENT.
- IMMEDIATELY BEFORE REQUESTING FINAL INSPECTIONS, THE CONTRACTOR SHALL CHECK ALL LINES AND DRESS TO THE PROPER GRADES/CONTOURS. ALL AREAS ARE TO BE STABILIZED AND MAINTAINED UNTIL SPECIFIED. THE CONTRACTOR SHALL MAKE ALLOWANCES WHEN ROUGH GRADING FOR THE FINISHED GRADES IN THESE AREAS.
- POST GRADING SOIL CONDITIONS SHALL BE APPROPRIATE FOR PLANTING WITH LIMITED COMPACTION AS DETERMINED BY THE PROJECT ECOLOGIST.
- ANY DISTURBED AREA WILL BE SEEDED/MULCHED, HYDROSEEDDED, OR SODDED OR PLANTED WITH MATERIALS AS SPECIFIED IN THE PLANS.
- ALL PLANT MATERIAL TO BE INSTALLED SHALL BE HEALTHY, IN GOOD CONDITION, FREE FROM DISEASE AND APPROVED BY A QUALIFIED ECOLOGIST PRIOR TO INSTALLATION.
- DURING CONSTRUCTION OF SPOIL REMOVAL SITES, WORK WILL BE DONE FORM UPLANDS TO THE EXTENT POSSIBLE. IN AREAS WHERE EQUIPMENT IS USED TO PERFORM SPOIL REMOVAL IS REQUIRED TO CROSS WETLANDS/WATERS OF THE UNITED STATES THE PROJECT ECOLOGIST WILL MONITOR THE OPERATION AND ENSURE MINIMAL DAMAGE TO SOIL AND VEGETATION OCCURS. NO EXCAVATED MATERIAL WILL BE PLACED IN WETLANDS AND ANY ALTERATIONS TO GRADE FROM SPOIL REMOVAL WILL BE REPAIRED.
- NO DEWATERING IS PROPOSED. IF DEWATERING IS TO OCCUR, PRIOR APPROVAL FROM SWFWMD WILL BE OBTAINED BY CONTRACTOR.

PREPARED BY

**Kimley»Horn**

© 2025 KIMLEY-HORN AND ASSOCIATES, INC.  
109 SOUTH KENTUCKY AVENUE, LAKELAND, FL 33801  
PHONE: 863-701-87021  
WWW.KIMLEY-HORN.COM  
CA00000696



THE SITE CONSTRUCTION STAKEOUT SHALL BE PERFORMED UNDER THE DIRECTION OF A FLORIDA REGISTERED SURVEYOR. AUTOCAD FILES WILL BE FURNISHED TO AID IN THE SITE CONSTRUCTION STAKEOUT. ANY DISCREPANCIES FOUND BETWEEN AUTOCAD FILES AND SITE CONSTRUCTION PLANS SHALL BE BROUGHT TO THE ENGINEER'S ATTENTION FOR CLARIFICATION PRIOR TO THAT STAKEOUT.

**Kimley»Horn**

© 2024 KIMLEY-HORN AND ASSOCIATES, INC.  
109 SOUTH KENTUCKY AVENUE, LAKELAND, FL 33801  
PHONE: 863-701-8702  
WWW.KIMLEY-HORN.COM REG NO. 35106

This item has been digitally signed and sealed by Robert B. Conerly, P.E. using a Digital Signature on the date adjacent to the seal. Printed copies of this document are not considered signed and sealed and the signature must be verified on any electronic copies.

KHA PROJECT	DATE	SCALE	AS SHOWN	DESIGNED BY	RBC	DRAWN BY	JJS	CHECKED BY	RBC
013735000	AUGUST 2025								

COVER SHEET

LAKE MANATEE WATERSHED  
IMPROVEMENTS PROJECT  
PHASE 2B (PART 1)  
PREPARED FOR  
MANATEE COUNTY

SHEET NUMBER  
C10

No.	REVISIONS	DATE	BY

MANATEE COUNTY











This document, together with the concepts and designs presented herein, as an instrument of service, is intended only for the specific purpose and client for which it was prepared. Reuse of and improper reliance on this document without written authorization and adaptation by Kimmel-Horn and Associates, Inc. shall be without liability to Kimmel-Horn and Associates, Inc.

[illegible]

**Kimley»»Horn**

**Kimley»»Horn**  
© 2024 KIMLEY-HORN AND ASSOCIATES, INC.  
109 SOUTH KENTUCKY AVENUE, LAKELAND, FL 33801  
PHONE: 863-701-8702  
WWW.KIMLEY-HORN.COM REG. NO. 35106

This item has been digitally signed and sealed by Robert B. Conerly, P.E. using a Digital Signature on the date adjacent to the seal.  
Printed copies of this document are not considered signed and sealed and the signature must be verified on any electronic copies.

KHA PROJECT 013735000	DATE AUGUST 2025	SCALE AS SHOWN	DESIGNED BY RBC	DRAWN BY DMS	CHECKED BY RBC
--------------------------	---------------------	----------------	-----------------	--------------	----------------

# OVERALL GRADING AND DRAINAGE PLAN

LAKE MANATEE WATERSHED  
IMPROVEMENTS PROJECT PHASE  
2B (PART 1)  
PREPARED FOR  
MANATEE COUNTY

SHEET NUMBER  
**C40**



Plotted By: Wisman, Drew    Street: Set-Lake Manatee Watershed Improvements Project Phase 2B (Part 1)    LAYOUT: C41    DETAILED GRADING AND DRAINAGE PLAN PHASE 1    March 26, 2025    05:09:30pm    K:\LAK-CIV\013735000 Duetta Pres\Cadd\PlanSheets\C41 DETAILED GRADING AND DRAINAGE PLAN.dwg    This document, together with the concepts and designs presented herein, as an instrument of service, is intended only for the specific purpose and client for which it was prepared. Reuse of and improper reliance on this document without written authorization and adaptation by Kimley-Horn and Associates, Inc. shall be without liability to Kimley-Horn and Associates, Inc.

LEGEND

- EXISTING CONTOUR
- EXISTING WETLAND LINE
- PROJECT BOUNDARY
- EXISTING OUTLET PIPES
- SILT FENCE
- TEMPORARY DITCH
- TEMPORARY PIPE
- BUFFER LINE

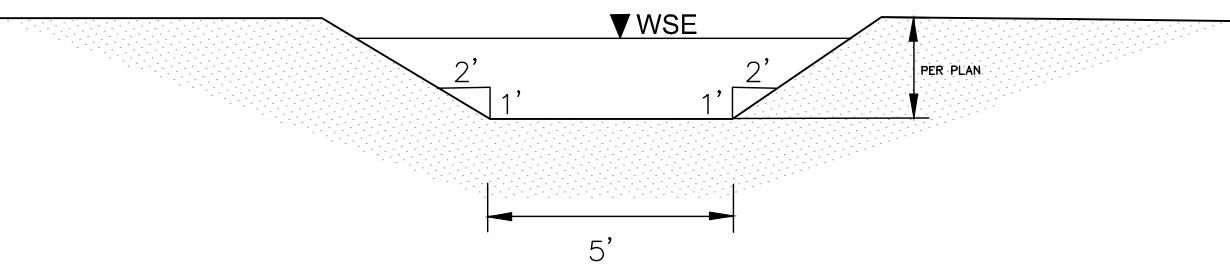

BY-PASS DIVERSION DITCH  
SCALE: NOT TO SCALE

REV. 12/01/2017 Kimley-Horn

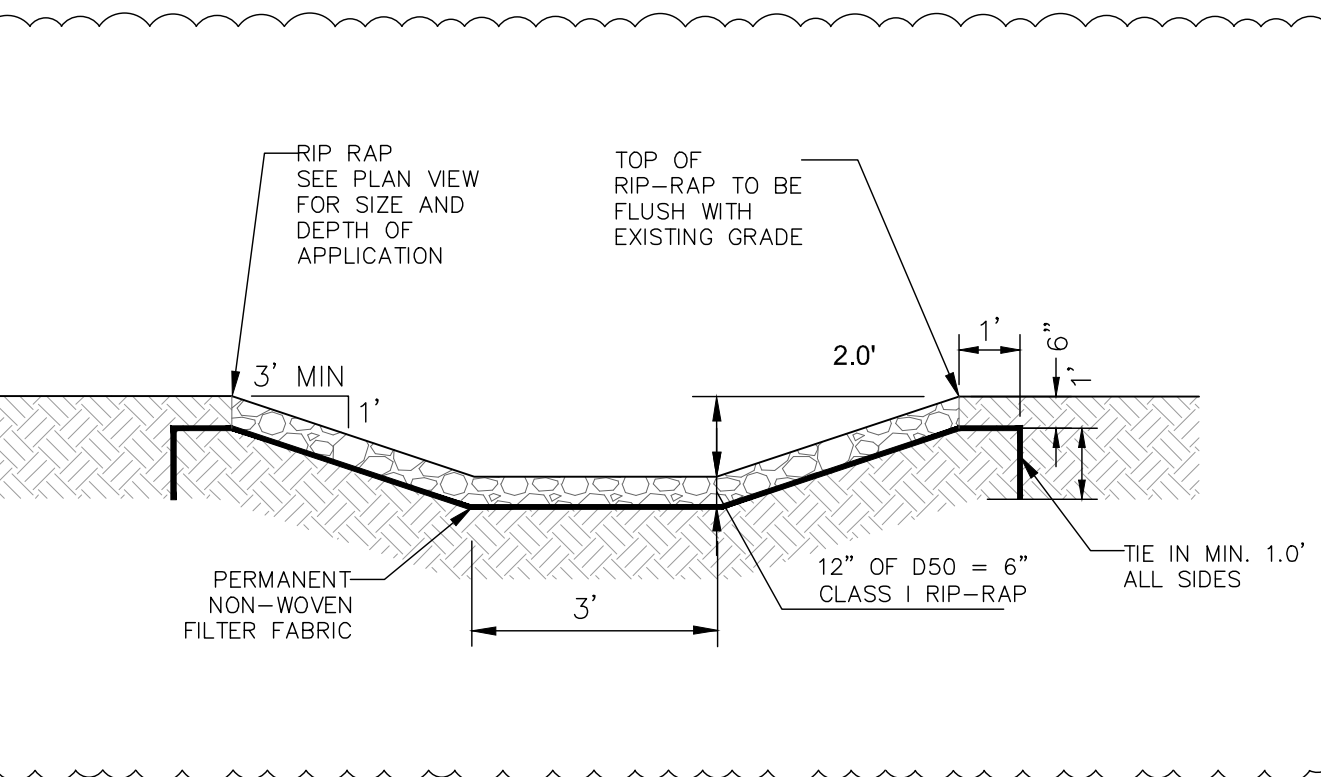

SPREADER SWALE  
SCALE: NOT TO SCALE

REV. 12/01/2017 Kimley-Horn

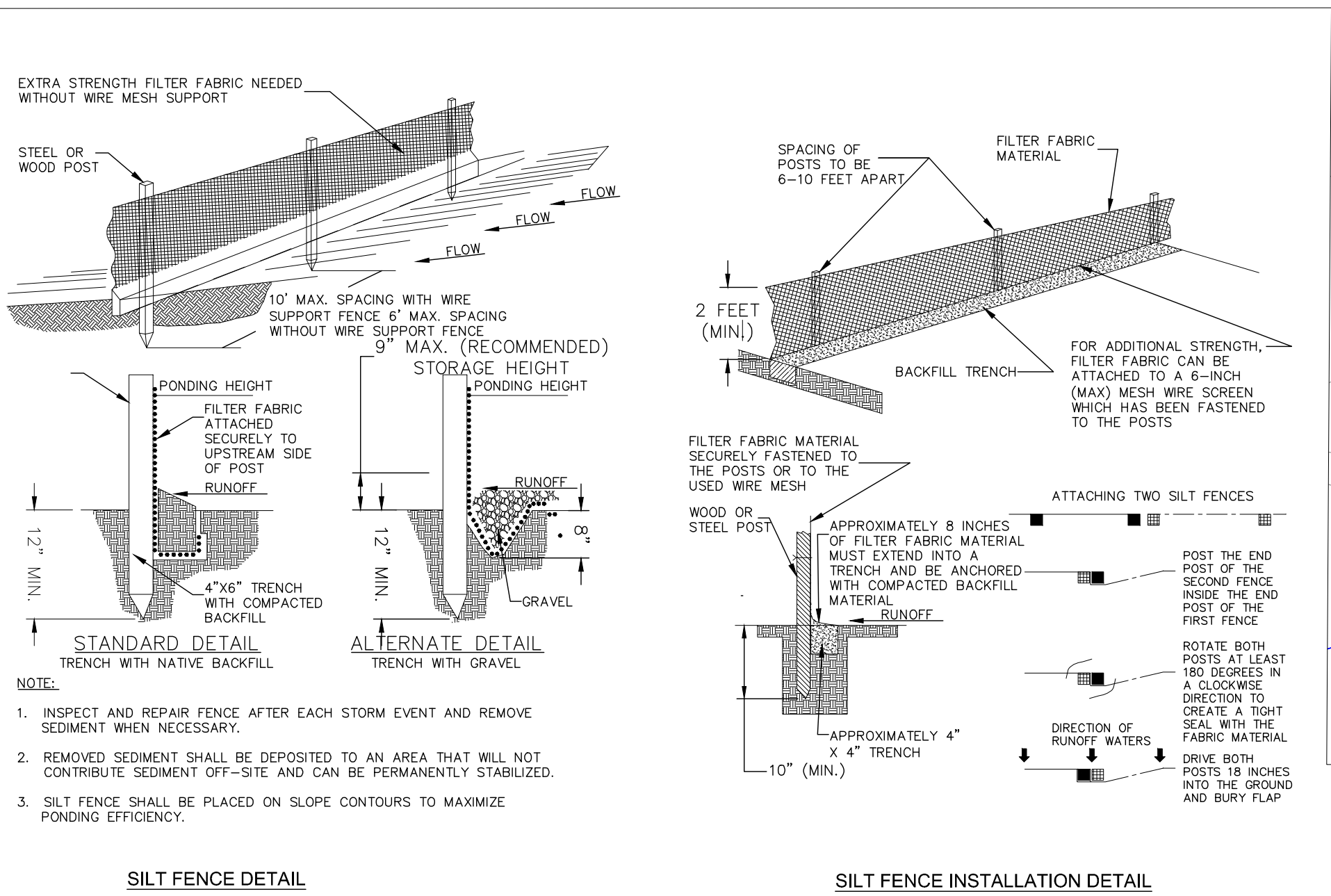

SILT FENCE DETAIL

SILT FENCE INSTALLATION DETAIL

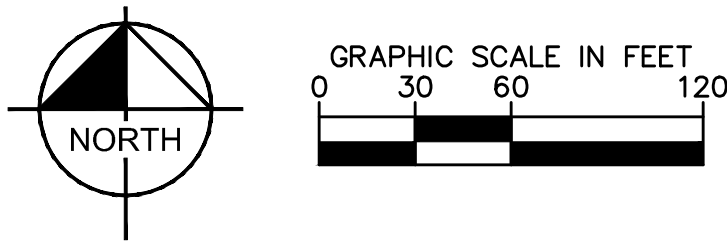
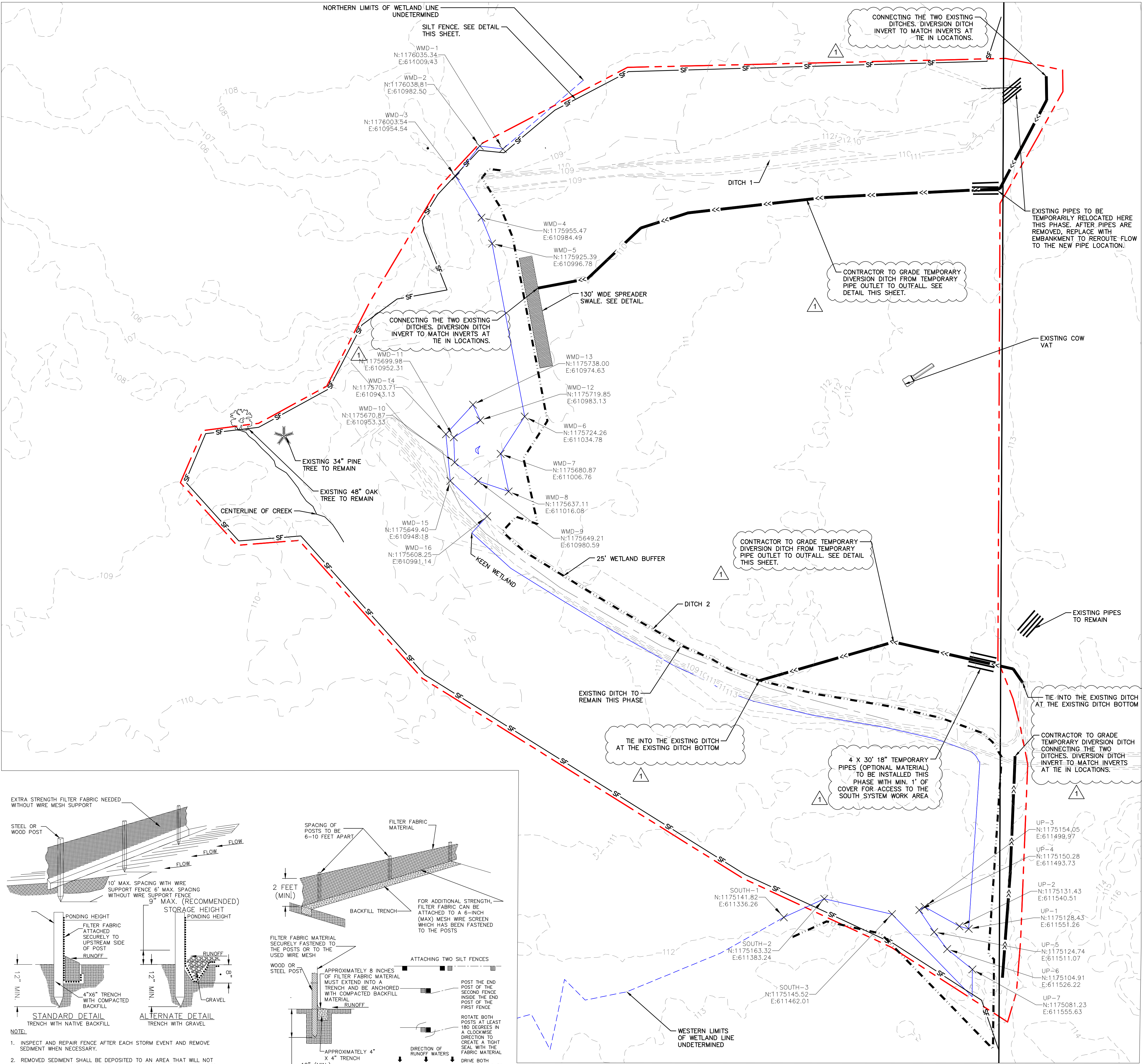

KHA PROJECT D13735000		DATE AUGUST 2025		SCALE AS SHOWN		DESIGNED BY RBC		DRAWN BY BWM		CHECKED BY RBC	
LAKE MANATEE WATERSHED IMPROVEMENTS PROJECT PHASE 2B (PART 1) PREPARED FOR MANATEE COUNTY						FL					
SHEET NUMBER C41						MANATEE COUNTY					
DETAILED GRADING AND DRAINAGE PLAN PHASE 1						KIMLEY-HORN					
© 2024 KIMLEY-HORN AND ASSOCIATES, INC. 109 SOUTH KENTUCKY AVENUE, LAKELAND, FL 33801 PHONE: 863-701-8702 WWW.KIMLEY-HORN.COM REG. NO. 35106						1 UPDATES: BID REF NO. 1 REVISIONS DATE BY					



	CUT (CY)	FILL (CY)	INSIDE WETLAND (SQ FT)	INSIDE BUFFER (SQ FT)	UPLAND CUT (SQ FT)
DITCH 1	4,440	245	0	1,160	62,617
DITCH 2	1,690	890	59	13,950	15,053
KEEN 2	1	251	19,003	235	0
KEEN 3	3,551	1	35,560	234	0
KEEN 4	5,530	31	65,386	5,998	301

LEGEND

- EXISTING CONTOUR
- PROPOSED CONTOUR
- EXISTING WETLAND LINE
- PROPOSED RIP-RAP
- PROPOSED WETLAND TREATMENT AREA
- PROPOSED WETLAND ENHANCEMENT AREA
- PROPOSED TRAIL CROSSING
- PROJECT BOUNDARY
- EXISTING OUTLET PIPES
- SILT FENCE
- TURBIDITY BARRIER
- PROPOSED PIPE
- BUFFER LINE

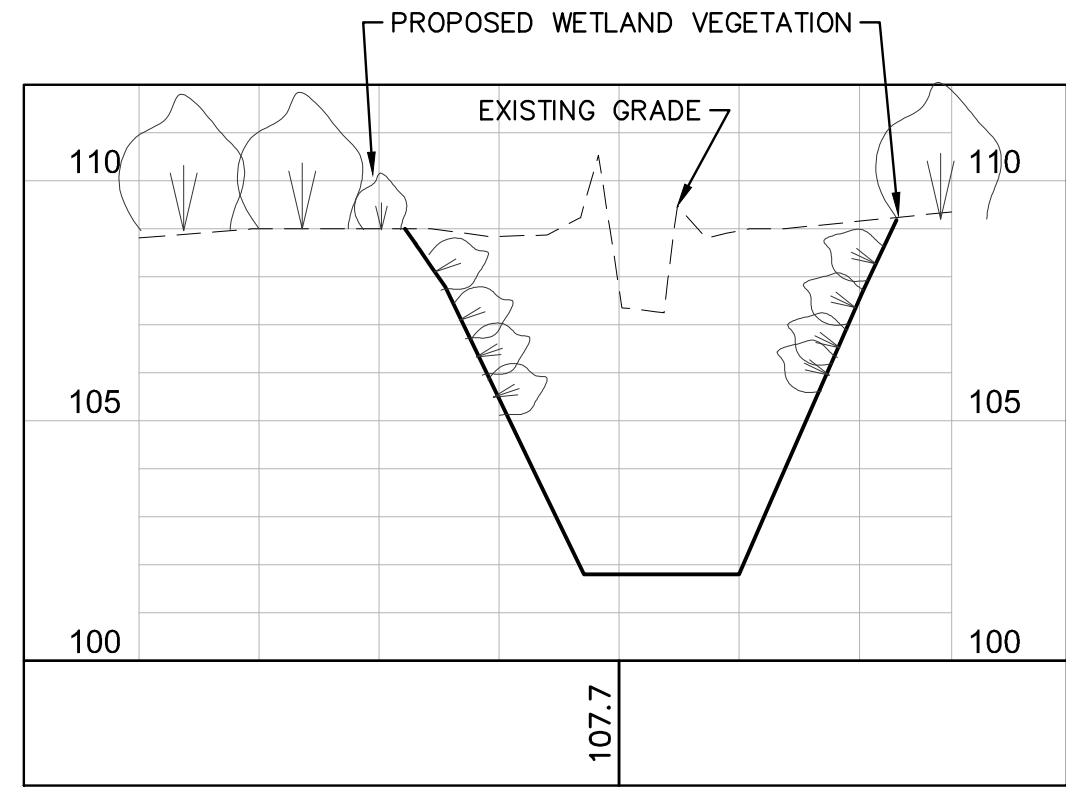
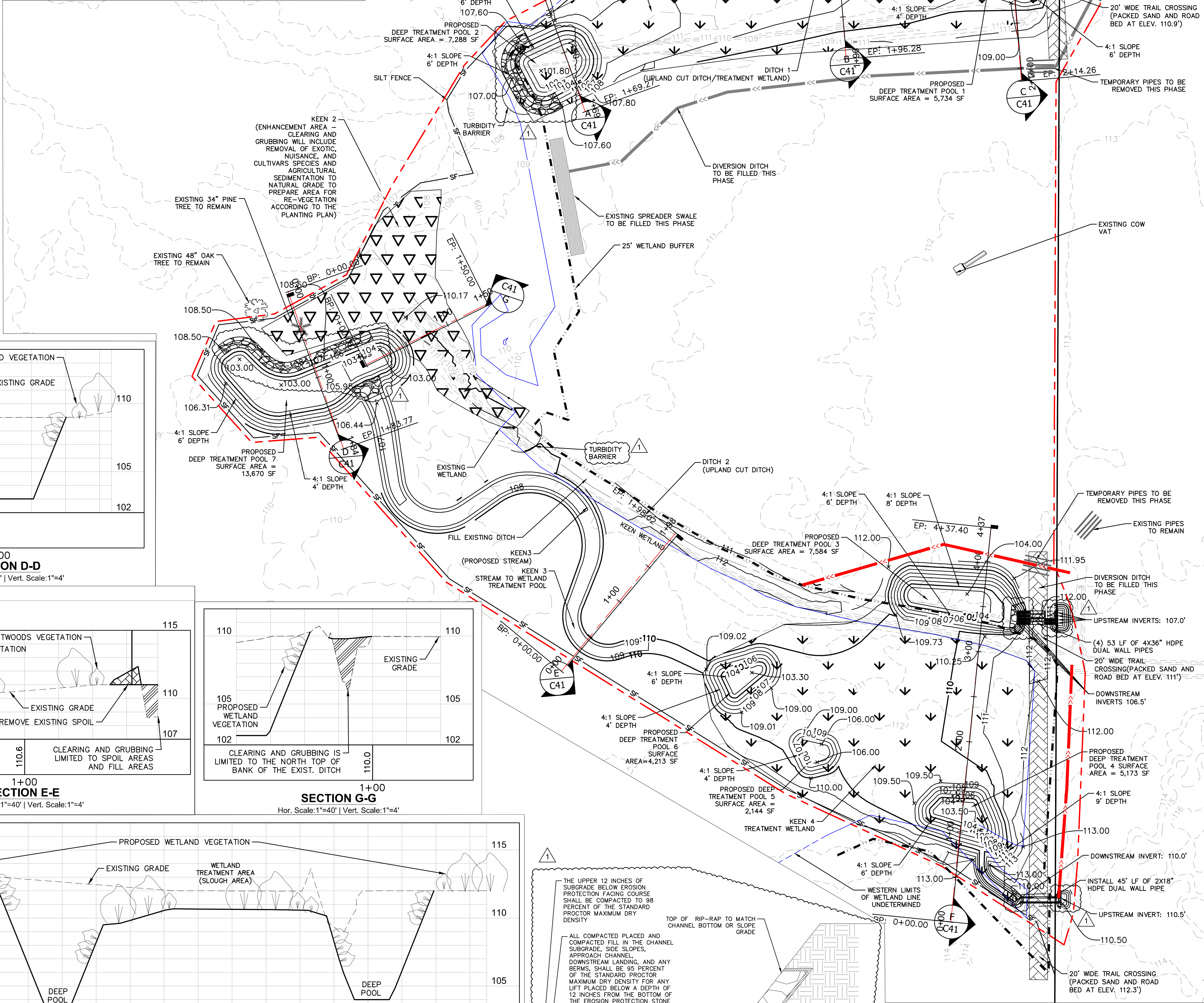

SECTION A-A  
Hor. Scale: 1"=40' | Vert. Scale: 1"=4'

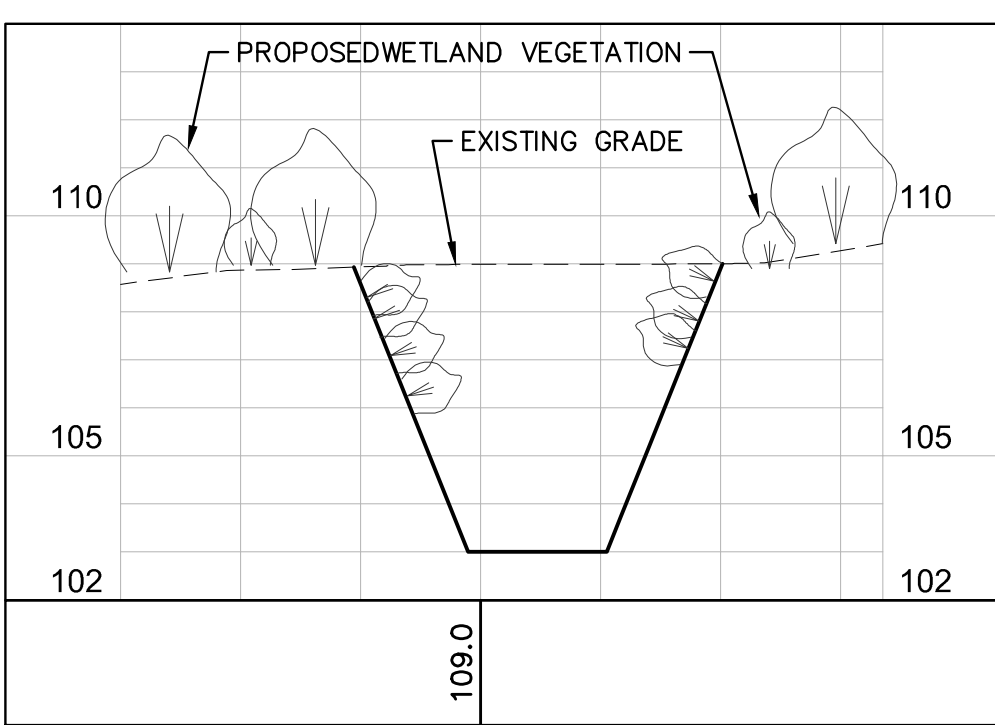

SECTION D-D  
Hor. Scale: 1"=40' | Vert. Scale: 1"=4'

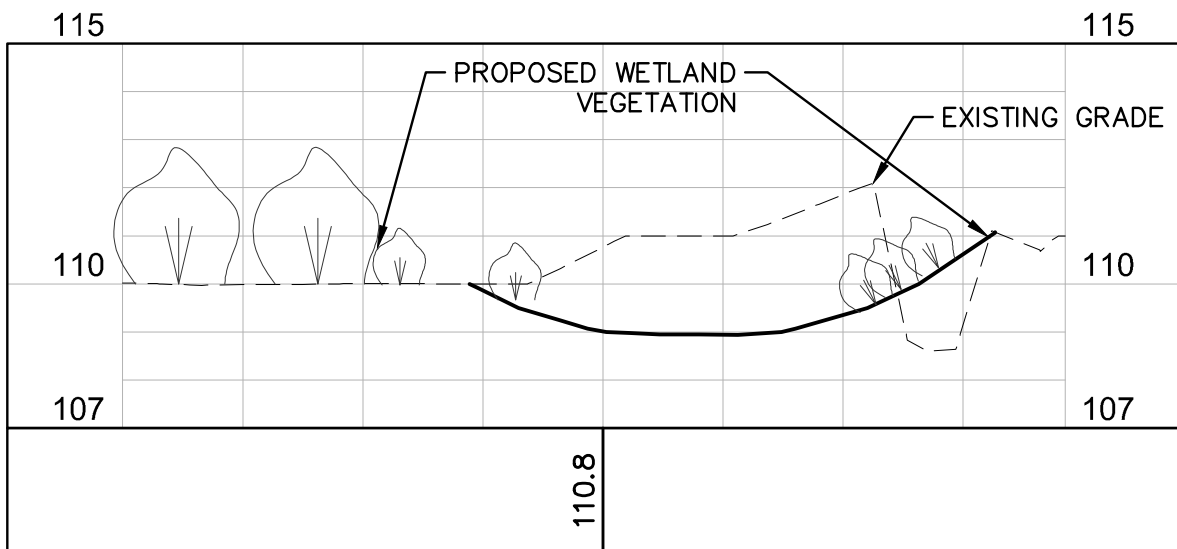

SECTION B-B  
Hor. Scale: 1"=40' | Vert. Scale: 1"=4'

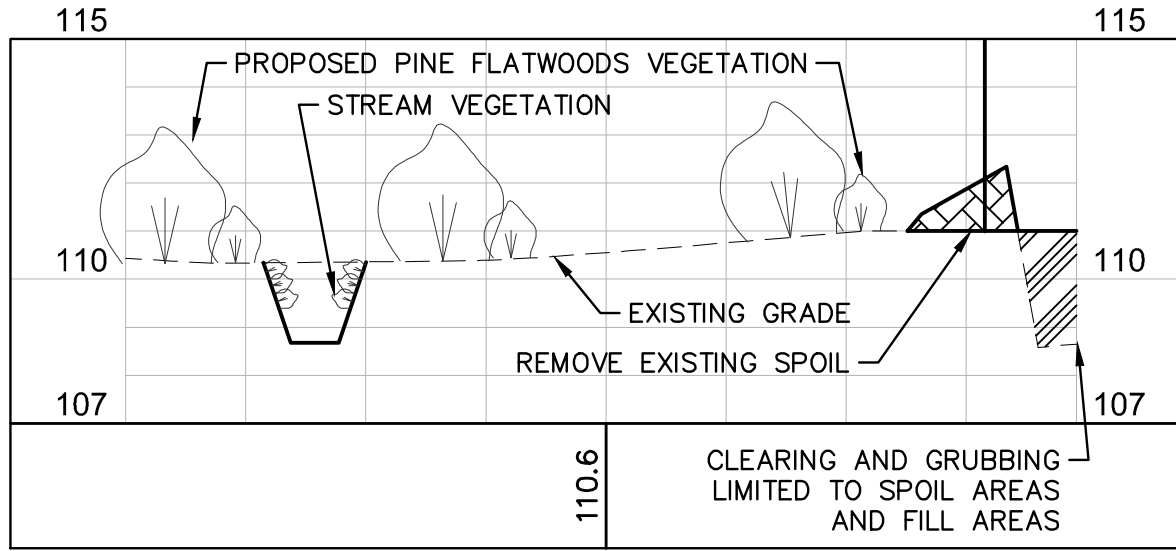

SECTION E-E  
Hor. Scale: 1"=40' | Vert. Scale: 1"=4'

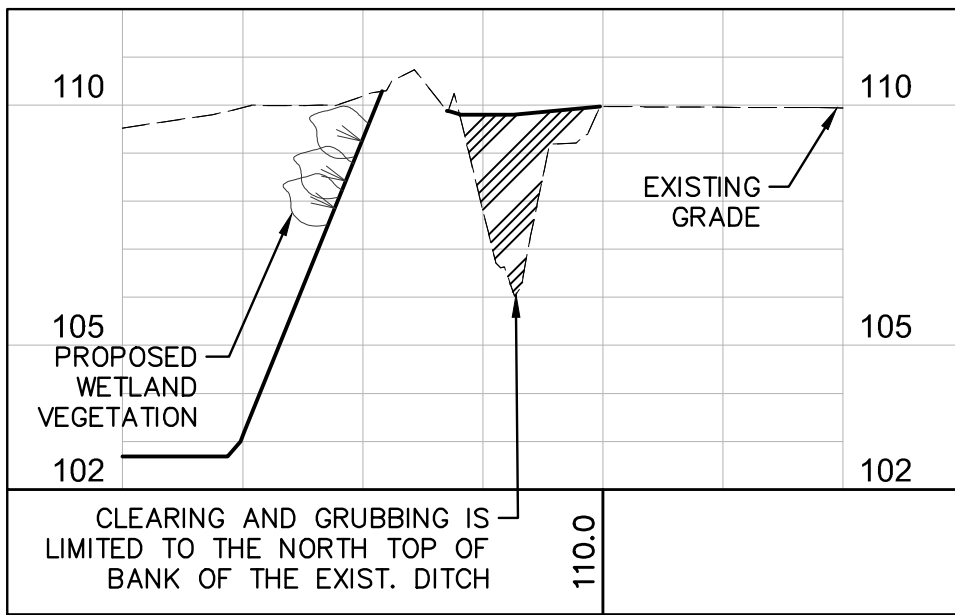

SECTION G-G  
Hor. Scale: 1"=40' | Vert. Scale: 1"=4'

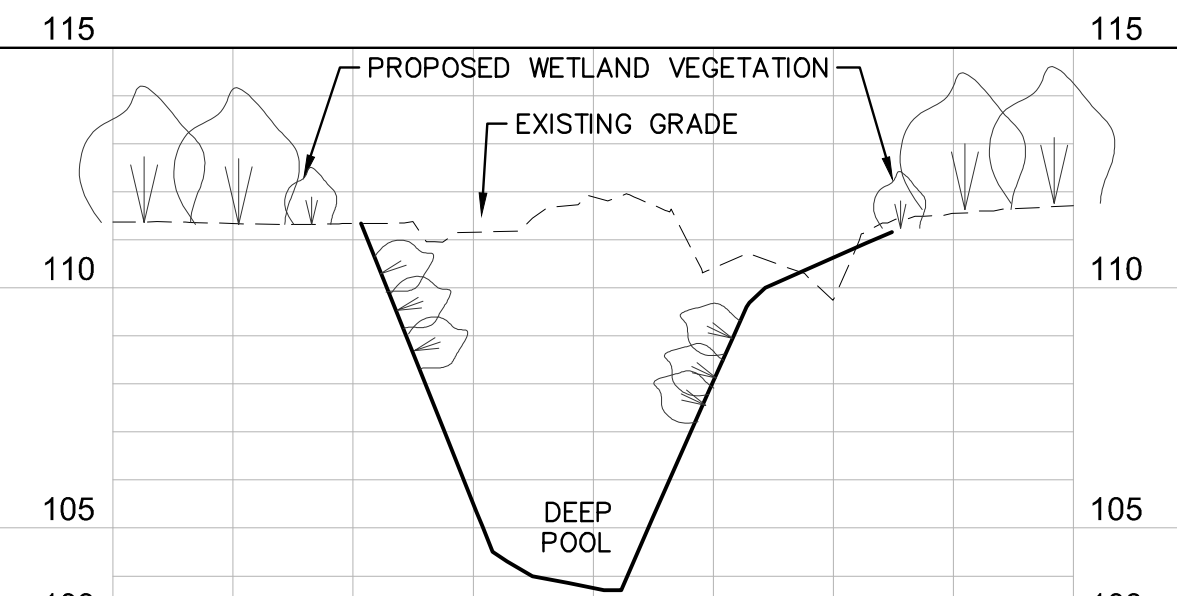

SECTION C-C  
Hor. Scale: 1"=40' | Vert. Scale: 1"=4'

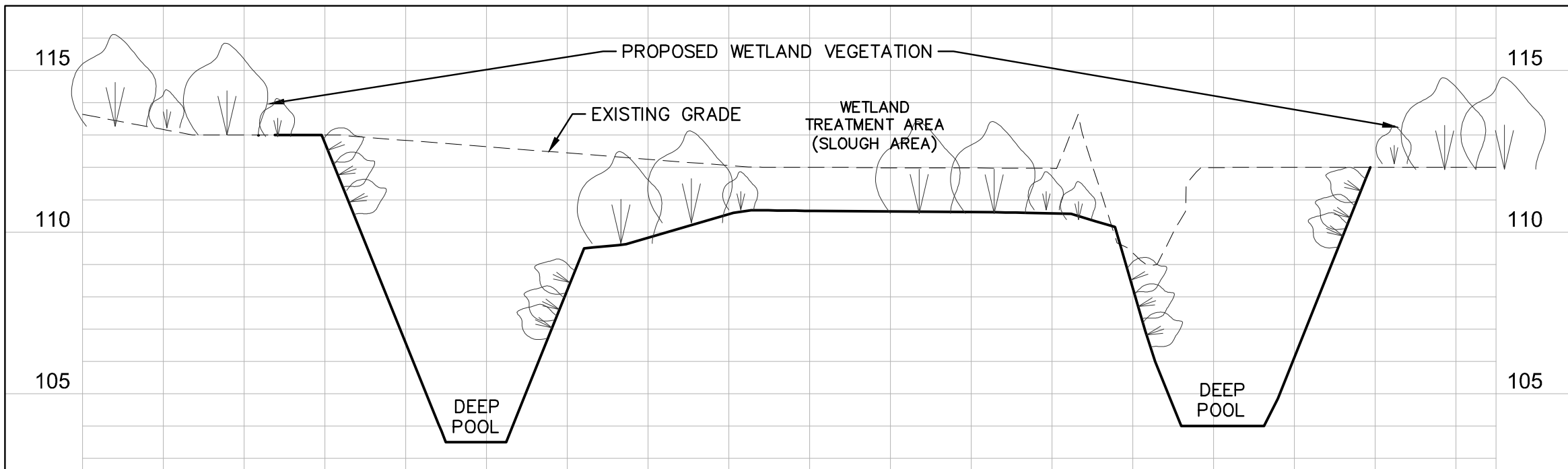

SECTION F-F  
Hor. Scale: 1"=40' | Vert. Scale: 1"=4'

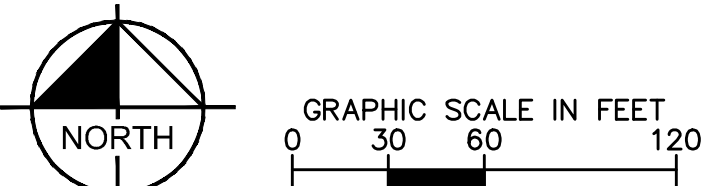
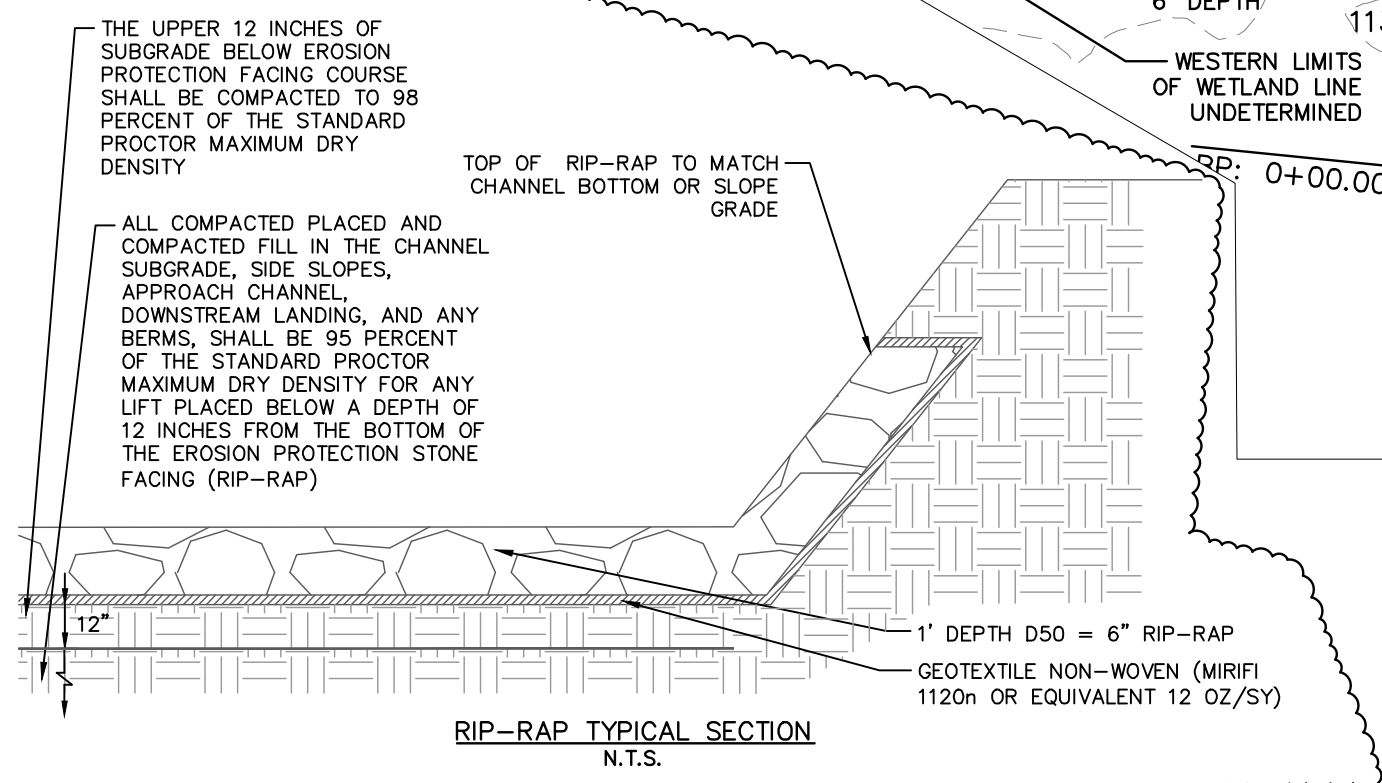

**Kimley»Horn**  
© 2024 KIMLEY-HORN AND ASSOCIATES, INC.  
109 SOUTH KENTUCKY AVENUE, LAKELAND, FL 33801  
PHONE: 863-701-8702  
WWW.KIMLEY-HORN.COM REG. NO. 35106

This item has been digitally signed and sealed by Robert B. Connelly, P.E. using a Digital Signature on the date adjacent to the seal. Printed copies of this document are not considered signed and sealed, and the signature must be verified on any electronic copies.

KHA PROJECT	DATE	SCALE	AS SHOWN	DESIGNED BY	RBC	DRAWN BY	BWM	CHECKED BY	RBC
013735000	AUGUST 2025								

DETAILED GRADING AND DRAINAGE PLAN  
PHASE 2

LAKE MANATEE WATERSHED  
IMPROVEMENTS PROJECT PHASE  
2B (PART 1)  
PREPARED FOR  
MANATEE COUNTY  
MANATEE COUNTY  
FL