

SIZE	"A"	"B"	"C"	"D"	"E"	"F"
4"x3/16"	4"	3/16"	3/16"	3/4"	1/4"	4
6"x3/8"	6"	3/8"	3/8"	7/8"	1/4"	6
9"x3/8"	9"	3/8"	3/8"	1"	1/4"	8

NOTES:

1. NON-ROUND CENTER BULBS SHALL HAVE A MINIMUM OUTSIDE DIMENSION OF 'D'.
2. SEE SPLICE DETAIL (0315-011)
3. BULB TYPE WATERSTOP SHOWN IS REQUIRED FOR EXPANSION AND CONTROL JOINTS. SIMILAR WATERSTOPS WITHOUT CENTER BULB MAY BE SUBSTITUTED AT CONSTRUCTION JOINTS.
4. USE 6 INCH WATERSTOPS IN ALL CONSTRUCTION JOINTS UNLESS SPECIFICALLY SHOWN OTHERWISE.

PLASTIC WATERSTOP

NTS

© CH2M HILL

0315-001

MITER CORNERS OF VERTICAL JOINTS & WELD SIMILAR AS SHOWN BELOW FOR IN-PLANE JOINTS

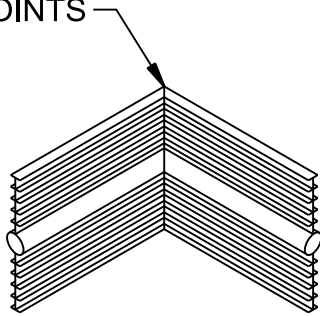

VERTICAL ELL

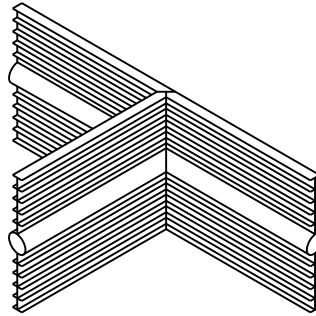

VERTICAL TEE

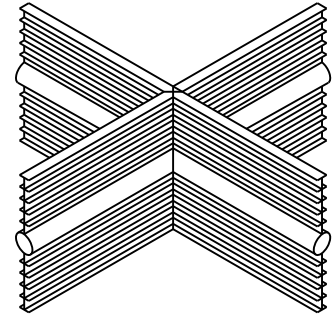

VERTICAL CROSS

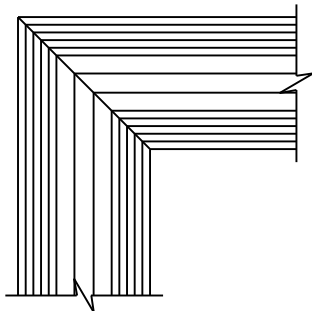

FLAT ELL

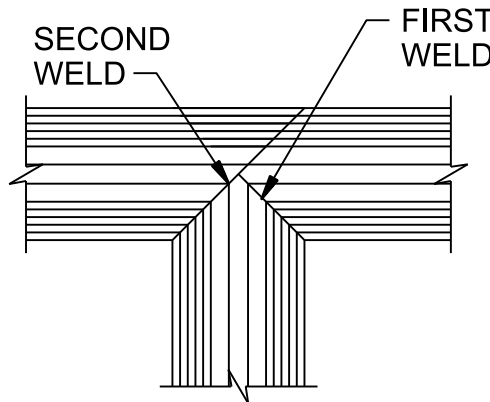

FLAT TEE

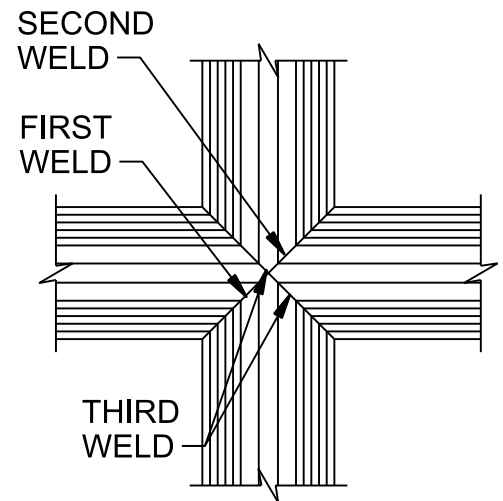

FLAT CROSS

NOTE:

ALL WELDS SHALL BE PER WATERSTOP MANUFACTURER'S RECOMMENDATIONS.

WATERSTOP JOINTS

NTS

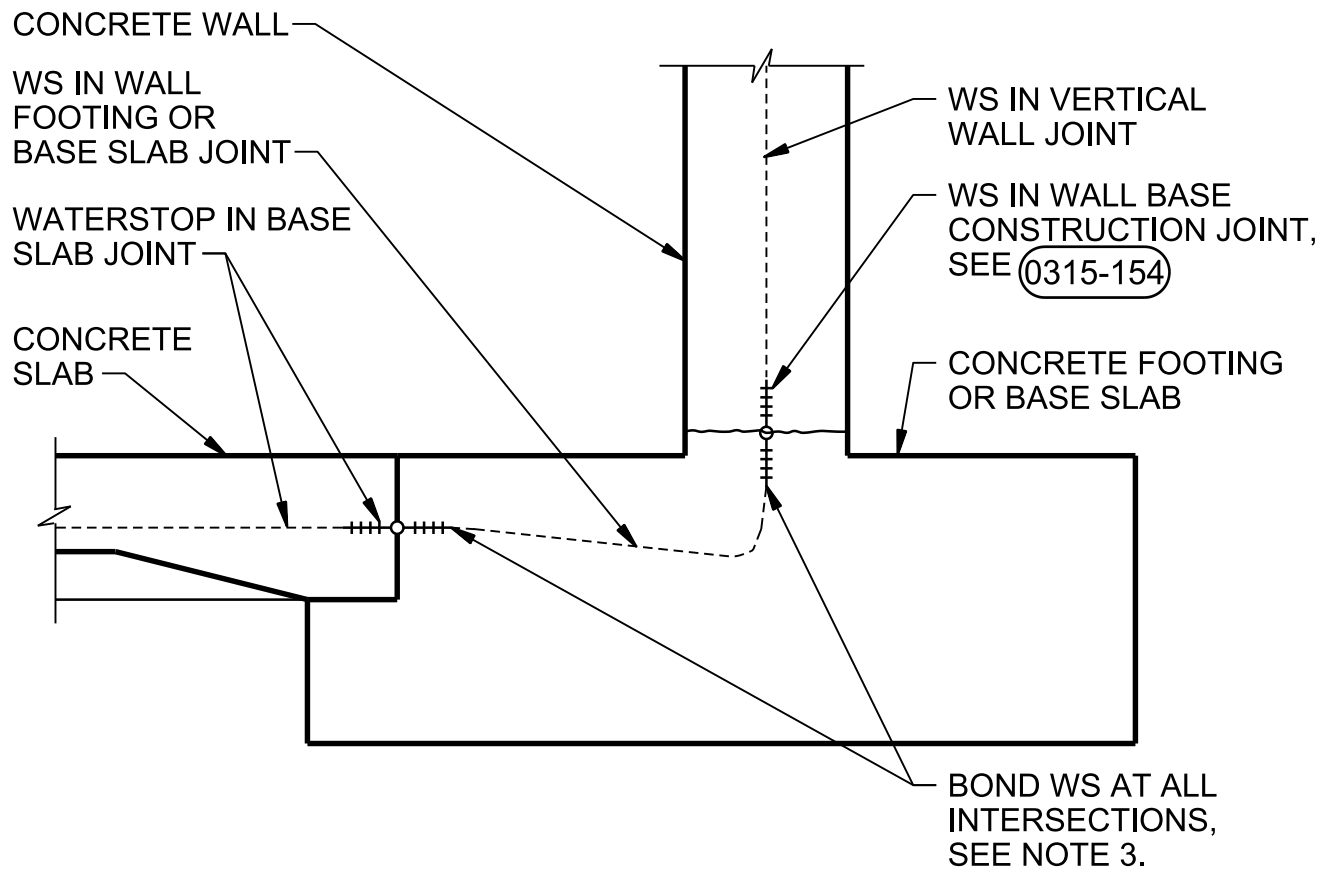

NOTES:

1. SUBMIT DETAILS OF SPLICING AND LOCATION.
2. BOND OR SPLICE ALL HORIZONTAL TRANSVERSE WATERSTOPS IN BASE SLAB JOINTS TO CONTINUOUS LONGITUDINAL WATERSTOP IN WALL BASE FOR COMPLETE SEAL.
3. BOND OR SPLICE ALL VERTICAL WATERSTOPS IN WALL JOINTS TO LONGITUDINAL WATERSTOP IN WALL BASE FOR COMPLETE SEAL, SEE (0315-011) FLAT CROSS JOINT.
4. FOR CONCRETE PLACEMENT SEQUENCE, SEE (0315-133)
5. FOR PLASTIC WATERSTOP DETAILS, SEE (0315-001)

WATERSTOP CONNECTION

NTS

© CH2M HILL

0315-012

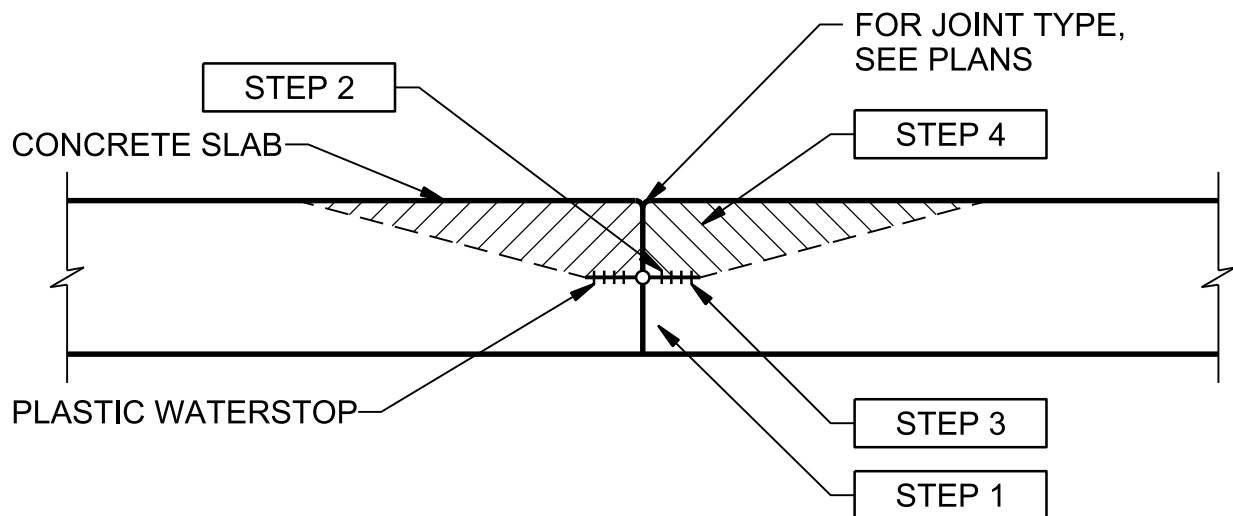

NOTES:

PLACEMENT SEQUENCE SHOWN REQUIRED ON BOTH SIDES OF JOINTS, IN ALL CONCRETE SLAB AND FOOTING POURS WITH HORIZONTALLY PLACED PLASTIC WATERSTOPS.

STEP 1

PLACE CONCRETE BELOW WATERSTOP FIRST, REMOVE ALL AIR VOIDS BY VIBRATING THOROUGHLY.

STEP 2

TO CONFIRM THERE ARE NO AIR VOIDS, LIFT WATERSTOP. A CONTINUOUS IMPRESSION OF THE WATERSTOP, INCLUDING EDGE OF BULB, SHOULD BE VISIBLE IN THE FRESH CONCRETE. CONTINUE THIS PROCEDURE ALONG THE ENTIRE POURED JOINT, END TO END. IF A CONTINUOUS IMPRESSION IS CONFIRMED, PROCEED WITH STEP 4. IF A VOID LARGER THAN 1/4 INCH IN DIAMETER IS PRESENT ANYWHERE IN THE WATERSTOP IMPRESSION, PROCEED WITH STEP 3.

STEP 3

IF A VOID LARGER THAN 1/4 INCH IN DIAMETER IS PRESENT IN THE WATERSTOP IMPRESSION, ADDITIONAL CONCRETE SHALL BE PLACED UNDER THE WATERSTOP, VIBRATED, AND STEP 2 REPEATED.

STEP 4

FINISH PLACING CONCRETE ABOVE THE WATERSTOP TO TOP OF SLAB.

CONCRETE PLACEMENT SEQUENCE

NTS

© CH2M HILL

0315-133

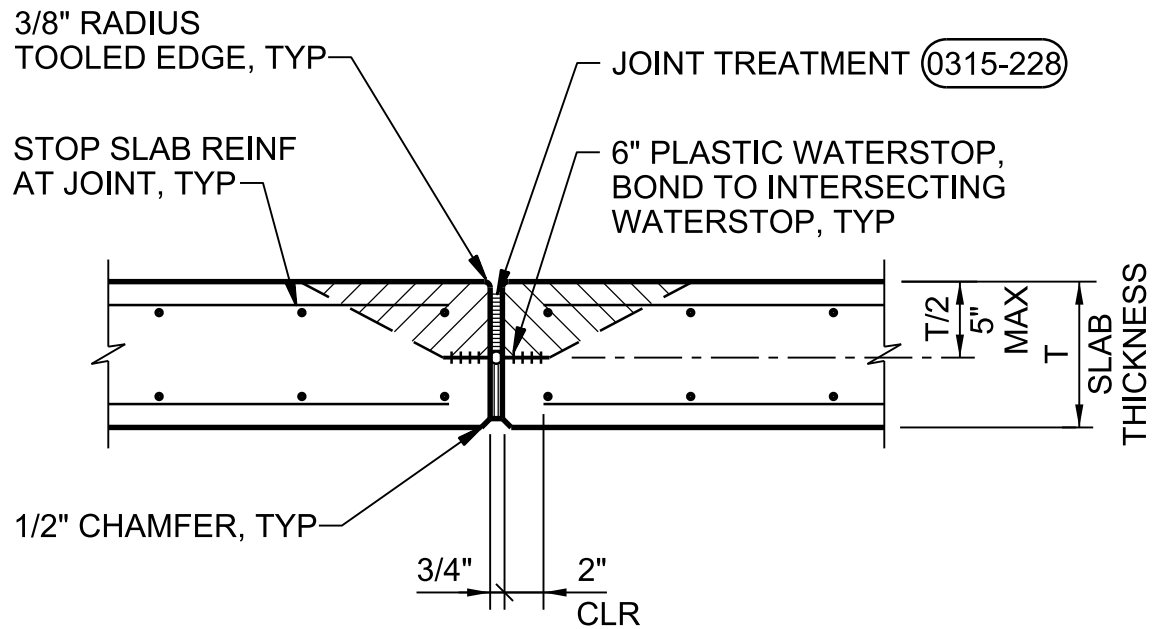

NOTE:

FOR CONCRETE PLACEMENT AROUND WATERSTOP, SEE (0315-133)

ELEVATED SLAB EXPANSION JOINT

NTS

© CH2M HILL

0315-216

POURABLE JOINT
FILLER TO WITHIN
1/2" OF TOP OF SLAB

WATERSTOP

LIQUID SIDE SURFACE

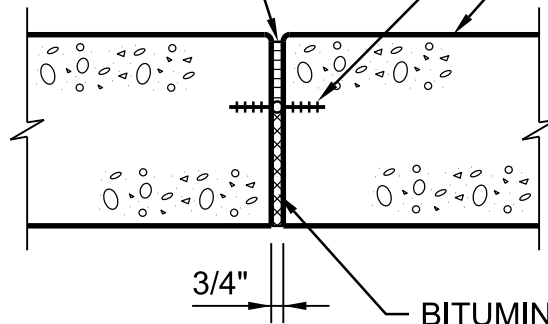

BITUMINOUS PREMOLDED
JOINT FILLER

SECTION

AT LIQUID HOLDING SLABS
(SEE NOTE 2)

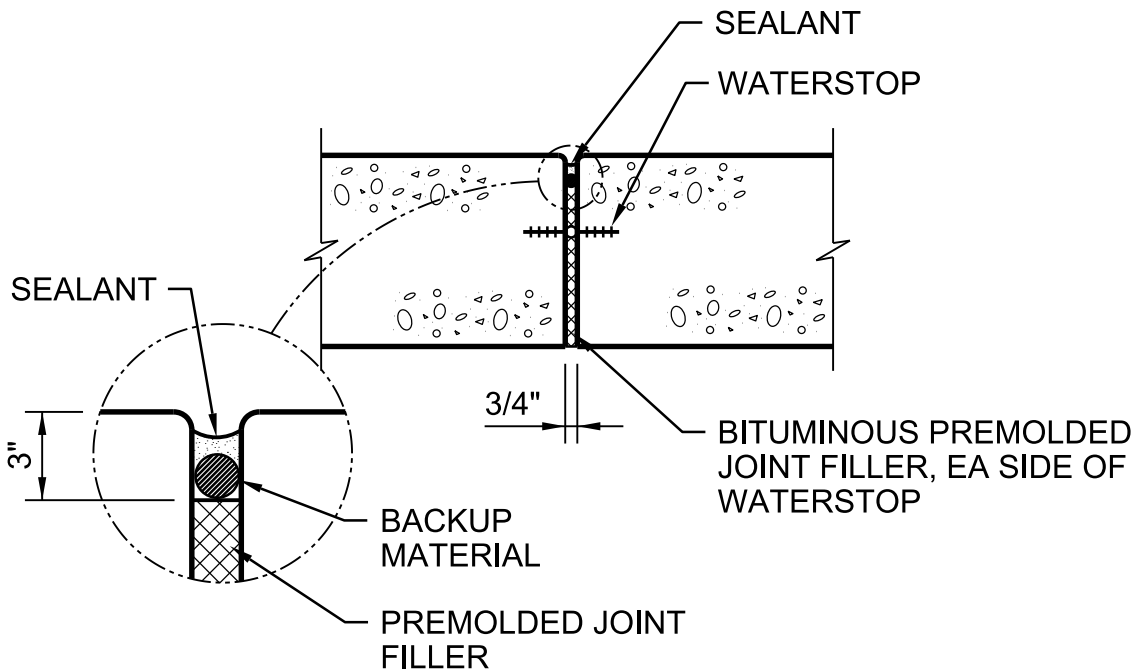

SECTION

AT NON-LIQUID HOLDING SLABS

NOTES:

1. ATTACH PREMOLDED JOINT FILLER WITH 8d GALVANIZED NAILS @ 1'-0" SPACING EMBEDDED IN FIRST SLAB POUR.
2. LIQUID HOLDING SLABS INCLUDING AREAS FOR TEMPORARY SECONDARY CONTAINMENT.

SLAB EXPANSION JOINT TREATMENT

NTS

© CH2M HILL

0315-228

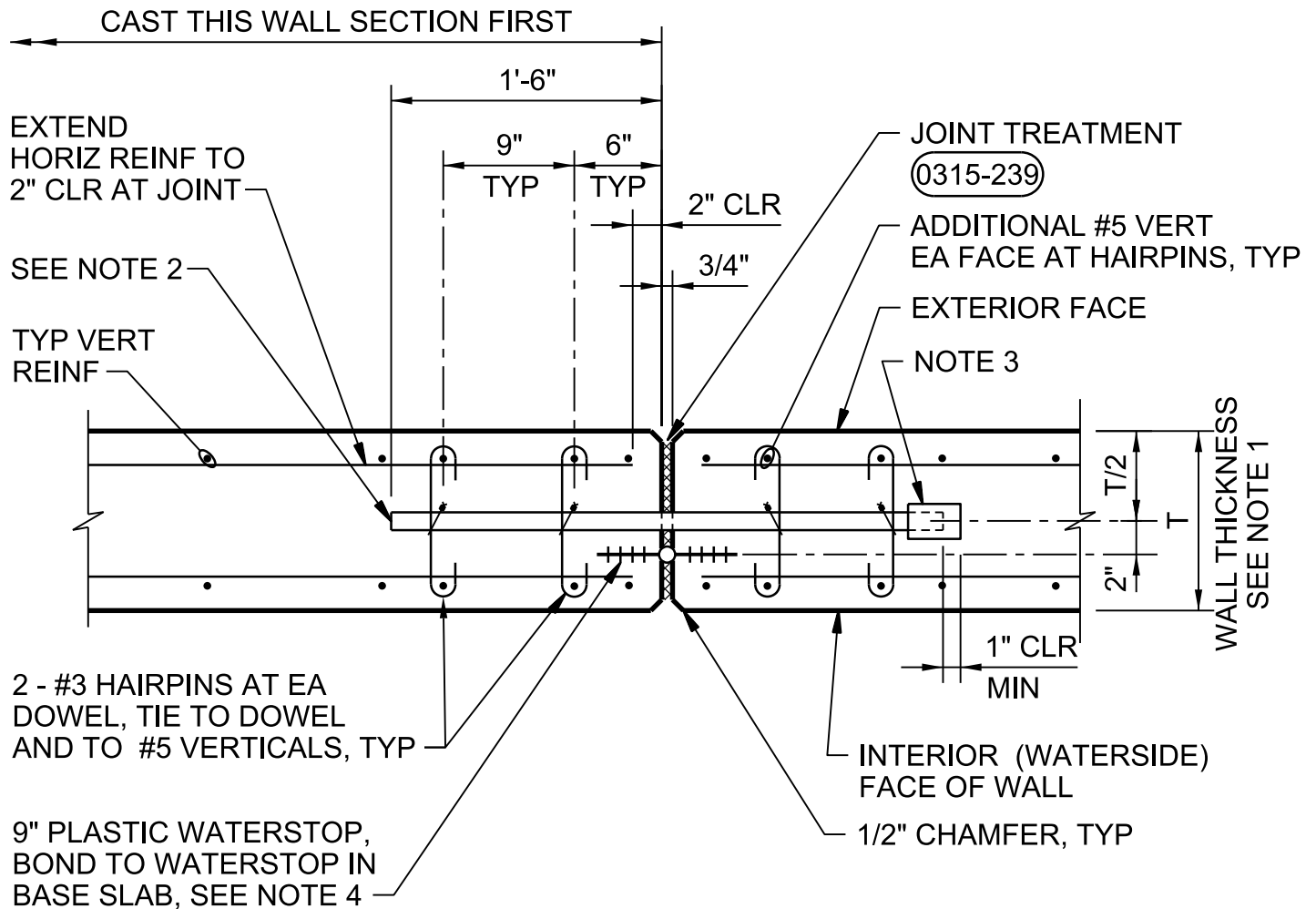

PLAN

NOTES:

1. FOR WALLS WITH THICKNESS OF 10" THRU 24". FOR 10" WALLS LOCATE DOWELS 4" FROM FACE OF WALL INSTEAD OF T/2 INDICATED.
2. 1" DIA x 3'-0" SMOOTH COATED BAR DOWELS. LOCATE AT 1'-0" MAX FROM TOP AND 2'-0" FROM BOTTOM OF WALL AND AT 2'-0" MAX SPACING. ALIGN AND TIE-IN-PLACE TO REINF COATING SHALL CONSIST OF A CORROSION RESISTANT COATING PLUS A LUBRICANT COATING AS SPECIFIED.
3. 1" ID x 2" PLASTIC CAP WITH 1" POLYSTYRENE BETWEEN END OF DOWEL AND END CAP. TAPE TO BAR FOR WATERTIGHT SEAL.
4. BEND VERTICAL JOINT WATERSTOP OVER TO CENTERLINE OF WALL IN BOTTOM 2'-0" OF WALL, AND SPLICE TO WATERSTOP IN WALL BASE CONSTRUCTION JOINT. SEE (0315-012)

WALL VERTICAL EXPANSION JOINT

NTS

© CH2M HILL

0315-232

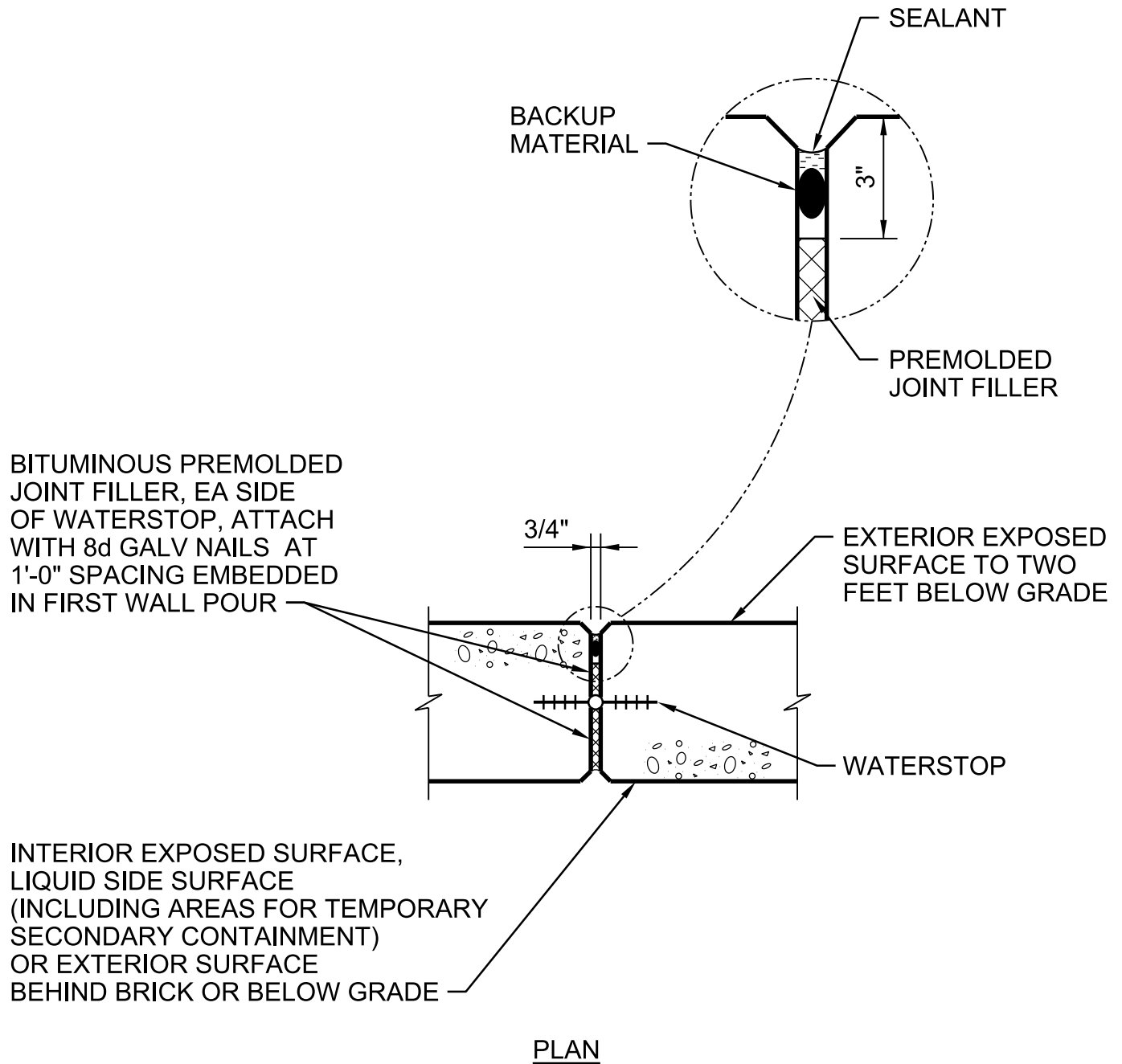

WALL EXPANSION JOINT TREATMENT

NTS

© CH2M HILL

0315-239